

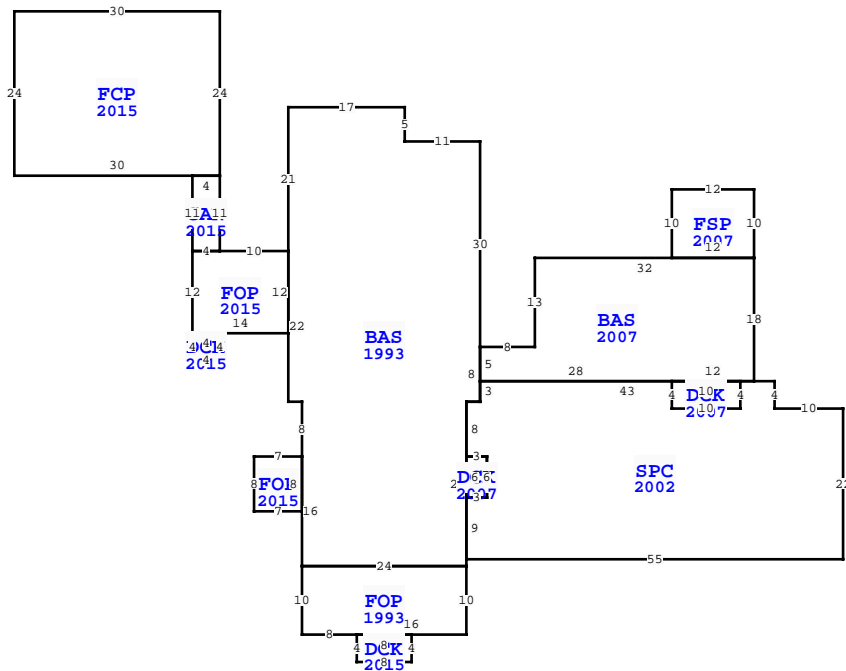

ELEMENT		CD	CONSTRUCTION		
Foundation	02	CONCR	SLAB	100	
Frame	02	WOOD	FRAME	100	
Exterior Wall	12	CEDAR/CYPR	100		
Roof Structur	03	GABLE/HIP	100		
Roof Cover	01	MINIMUM	100		
Interior Wall	05	DRYWALL	100		
Interior Floor	10	LAMINATED	50		
Interior Floor	11	CLAY TILE	50		
Heating Type	04	AIR DUCTED	100		
Air Condition	03	CENTRAL	100		
Bedrooms			3	100	
Bathrooms			3.5	100	
Story Height			0	100	
Stories	1.		1.	100	
Units			0	100	
Quality	03	AVERAGE			
DOR CODE	5000	IMPRVD AG RES			
MAP NUM	1	MKT AREA		12	
NEIGHBORHOOD/LOC	000	1.00/			
AREA TYPE	TOTAL GROSS AREA	PCT OF BASE	YEAR	TOT ADJ AREA	SUBAREA MARKET VALUE
BAS	1,725	100	1993	1,725	145,521
BAS	616	100	2007	616	51,966
CAN	44	30	2015	13	1,097
DCK	18	10	2007	2	169
DCK	40	10	2007	4	337
DCK	16	10	2015	2	169
DCK	32	10	2015	3	253
FCP	720	25	2015	180	15,185
FOP	240	30	1993	72	6,074
FOP	56	30	2015	17	1,434
TOTALS	5,161			3,023	255,020

MARKET ADJUSTMENTS											
TYPE	MDL	EFF. AREA	TOT ADJ PTS	EFF. BASE RATE	REPL. COST NEW	AYB	EYB	ECON	FNCT	NORM	% COND
0100	01	3,023	120.0000	114.00	344,622	1992	1997	0	0	26.00	74.00
1 SINGLE FAM 100% - 0 Heated Area: 2341 HX Base Yr											



\*\* This building has 13 Sub-Areas

BLD DATE	12/06/2019	MMLC	LGL DATE	
XF DATE	12/06/2019	MMLC	LAND DATE	12/06/2019
INC DATE			AG DATE	

EXTRA FEATURES																	
L N	OB/XF CODE	DESCRIPTION	BLD	CAP	L	W	UNITS	UT	Adj R	ADJ UNIT PRICE	ORIG COND	YEAR ON	YEAR ACTUAL	Q	% COND	OB/XF MKT VALUE	NOTES
1	0220	POOL VINYL	0	100	14	32	448.00	SF	60.00	60.00	100	1994	1994	3	40	10,752	
2	0210	CONCRETE D	0	100	24	16	384.00	SF	6.00	6.00	100	2002	2002	3	20	461	
3	0055	PORTABLE C	0	100	25	12	300.00	SF	3.00	3.00	100	2006	2006	3	27	243	
4	0770	PUMP HOUSE	0	100	4	4	16.00	SF	5.00	5.00	100	2003	2003	3	0	0	
5	0935	OPEN SHED	0	100	10	12	120.00	SF	6.00	6.00	100	2002	2002	3	20	144	
6	0030	BARN, POLE	0	100	30	16	480.00	SF	9.00	9.00	100	2009	2009	3	39	1,685	
7	0210	CONCRETE D	0	100	24	10	240.00	SF	6.00	6.00	100	2002	2002	3	20	288	
8	0030	BARN, POLE	0	100	40	16	640.00	SF	9.00	9.00	100	2011	2011	3	47	2,707	
9	0030	BARN, POLE	0	100	21	14	294.00	SF	9.00	9.00	100	2016	2016	3	72	1,905	
10	0625	PORT WD UT	0	100	16	10	160.00	SF	6.00	6.00	100	2017	2017	3	76	730	

TOTAL OB/XF												18,915										
1	000110	C	SFR RURAL				0.00	0.00	1.00	AC	1.00	1.00	1.00	15,000.00	15,000.00	15,000						
2	005970	A	TIMBER MIX 1				0.00	0.00	9.00	AC	1.00	1.00	1.00	325.00	325.00	2,925						

LAND DESCRIPTION												TOTAL OB/XF											
1	000110	C	SFR RURAL				0.00	0.00	1.00	AC	1.00	1.00	1.00	15,000.00	15,000.00	15,000							
2	005970	A	TIMBER MIX 1				0.00	0.00	9.00	AC	1.00	1.00	1.00	325.00	325.00	2,925							

TOTAL OB/XF												18,915											
1	000110	C	SFR RURAL				0.00	0.00	1.00	AC	1.00	1.00	1.00	15,000.00	15,000.00	15,000							
2	005970	A	TIMBER MIX 1				0.00	0.00	9.00	AC	1.00	1.00	1.00	325.00	325.00	2,925							

WAKULLA COUNTY PROPERTY				PAGE 1 of 1			
VALUATION BY				STANDARD			
Tax Group: 3		Tax Dist:					
BUILDING MARKET VALUE				255,020			
TOTAL MARKET OB/XF VALUE				18,915			
TOTAL LAND VALUE - MARKET				82,500			
TOTAL MARKET VALUE				291,860			
SOH/AGL Deduction				151,692			
ASSESSED VALUE				140,168			
TOTAL EXEMPTION VALUE				50,000			
BASE TAXABLE VALUE				90,168			
TOTAL JUST VALUE				356,435			
NCON VALUE				0			
INCOME VALUE							
PREVIOUS YEAR MKT VALUE				287,689			
2022 AG RENEWAL RECD							
2021 AG RENEWAL RECD							
11-13, CORR CODE XFOB LN 3							
5 YR PRCL CK, PU XFOB LN 8-10, DEL XFOB LN							
PERMIT NUM	DESCRIPTION	AMT	ISSUED				
15000273	RENOVATION	0	04/15/2015				
15000020	SAFETY INSP	0	02/03/2015				
2006930	ADDITION	0	06/01/2006				
32550	FSP	0	10/25/2004				
28710	POL CVR	0	02/28/2002				

SALES DATA						
OFF RECORD Number	DATE	TYPE INST	Q U	V I	RSN CD	SALE PRICE
0532/0287	4/12/2004	QC	U	I		100
GRANTOR: HARRELL THODORE WESLE						
GRANTEE: HARRELL						
0310/0129	10/01/1997	WD	U	I		39,000
GRANTOR: HARRELL THODORE WESLE						
GRANTEE:						

BUILDING NOTES											
FSP=[YR=2007] W12 S10 E12 BAS=[YR=2007] W32 S13 W8											
BAS=[YR=1993] N30 W11 N5 W17 S21 FOP=[YR=2015] W10											
CAN=[YR=2015] N11 FCP=[YR=2015] N24 W30 S24 E30\$ W4 S11 E4\$											
W4 S12 DCK=[YR=2015] S4 E4 N4 W4\$ E14 N12\$ S22 E2 S8											
FOP=[YR=2015] W7 S8 E7 N8\$ S16 FOP=[YR=1993] S10 E8											
DCK=[YR=2015] S4 E8 N4 W8\$ E16 N10 W24\$ E24 N24 E2 N8\$ S5											
SPC=[YR=2002] S3 W2 S8 DCK=[YR=2007] S6 E3 N6 W3\$ E3 S6 W3 S9											
E55 N22 W10 N4 W43\$ E28 DCK=[YR=2007] S4 E10 N4 W10\$ E12 N18											
\$ N10\$.											

BUILDING DIMENSIONS											
FSP=[YR=2007] W12 S10 E12 BAS=[YR=2007] W32 S13 W8											
BAS=[YR=1993] N30 W11 N5 W17 S21 FOP=[YR=2015] W10											
CAN=[YR=2015] N11 FCP=[YR=2015] N24 W30 S24 E30\$ W4 S11 E4\$											
W4 S12 DCK=[YR=2015] S4 E4 N4 W4\$ E14 N12\$ S22 E2 S8											
FOP=[YR=2015] W7 S8 E7 N8\$ S16 FOP=[YR=1993] S10 E8											
DCK=[YR=2015] S4 E8 N4 W8\$ E16 N10 W24\$ E24 N24 E2 N8\$ S5											
SPC=[YR=2002] S3 W2 S8 DCK=[YR=2007] S6 E3 N6 W3\$ E3 S6 W3 S9											
E55 N22 W10 N4 W43\$ E28 DCK=[YR=2007] S4 E10 N4 W10\$ E12 N18											
\$ N10\$.											