

| BUILDING CHARACTERISTICS |                  | CONSTRUCTION  |      |
|--------------------------|------------------|---------------|------|
| ELEMENT                  | CD               |               |      |
| Foundation               | 01               | WOOD FRAME    | 100  |
| Frame                    | 02               | WOOD FRAME    | 100  |
| Exterior Wall            | 12               | CEDAR/CYPR    | 100  |
| Roof Structur            | 02               | SHED          | 100  |
| Roof Cover               | 12               | MODULAR MT    | 100  |
| Interior Wall            | 05               | DRYWALL       | 100  |
| Interior Floor           | 12               | HARDWOOD      | 100  |
| Heating Type             | 04               | AIR DUCTED    | 100  |
| Air Condition            | 03               | CENTRAL       | 100  |
| Bedrooms                 |                  | 3             | 100  |
| Bathrooms                |                  | 2             | 100  |
| Story Height             |                  | 0             | 100  |
| Stories                  | 1.5              | 1.5           | 100  |
| Units                    |                  | 0             | 100  |
| Quality                  | 03               | AVERAGE       |      |
| DOR CODE                 | 0100             | SINGLE FAMILY |      |
| MAP NUM                  | 1                | MKT AREA      | 12   |
| NEIGHBORHOOD/LOC         | 000              | 1.00/         |      |
| AREA TYPE                | TOTAL GROSS AREA | PCT OF BASE   | YEAR |
| BAS                      | 1,428            | 100           | 1993 |
| DCK                      | 130              | 10            | 1993 |
| DCK                      | 240              | 10            | 2009 |
| FSP                      | 196              | 55            | 1993 |
| FST                      | 192              | 55            | 2009 |
| FUS                      | 280              | 100           | 1993 |
| UCP                      | 272              | 20            | 2009 |
| UOP                      | 20               | 20            | 1993 |
| UST                      | 192              | 45            | 1987 |
| TOTALS                   | 2,950            |               |      |

| MARKET ADJUSTMENTS   |     |           |             |                |                |      |      |      |      |       |        |
|--|-----|-----------|-------------|----------------|----------------|------|------|------|------|-------|--------|
| TYPE   | MDL | EFF. AREA | TOT ADJ PTS | EFF. BASE RATE | REPL. COST NEW | AYB  | EYB  | ECON | FNCT | NORM  | % COND |
| 0100   | 01  | 2,103     | 112.5200    | 106.89         | 224,790        | 1974 | 1981 | 0    | 0    | 42.00 | 58.00  |
| 1 SINGLE FAM 100% - 2008 Heated Area: 1708 HX Base Yr 2008 |     |           |             |                |                |      |      |      |      |       |        |

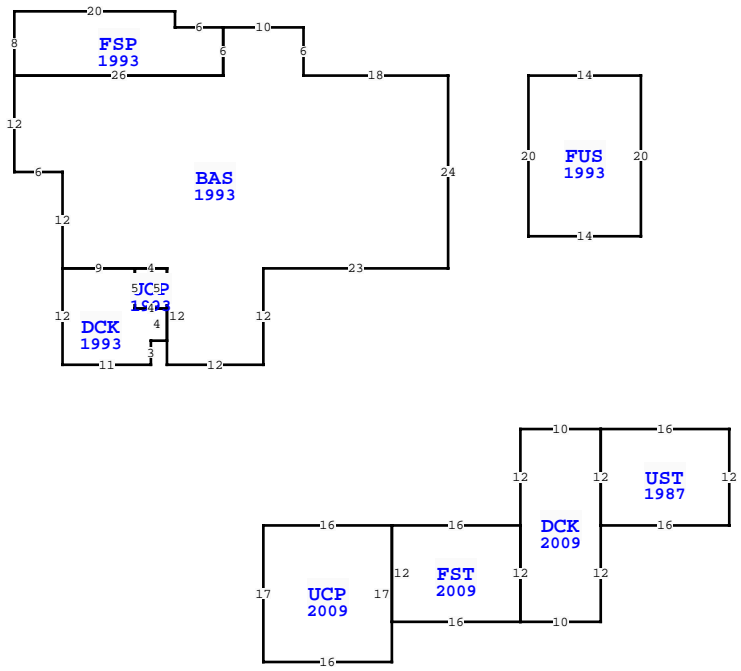

| WAKULLA COUNTY PROPERTY                      |             |     |            |
|--|-------------|-----|------------|
| VALUATION SUMMARY                            |             |     |            |
| VALUATION BY                                 | STANDARD    |     |            |
| Tax Group: 3                                 | Tax Dist:   |     |            |
| BUILDING MARKET VALUE                        | 157,628     |     |            |
| TOTAL MARKET OB/XF VALUE                     | 3,760       |     |            |
| TOTAL LAND VALUE - MARKET                    | 37,500      |     |            |
| TOTAL MARKET VALUE                           | 198,888     |     |            |
| SOH/AGL Deduction                            | 112,891     |     |            |
| ASSESSED VALUE                               | 85,997      |     |            |
| TOTAL EXEMPTION VALUE                        | 50,000      |     |            |
| BASE TAXABLE VALUE                           | 35,997      |     |            |
| TOTAL JUST VALUE                             | 198,888     |     |            |
| NCON VALUE                                   | 0           |     |            |
| INCOME VALUE                                 | 0           |     |            |
| PREVIOUS YEAR MKT VALUE                      | 201,607     |     |            |
| 5YR CK JS PU XFOB                            |             |     |            |
| 5 YR PRCL CH, N/C                            |             |     |            |
| PU FNDN & FRME CARD 2                        |             |     |            |
| TRAV, PU FNDN & FRME, CHG HTTP & A/C CARD 1, |             |     |            |
| PERMIT NUM                                   | DESCRIPTION | AMT | ISSUED     |
| 20061598                                     | REROOF      | 0   | 10/03/2006 |

| SALES DATA                    |           |           |     |     |        |            |
|-------------------------------|-----------|-----------|-----|-----|--------|------------|
| OFF RECORD Number             | DATE      | TYPE INST | Q U | V I | RSN CD | SALE PRICE |
| 1357/0408                     | 4/17/2024 | WD        | U   | I   | 30     | 100        |
| GRANTOR: MOYNAHAN DAVID FRANK |           |           |     |     |        |            |
| GRANTEE: THE MOYNAHAN/WAKOA   |           |           |     |     |        |            |
| 0910/0804                     | 5/08/2013 | WD        | U   | I   | 11     | 100        |
| GRANTOR: WAKOA CRYSTAL S      |           |           |     |     |        |            |
| GRANTEE: MOYNAHAN DAVID & WA  |           |           |     |     |        |            |

| EXTRA FEATURES |            |             |     |     |    |    |        |    |          |                |           |         |             |   |        |                 |       |
|----------------|------------|-------------|-----|-----|----|----|--------|----|----------|----------------|-----------|---------|-------------|---|--------|-----------------|-------|
| L N            | OB/XF CODE | DESCRIPTION | BLD | CAP | L  | W  | UNITS  | UT | Adj R    | ADJ UNIT PRICE | ORIG COND | YEAR ON | YEAR ACTUAL | Q | % COND | OB/XF MKT VALUE | NOTES |
| 1              | 0625       | PORT WD UT  | 0   | 100 | 14 | 9  | 126.00 | SF | 6.00     | 6.00           | 100       | 1987    | 1987        | 3 | 20     | 151             |       |
| 2              | 0940       | OPEN SHED   | 0   | 100 | 13 | 8  | 104.00 | SF | 4.00     | 4.00           | 100       | 1987    | 1987        | 3 | 20     | 83              |       |
| 3              | 0620       | WOOD UTL B  | 0   | 100 | 17 | 16 | 273.00 | SF | 6.00     | 6.00           | 100       | 1987    | 1987        | 3 | 20     | 328             |       |
| 4              | 0130       | FIRE PLACE  | 0   | 100 | 0  | 0  | 1.00   | UT | 1,300.00 | 1,300.00       | 100       | 1987    | 1987        | 3 | 44     | 572             |       |
| 5              | 0940       | OPEN SHED   | 0   | 100 | 8  | 5  | 40.00  | SF | 4.00     | 4.00           | 100       | 2005    | 2005        | 3 | 24     | 38              |       |
| 6              | 0940       | OPEN SHED   | 0   | 100 | 10 | 24 | 240.00 | SF | 4.00     | 4.00           | 100       | 1990    | 1990        | 3 | 20     | 192             |       |
| 7              | 0770       | PUMP HOUSE  | 0   | 100 | 4  | 5  | 20.00  | SF | 5.00     | 5.00           | 100       | 1987    | 1987        | 3 | 0      | 0               |       |
| 8              | 0060       | DECK WOOD   | 0   | 100 | 0  | 0  | 484.00 | SF | 5.00     | 5.00           | 100       | 2022    | 2022        | 3 | 99     | 2,396           |       |

| LAND DESCRIPTION |          |     |                      |     |     |          |       |       |             |           |     |          |        |         | TOTAL OB/XF |                |            |                             |      |         |      |     |    |        |
|------------------|----------|-----|----------------------|-----|-----|----------|-------|-------|-------------|-----------|-----|----------|--------|---------|-------------|----------------|------------|-----------------------------|------|---------|------|-----|----|--------|
| L N              | USE CODE | CLS | LAND USE DESCRIPTION | CAP | R D | LOC ZONE | FRONT | DEPTH | TOT LND UTS | UNIT TYPE | D T | DPH FACT | % COND | TOT ADJ | UNIT PRICE  | ADJ UNIT PRICE | LAND VALUE | OTHER ADJUSTMENTS AND NOTES | YEAR | DENSITY | DECL | FRZ | YR | CONSRV |
| 1                | 000100   | C   | SFR                  | 100 |     |          | 0.00  | 0.00  | 5.00        | AC        |     | 1.00     | 1.00   | 1.00    | 7,500.00    | 7,500.00       | 37,500     |                             |      |         |      |     |    |        |

| ELEMENT          |                  | CD            | CONSTRUCTION |              |                      |
|------------------|------------------|---------------|--------------|--------------|----------------------|
| Foundation       | 01               | WOOD          | FRAME        | 100          |                      |
| Frame            | 02               | WOOD          | FRAME        | 100          |                      |
| Exterior Wall    | 08               | WD ON         | PLY          | 100          |                      |
| Roof Structur    | 03               | GABLE/HIP     |              | 100          |                      |
| Roof Cover       | 12               | MODULAR       | MT           | 100          |                      |
| Interior Wall    | 05               | DRYWALL       |              | 100          |                      |
| Interior Floo    | 12               | HARDWOOD      |              | 100          |                      |
| Heating Type     | 01               | NONE          |              | 100          |                      |
| Air Condition    | 02               | WINDOW        |              | 100          |                      |
| Bedrooms         | 1                | 100           |              |              |                      |
| Bathrooms        | 1                | 100           |              |              |                      |
| Story Height     | 0                | 100           |              |              |                      |
| Stories          | 1.5              | 1.5           | 100          |              |                      |
| Units            | 0                | 100           |              |              |                      |
| Quality          | 02               | BELOW AVERAGE |              |              |                      |
| DOR CODE         | 0100             | SINGLE FAMILY |              |              |                      |
| MAP NUM          | 1                | MKT AREA      |              | 12           |                      |
| NEIGHBORHOOD/LOC | 000              | 1.00/         |              |              |                      |
| AREA TYPE        | TOTAL GROSS AREA | PCT OF BASE   | YEAR         | TOT ADJ AREA | SUBAREA MARKET VALUE |
| BAS              | 272              | 100           | 2006         | 272          | 14,620               |
| FUS              | 100              | 100           | 2006         | 100          | 5,375                |
| UCP              | 260              | 20            | 2006         | 52           | 2,795                |
| USP              | 208              | 40            | 2006         | 83           | 4,461                |
| TOTALS           | 840              |               |              | 507          | 27,250               |

| MARKET ADJUSTMENTS |     |             |             |                  |                |                 |      |      |      |       |        |
|--------------------|-----|-------------|-------------|------------------|----------------|-----------------|------|------|------|-------|--------|
| TYPE               | MDL | EFF. AREA   | TOT ADJ PTS | EFF. BASE RATE   | REPL. COST NEW | AYB             | EYB  | ECON | FNCT | NORM  | % COND |
| 0100               | 01  | 507         | 88.4000     | 83.98            | 42,578         | 1987            | 1987 | 0    | 0    | 36.00 | 64.00  |
| 2 SINGLE FAM       |     | 100% - 2008 |             | Heated Area: 372 |                | HX Base Yr 2008 |      |      |      |       |        |

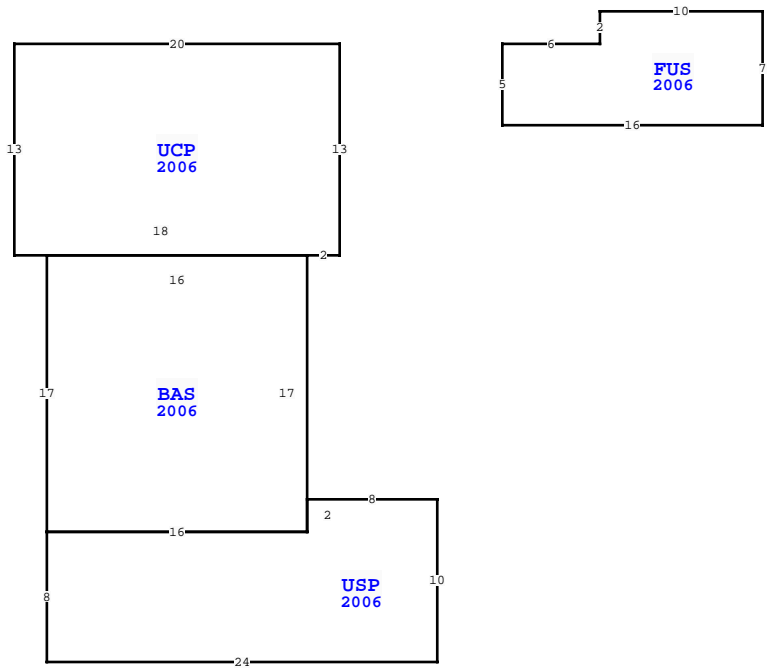

| WAKULLA COUNTY PROPERTY  |             |              |        | PAGE 2 of 2 | 3      |            |
|--|-------------|--------------|--------|-------------|--------|------------|
| VALUATION SUMMARY  |             |              |        |             |        |            |
| VALUATION BY   |             | STANDARD     |        |             |        |            |
| Tax Group: 3   |             | Tax Dist:    |        |             |        |            |
| BUILDING MARKET VALUE  |             | 157,628      |        |             |        |            |
| TOTAL MARKET OB/XF VALUE   |             | 3,760        |        |             |        |            |
| TOTAL LAND VALUE - MARKET  |             | 37,500       |        |             |        |            |
| TOTAL MARKET VALUE   |             | 198,888      |        |             |        |            |
| SOH/AGL Deduction  |             | 112,891      |        |             |        |            |
| ASSESSED VALUE   |             | 85,997       |        |             |        |            |
| TOTAL EXEMPTION VALUE  |             | HX HB 50,000 |        |             |        |            |
| BASE TAXABLE VALUE   |             | 35,997       |        |             |        |            |
| TOTAL JUST VALUE   |             | 198,888      |        |             |        |            |
| NCON VALUE   |             | 0            |        |             |        |            |
| INCOME VALUE   |             |              |        |             |        |            |
| PREVIOUS YEAR MKT VALUE  |             | 201,607      |        |             |        |            |
| CHG WIDTH XFOB LN 2, PU XFOB LN 7, PU NEW                        |             |              |        |             |        |            |
| 5 YR PRCL CH, CHG LENGTH & WIDTH XFOB LN 1,                      |             |              |        |             |        |            |
| 5 YR PRCL CH, CHG FHS TO FUS IN TRAV                             |             |              |        |             |        |            |
| 1, 5 YR PRCL CK  |             |              |        |             |        |            |
| PERMIT NUM   | DESCRIPTION | AMT          | ISSUED |             |        |            |
| SALES DATA   |             |              |        |             |        |            |
| OFF RECORD Number  | DATE        | TYPE INST    | Q / U  | V / I       | RSN CD | SALE PRICE |
| 1357/0408  | 4/17/2024   | WD           | U      | I           | 30     | 100        |
| GRANTOR: MOYNAHAN DAVID FRANK                                    |             |              |        |             |        |            |
| GRANTEE: THE MOYNAHAN/WAKOA                                      |             |              |        |             |        |            |
| 0910/0804  | 5/08/2013   | WD           | U      | I           | 11     | 100        |
| GRANTOR: WAKOA CRYSTAL S   |             |              |        |             |        |            |
| GRANTEE: MOYNAHAN DAVID & WA                                     |             |              |        |             |        |            |
| BUILDING NOTES   |             |              |        |             |        |            |
| BUILDING DIMENSIONS  |             |              |        |             |        |            |
| UCP=[YR=2006] W20 S13 E18 BAS=[YR=2006] W16 S17                  |             |              |        |             |        |            |
| USP=[YR=2006] S8 E24 N10 W8 S2 W16\$ E16 N17\$ E2 N13\$ PTR= E10 |             |              |        |             |        |            |
| FUS=[YR=2006] S5 E16 N7 W10 S2 W6\$ W10\$.                       |             |              |        |             |        |            |

| EXTRA FEATURES                       |            |             |         |   |   |       |    |       |                |           |         |             |   |        |                 |       |
|--------------------------------------|------------|-------------|---------|---|---|-------|----|-------|----------------|-----------|---------|-------------|---|--------|-----------------|-------|
| L N                                  | OB/XF CODE | DESCRIPTION | BLD CAP | L | W | UNITS | UT | Adj R | ADJ UNIT PRICE | ORIG COND | YEAR ON | YEAR ACTUAL | Q | % COND | OB/XF MKT VALUE | NOTES |
| 108 PASSION FLOWER LN, CRAWFORDVILLE |            |             |         |   |   |       |    |       |                |           |         |             |   |        |                 |       |
| TOTAL OB/XF 0                        |            |             |         |   |   |       |    |       |                |           |         |             |   |        |                 |       |

| LAND DESCRIPTION |          |     |                      |     |     |          |       |       |             |           |     |          |        |         |            |                |            |                             |      |         |      |     |    |        |
|------------------|----------|-----|----------------------|-----|-----|----------|-------|-------|-------------|-----------|-----|----------|--------|---------|------------|----------------|------------|-----------------------------|------|---------|------|-----|----|--------|
| L N              | USE CODE | CLS | LAND USE DESCRIPTION | CAP | R D | LOC ZONE | FRONT | DEPTH | TOT LND UTS | UNIT TYPE | D T | DPH FACT | % COND | TOT ADJ | UNIT PRICE | ADJ UNIT PRICE | LAND VALUE | OTHER ADJUSTMENTS AND NOTES | YEAR | DENSITY | DECL | FRZ | YR | CONSRV |
|                  |          |     |                      |     |     |          |       |       |             |           |     |          |        |         |            |                |            |                             |      |         |      |     |    |        |