

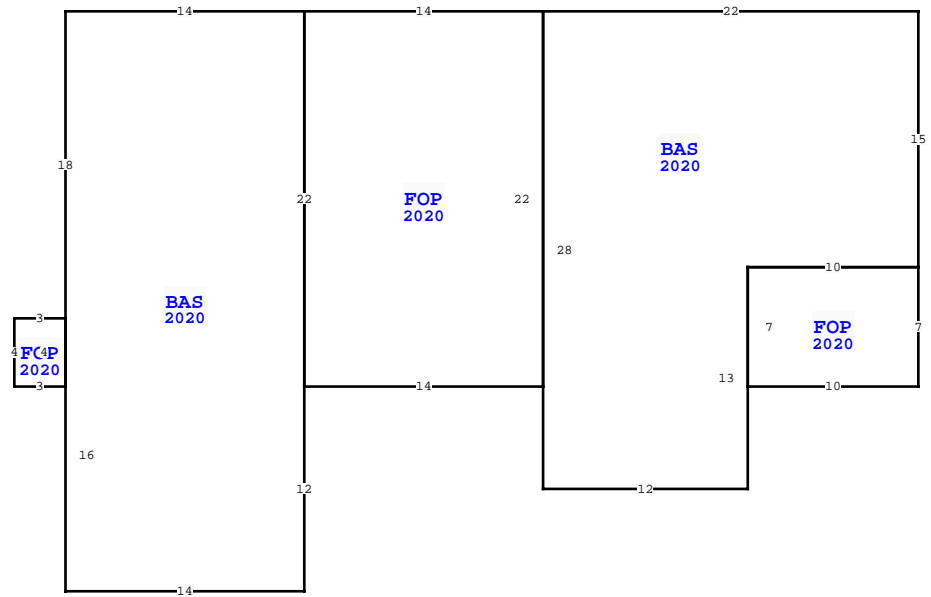

| ELEMENT          |                  | BUILDING CHARACTERISTICS |      |
|------------------|------------------|--------------------------|------|
| ELEMENT          | CD               | CONSTRUCTION             |      |
| Foundation       | 02               | CONCR SLAB 100           |      |
| Frame            | 05               | WOOD FRAME 100           |      |
| Exterior Wall    | 02               | HARDIE BRD 100           |      |
| Roof Structur    | 03               | GABLE/HIP 100            |      |
| Roof Cover       | 03               | COMP SHNGL 100           |      |
| Interior Wall    | 05               | DRYWALL 100              |      |
| Interior Floo    | 10               | LAMINATED 100            |      |
| Heating Type     | 04               | AIR DUCTED 100           |      |
| Air Condition    | 03               | CENTRAL 100              |      |
| Bedrooms         |                  | 2 100                    |      |
| Bathrooms        |                  | 2 100                    |      |
| Story Height     |                  | 0 100                    |      |
| Stories          | 1.               | 1. 100                   |      |
| Units            |                  | 0 100                    |      |
| Quality          | 08               | FAIR                     |      |
| DOR CODE         | 0100             | SINGLE FAMILY            |      |
| MAP NUM          | 1                | MKT AREA                 | 12   |
| NEIGHBORHOOD/LOC | 6.00             | 1.00/                    |      |
| AREA TYPE        | TOTAL GROSS AREA | PCT OF BASE              | YEAR |
| BAS              | 476              | 100                      | 2020 |
| BAS              | 486              | 100                      | 2020 |
| FOP              | 12               | 30                       | 2020 |
| FOP              | 70               | 30                       | 2020 |
| FOP              | 308              | 30                       | 2020 |
| TOTALS           | 1,352            |                          |      |

| MARKET ADJUSTMENTS                              |     |           |             |                |                |      |      |      |      |      |        |  |  |
|---|-----|-----------|-------------|----------------|----------------|------|------|------|------|------|--------|--|--|
| TYPE  | MDL | EFF. AREA | TOT ADJ PTS | EFF. BASE RATE | REPL. COST NEW | AYB  | EYB  | ECON | FNCT | NORM | % COND |  |  |
| 0100  | 01  | 1,079     | 104.4000    | 99.18          | 107,015        | 2020 | 2020 | 0    | 0    | 3.00 | 97.00  |  |  |
| 1 SINGLE FAM 0% - 0 Heated Area: 962 HX Base Yr |     |           |             |                |                |      |      |      |      |      |        |  |  |



| WAKULLA COUNTY PROPERTY   |             |           |                           |
|---|-------------|-----------|---------------------------|
| VALUATION SUMMARY   |             |           | PAGE 1 of 1               |
| VALUATION BY  |             |           | STANDARD                  |
| Tax Group: 3  | Tax Dist:   |           |                           |
| BUILDING MARKET VALUE   |             |           | 103,805                   |
| TOTAL MARKET OB/XF VALUE  |             |           | 9,680                     |
| TOTAL LAND VALUE - MARKET   |             |           | 13,500                    |
| TOTAL MARKET VALUE  |             |           | 126,985                   |
| SOH/AGL Deduction   |             |           | 0                         |
| ASSESSED VALUE  |             |           | 126,985                   |
| TOTAL EXEMPTION VALUE   |             |           | 0                         |
| BASE TAXABLE VALUE  |             |           | 126,985                   |
| TOTAL JUST VALUE  |             |           | 126,985                   |
| NCON VALUE  |             |           | 0                         |
| INCOME VALUE  |             |           |                           |
| PREVIOUS YEAR MKT VALUE   |             |           | 122,952                   |
| 5 YR PRCL CK, PU NEW SFD & XFOB LN 1-7  |             |           |                           |
| 5 YR PRCL CK, N/C   |             |           |                           |
| 5 YR PRCL CH, N/C   |             |           |                           |
| 5 YR PRCL CK, N/C   |             |           |                           |
| PERMIT NUM  | DESCRIPTION | AMT       | ISSUED                    |
| 19001523  | SFD-CO      | 0         | 12/11/2019                |
| SALES DATA  |             |           |                           |
| OFF RECORD Number   | DATE        | TYPE INST | Q / V / RSN CD SALE PRICE |
| 1074/0872   | 5/29/2018   | WD Q      | V / 05 9,000              |
| GRANTOR: KNEECE WILLIAM   |             |           |                           |
| GRANTEE: FORGOTTEN WATERS, L  |             |           |                           |
| 0367/0457   | 11/15/1999  | WD U      | V 6,400                   |
| GRANTOR: KNEECE WILLIAM   |             |           |                           |
| GRANTEE:  |             |           |                           |
| BUILDING NOTES  |             |           |                           |
| BUILDING DIMENSIONS   |             |           |                           |
| BAS=[YR=2020] W22 FOP=[YR=2020] W14 S22 BAS=[YR=2020] N22 W14 S18 FOP=[YR=2020] W3 S4 E3 N4\$ S16 E14 N12\$ E14 N22 \$ S28 E12 N13 FOP=[YR=2020] S7 E10 N7 W10\$ E10 N15\$. |             |           |                           |

| EXTRA FEATURES |            |             |         |   |    |       |    |       |                |           |         |             |   |        |                 |       |
|----------------|------------|-------------|---------|---|----|-------|----|-------|----------------|-----------|---------|-------------|---|--------|-----------------|-------|
| L N            | OB/XF CODE | DESCRIPTION | BLD CAP | L | W  | UNITS | UT | Adj R | ADJ UNIT PRICE | ORIG COND | YEAR ON | YEAR ACTUAL | Q | % COND | OB/XF MKT VALUE | NOTES |
| 1              | 0210       | CONCRETE D  | 0       | 0 | 59 | 10    |    |       | 6.00           | 100       | 2020    | 2020        | 3 | 89     | 3,151           |       |
| 2              | 0210       | CONCRETE D  | 0       | 0 | 70 | 10    |    |       | 6.00           | 100       | 2020    | 2020        | 3 | 89     | 3,738           |       |
| 3              | 0211       | CONCRETE W  | 0       | 0 | 82 | 4     |    |       | 6.00           | 100       | 2020    | 2020        | 3 | 89     | 1,752           |       |
| 4              | 0211       | CONCRETE W  | 0       | 0 | 11 | 4     |    |       | 6.00           | 100       | 2020    | 2020        | 3 | 89     | 235             |       |
| 5              | 0213       | CONCRETE P  | 0       | 0 | 11 | 11    |    |       | 6.00           | 100       | 2020    | 2020        | 3 | 100    | 726             |       |
| 6              | 0770       | PUMP HOUSE  | 0       | 0 | 4  | 4     |    |       | 5.00           | 100       | 2020    | 2020        | 3 | 97     | 78              |       |
| TOTALS         |            |             |         |   |    |       |    |       |                |           |         |             |   | 9,680  |                 |       |

| LAND DESCRIPTION |          |     |                      |     |     |          |       |       |             |           |     |          |        |         |            |                |            |                             |      |         |      |     |    |        |
|------------------|----------|-----|----------------------|-----|-----|----------|-------|-------|-------------|-----------|-----|----------|--------|---------|------------|----------------|------------|-----------------------------|------|---------|------|-----|----|--------|
| L N              | USE CODE | CLS | LAND USE DESCRIPTION | CAP | R D | LOC ZONE | FRONT | DEPTH | TOT LND UTS | UNIT TYPE | D T | DPH FACT | % COND | TOT ADJ | UNIT PRICE | ADJ UNIT PRICE | LAND VALUE | OTHER ADJUSTMENTS AND NOTES | YEAR | DENSITY | DECL | FRZ | YR | CONSRV |
| 1                | 000100   | C   | SFR                  | 0   |     |          | 80.00 | 95.00 | 1.00        | LT        |     | 1.00     | 1.00   | 1.00    | 6,750.00   | 6,750.00       | 6,750      |                             |      |         |      |     |    |        |
| 2                | 000100   | C   | SFR                  | 0   |     |          | 55.00 | 95.00 | 1.00        | LT        |     | 1.00     | 1.00   | 1.00    | 6,750.00   | 6,750.00       | 6,750      |                             |      |         |      |     |    |        |