

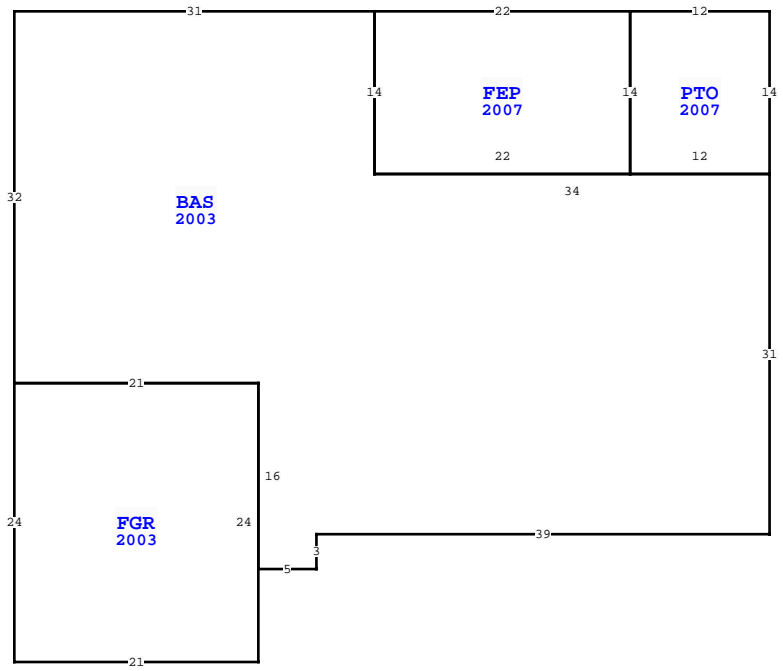

| ELEMENT | | BUILDING CHARACTERISTICS | |
|------------------|------------------|--------------------------|------|
| ELEMENT | CD | CONSTRUCTION | |
| Foundation | 02 | CONCR SLAB 100 | |
| Frame | 02 | WOOD FRAME 100 | |
| Exterior Wall | 19 | COMMON BRK 80 | |
| Exterior Wall | 05 | HARDIE BRD 20 | |
| Roof Structur | 03 | GABLE/HIP 100 | |
| Roof Cover | 03 | COMP SHNGL 100 | |
| Interior Wall | 05 | DRYWALL 100 | |
| Interior Floo | 14 | CARPET 80 | |
| Interior Floo | 12 | HARDWOOD 20 | |
| Heating Type | 04 | AIR DUCTED 100 | |
| Air Condition | 03 | CENTRAL 100 | |
| Bedrooms | | 4 100 | |
| Bathrooms | | 3 100 | |
| Story Height | | 0 100 | |
| Stories | 1. | 1. 100 | |
| Units | | 0 100 | |
| Quality | 03 | AVERAGE | |
| DOR CODE | 0100 | SINGLE FAMILY | |
| MAP NUM | 4 | MKT AREA | 10 |
| NEIGHBORHOOD/LOC | 000 | 1.00/ | |
| AREA TYPE | TOTAL GROSS AREA | PCT OF BASE | YEAR |
| BAS | 2,191 | 100 | 2003 |
| FEP | 308 | 80 | 2007 |
| FGR | 504 | 50 | 2003 |
| PTO | 168 | 5 | 2007 |
| TOTALS | 3,171 | | |

| MARKET ADJUSTMENTS | | | | | | | | | | | | | |
|--------------------|------------|-----------|-------------|----------------|----------------|-----|-----|------|------|------|--------|-----------------------------------|--|
| TYPE | MDL | EFF. AREA | TOT ADJ PTS | EFF. BASE RATE | REPL. COST NEW | AYB | EYB | ECON | FNCT | NORM | % COND | | |
| 1 | SINGLE FAM | 100% | - 2004 | | | | | | | | | Heated Area: 2437 HX Base Yr 2004 | |



| WAKULLA COUNTY PROPERTY | | | |
|--|-------------|------------------|-------------|
| VALUATION SUMMARY | | | PAGE 1 of 1 |
| VALUATION BY | | STANDARD | |
| Tax Group: 3 | | Tax Dist: | |
| BUILDING MARKET VALUE | | 238,178 | |
| TOTAL MARKET OB/XF VALUE | | 5,415 | |
| TOTAL LAND VALUE - MARKET | | 52,500 | |
| TOTAL MARKET VALUE | | 296,093 | |
| SOH/AGL Deduction | | 82,296 | |
| ASSESSED VALUE | | 213,797 | |
| TOTAL EXEMPTION VALUE | | HX HB SX 100,000 | |
| BASE TAXABLE VALUE | | 113,797 | |
| TOTAL JUST VALUE | | 296,093 | |
| NCON VALUE | | 0 | |
| INCOME VALUE | | | |
| PREVIOUS YEAR MKT VALUE | | 299,341 | |
| 5 YR PRCL CK, CHG/ADD ELMNTS AS FUTURE PAPER. DEMO | | | |
| UPDTD NAME/ADDRESS FIELDS CONV | | | |
| CORRECTED NAME SPELLING OF TANYA MONROE | | | |
| 5 YR PRCL CK, CHG EXW, QUAL | | | |
| PERMIT NUM | DESCRIPTION | AMT | ISSUED |
| 2007577 | SUNROOM | 0 | 04/23/2007 |
| 29558 | SFD | 0 | 10/28/2002 |

| SALES DATA | | | | | | |
|--------------------------------|------------|-----------|-----|-----|--------|------------|
| OFF RECORD Number | DATE | TYPE INST | Q U | V I | RSN CD | SALE PRICE |
| 1244/0490 | 12/23/2021 | QC | U | I | 11 | 100 |
| GRANTOR: GAVIN CLARENCE C & MA | | | | | | |
| GRANTEE: GAVIN CLARENCE C & | | | | | | |
| 0520/0780 | 1/20/2004 | QC | U | I | | 100 |
| GRANTOR: GAVIN | | | | | | |
| GRANTEE: GAVIN | | | | | | |

| EXTRA FEATURES | | | | | | | | | | | | | | | |
|----------------|------------|-------------|---------|-------|----------|----|----------|----------------|-----------|---------|-------------|---|--------|-----------------|-------|
| L N | OB/XF CODE | DESCRIPTION | BLD CAP | L W | UNITS | UT | Adj R | ADJ UNIT PRICE | ORIG COND | YEAR ON | YEAR ACTUAL | Q | % COND | OB/XF MKT VALUE | NOTES |
| 1 | 0940 | OPEN SHED | 0 100 | 20 30 | 600.00 | SF | 4.00 | 4.00 | 100 | 1993 | 1993 | 3 | 20 | 480 | |
| 2 | 0130 | FIRE PLACE | 0 100 | 0 0 | 1.00 | UT | 1,300.00 | 1,300.00 | 100 | 2003 | 2003 | 3 | 60 | 780 | |
| 3 | 0210 | CONCRETE D | 0 100 | 0 0 | 782.00 | SF | 6.00 | 6.00 | 100 | 2003 | 2003 | 3 | 21 | 985 | |
| 4 | 0211 | CONCRETE W | 0 100 | 0 0 | 219.00 | SF | 6.00 | 6.00 | 100 | 2003 | 2003 | 3 | 21 | 276 | |
| 5 | 0210 | CONCRETE D | 0 100 | 0 0 | 1,897.00 | SF | 6.00 | 6.00 | 100 | 2004 | 2004 | 3 | 23 | 2,618 | |
| 6 | 0211 | CONCRETE W | 0 100 | 20 5 | 100.00 | SF | 6.00 | 6.00 | 100 | 2004 | 2004 | 3 | 23 | 138 | |
| 7 | 0211 | CONCRETE W | 0 100 | 10 10 | 100.00 | SF | 6.00 | 6.00 | 100 | 2004 | 2004 | 3 | 23 | 138 | |
| TOTAL OB/XF | | | | | | | | | | | | | | 5,415 | |

| BUILDING NOTES | | | | | | | | | | | | | |
|---|--|--|--|--|--|--|--|--|--|--|--|--|--|
| PTO=[YR=2007] W12 FEP=[YR=2007] W22 S14 E22 N14\$ S14 E12 | | | | | | | | | | | | | |
| BAS=[YR=2003] W34 N14 W31 S32 FGR=[YR=2003] S24 E21 N24 W21\$ | | | | | | | | | | | | | |
| E21 S16 E5 N3 E39 N31 \$ N14\$. | | | | | | | | | | | | | |

| LAND DESCRIPTION | | | | | | | | | | | | | | TOTAL OB/XF | | | | | | | | | | |
|------------------|----------|-----|----------------------|-----|-----|----------|-------|-------|-------------|-----------|-----|----------|--------|-------------|------------|----------------|------------|-----------------------------|------|---------|------|-----|----|--------|
| L N | USE CODE | CLS | LAND USE DESCRIPTION | CAP | R D | LOC ZONE | FRONT | DEPTH | TOT LND UTS | UNIT TYPE | D T | DPH FACT | % COND | TOT ADJ | UNIT PRICE | ADJ UNIT PRICE | LAND VALUE | OTHER ADJUSTMENTS AND NOTES | YEAR | DENSITY | DECL | FRZ | YR | CONSRV |
| 1 | 000100 | C | SFR | 100 | | | 0.00 | 0.00 | 7.00 | AC | | 1.00 | 1.00 | 1.00 | 7,500.00 | 7,500.00 | 52,500 | | | | | | | |