

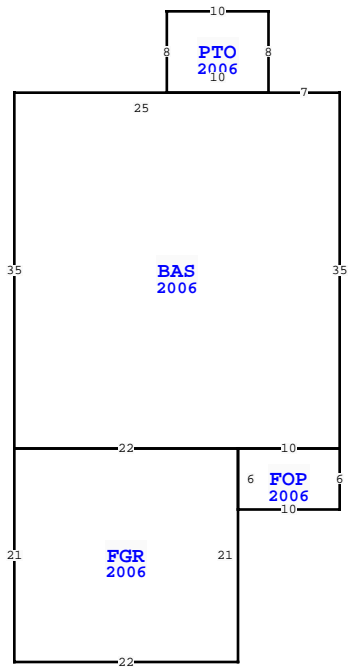

| BUILDING CHARACTERISTICS | | |
|--------------------------|------------------|----------------|
| ELEMENT | CD | CONSTRUCTION |
| Foundation | 02 | CONCR SLAB 100 |
| Frame | 02 | WOOD FRAME 100 |
| Exterior Wall | 05 | HARDIE BRD 100 |
| Roof Structur | 03 | GABLE/HIP 100 |
| Roof Cover | 03 | COMP SHNGL 100 |
| Interior Wall | 05 | DRYWALL 100 |
| Interior Floo | 09 | PINE WOOD 50 |
| Interior Floo | 14 | CARPET 50 |
| Heating Type | 04 | AIR DUCTED 100 |
| Air Condition | 03 | CENTRAL 100 |
| Bedrooms | | 3 100 |
| Bathrooms | | 2 100 |
| Story Height | | 0 100 |
| Stories | 1. | 1. 100 |
| Units | | 0 100 |
| Quality | 08 | FAIR |
| DOR CODE | 0100 | SINGLE FAMILY |
| MAP NUM | 4 | MKT AREA 10 |
| NEIGHBORHOOD/LOC | 12.00 | 1.20/ |
| AREA TYPE | TOTAL GROSS AREA | PCT OF BASE |
| BAS | 1,120 | 100 |
| FGR | 462 | 50 |
| FOP | 60 | 30 |
| PTO | 80 | 5 |
| TOTALS | 1,722 | |

| MARKET ADJUSTMENTS | | | | | | | | | | | | |
|--------------------|------------|-----------|-------------------|----------------|----------------|-----|-----------------|------|------|------|--------|--|
| TYPE | MDL | EFF. AREA | TOT ADJ PTS | EFF. BASE RATE | REPL. COST NEW | AYB | EYB | ECON | FNCT | NORM | % COND | |
| 1 | SINGLE FAM | 100% | - 2009 | | | | | | | | | |
| | | | Heated Area: 1120 | | | | HX Base Yr 2009 | | | | | |



| WAKULLA COUNTY PROPERTY | | | |
|--|-------------------|----------|-------------|
| VALUATION SUMMARY | | | PAGE 1 of 1 |
| VALUATION BY | | STANDARD | |
| Tax Group: 3 | Tax Dist: | | |
| BUILDING MARKET VALUE | 140,307 | | |
| TOTAL MARKET OB/XF VALUE | 2,986 | | |
| TOTAL LAND VALUE - MARKET | 13,600 | | |
| TOTAL MARKET VALUE | 156,893 | | |
| SOH/AGL Deduction | 74,555 | | |
| ASSESSED VALUE | 82,338 | | |
| TOTAL EXEMPTION VALUE | 50,000 | | |
| BASE TAXABLE VALUE | 32,338 | | |
| TOTAL JUST VALUE | 156,893 | | |
| NCON VALUE | 0 | | |
| INCOME VALUE | | | |
| PREVIOUS YEAR MKT VALUE | 143,400 | | |
| 5 YR PRCL CH, N/C | | | |
| 5 YR PRCL CH, PU FNDN & FRME, PU XFOB LN 5 | | | |
| CHG STREET NAME | | | |
| ADD HX FOR 2009 PH#926-3227 | | | |
| PERMIT NUM | DESCRIPTION | AMT | ISSUED |
| OB24-000570 | RE-ROOF/SHINGLES- | | 08/09/2024 |
| 20000365 | MECHANICAL | 0 | 08/12/2020 |
| 2006659 | SFD | 0 | 09/28/2006 |

| SALES DATA | | | | | | |
|--------------------------------|-----------|-----------|-------|-------|--------|------------|
| OFF RECORD Number | DATE | TYPE INST | Q / U | V / I | RSN CD | SALE PRICE |
| 0762/0616 | 7/22/2008 | WD | Q | I | | 126,000 |
| GRANTOR: RUPERT JERRY & KATHY | | | | | | |
| GRANTEE: GREGIE RONALD C. SR | | | | | | |
| 0761/0847 | 7/22/2008 | CR | Q | I | 01 | 100 |
| GRANTOR: FOUNTIAN HOMES & CONT | | | | | | |
| GRANTEE: RUPERT JERRY & KATH | | | | | | |

| EXTRA FEATURES | | | | | | | | | | | | |
|----------------|------------|-------------|---------|----|----|--------|----|----------|----------------|-----------|---------|-------------|
| L N | OB/XF CODE | DESCRIPTION | BLD CAP | L | W | UNITS | UT | Adj R | ADJ UNIT PRICE | ORIG COND | YEAR ON | YEAR ACTUAL |
| 1 | 0210 | CONCRETE D | 0 100 | 34 | 16 | 544.00 | SF | 6.00 | 6.00 | 100 | 2006 | 2006 |
| 2 | 0211 | CONCRETE W | 0 100 | 24 | 4 | 96.00 | SF | 6.00 | 6.00 | 100 | 2006 | 2006 |
| 3 | 0211 | CONCRETE W | 0 100 | 4 | 4 | 16.00 | SF | 6.00 | 6.00 | 100 | 2006 | 2006 |
| 4 | 0130 | FIRE PLACE | 0 100 | 0 | 0 | 1.00 | UT | 1,300.00 | 1,300.00 | 100 | 2006 | 2006 |
| 5 | 0955 | PRIVACY FE | 0 100 | 0 | 0 | 142.00 | LF | 15.00 | 15.00 | 100 | 2008 | 2008 |

| TOTAL OB/XF | | | | | | | | | | | | |
|-------------|--|--|--|--|--|--|--|--|--|--|--|--|
| 2,986 | | | | | | | | | | | | |

| BUILDING NOTES | | | | | | |
|--|--|--|--|--|--|--|
| BAS=[YR=2006] W7 PTO=[YR=2006] N8 W10 S8 E10\$ W25 S35 | | | | | | |
| FGR=[YR=2006] S21 E22 N21 W22\$ E22 FOP=[YR=2006] S6 E10 N6 W10\$ E10 N35\$. | | | | | | |

| LAND DESCRIPTION | | | | | | | | | | | | |
|------------------|----------|-----|----------------------|-----|-----|----------|-------|--------|-------------|-----------|-----|-----------|
| L N | USE CODE | CLS | LAND USE DESCRIPTION | CAP | R D | LOC ZONE | FRONT | DEPTH | TOT LND UTS | UNIT TYPE | D T | DPHT FACT |
| 1 | 000100 | C | SFR | 100 | | | 50.00 | 126.00 | 1.00 | LT | | 1.00 |

| TOTAL OB/XF | | | | | | | | | | | | |
|-------------|--|--|--|--|--|--|--|--|--|--|--|--|
| 2,986 | | | | | | | | | | | | |