

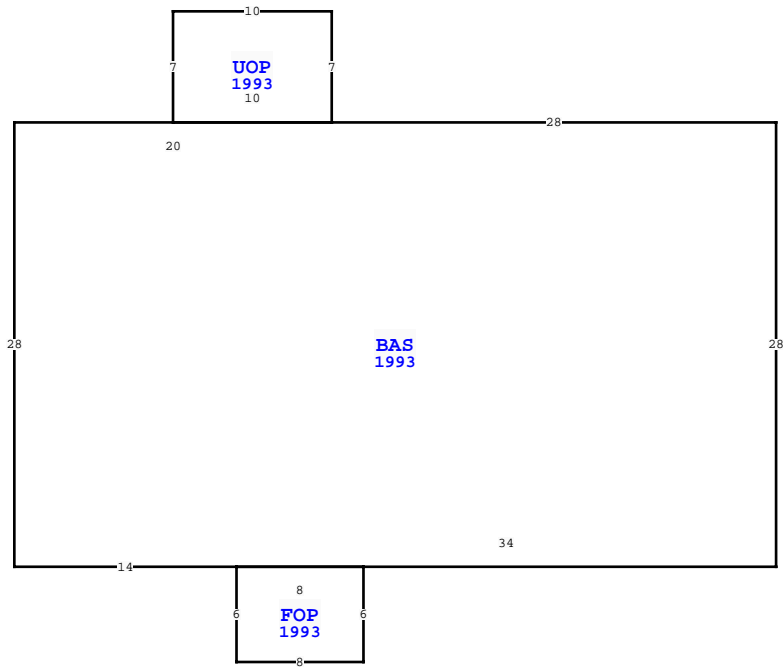

ELEMENT		CD	CONSTRUCTION		
Foundation	03		CONCR	STEM 100	
Frame	02		WOOD	FRAME 100	
Exterior Wall	17		CB	STUCCO 100	
Roof Structur	03		GABLE/HIP	100	
Roof Cover	03		COMP	SHNGL 100	
Interior Wall	05		DRYWALL	100	
Interior Floo	10		LAMINATED	100	
Heating Type	01		NONE	100	
Air Condition	03		CENTRAL	100	
Bedrooms			3	100	
Bathrooms			2	100	
Story Height			0	100	
Stories	1.		1.	100	
Units			0	100	
Quality	08		FAIR		
DOR CODE	0100		SINGLE	FAMILY	
MAP NUM	4		MKT AREA	10	
NEIGHBORHOOD/LOC	12.00		1.20/		
AREA TYPE	TOTAL GROSS AREA	PCT OF BASE	YEAR	TOT ADJ AREA	SUBAREA MARKET VALUE
BAS	1,344	100	1993	1,344	78,876
FOP	48	30	1993	14	822
UOP	70	20	1993	14	822
TOTALS	1,462			1,372	80,519

MARKET ADJUSTMENTS											
TYPE	MDL	EFF. AREA	TOT ADJ PTS	EFF. BASE RATE	REPL. COST NEW	AYB	EYB	ECON	FNCT	NORM	% COND
1	SINGLE FAM	100%	- 1990		154,844	1971	1975	0	0	48.00	52.00
Heated Area: 1344 HX Base Yr 1990											



WAKULLA COUNTY PROPERTY		PAGE 1 of 1	3
VALUATION SUMMARY			
VALUATION BY			STANDARD
Tax Group: 3	Tax Dist:		
BUILDING MARKET VALUE			80,519
TOTAL MARKET OB/XF VALUE			4,007
TOTAL LAND VALUE - MARKET			40,800
TOTAL MARKET VALUE			125,326
SOH/AGL Deduction			66,267
ASSESSED VALUE			59,059
TOTAL EXEMPTION VALUE	HA HAB 13	59,059	
BASE TAXABLE VALUE			0
TOTAL JUST VALUE			125,326
NCON VALUE			0
INCOME VALUE			
PREVIOUS YEAR MKT VALUE			109,085

PERMIT NUM	DESCRIPTION	AMT	ISSUED
21000315	RE-ROOF-CO	0	06/11/2021
028007	COMCAST	0	07/23/2001
023694	SHIP	0	06/11/1998

SALES DATA						
OFF RECORD Number	DATE	TYPE INST	Q U	V I	RSN CD	SALE PRICE
0098/0913	10/01/1983	QC	U	I		100

BLD DATE		10/29/2019	RTLC	LGL DATE	
XF DATE	10/29/2019	RTLC		03/09/2008	JBHC
INC DATE					

BUILDING NOTES	
BAS=[YR=1993] W28 UOP=[YR=1993] N7 W10 S7 E10\$ W20 S28 E14 FOP=[YR=1993] S6 E8 N6 W8\$ E34 N28\$.	

EXTRA FEATURES																
L N	OB/XF CODE	DESCRIPTION	BLD CAP	L	W	UNITS	UT	Adj R	ADJ UNIT PRICE	ORIG COND	YEAR ON	YEAR ACTUAL	Q	% COND	OB/XF MKT VALUE	NOTES
1	0625	PORT WD UT	0 100	22	16	352.00	SF	6.00	6.00	100	1983	1983	3	20	422	
2	0140	FIRE PLACE	0 100	0	0	1.00	UT	1,900.00	1,900.00	100	1971	1971	3	20	380	
3	0630	METAL UTL	0 100	10	19	190.00	SF	8.00	8.00	100	1980	1980	3	20	304	
4	0940	OPEN SHED	0 100	10	22	220.00	SF	4.00	4.00	100	2001	2001	3	20	176	
5	0940	OPEN SHED	0 100	12	18	216.00	SF	4.00	4.00	100	2001	2001	3	20	173	
6	0055	PORTABLE C	0 100	20	20	400.00	SF	3.00	3.00	100	1998	1998	3	20	240	
7	0770	PUMP HOUSE	0 100	5	6	30.00	SF	5.00	5.00	100	2007	2007	3	40	60	
8	0955	PRIVACY FE	0 100	0	0	82.00	LF	15.00	15.00	100	2007	2007	3	40	492	
9	0210	CONCRETE D	0 100	20	20	400.00	SF	6.00	6.00	100	1998	1998	3	20	480	
10	0700	PORT BLDG	0 100	10	20	200.00	SF	8.00	8.00	100	2013	2013	3	80	1,280	

LAND DESCRIPTION		TOTAL OB/XF																						
L N	USE CODE	CLS	LAND USE DESCRIPTION	CAP	R D	LOC ZONE	FRONT	DEPTH	TOT LND UTS	UNIT TYPE	D T	DPH FACT	% COND	TOT ADJ	UNIT PRICE	ADJ UNIT PRICE	LAND VALUE	OTHER ADJUSTMENTS AND NOTES	YEAR	DENSITY	DECL	FRZ	YR	CONSRV
1	000100	C	SFR	100			98.00	85.00	3.00	LT		1.00	1.00	1.00	13,600.00	13,600.00	40,800							