

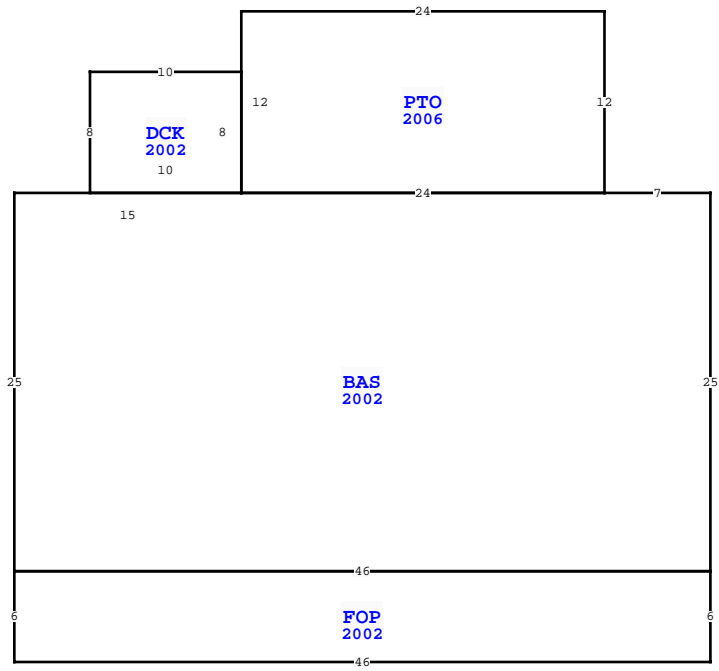

| BUILDING CHARACTERISTICS | | CONSTRUCTION | |
|--------------------------|------------------|---------------|------|
| ELEMENT | CD | | |
| Foundation | 02 | CONCR SLAB | 100 |
| Frame | 02 | WOOD FRAME | 100 |
| Exterior Wall | 30 | VINYL | 100 |
| Roof Structur | 03 | GABLE/HIP | 100 |
| Roof Cover | 03 | COMP SHNGL | 100 |
| Interior Wall | 05 | DRYWALL | 100 |
| Interior Floor | 08 | SHT VINYL | 50 |
| Interior Floor | 14 | CARPET | 50 |
| Heating Type | 04 | AIR DUCTED | 100 |
| Air Condition | 03 | CENTRAL | 100 |
| Bedrooms | | 3 | 100 |
| Bathrooms | | 2 | 100 |
| Story Height | | 0 | 100 |
| Stories | 1. | 1. | 100 |
| Units | | 0 | 100 |
| Quality | 08 | FAIR | |
| DOR CODE | 0100 | SINGLE FAMILY | |
| MAP NUM | 4 | MKT AREA | 10 |
| NEIGHBORHOOD/LOC | 12.00 | 1.20/ | |
| AREA TYPE | TOTAL GROSS AREA | PCT OF BASE | YEAR |
| BAS | 1,150 | 100 | 2002 |
| DCK | 80 | 10 | 2002 |
| FOP | 276 | 30 | 2002 |
| PTO | 288 | 5 | 2006 |
| TOTALS | 1,794 | | |

| MARKET ADJUSTMENTS | | | | | | | | | | | | |
|--------------------|------------|-----------|-------------|-------------------|----------------|-----|-----------------|------|------|------|--------|--|
| TYPE | MDL | EFF. AREA | TOT ADJ PTS | EFF. BASE RATE | REPL. COST NEW | AYB | EYB | ECON | FNCT | NORM | % COND | |
| 1 | SINGLE FAM | 100% | - 2021 | | | | | | | | | |
| | | | | Heated Area: 1150 | | | HX Base Yr 2021 | | | | | |



| WAKULLA COUNTY PROPERTY | | | |
|--|------------------|------------|--------------------|
| VALUATION SUMMARY | | | PAGE 1 of 1 |
| VALUATION BY | | STANDARD | |
| Tax Group: 3 | Tax Dist: | | |
| BUILDING MARKET VALUE | | | 112,916 |
| TOTAL MARKET OB/XF VALUE | | | 1,133 |
| TOTAL LAND VALUE - MARKET | | | 27,200 |
| TOTAL MARKET VALUE | | | 141,249 |
| SOH/AGL Deduction | | | 34,575 |
| ASSESSED VALUE | | | 106,674 |
| TOTAL EXEMPTION VALUE | HX HB | 50,000 | |
| BASE TAXABLE VALUE | | | 56,674 |
| TOTAL JUST VALUE | | | 141,249 |
| NCON VALUE | | | 0 |
| INCOME VALUE | | | |
| PREVIOUS YEAR MKT VALUE | | | 125,216 |
| 2021 HX APPLIED PRESTIA | | | |
| 5 YR PRCL CK, N/C | | | |
| 5 YR PRCL CH, PU FNDN | | | |
| ADD HX FOR 2011 N | | | |
| PERMIT NUM | DESCRIPTION | AMT | ISSUED |
| 19000261 | ELECTRIC RPRS-CO | 0 | 03/04/2019 |
| 19000103 | MECH-CO | 0 | 02/20/2019 |
| 18001379 | REROOF-CO | 0 | 12/12/2018 |
| 028404 | SFD | 0 | 11/26/2001 |
| SALES DATA | | | |
| OFF RECORD Number | DATE | TYPE INST | Q / V / I / RSN CD |
| 1177/0619 | 10/23/2020 | WD Q | I 01 |
| | | SALE PRICE | 124,000 |
| GRANTOR: BENTLEY THOMAS A | | | |
| GRANTEE: PRESTIA JULIANA | | | |
| 0827/0027 | 4/22/2010 | WD Q | I 01 |
| | | SALE PRICE | 75,000 |
| GRANTOR: MAREK JUDITH D | | | |
| GRANTEE: BENTLEY THOMAS A | | | |
| BUILDING NOTES | | | |
| BUILDING DIMENSIONS | | | |
| BAS=[YR=2002] W7 PTO=[YR=2006] N12 W24 S12 E24\$ W24 | | | |
| DCK=[YR=2002] N8 W10 S8 E10\$ W15 S25 FOP=[YR=2002] S6 E46 | | | |
| N6 W46\$ E46 N25\$. | | | |

| EXTRA FEATURES | | | | | | | | | | | | |
|----------------|------------|-------------|---------|-----|----|-------|----|-------|----------------|-----------|---------|-------------|
| L N | OB/XF CODE | DESCRIPTION | BLD CAP | L | W | UNITS | UT | Adj R | ADJ UNIT PRICE | ORIG COND | YEAR ON | YEAR ACTUAL |
| 1 | 0700 | PORT BLDG | 0 | 100 | 12 | 20 | | | 8.00 | 100 | 2002 | 2002 |
| | | | | | | | | | | 3 | 59 | 1,133 |

| LAND DESCRIPTION | | | | | | | | | | | | | TOTAL OB/XF | | | | | | | | | | | | |
|------------------|----------|-----|----------------------|-----|-----|----------|-------|--------|-------------|-----------|---|----------|-------------|---------|------------|----------------|------------|-----------------------------|------|---------|------|-----|----|--------|--|
| L N | USE CODE | CLS | LAND USE DESCRIPTION | CAP | R D | LOC ZONE | FRONT | DEPTH | TOT LND UTS | UNIT TYPE | D | DPH FACT | % COND | TOT ADJ | UNIT PRICE | ADJ UNIT PRICE | LAND VALUE | OTHER ADJUSTMENTS AND NOTES | YEAR | DENSITY | DECL | FRZ | YR | CONSRV | |
| 1 | 000100 | C | SFR | 100 | | | 50.00 | 103.00 | 2.00 | LT | | 1.00 | 1.00 | 1.00 | 13,600.00 | 13,600.00 | 27,200 | | | | | | | | |