

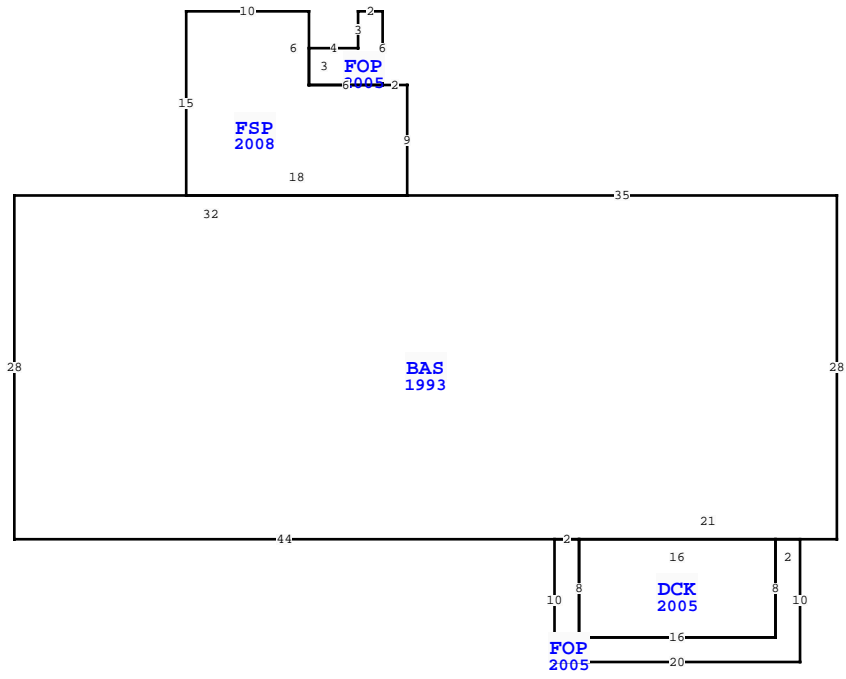

ELEMENT		BUILDING CHARACTERISTICS		CONSTRUCTION	
ELEMENT	CD	CD	CONSTRUCTION	CD	CONSTRUCTION
Foundation	01	WOOD FRAME	100		
Frame	02	WOOD FRAME	100		
Exterior Wall	26	AL SIDING	100		
Roof Structur	03	GABLE/HIP	100		
Roof Cover	12	MODULAR MT	100		
Interior Wall	04	PLYWOOD	100		
Interior Floo	08	SHT VINYL	100		
Heating Type	04	AIR DUCTED	100		
Air Condition	03	CENTRAL	100		
Bedrooms		4	100		
Bathrooms		2	100		
Stories	1.1	1.100			
Class	00	N/A	100		
Units		0	100		
Quality	08	FAIR			
DOR CODE	0200	MOBILE HOME			
MAP NUM	4	MKT AREA	10		
NEIGHBORHOOD/LOC	000	1.00/			
AREA TYPE	TOTAL GROSS AREA	PCT OF BASE	YEAR	TOT ADJ AREA	SUBAREA MARKET VALUE
BAS	1,876	100	1993	1,876	52,003
DCK	128	10	2005	13	360
FOP	24	35	2005	8	222
FOP	72	35	2005	25	693
FSP	222	60	2008	133	3,687
TOTALS	2,322			2,055	56,965

MARKET ADJUSTMENTS											
TYPE	MDL	EFF. AREA	TOT ADJ PTS	EFF. BASE RATE	REPL. COST NEW	AYB	EYB	ECON	FNCT	NORM	% COND
1	MOBILE HOM	50%	- 2024		142,412	1984	1984	0	0	60.00	40.00
Heated Area: 1876 HX Base Yr 2024											



WAKULLA COUNTY PROPERTY			
VALUATION SUMMARY			PAGE 1 of 2
VALUATION BY		STANDARD	
Tax Group: 3		Tax Dist:	
BUILDING MARKET VALUE		106,369	
TOTAL MARKET OB/XF VALUE		17,290	
TOTAL LAND VALUE - MARKET		30,000	
TOTAL MARKET VALUE		153,659	
SOH/AGL Deduction		0	
ASSESSED VALUE		153,659	
TOTAL EXEMPTION VALUE		50,000	
BASE TAXABLE VALUE		103,659	
TOTAL JUST VALUE		153,659	
NCON VALUE		8,900	
INCOME VALUE			
PREVIOUS YEAR MKT VALUE		119,890	
XFOB 0157 PU BY PRMT NO INSP LW			
CHGED OWNERS NAMES BASED ON OR 1070 P 526, AND DC			
DC OR 1303 P 264 WILLIAM USHERWOOD			
INCR EYB 1995-1999 ROOF OVER CC 8-2022			
PERMIT NUM	DESCRIPTION	AMT	ISSUED
22000783	ROOF OVER-CC	0	08/02/2022
OBN22-00005	GENERATOR-CC		07/08/2022
20209	N/A	0	10/19/1995

SALES DATA						
OFF RECORD Number	DATE	TYPE INST	Q / U	V / I	RSN CD	SALE PRICE
1070/0526	4/12/2018	QC	U	I	30	100
GRANTOR: USHERWOOD WILLIAM C S						
GRANTEE: USHERWOOD WILLIAM C						
0849/0894	4/05/2011	WD	U	I	30	100
GRANTOR: USHERWOOD WILLIAM C &						
GRANTEE: USHERWOOD WILLIAM C						

EXTRA FEATURES																
L N	OB/XF CODE	DESCRIPTION	BLD CAP	L	W	UNITS	UT	Adj R	ADJ UNIT PRICE	ORIG COND	YEAR ON	YEAR ACTUAL	Q	% COND	OB/XF MKT VALUE	NOTES
1	0901	MH STORAGE	0 50	46	8	1.00	UT	2.00	2.00	100	1963	1963	3	100	1,000	
2	0940	OPEN SHED	0 50	20	14	280.00	SF	4.00	4.00	100	1982	1982	3	20	224	
3	0940	OPEN SHED	0 50	36	16	576.00	SF	4.00	4.00	100	1982	1982	3	20	461	
4	0940	OPEN SHED	0 50	10	10	100.00	SF	4.00	4.00	100	1982	1982	3	20	80	
5	0620	WOOD UTL B	0 50	32	20	640.00	SF	6.00	6.00	100	1982	1982	3	20	768	
6	0700	PORT BLDG	0 50	10	14	140.00	SF	8.00	8.00	100	1982	1982	3	20	224	
7	0050	CARPORT UN	0 50	12	14	168.00	SF	9.00	9.00	100	1982	1982	3	20	302	
8	0630	METAL UTL	0 50	28	8	224.00	SF	8.00	8.00	100	1982	1982	3	20	358	
9	0770	PUMP HOUSE	0 50	4	5	20.00	SF	5.00	5.00	100	1982	1982	3	0	0	
10	0130	FIRE PLACE	0 50	0	0	1.00	UT	1,300.00	1,300.00	100	1984	1984	3	30	390	

TOTAL OB/XF											
3,807											
BLD DATE	04/30/2019	FRJT	LGL DATE	04/30/2019	FRJT						
XF DATE	04/30/2019	FRJT	LAND DATE	04/30/2019	FRJT						
INC DATE			AG DATE								

BUILDING NOTES											
BAS=[YR=1993] W35 FSP=[YR=2008] N9 W2 FOP=[YR=2005] N6 W2 S3 W4 S3 E6\$ W6 N6 W10 S15 E18\$ W32 S28 E44 FOP=[YR=2005] S10 E20 N10 W2 S8 W16 N8 W2\$ E2 DCK=[YR=2005] S8 E16 N8 W16\$ E21 N28\$.											

LAND DESCRIPTION																								
L N	USE CODE	CLS	LAND USE DESCRIPTION	CAP	R D	LOC ZONE	FRONT	DEPTH	TOT LND UTS	UNIT TYPE	D T	DPH FACT	% COND	TOT ADJ	UNIT PRICE	ADJ UNIT PRICE	LAND VALUE	OTHER ADJUSTMENTS AND NOTES	YEAR	DENSITY	DECL	FRZ	YR	CONSRV
1	000201	C	MH	50			0.00	0.00	4.00	AC		1.00	1.00	1.00	7,500.00	7,500.00	30,000							

REVIEW DATE 10/13/2023 BY FRLW																													
Total Acres: 4.00						Total Land Value: 30,000						Market: 0						Agricultural: 0						Common: 30,000					

