

| BUILDING CHARACTERISTICS |                  | CONSTRUCTION |      |
|--------------------------|------------------|--------------|------|
| ELEMENT                  | CD               |              |      |
| Foundation               | 01               | WOOD FRAME   | 100  |
| Frame                    | 02               | WOOD FRAME   | 100  |
| Exterior Wall            | 30               | VINYL        | 100  |
| Roof Structur            | 03               | GABLE/HIP    | 100  |
| Roof Cover               | 03               | COMP SHNGL   | 100  |
| Interior Wall            | 05               | DRYWALL      | 100  |
| Interior Floo            | 08               | SHT VINYL    | 50   |
| Interior Floo            | 14               | CARPET       | 50   |
| Heating Type             | 03               | FORCED AIR   | 100  |
| Air Condition            | 02               | WINDOW       | 100  |
| Bedrooms                 |                  | 3            | 100  |
| Bathrooms                |                  | 2            | 100  |
| Stories                  | 1.               | 1.           | 100  |
| Class                    | 00               | N/A          | 100  |
| Units                    |                  | 0            | 100  |
| Quality                  | 01               | MINIMUM      |      |
| DOR CODE                 | 0200             | MOBILE HOME  |      |
| MAP NUM                  | 4                | MKT AREA     | 10   |
| NEIGHBORHOOD/LOC         | 000              | 1.00/        |      |
| AREA TYPE                | TOTAL GROSS AREA | PCT OF BASE  | YEAR |
| BAS                      | 1,248            | 100          | 1999 |
| DCK                      | 96               | 10           | 1999 |
| UOP                      | 96               | 25           | 1999 |
| TOTALS                   | 1,440            |              |      |

| MARKET ADJUSTMENTS |            |             |                   |                |                |                 |      |      |      |       |        |
|--------------------|------------|-------------|-------------------|----------------|----------------|-----------------|------|------|------|-------|--------|
| TYPE               | MDL        | EFF. AREA   | TOT ADJ PTS       | EFF. BASE RATE | REPL. COST NEW | AYB             | EYB  | ECON | FNCT | NORM  | % COND |
| 1                  | MOBILE HOM | 100% - 2018 |                   | 38.31          | 49,113         | 1999            | 1999 | 0    | 0    | 44.00 | 56.00  |
|                    |            |             | Heated Area: 1248 |                |                | HX Base Yr 2018 |      |      |      |       |        |

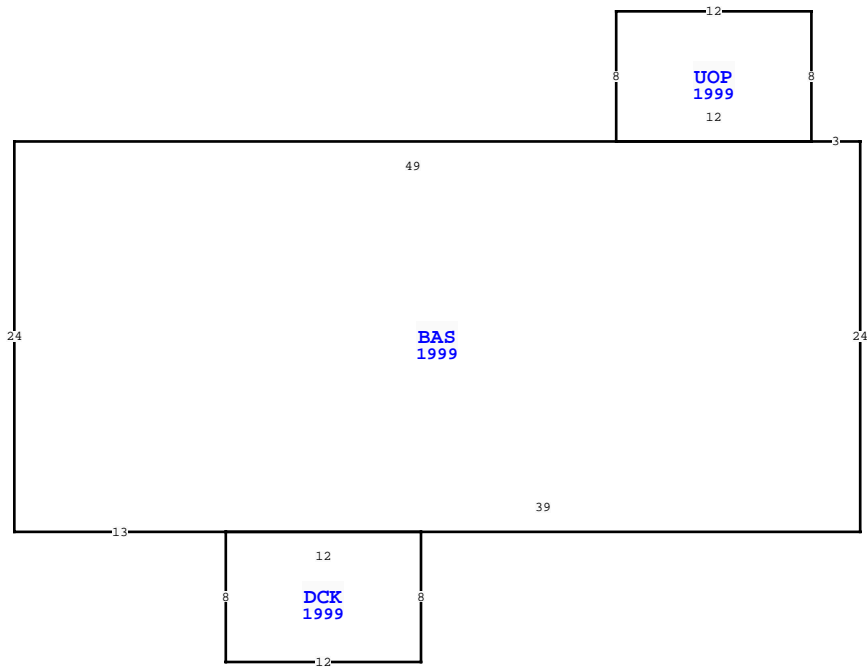

| WAKULLA COUNTY PROPERTY                      |             |              |             |
|--|-------------|--------------|-------------|
| VALUATION SUMMARY                            |             |              | PAGE 1 of 1 |
| VALUATION BY                                 |             | STANDARD     |             |
| Tax Group: 3                                 |             | Tax Dist:    |             |
| BUILDING MARKET VALUE                        |             | 27,503       |             |
| TOTAL MARKET OB/XF VALUE                     |             | 5,103        |             |
| TOTAL LAND VALUE - MARKET                    |             | 2,150        |             |
| TOTAL MARKET VALUE                           |             | 34,756       |             |
| SOH/AGL Deduction                            |             | 4,619        |             |
| ASSESSED VALUE                               |             | 30,137       |             |
| TOTAL EXEMPTION VALUE                        |             | HX HB 25,000 |             |
| BASE TAXABLE VALUE                           |             | 5,137        |             |
| TOTAL JUST VALUE                             |             | 34,756       |             |
| NCON VALUE                                   |             | 0            |             |
| INCOME VALUE                                 |             |              |             |
| PREVIOUS YEAR MKT VALUE                      |             | 29,259       |             |
| 5YR PRCL CK NC                               |             |              |             |
| ADD HX FOR 2018                              |             |              |             |
| & A/C, PU XFOB LN 3-5, DEL XFOB LN 6         |             |              |             |
| 5 YR PRCL CH, CHG BUSE TO LIVABLE, CORR HTTP |             |              |             |
| PERMIT NUM                                   | DESCRIPTION | AMT          | ISSUED      |
| 17000284                                     | SHED-CO\    | 0            | 02/28/2017  |
| 15000084                                     | RE-ROOF     | 0            | 02/20/2015  |
| 025378                                       | MECH        | 0            | 06/30/1999  |
| 025357                                       | DW MH       | 0            | 06/25/1999  |

| SALES DATA                     |            |           |     |     |        |            |
|--------------------------------|------------|-----------|-----|-----|--------|------------|
| OFF RECORD Number              | DATE       | TYPE INST | Q U | V I | RSN CD | SALE PRICE |
| 1029/0001                      | 3/16/2017  | QC        | U   | I   | 11     | 100        |
| GRANTOR: SMITH JERRY D 1/3 INT |            |           |     |     |        |            |
| GRANTEE: BRADY STEVEN MICHAEL  |            |           |     |     |        |            |
| 0956/0734                      | 11/24/2014 | WD        | U   | I   | 12     | 22,000     |
| GRANTOR: GREEN TREE SERVICING  |            |           |     |     |        |            |
| GRANTEE: SMITH JERRY D, BRADY  |            |           |     |     |        |            |

| EXTRA FEATURES |            |             |         |     |    |        |    |          |                |           |         |
|----------------|------------|-------------|---------|-----|----|--------|----|----------|----------------|-----------|---------|
| L N            | OB/XF CODE | DESCRIPTION | BLD CAP | L   | W  | UNITS  | UT | Adj R    | ADJ UNIT PRICE | ORIG COND | YEAR ON |
| 1              | 0130       | FIRE PLACE  | 0       | 100 | 0  | 1.00   | UT | 1,300.00 | 1,300.00       | 100       | 1999    |
| 2              | 0955       | PRIVACY FE  | 0       | 100 | 0  | 100.00 | LF | 15.00    | 15.00          | 100       | 2000    |
| 3              | 0210       | CONCRETE D  | 0       | 100 | 8  | 144.00 | SF | 6.00     | 6.00           | 100       | 2014    |
| 4              | 0800       | FINISHED S  | 0       | 100 | 8  | 160.00 | SF | 23.00    | 23.00          | 100       | 2014    |
| 5              | 0625       | PORT WD UT  | 0       | 100 | 10 | 180.00 | SF | 6.00     | 6.00           | 100       | 2017    |
| TOTALS         |            |             |         |     |    |        |    |          |                |           |         |

| LAND DESCRIPTION |          |     |                      |     |     |          |       |       |             |           |     | TOTAL OB/XF |        |         |            |                |            |                             |      |         |      |     |    |        |
|------------------|----------|-----|----------------------|-----|-----|----------|-------|-------|-------------|-----------|-----|-------------|--------|---------|------------|----------------|------------|-----------------------------|------|---------|------|-----|----|--------|
| L N              | USE CODE | CLS | LAND USE DESCRIPTION | CAP | R D | LOC ZONE | FRONT | DEPTH | TOT LND UTS | UNIT TYPE | D T | DPTH FACT   | % COND | TOT ADJ | UNIT PRICE | ADJ UNIT PRICE | LAND VALUE | OTHER ADJUSTMENTS AND NOTES | YEAR | DENSITY | DECL | FRZ | YR | CONSRV |
| 1                | 000201   | C   | MH                   | 100 |     |          | 0.00  | 0.00  | 0.43        | AC        |     | 1.00        | 1.00   | 1.00    | 5,000.00   | 5,000.00       | 2,150      |                             |      |         |      |     |    |        |