

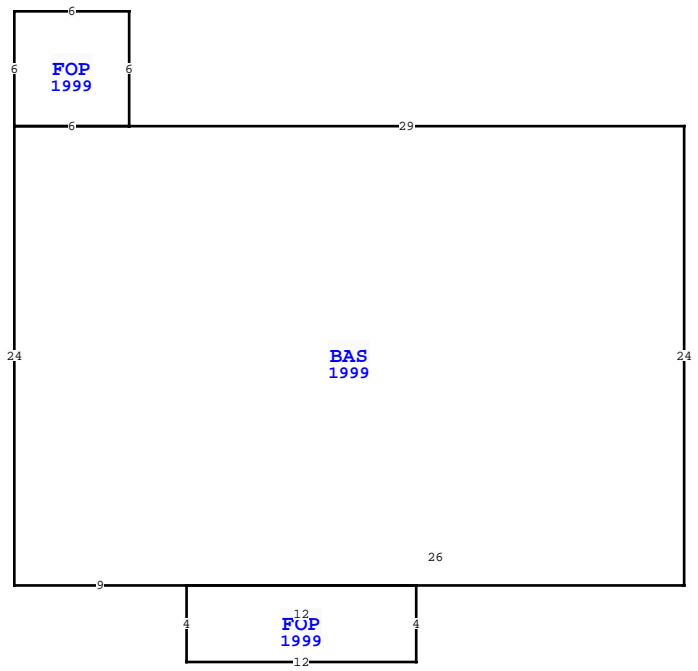

| ELEMENT | | CD | CONSTRUCTION |
|------------------|------------------|---------------|--------------|
| Foundation | 02 | CONCR | SLAB 100 |
| Frame | 02 | WOOD | FRAME 100 |
| Exterior Wall | 05 | HARDIE | BRD 100 |
| Roof Structur | 03 | GABLE/HIP | 100 |
| Roof Cover | 03 | COMP SHNGL | 100 |
| Interior Wall | 05 | DRYWALL | 100 |
| Interior Floo | 08 | SHT VINYL | 50 |
| Interior Floo | 14 | CARPET | 50 |
| Heating Type | 04 | AIR DUCTED | 100 |
| Air Condition | 03 | CENTRAL | 100 |
| Bedrooms | | | 2 100 |
| Bathrooms | | | 1 100 |
| Story Height | | | 0 100 |
| Stories | 1. | | 1. 100 |
| Units | | | 0 100 |
| Quality | 03 | AVERAGE | |
| DOR CODE | 0100 | SINGLE FAMILY | |
| MAP NUM | 4 | MKT AREA | 10 |
| NEIGHBORHOOD/LOC | 10.00 | 1.20/ | |
| AREA TYPE | TOTAL GROSS AREA | PCT OF BASE | YEAR |
| BAS | 840 | 100 | 1999 |
| FOP | 36 | 30 | 1999 |
| FOP | 48 | 30 | 1999 |
| TOTALS | 924 | | |

| MARKET ADJUSTMENTS | | | | | | | | | | | | | |
|--------------------|------------|-----------|-------------|----------------|------------------|-----|-----|------|------|------|--------------|--|--|
| TYPE | MDL | EFF. AREA | TOT ADJ PTS | EFF. BASE RATE | REPL. COST NEW | AYB | EYB | ECON | FNCT | NORM | % COND | | |
| 1 | SINGLE FAM | 100% | - 2004 | | Heated Area: 840 | | | | | HX | Base Yr 2004 | | |



| WAKULLA COUNTY PROPERTY | | | |
|--|-------------------|--------|-------------|
| VALUATION SUMMARY | | | PAGE 1 of 1 |
| VALUATION BY | | | STANDARD |
| Tax Group: 3 | Tax Dist: | | |
| BUILDING MARKET VALUE | | | 96,943 |
| TOTAL MARKET OB/XF VALUE | | | 1,102 |
| TOTAL LAND VALUE - MARKET | | | 22,950 |
| TOTAL MARKET VALUE | | | 120,995 |
| SOH/AGL Deduction | | | 70,752 |
| ASSESSED VALUE | | | 50,243 |
| TOTAL EXEMPTION VALUE | HX HB | 25,243 | |
| BASE TAXABLE VALUE | | | 25,000 |
| TOTAL JUST VALUE | | | 120,995 |
| NCON VALUE | | | 0 |
| INCOME VALUE | | | |
| PREVIOUS YEAR MKT VALUE | | | 89,542 |
| FR 5YR CK 3/1/23; REROOF EYB+4 2005; PU XFOB | | | |
| HVAC-CC B23-191 INCR EYB 1999-2001 | | | |
| 5 YR PRCL CK, N/C | | | |
| 1, PU XFOB LN 2-3 | | | |
| PERMIT NUM | DESCRIPTION | AMT | ISSUED |
| B23-000191 | HVAC CHANGE OUT-C | | 03/07/2023 |
| 19001502 | REROOF-CO | 0 | 11/21/2019 |
| 025243 | SFD | 0 | 06/07/1999 |

| SALES DATA | | | | | | |
|------------------------------|------------|-----------|-----|-----|--------|------------|
| OFF RECORD Number | DATE | TYPE INST | Q U | V I | RSN CD | SALE PRICE |
| 1295/0879 | 12/20/2022 | QC | U | I | 11 | 100 |
| GRANTOR: POPE HENRY PASCO | | | | | | |
| GRANTEE: POPE HENRY PASCO & | | | | | | |
| 1293/0888 | 12/09/2022 | QC | U | I | 11 | 100 |
| GRANTOR: POPE HENRY PASCO | | | | | | |
| GRANTEE: POPE SHANNON NICOLE | | | | | | |

| EXTRA FEATURES | | | | | | | | | | | | | | | | |
|----------------|------------|-------------|---------|-----|----|--------|----|-------|----------------|-----------|---------|-------------|----|--------|-----------------|-------|
| L N | OB/XF CODE | DESCRIPTION | BLD CAP | L | W | UNITS | UT | Adj R | ADJ UNIT PRICE | ORIG COND | YEAR ON | YEAR ACTUAL | Q | % COND | OB/XF MKT VALUE | NOTES |
| 1 | 0955 | PRIVACY FE | 0 | 100 | 0 | 360.00 | LF | 15.00 | 15.00 | 100 | 2000 | 2000 | 3 | 0 | 0 | |
| 2 | 0955 | PRIVACY FE | 0 | 100 | 0 | 48.00 | LF | 15.00 | 15.00 | 100 | 2010 | 2010 | 3 | 60 | 432 | |
| 3 | 0055 | PORTABLE C | 0 | 100 | 18 | 360.00 | SF | 3.00 | 3.00 | 100 | 2014 | 2014 | 3 | 62 | 670 | |
| 4 | 0625 | PORT WD UT | 0 | 100 | 10 | 140.00 | SF | 0.00 | 0.00 | 100 | 2024 | 2021 | AV | 93 | 0 | |

| | | | | |
|----------|------------|------|-----------|------------|
| BLD DATE | 10/01/2018 | RTJT | LGL DATE | |
| XF DATE | 10/01/2018 | RTJT | LAND DATE | 01/03/2018 |
| INC DATE | | | AG DATE | JBHC |

| BUILDING NOTES | |
|----------------|--|
| | |

| BUILDING DIMENSIONS | |
|---|--|
| BAS=[YR=1999] W29 FOP=[YR=1999] N6 W6 S6 E6\$ W6 S24 E9 | |
| FOP=[YR=1999] S4 E12 N4 W12\$ E26 N24\$. | |

| LAND DESCRIPTION | | | | | | | | | | | | | | TOTAL OB/XF | | | | | | | | | | |
|------------------|----------|-----|----------------------|-----|-----|----------|-------|--------|-------------|-----------|-----|-----------|--------|-------------|------------|----------------|------------|-----------------------------|------|---------|------|-----|----|--------|
| L N | USE CODE | CLS | LAND USE DESCRIPTION | CAP | R D | LOC ZONE | FRONT | DEPTH | TOT LND UTS | UNIT TYPE | D T | DPHT FACT | % COND | TOT ADJ | UNIT PRICE | ADJ UNIT PRICE | LAND VALUE | OTHER ADJUSTMENTS AND NOTES | YEAR | DENSITY | DECL | FRZ | YR | CONSRV |
| 1 | 000100 | C | SFR | 100 | | | 50.00 | 100.00 | 2.00 | LT | | 1.00 | 1.00 | 1.00 | 7,650.00 | 7,650.00 | 15,300 | | | | | | | |
| 2 | 000115 | C | SFR ACRES | 100 | | | 50.00 | 100.00 | 1.00 | LT | | 1.00 | 1.00 | 1.00 | 7,650.00 | 7,650.00 | 7,650 | | | | | | | |