

| BUILDING CHARACTERISTICS | | CONSTRUCTION | | | |
|--------------------------|------------------|--------------|------|--------------|----------------------|
| ELEMENT | CD | | | | |
| Foundation | 01 | WOOD FRAME | 100 | | |
| Frame | 02 | WOOD FRAME | 100 | | |
| Exterior Wall | 30 | VINYL | 100 | | |
| Roof Structur | 03 | GABLE/HIP | 100 | | |
| Roof Cover | 13 | GALVALUM | 100 | | |
| Interior Wall | 05 | DRYWALL | 100 | | |
| Interior Floo | 08 | SHT VINYL | 50 | | |
| Interior Floo | 14 | CARPET | 50 | | |
| Heating Type | 04 | AIR DUCTED | 100 | | |
| Air Condition | 03 | CENTRAL | 100 | | |
| Bedrooms | | 3 | 100 | | |
| Bathrooms | | 2 | 100 | | |
| Stories | 1. | 1. | 100 | | |
| Class | 00 | N/A | 100 | | |
| Units | | 0 | 100 | | |
| Quality | 03 | AVERAGE | | | |
| DOR CODE | 0200 | MOBILE HOME | | | |
| MAP NUM | 4 | MKT AREA | 08 | | |
| NEIGHBORHOOD/LOC | 000 | 1.00/ | | | |
| AREA TYPE | TOTAL GROSS AREA | PCT OF BASE | YEAR | TOT ADJ AREA | SUBAREA MARKET VALUE |
| BAS | 2,052 | 100 | 2001 | 2,052 | 102,502 |
| DCK | 192 | 10 | 2012 | 19 | 949 |
| UOP | 160 | 25 | 2012 | 40 | 1,998 |
| TOTALS | 2,404 | | | 2,111 | 105,449 |

| MARKET ADJUSTMENTS | | | | | | | | | | | |
|--------------------|------------|-----------|-------------|----------------|-------------------|-----|-----|------|------|-----------------|--------|
| TYPE | MDL | EFF. AREA | TOT ADJ PTS | EFF. BASE RATE | REPL. COST NEW | AYB | EYB | ECON | FNCT | NORM | % COND |
| 1 | MOBILE HOM | 100% | - 2002 | | Heated Area: 2052 | | | | | HX Base Yr 2002 | |

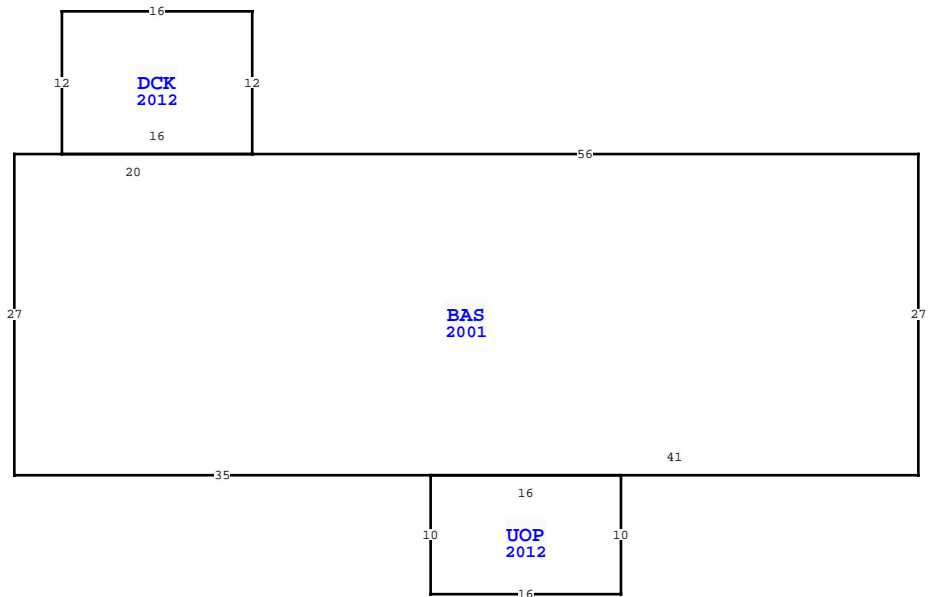

| WAKULLA COUNTY PROPERTY | | | | |
|---|--------------|--------------|----------------|------------|
| VALUATION SUMMARY | | | PAGE 1 of 1 | |
| VALUATION BY | | STANDARD | | |
| Tax Group: 3 | | Tax Dist: | | |
| BUILDING MARKET VALUE | | 105,449 | | |
| TOTAL MARKET OB/XF VALUE | | 1,304 | | |
| TOTAL LAND VALUE - MARKET | | 10,000 | | |
| TOTAL MARKET VALUE | | 116,753 | | |
| SOH/AGL Deduction | | 58,294 | | |
| ASSESSED VALUE | | 58,459 | | |
| TOTAL EXEMPTION VALUE | | HX HB 33,459 | | |
| BASE TAXABLE VALUE | | 25,000 | | |
| TOTAL JUST VALUE | | 116,753 | | |
| NCON VALUE | | 0 | | |
| INCOME VALUE | | | | |
| PREVIOUS YEAR MKT VALUE | | 79,046 | | |
| INCR EYB 2001-2005 ROOF OVER B23-665 CC 5/10/2023 | | | | |
| 5 YR PRCL CK, CHG QUAL, PU XFOB LN 2 | | | | |
| 5 YR PRCL CH, PU CORR TRAV, PU FNDN, CHG QUAL | | | | |
| PU NEW TRAV,FRM,XFOB#1,CAPPED; 5 YR PRCL CK | | | | |
| PERMIT NUM | DESCRIPTION | AMT | ISSUED | |
| B23-000665 | ROOF OVER-CC | 0 | 05/05/2023 | |
| 028318 | MECH | 0 | 10/22/2001 | |
| 028302 | MH | 0 | 10/17/2001 | |
| SALES DATA | | | | |
| OFF RECORD Number | DATE | TYPE INST | Q / V / RSN CD | SALE PRICE |
| 0382/0377 | 6/07/2000 | QC U V | | 100 |
| GRANTOR: | | | | |
| GRANTEE:MILLS ANNIE M | | | | |
| | | | | |
| BUILDING NOTES | | | | |
| | | | | |
| BUILDING DIMENSIONS | | | | |
| BAS=[YR=2001] W56 DCX=[YR=2012] N12 W16 S12 E16\$ W20 S27 E35 | | | | |
| UOP=[YR=2012] S10 E16 N10 W16\$ E41 N27\$. | | | | |

| EXTRA FEATURES | | | | | | | | | | | | | | | | |
|----------------|------------|-------------|---------|-----|---|-------|-------|-------|----------------|-----------|---------|-------------|---|--------|-----------------|-------|
| L N | OB/XF CODE | DESCRIPTION | BLD CAP | L | W | UNITS | UT | Adj R | ADJ UNIT PRICE | ORIG COND | YEAR ON | YEAR ACTUAL | Q | % COND | OB/XF MKT VALUE | NOTES |
| 1 | 0130 | FIRE PLACE | 0 | 100 | 0 | 0 | 1.00 | UT | 1,300.00 | 100 | 2001 | 2001 | 3 | 58 | 754 | |
| 2 | 0700 | PORT BLDG | 0 | 100 | 8 | 10 | 80.00 | SF | 8.00 | 100 | 2016 | 2016 | 3 | 86 | 550 | |

| LAND DESCRIPTION | | | | | | | | | | | | | | | | | | | | | | | | |
|------------------|----------|-----|----------------------|-----|-----|----------|-------|-------|-------------|-----------|-----|----------|--------|---------|------------|----------------|------------|-----------------------------|------|---------|------|-----|----|--------|
| L N | USE CODE | CLS | LAND USE DESCRIPTION | CAP | R D | LOC ZONE | FRONT | DEPTH | TOT LND UTS | UNIT TYPE | D T | DPH FACT | % COND | TOT ADJ | UNIT PRICE | ADJ UNIT PRICE | LAND VALUE | OTHER ADJUSTMENTS AND NOTES | YEAR | DENSITY | DECL | FRZ | YR | CONSRV |
| 1 | 000201 | C | MH | 100 | | | 0.00 | 0.00 | 1.00 | AC | | 1.00 | 1.00 | 1.00 | 10,000.00 | 10,000.00 | 10,000 | | | | | | | |