

LOT 49 HS P-23-1-M-16
 A PARCEL OF LAND IN N 1/2 OF
 WHAT LIES W OF ST RD 365

GIBSON DELTA SIZEMORE
 2946 SPRING CREEK HWY
 CRAWFORDVILLE, FL 32327

2024

00-00-049-000-09889-000

BUILDING CHARACTERISTICS		CONSTRUCTION	
ELEMENT	CD		
Foundation	01	WOOD FRAME	100
Frame	02	WOOD FRAME	100
Exterior Wall	01	MINIMUM	100
Roof Structur	03	GABLE/HIP	100
Roof Cover	03	COMP SHNGL	100
Interior Wall	04	PLYWOOD	100
Interior Floo	08	SHT VINYL	50
Interior Floo	14	CARPET	50
Heating Type	03	FORCED AIR	100
Air Condition	02	WINDOW	100
Bedrooms		1	100
Bathrooms		1	100
Stories	1.	1.	100
Class	00	N/A	100
Units		0	100
Quality	02	BELOW AVERAGE	
DOR CODE	0200	MOBILE HOME	
MAP NUM	4	MKT AREA	08
NEIGHBORHOOD/LOC	000	1.00/	
AREA TYPE	TOTAL GROSS AREA	PCT OF BASE	YEAR
BAS	72	100	1993
BAS	160	100	1993
BAS	684	100	1993
DCK	32	10	1993
DCK	460	10	2011
UCP	1,140	20	1993
UOP	90	25	1993
UOP	320	25	1993
TOTALS	2,958		

MARKET ADJUSTMENTS											
TYPE	MDL	EFF. AREA	TOT ADJ PTS	EFF. BASE RATE	REPL. COST NEW	AYB	EYB	ECON	FNCT	NORM	% COND
0200	02	1,295	67.6000	47.32	61,279	1968	1968	0	0	60.00	40.00
1 MOBILE HOM 0% - 2024 Heated Area: 916 HX Base Yr											

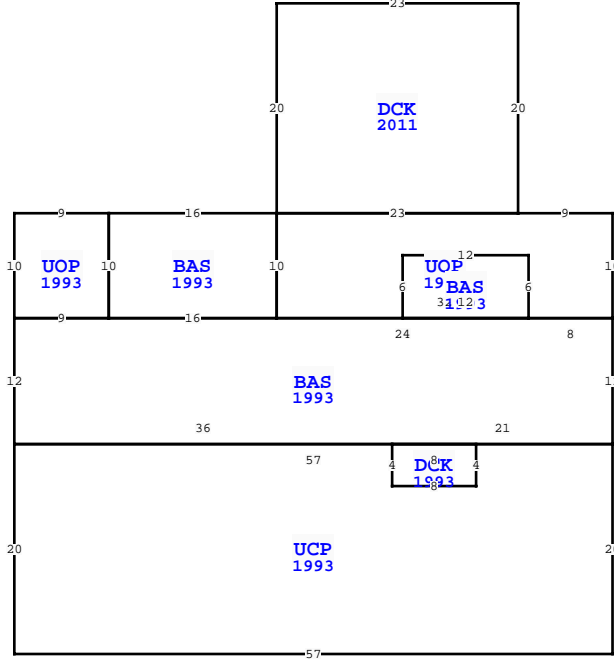

WAKULLA COUNTY PROPERTY			
VALUATION SUMMARY			PAGE 1 of 1
VALUATION BY		STANDARD	
Tax Group: 3	Tax Dist:		
BUILDING MARKET VALUE	24,512		
TOTAL MARKET OB/XF VALUE	3,054		
TOTAL LAND VALUE - MARKET	15,000		
TOTAL MARKET VALUE	42,566		
SOH/AGL Deduction	0		
ASSESSED VALUE	42,566		
TOTAL EXEMPTION VALUE	0		
BASE TAXABLE VALUE	42,566		
TOTAL JUST VALUE	42,566		
NCON VALUE	0		
INCOME VALUE	0		
PREVIOUS YEAR MKT VALUE	37,220		
ADJ BNDRY W/ 09888-002 NEW AC IS 2.00 AC M/L			
OR 1317 P 250 BNDRY ADJ			
DC OR 1290 P 144 MARSHALL TILDEN			
FLAGGED AS H3 UNDER NOTC			
PERMIT NUM	DESCRIPTION	AMT	ISSUED
B23-001111	Electrical		10/16/2023
SALES DATA			
OFF RECORD Number	DATE	TYPE INST	Q / V / RSN CD SALE PRICE
1343/0048	12/27/2023	WD Q I 01	28,400
GRANTOR: APTHORP SANDRA C &			
GRANTEE: GIBSON DELTA SIZEMO			
1296/0290	12/20/2022	WD Q I 05	70,000
GRANTOR: TILDEN-CRIPPEN AMBER			
GRANTEE: APTHORP SANDRA C &			
BUILDING NOTES			
BUILDING DIMENSIONS			
UOP=[YR=1993] W9 DCK=[YR=2011] N20 W23 S20 E23\$ W23 S10 E32 BAS=[YR=1993] W8 BAS=[YR=1993] N6 W12 S6 E12\$ W24 BAS=[YR=1993] N10 W16 S10 E16\$ W16 UOP=[YR=1993] N10 W9 S10 E9\$ W9 S12 UCP=[YR=1993] S20 E57 N20 W57\$ E36 DCK=[YR=1993] S4 E8 N4 W8\$ E21 N12\$ N10\$.			

EXTRA FEATURES																
L N	OB/XF CODE	DESCRIPTION	BLD CAP	L	W	UNITS	UT	Adj R	ADJ UNIT PRICE	ORIG COND	YEAR ON	YEAR ACTUAL	Q	% COND	OB/XF MKT VALUE	NOTES
1	0080	4' CHAINLI	0	0	0	210.00	LF	13.00	13.00	100	1980	1980	3	20	546	
2	0940	OPEN SHED	0	0	25	700.00	SF	4.00	4.00	100	1993	1993	3	20	560	
3	0210	CONCRETE D	0	0	57	1,140.00	SF	6.00	6.00	100	1993	1993	3	20	1,368	
4	0211	CONCRETE W	0	0	60	240.00	SF	6.00	6.00	100	1993	1993	3	20	288	
5	0055	PORTABLE C	0	0	18	360.00	SF	3.00	3.00	100	2006	2006	3	27	292	

LAND DESCRIPTION												TOTAL OB/XF												
L N	USE CODE	CLS	LAND USE DESCRIPTION	CAP	R D	LOC ZONE	FRONT	DEPTH	TOT LND UTS	UNIT TYPE	D T	DPH FACT	% COND	TOT ADJ	UNIT PRICE	ADJ UNIT PRICE	LAND VALUE	OTHER ADJUSTMENTS AND NOTES	YEAR	DENSITY	DECL	FRZ	YR	CONSRV
1	000201	C	MH	0			0.00	0.00	2.00	AC		1.00	1.00	1.00	7,500.00	7,500.00	15,000							