

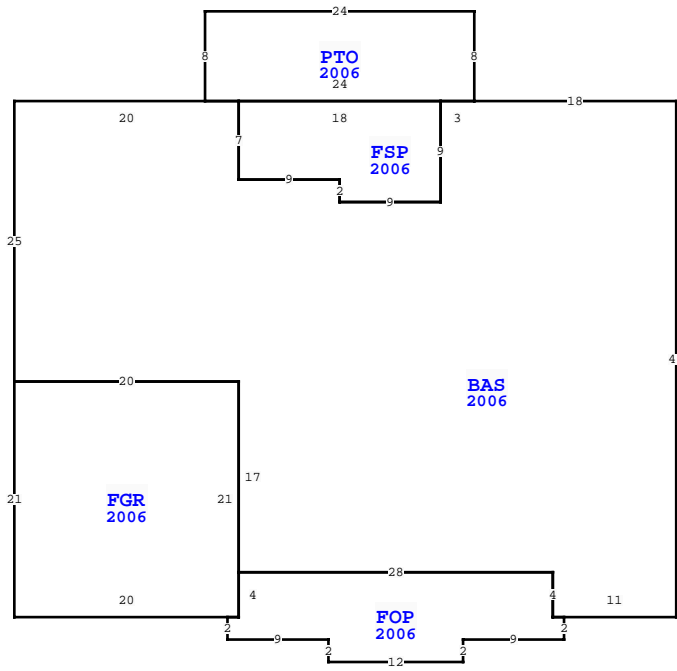

| BUILDING CHARACTERISTICS | | |
|--------------------------|------------------|----------------|
| ELEMENT | CD | CONSTRUCTION |
| Foundation | 02 | CONCR SLAB 100 |
| Frame | 02 | WOOD FRAME 100 |
| Exterior Wall | 05 | HARDIE BRD 80 |
| Exterior Wall | 20 | FACE BRICK 20 |
| Roof Structur | 03 | GABLE/HIP 100 |
| Roof Cover | 03 | COMP SHNGL 100 |
| Interior Wall | 05 | DRYWALL 100 |
| Interior Floo | 11 | CLAY TILE 50 |
| Interior Floo | 14 | CARPET 50 |
| Ceiling | 09 | 9 FT 100 |
| Heating Type | 13 | HEAT PUMP 100 |
| Air Condition | 13 | HEAT PUMP 100 |
| Bedrooms | | 3 100 |
| Bathrooms | | 2 100 |
| Story Height | | 0 100 |
| Stories | 1. | 1. 100 |
| Fireplace | 01 | FIREPLACE 100 |
| Units | | 0 100 |
| Quality | 03 | AVERAGE |
| DOR CODE | 0100 | SINGLE FAMILY |
| MAP NUM | 3 | MKT AREA 01 |
| NEIGHBORHOOD/LOC | 311.00 | 1.10/ |
| AREA TYPE | TOTAL GROSS AREA | PCT OF BASE |
| BAS | 2,038 | 100 |
| FGR | 420 | 50 |
| FOP | 196 | 30 |
| FSP | 144 | 55 |
| PTO | 192 | 5 |
| TOTALS | 2,990 | |

| MARKET ADJUSTMENTS | | | | | | | | | | | | |
|--------------------|------------|-----------|-------------|----------------|----------------|-----------------|-----|------|------|------|--------|--|
| TYPE | MDL | EFF. AREA | TOT ADJ PTS | EFF. BASE RATE | REPL. COST NEW | AYB | EYB | ECON | FNCT | NORM | % COND | |
| 1 | SINGLE FAM | 100% | - 2007 | | | | | | | | | |
| Heated Area: 2038 | | | | | | HX Base Yr 2007 | | | | | | |



WAKULLA COUNTY PROPERTY PAGE 1 of 1 3

| VALUATION SUMMARY | | STANDARD |
|---------------------------|-----------|----------|
| VALUATION BY | | |
| Tax Group: 3 | Tax Dist: | |
| BUILDING MARKET VALUE | | 255,406 |
| TOTAL MARKET OB/XF VALUE | | 39,170 |
| TOTAL LAND VALUE - MARKET | | 65,000 |
| TOTAL MARKET VALUE | | 359,576 |
| SOH/AGL Deduction | | 136,908 |
| ASSESSED VALUE | | 222,668 |
| TOTAL EXEMPTION VALUE | HX HB | 50,000 |
| BASE TAXABLE VALUE | | 172,668 |
| TOTAL JUST VALUE | | 359,576 |
| NCON VALUE | | 0 |
| INCOME VALUE | | |
| PREVIOUS YEAR MKT VALUE | | 309,475 |

5 YR PRCL CK, N/C
FR PU XFOPS, CC 06/04/2022
5 YR PRCL CK, N/C
5 YR PRCL CH, PU FNDN, PU XFOB LN 5

| PERMIT NUM | DESCRIPTION | AMT | ISSUED |
|------------|--------------|-----|------------|
| 2200466 | INGR POOL-CC | 0 | 05/23/2022 |
| 2014795 | MECH | 0 | 09/24/2014 |
| 20051701 | SFD/CO | 0 | 10/20/2005 |

| SALES DATA | | | | | | |
|-------------------|-----------|-----------|-------|-------|--------|------------|
| OFF RECORD Number | DATE | TYPE INST | Q / U | V / I | RSN CD | SALE PRICE |
| 0652/0644 | 4/26/2006 | WD Q | Q | I | | 258,000 |

GRANTOR: BRACKENCHASE BUILDERS
GRANTEE: BYRNE CHARLES & CHR
0619/0464 9/30/2005 WD Q V 02 5,043,500
GRANTOR: WAKULLA LAND LLC
GRANTEE: BRACKENCHASE BUILDE

BUILDING NOTES

BUILDING DIMENSIONS
BAS=[YR=2006] W18 PTO=[YR=2006] N8 W24 S8 E24\$ W3
FSP=[YR=2006] W18 S7 E9 S2 E9 N9\$ S9 W9 N2 W9 N7 W20 S25
FGR=[YR=2006] S21 E20 N21 W20\$ E20 S17 FOP=[YR=2006] E28 S4
E1 S2 W9 S2 W12 N2 W9 N2 E1 N4\$ E28 S4 E11 N46\$.

| EXTRA FEATURES | | | | | | | | | | | | | | | | | |
|----------------|------------|-------------|-----|-----|----|----|----------|----|-------|----------------|-----------|---------|-------------|---|--------|-----------------|-------|
| L N | OB/XF CODE | DESCRIPTION | BLD | CAP | L | W | UNITS | UT | Adj R | ADJ UNIT PRICE | ORIG COND | YEAR ON | YEAR ACTUAL | Q | % COND | OB/XF MKT VALUE | NOTES |
| 2 | 0210 | CONCRETE D | 0 | 100 | 0 | 0 | 1,363.00 | SF | 6.00 | 6.00 | 100 | 2006 | 2006 | 3 | 27 | 2,208 | |
| 3 | 0211 | CONCRETE W | 0 | 100 | 0 | 0 | 208.00 | SF | 6.00 | 6.00 | 100 | 2006 | 2006 | 3 | 27 | 337 | |
| 4 | 0955 | PRIVACY FE | 0 | 100 | 0 | 0 | 653.00 | LF | 15.00 | 15.00 | 100 | 2006 | 2006 | 3 | 30 | 2,939 | |
| 5 | 0700 | PORT BLDG | 0 | 100 | 7 | 14 | 98.00 | SF | 0.00 | 0.00 | 100 | 2008 | 2008 | 3 | 70 | 0 | |
| 6 | 0211 | CONCRETE W | 0 | 100 | 11 | 4 | 44.00 | SF | 6.00 | 6.00 | 100 | 2022 | 2022 | 3 | 97 | 256 | |
| 7 | 0220 | POOL VINYL | 0 | 100 | 16 | 31 | 496.00 | SF | 60.00 | 60.00 | 100 | 2022 | 2022 | 3 | 97 | 28,867 | |
| 8 | 0211 | CONCRETE W | 0 | 100 | 0 | 0 | 784.00 | SF | 6.00 | 6.00 | 100 | 2022 | 2022 | 3 | 97 | 4,563 | |
| TOTALS | | | | | | | | | | | | | | | | | |

| LAND DESCRIPTION | | | | | | | | | | | | | TOTAL OB/XF | | | | | | | | | | | | |
|------------------|----------|-----|----------------------|-----|-----|----------|-------|-------|-------------|-----------|-----|----------|-------------|---------|------------|----------------|------------|-----------------------------|------|---------|------|-----|----|--------|--|
| L N | USE CODE | CLS | LAND USE DESCRIPTION | CAP | R D | LOC ZONE | FRONT | DEPTH | TOT LND UTS | UNIT TYPE | D T | DPH FACT | % COND | TOT ADJ | UNIT PRICE | ADJ UNIT PRICE | LAND VALUE | OTHER ADJUSTMENTS AND NOTES | YEAR | DENSITY | DECL | FRZ | YR | CONSRV | |
| 1 | 000100 | C | SFR | 100 | | | 0.00 | 0.00 | 1.00 | LT | | 1.00 | 1.00 | 1.00 | 65,000.00 | 65,000.00 | 65,000 | | | | | | | | |