

THE PARK  
OR 521 P 193  
OR 964 P 304

LOT 41  
OR 619 P 464  
OR 1010 P 135

HOLAWAY WILLIAM S/HOLAWAY AMANDA  
42 PARKCREST COURT  
CRAWFORDVILLE, FL 32327

2024

00-00-051-311-09893-041

| ELEMENT        | CD | CONSTRUCTION   |
|----------------|----|----------------|
| Foundation     | 02 | CONCR SLAB 100 |
| Frame          | 05 | WOOD FRAME 100 |
| Exterior Wall  | 02 | HARDIE BRD 90  |
| Exterior Wall  | 11 | AVERAGE 10     |
| Roof Structur  | 03 | GABLE/HIP 100  |
| Roof Cover     | 03 | COMP SHNGL 100 |
| Interior Wall  | 05 | DRYWALL 100    |
| Interior Floor | 10 | LAMINATED 50   |
| Interior Floor | 14 | CARPET 50      |
| Ceiling        | 09 | 9 FT 100       |
| Heating Type   | 13 | HEAT PUMP 100  |
| Air Condition  | 13 | HEAT PUMP 100  |
| Bedrooms       |    | 3 100          |
| Bathrooms      |    | 2 100          |
| Story Height   |    | 0 100          |
| Stories        | 1. | 1. 100         |
| Units          |    | 0 100          |

| MARKET ADJUSTMENTS |     |           |             |                |                |      |      |      |      |      |        |       |
|--------------------|-----|-----------|-------------|----------------|----------------|------|------|------|------|------|--------|-------|
| TYPE               | MDL | EFF. AREA | TOT ADJ PTS | EFF. BASE RATE | REPL. COST NEW | AYB  | EYB  | ECON | FNCT | NORM | % COND |       |
| 0100               | 01  | 2,003     | 113.7000    | 118.82         | 237,996        | 2018 | 2018 | 0    | 0    | 0    | 5.00   | 95.00 |

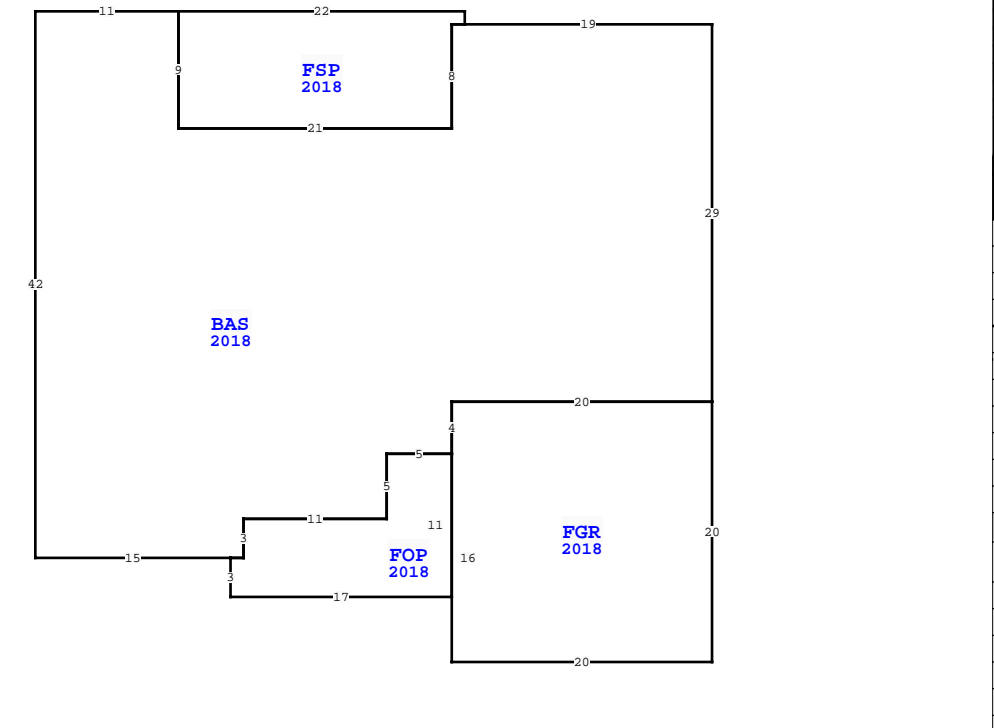

| AREA TYPE | TOTAL GROSS AREA | PCT OF BASE | YEAR | TOT ADJ AREA | SUBAREA MARKET VALUE |
|-----------|------------------|-------------|------|--------------|----------------------|
| BAS       | 1,662            | 100         | 2018 | 1,662        | 187,605              |
| FGR       | 400              | 50          | 2018 | 200          | 22,576               |
| FOP       | 124              | 30          | 2018 | 37           | 4,176                |
| FSP       | 190              | 55          | 2018 | 104          | 11,739               |

| WAKULLA COUNTY PROPERTY            |                  |     |            |
|------------------------------------|------------------|-----|------------|
| VALUATION SUMMARY                  |                  |     |            |
| VALUATION BY                       | STANDARD         |     |            |
| Tax Group: 3                       | Tax Dist:        |     |            |
| BUILDING MARKET VALUE              | 226,096          |     |            |
| TOTAL MARKET OB/XF VALUE           | 65,607           |     |            |
| TOTAL LAND VALUE - MARKET          | 65,000           |     |            |
| TOTAL MARKET VALUE                 | 356,703          |     |            |
| SOH/AGL Deduction                  | 0                |     |            |
| ASSESSED VALUE                     | 356,703          |     |            |
| TOTAL EXEMPTION VALUE              | HX HB VX 55,000  |     |            |
| BASE TAXABLE VALUE                 | 301,703          |     |            |
| TOTAL JUST VALUE                   | 356,703          |     |            |
| NCON VALUE                         | 0                |     |            |
| INCOME VALUE                       | 0                |     |            |
| PREVIOUS YEAR MKT VALUE            | 311,836          |     |            |
| 5 YR PRCL CK, N/C                  |                  |     |            |
| FR PRMT CK, PU XFOBS. CC05/19/2022 |                  |     |            |
| FR PRMT CK, PU XFOB. CC 03/2022    |                  |     |            |
| 5 YR PRCL CH, N/C                  |                  |     |            |
| PERMIT NUM                         | DESCRIPTION      | AMT | ISSUED     |
| 22000294                           | LEAN TO 8X36     | 0   | 04/28/2022 |
| 22000034                           | SHED-CC          | 0   | 01/24/2022 |
| 18000917                           | POLE BARN-CO     | 0   | 09/13/2018 |
| 18000603                           | SWIMMING POOL-CO | 0   | 06/21/2018 |
| 17001247                           | SFD-CO           | 0   | 10/12/2017 |

| SALES DATA                     |           |           |       |       |        |            |
|--------------------------------|-----------|-----------|-------|-------|--------|------------|
| OFF RECORD Number              | DATE      | TYPE INST | Q / U | V / I | RSN CD | SALE PRICE |
| 1061/0190                      | 1/24/2018 | WD Q      | Q     | I     | 01     | 206,000    |
| GRANTOR: PAFFORD PROPERTIES &  |           |           |       |       |        |            |
| GRANTEE: HOLAWAY WILLIAM S &   |           |           |       |       |        |            |
| 1010/0135                      | 8/26/2016 | WD Q      | Q     | V     | 05     | 553,000    |
| GRANTOR: JERRY MOORE FLORIDA O |           |           |       |       |        |            |
| GRANTEE: PAFFORD PROPERTIES    |           |           |       |       |        |            |

| L N | OB/XF CODE | DESCRIPTION | BLD | CAP | L  | W  | UNITS    | UT | Adj R | ADJ UNIT PRICE | ORIG COND | YEAR ON | YEAR ACTUAL | Q | % COND | OB/XF MKT VALUE | NOTES |
|-----|------------|-------------|-----|-----|----|----|----------|----|-------|----------------|-----------|---------|-------------|---|--------|-----------------|-------|
| 1   | 0210       | CONCRETE D  | 0   | 100 | 0  | 0  | 1,678.00 | SF | 6.00  | 6.00           | 100       | 2018    | 2018        | 3 | 80     | 8,054           |       |
| 2   | 0211       | CONCRETE W  | 0   | 100 | 0  | 0  | 172.00   | SF | 6.00  | 6.00           | 100       | 2018    | 2018        | 3 | 80     | 826             |       |
| 3   | 0220       | POOL VINYL  | 0   | 100 | 32 | 16 | 512.00   | SF | 60.00 | 60.00          | 100       | 2018    | 2018        | 3 | 80     | 24,576          |       |
| 4   | 0211       | CONCRETE W  | 0   | 100 | 0  | 0  | 1,104.00 | SF | 6.00  | 6.00           | 100       | 2018    | 2018        | 3 | 80     | 5,299           |       |
| 5   | 0955       | PRIVACY FE  | 0   | 100 | 0  | 0  | 791.00   | LF | 15.00 | 15.00          | 100       | 2018    | 2018        | 3 | 95     | 11,272          |       |
| 6   | 0025       | BARN, POLE  | 0   | 100 | 36 | 24 | 864.00   | SF | 12.50 | 12.50          | 100       | 2018    | 2018        | 3 | 80     | 8,640           |       |
| 7   | 0210       | CONCRETE D  | 0   | 100 | 36 | 24 | 864.00   | SF | 6.00  | 6.00           | 100       | 2018    | 2018        | 3 | 80     | 4,147           |       |
| 8   | 0700       | PORT BLDG   | 0   | 100 | 10 | 20 | 200.00   | SF | 0.00  | 0.00           | 100       | 2022    | 2022        | 3 | 98     | 0               |       |
| 9   | 0940       | OPEN SHED   | 0   | 100 | 8  | 36 | 288.00   | SF | 4.00  | 4.00           | 100       | 2022    | 2022        | 3 | 97     | 1,117           |       |
| 10  | 0210       | CONCRETE D  | 0   | 100 | 8  | 36 | 288.00   | SF | 6.00  | 6.00           | 100       | 2022    | 2022        | 3 | 97     | 1,676           |       |

| EXTRA FEATURES                 |            |          |      |            |           |         |      |  |  |  |  |  |
|--------------------------------|------------|----------|------|------------|-----------|---------|------|--|--|--|--|--|
| 42 PARKCREST CT, CRAWFORDVILLE |            |          |      |            |           |         |      |  |  |  |  |  |
| BLD DATE                       | XF DATE    | INC DATE | FRSR | LGL DATE   | LAND DATE | AG DATE | FRSR |  |  |  |  |  |
| 08/19/2020                     | 08/19/2020 |          | FRSR | 08/19/2020 |           |         | FRSR |  |  |  |  |  |

| BUILDING NOTES   |  |  |  |  |  |  |  |  |  |  |  |  |
|--|--|--|--|--|--|--|--|--|--|--|--|--|
| BAS=[YR=2018] W19 FSP=[YR=2018] N1 W22 S9 E21 N8 E1\$ W1 S8 W21 N9 W11 S42 E15 FOP=[YR=2018] S3 E17 N11 W5 S5 W11 S3 W1\$ E1 N3 E11 N5 E5 FGR=[YR=2018] S16 E20 N20 W20 S4\$ N4 E20 N29\$. |  |  |  |  |  |  |  |  |  |  |  |  |

| LAND DESCRIPTION |          |     |                      |     |     |          |       |       |             |           |     |           |        |         |            |                |            |                             |      |         |      |     |    |        |
|------------------|----------|-----|----------------------|-----|-----|----------|-------|-------|-------------|-----------|-----|-----------|--------|---------|------------|----------------|------------|-----------------------------|------|---------|------|-----|----|--------|
| L N              | USE CODE | CLS | LAND USE DESCRIPTION | CAP | R D | LOC ZONE | FRONT | DEPTH | TOT LND UTS | UNIT TYPE | D T | DPTH FACT | % COND | TOT ADJ | UNIT PRICE | ADJ UNIT PRICE | LAND VALUE | OTHER ADJUSTMENTS AND NOTES | YEAR | DENSITY | DECL | FRZ | YR | CONSRV |
| 1                | 000100   | C   | SFR                  | 100 |     |          | 0.00  | 0.00  | 1.00        | LT        |     | 1.00      | 1.00   | 1.00    | 65,000.00  | 65,000.00      | 65,000     |                             |      |         |      |     |    |        |

| TOTAL OB/XF |  |  |  |  |  |  |  |  |  |  |  |  |
|-------------|--|--|--|--|--|--|--|--|--|--|--|--|
| 65,607      |  |  |  |  |  |  |  |  |  |  |  |  |