

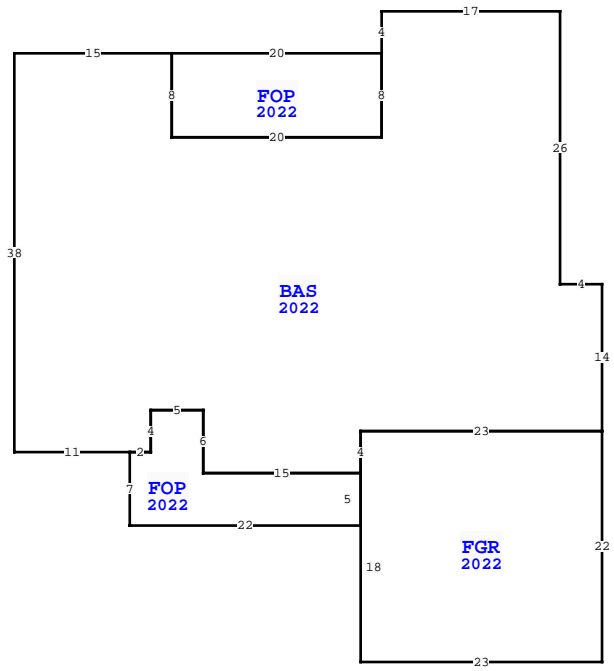

| ELEMENT | | CD | | CONSTRUCTION | |
|------------------|------------------|---------------|--------|--------------|----------------------|
| Foundation | 02 | CONCR | SLAB | 100 | |
| Frame | 02 | WOOD | FRAME | 100 | |
| Exterior Wall | 05 | HARDIE | BRD | 100 | |
| Roof Structur | 03 | GABLE | HIP | 100 | |
| Roof Cover | 03 | COMP | SHNGL | 100 | |
| Interior Wall | 05 | DRYWALL | 100 | | |
| Interior Floor | 07 | VYL | PLANK | 70 | |
| Interior Floor | 14 | CARPET | 30 | | |
| Heating Type | 04 | AIR | DUCTED | 100 | |
| Air Condition | 03 | CENTRAL | 100 | | |
| Bedrooms | | 4 | 100 | | |
| Bathrooms | | 2.5 | 100 | | |
| Story Height | | 0 | 100 | | |
| Stories | 1. | 1. | 100 | | |
| Units | | 0 | 100 | | |
| Quality | 03 | AVERAGE | | | |
| DOR CODE | 0100 | SINGLE FAMILY | | | |
| MAP NUM | 1 | MKT AREA | 10 | | |
| NEIGHBORHOOD/LOC | 407.00 | 1.00/ | | | |
| AREA TYPE | TOTAL GROSS AREA | PCT OF BASE | YEAR | TOT ADJ AREA | SUBAREA MARKET VALUE |
| BAS | 1,912 | 100 | 2022 | 1,912 | 202,740 |
| FGR | 506 | 50 | 2022 | 253 | 26,828 |
| FOP | 144 | 30 | 2022 | 43 | 4,560 |
| FOP | 160 | 30 | 2022 | 48 | 5,090 |
| TOTALS | 2,722 | | | 2,256 | 239,217 |

| MARKET ADJUSTMENTS | | | | | | | | | | | | |
|--------------------|------------|-------------|-------------------|----------------|----------------|-----|-----------------|------|------|------|--------|--|
| TYPE | MDL | EFF. AREA | TOT ADJ PTS | EFF. BASE RATE | REPL. COST NEW | AYB | EYB | ECON | FNCT | NORM | % COND | |
| 1 | SINGLE FAM | 100% - 2023 | | | | | | | | | | |
| | | | Heated Area: 1912 | | | | HX Base Yr 2023 | | | | | |



| WAKULLA COUNTY PROPERTY | | | | PAGE 1 of 1 | 3 |
|--|-------------|--------------|-------------|-------------|------------|
| VALUATION SUMMARY | | | | | |
| VALUATION BY | | STANDARD | | | |
| Tax Group: 3 | | Tax Dist: | | | |
| BUILDING MARKET VALUE | | 239,217 | | | |
| TOTAL MARKET OB/XF VALUE | | 9,111 | | | |
| TOTAL LAND VALUE - MARKET | | 60,000 | | | |
| TOTAL MARKET VALUE | | 308,328 | | | |
| SOH/AGL Deduction | | 0 | | | |
| ASSESSED VALUE | | 308,328 | | | |
| TOTAL EXEMPTION VALUE | | HX HB 50,000 | | | |
| BASE TAXABLE VALUE | | 258,328 | | | |
| TOTAL JUST VALUE | | 308,328 | | | |
| NCON VALUE | | 0 | | | |
| INCOME VALUE | | 0 | | | |
| PREVIOUS YEAR MKT VALUE | | 306,065 | | | |
| PU SFD, XFOB, POWER 10/20/21 C/O 12/8/21 | | | | | |
| 5 YR PRCL CH, N/C | | | | | |
| CREATED FROM PARCEL 000-09932-003 | | | | | |
| PERMIT NUM | DESCRIPTION | AMT | ISSUED | | |
| OBN21-00011 | SFD-CO | 0 | 06/07/2021 | | |
| SALES DATA | | | | | |
| OFF RECORD Number | DATE | TYPE INST | Q / V / I / | RSN CD | SALE PRICE |
| 1245/0112 | 12/20/2021 | WD Q | Q I | 01 | 335,000 |
| GRANTOR: SOUTHERN COASTAL HOME | | | | | |
| GRANTEE: MCWHORTER LESLY KEI | | | | | |
| 1200/0274 | 3/24/2021 | WD Q | V | 05 | 2,000,000 |
| GRANTOR: PALMETTO OF WAKULLA C | | | | | |
| GRANTEE: SOUTHERN COASTAL HO | | | | | |
| BUILDING NOTES | | | | | |
| BUILDING DIMENSIONS | | | | | |
| BAS=[YR=2022] W17 S4 FOP=[YR=2022] W20 S8 E20 N8\$ S8 W20 N8 W15 S38 E11 FOP=[YR=2022] S7 E22 N5 W15 N6 W5 S4 W2\$ E2 N4 E5 S6 E15 FGR=[YR=2022] S18 E23 N22 W23 S4\$ N4 E23 N14 W4 N26\$. | | | | | |

| EXTRA FEATURES | | | | | | | | | | | | | | | | | |
|----------------|------------|-------------|-----|-----|----|---|--------|----|-------|----------------|-----------|---------|-------------|---|--------|-----------------|-------|
| L N | OB/XF CODE | DESCRIPTION | BLD | CAP | L | W | UNITS | UT | Adj R | ADJ UNIT PRICE | ORIG COND | YEAR ON | YEAR ACTUAL | Q | % COND | OB/XF MKT VALUE | NOTES |
| 1 | 0210 | CONCRETE D | 0 | 100 | 0 | 0 | 917.00 | SF | 6.00 | 6.00 | 100 | 2021 | 2021 | 3 | 93 | 5,117 | |
| 2 | 0211 | CONCRETE W | 0 | 100 | 36 | 4 | 144.00 | SF | 6.00 | 6.00 | 100 | 2021 | 2021 | 3 | 93 | 804 | |
| 3 | 0955 | PRIVACY FE | 0 | 100 | 0 | 0 | 217.00 | LF | 15.00 | 15.00 | 100 | 2021 | 2021 | 3 | 98 | 3,190 | |

| LAND DESCRIPTION | | | | | | | | | | | | | TOTAL OB/XF | | | | | | | | | | | | |
|------------------|----------|-----|----------------------|-----|-----|----------|-------|-------|-------------|-----------|-----|-----------|-------------|---------|------------|----------------|------------|-----------------------------|------|---------|------|-----|----|--------|--|
| L N | USE CODE | CLS | LAND USE DESCRIPTION | CAP | R D | LOC ZONE | FRONT | DEPTH | TOT LND UTS | UNIT TYPE | D T | DPHT FACT | % COND | TOT ADJ | UNIT PRICE | ADJ UNIT PRICE | LAND VALUE | OTHER ADJUSTMENTS AND NOTES | YEAR | DENSITY | DECL | FRZ | YR | CONSRV | |
| 1 | 000100 | C | SFR | 100 | | | 0.00 | 0.00 | 1.00 | LT | | 1.00 | 1.00 | 1.00 | 60,000.00 | 60,000.00 | 60,000 | | | | | | | | |