

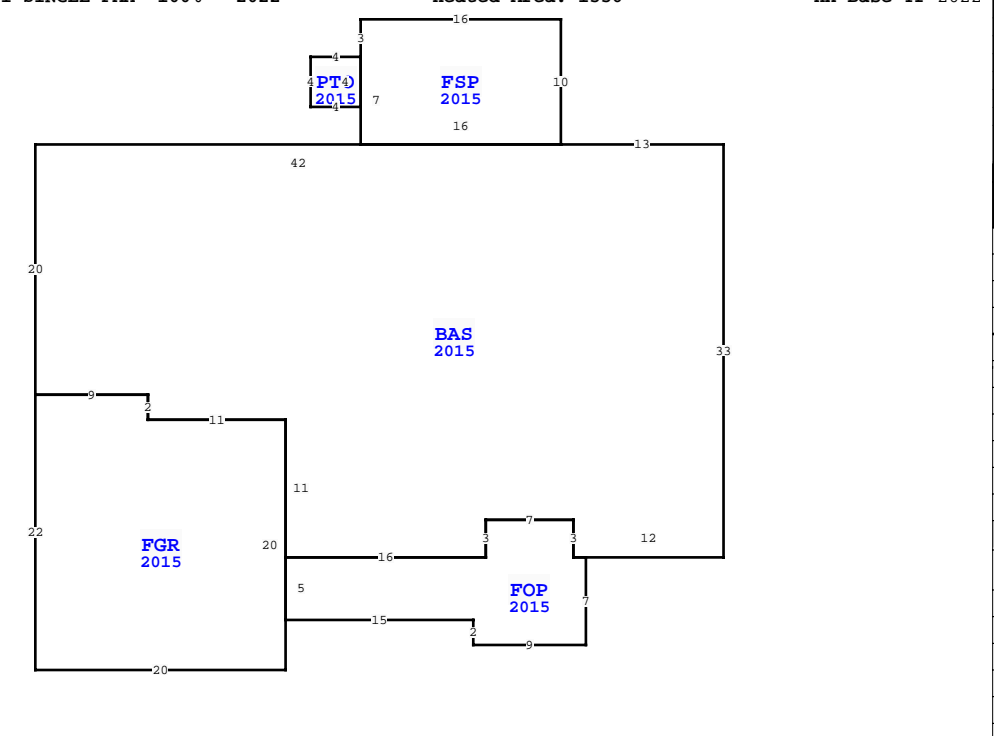

| BUILDING CHARACTERISTICS | | |
|--------------------------|------|----------------|
| ELEMENT | CD | CONSTRUCTION |
| Foundation | 02 | CONCR SLAB 100 |
| Frame | 02 | WOOD FRAME 100 |
| Exterior Wall | 05 | HARDIE BRD 100 |
| Roof Structur | 03 | GABLE/HIP 100 |
| Roof Cover | 03 | COMP SHNGL 100 |
| Interior Wall | 05 | DRYWALL 100 |
| Interior Floo | 12 | HARDWOOD 50 |
| Interior Floo | 14 | CARPET 50 |
| Heating Type | 04 | AIR DUCTED 100 |
| Air Condition | 03 | CENTRAL 100 |
| Bedrooms | | 3 100 |
| Bathrooms | | 2 100 |
| Story Height | | 0 100 |
| Stories | 1. | 1. 100 |
| Units | | 0 100 |
| Quality | 02 | BELOW AVERAGE |
| DOR CODE | 0100 | SINGLE FAMILY |
| MAP NUM | 2 | MKT AREA 10 |

| MARKET ADJUSTMENTS | | | | | | | | | | | |
|--------------------|------------|-----------|-------------|-------------------|-----------------|-----|-----|------|------|------|--------|
| TYPE | MDL | EFF. AREA | TOT ADJ PTS | EFF. BASE RATE | REPL. COST NEW | AYB | EYB | ECON | FNCT | NORM | % COND |
| 1 | SINGLE FAM | 100% | - 2022 | | | | | | | | |
| | | | | Heated Area: 1556 | | | | | | | |
| | | | | | HX Base Yr 2022 | | | | | | |



| NEIGHBORHOOD/LOC | 350.00 | 1.10/ | | | |
|------------------|------------------|-------------|------|--------------|----------------------|
| AREA TYPE | TOTAL GROSS AREA | PCT OF BASE | YEAR | TOT ADJ AREA | SUBAREA MARKET VALUE |
| BAS | 1,556 | 100 | 2015 | 1,556 | 154,574 |
| FGR | 418 | 50 | 2015 | 209 | 20,762 |
| FOP | 159 | 30 | 2015 | 48 | 4,768 |
| FSP | 160 | 55 | 2015 | 88 | 8,742 |
| PTO | 16 | 5 | 2015 | 1 | 99 |
| TOTALS | 2,309 | | | 1,902 | 188,946 |

| WAKULLA COUNTY PROPERTY | | | |
|---------------------------|--|-----------------|-------------|
| VALUATION SUMMARY | | | PAGE 1 of 1 |
| VALUATION BY | | STANDARD | |
| Tax Group: 3 | | Tax Dist: | |
| BUILDING MARKET VALUE | | 188,946 | |
| TOTAL MARKET OB/XF VALUE | | 8,921 | |
| TOTAL LAND VALUE - MARKET | | 50,000 | |
| TOTAL MARKET VALUE | | 247,867 | |
| SOH/AGL Deduction | | 104,109 | |
| ASSESSED VALUE | | 143,758 | |
| TOTAL EXEMPTION VALUE | | HX HB WX 55,000 | |
| BASE TAXABLE VALUE | | 88,758 | |
| TOTAL JUST VALUE | | 247,867 | |
| NCON VALUE | | 0 | |
| INCOME VALUE | | | |
| PREVIOUS YEAR MKT VALUE | | 214,476 | |

HVAC CC B23-1110 INCR EYB 2017-2019
 INCR EYB 2015-2017 HVAC-CC 9-2022
 ADDED WX FOR 2023 DC OR 1140 P 729
 2021 PORT FROM 20-3S-01E-154-05398-A18

| PERMIT NUM | DESCRIPTION | AMT | ISSUED |
|------------|---------------|-----|------------|
| B23-001110 | MECHANICAL-CC | | 10/16/2023 |
| 22000885 | HVAC-CC | 0 | 08/30/2022 |
| 21000770 | SHED | 0 | 08/05/2021 |
| 2014777 | SFD-CO | 0 | 09/17/2014 |

| SALES DATA | | | | | | |
|--|-----------|-----------|-------|-------|--------|------------|
| OFF RECORD Number | DATE | TYPE INST | Q / U | V / I | RSN CD | SALE PRICE |
| 1229/0597 | 7/15/2021 | CD | U | I | 11 | 100 |
| GRANTOR: BONE EDGARDO TORRES & GRANTEE: HENDERSON HANNELORE | | | | | | |
| 1220/0017 | 7/15/2021 | WD | P | I | 98 | 239,900 |
| GRANTOR: BONE EDGARDO TORRES & GRANTEE: HENDERSON HANNELORE | | | | | | |

23 CAROUSEL CIR, CRAWFORDVILLE
 BLD DATE 10/26/2021 FRJS LGL DATE 10/26/2021 FRJS
 XF DATE 10/26/2021 FRJS LAND DATE 10/26/2021 FRJS
 INC DATE AG DATE

| EXTRA FEATURES | | | | | | | | | | | | | | | | |
|----------------|------------|-------------|---------|-----|----|----------|----|-------|----------------|-----------|---------|-------------|---|--------|-----------------|-------|
| L N | OB/XF CODE | DESCRIPTION | BLD CAP | L | W | UNITS | UT | Adj R | ADJ UNIT PRICE | ORIG COND | YEAR ON | YEAR ACTUAL | Q | % COND | OB/XF MKT VALUE | NOTES |
| 1 | 0210 | CONCRETE D | 0 | 100 | 0 | 1,190.00 | SF | 6.00 | 6.00 | 100 | 2015 | 2015 | 3 | 67 | 4,784 | |
| 2 | 0211 | CONCRETE W | 0 | 100 | 50 | 200.00 | SF | 6.00 | 6.00 | 100 | 2015 | 2015 | 3 | 67 | 804 | |
| 3 | 0955 | PRIVACY FE | 0 | 100 | 0 | 196.00 | LF | 15.00 | 15.00 | 100 | 2015 | 2015 | 3 | 83 | 2,440 | |
| 4 | 0625 | PORT WD UT | 0 | 100 | 10 | 160.00 | SF | 6.00 | 6.00 | 100 | 2021 | 2021 | 3 | 93 | 893 | |

| BUILDING NOTES | | | | | | | | | |
|----------------|--|--|--|--|--|--|--|--|--|
| | | | | | | | | | |

BUILDING DIMENSIONS
 BAS=[YR=2015] W13 FSP=[YR=2015] N10 W16 S3 PTO=[YR=2015] W4 S4 E4 N4\$ S7 E16\$ W42 S20 FGR=[YR=2015] S22 E20 N20 W11 N2 W9\$ E9 S2 E11 S11 FOP=[YR=2015] S5 E15 S2 E9 N7 W1 N3 W7 S3 W16\$ E16 N3 E7 S3 E12 N33\$.

| LAND DESCRIPTION | | | | | | | | | | TOTAL OB/XF | | | | | | | | | | | | | | |
|------------------|----------|-----|----------------------|-----|-----|----------|-------|-------|-------------|-------------|-----|-----------|--------|---------|------------|----------------|------------|-----------------------------|------|---------|------|-----|----|--------|
| L N | USE CODE | CLS | LAND USE DESCRIPTION | CAP | R D | LOC ZONE | FRONT | DEPTH | TOT LND UTS | UNIT TYPE | D T | DPHT FACT | % COND | TOT ADJ | UNIT PRICE | ADJ UNIT PRICE | LAND VALUE | OTHER ADJUSTMENTS AND NOTES | YEAR | DENSITY | DECL | FRZ | YR | CONSRV |
| 1 | 000100 | C | SFR | 100 | | | 0.00 | 0.00 | 1.00 | LT | | 1.00 | 1.00 | 1.00 | 50,000.00 | 50,000.00 | 50,000 | | | | | | | |