

| BUILDING CHARACTERISTICS | | CONSTRUCTION | |
|--------------------------|------------------|---------------|------|
| ELEMENT | CD | | |
| Foundation | 02 | CONCR SLAB | 100 |
| Frame | 02 | WOOD FRAME | 100 |
| Exterior Wall | 05 | HARDIE BRD | 90 |
| Exterior Wall | 19 | COMMON BRK | 10 |
| Roof Structur | 03 | GABLE/HIP | 100 |
| Roof Cover | 03 | COMP SHNGL | 100 |
| Interior Wall | 05 | DRYWALL | 100 |
| Interior Floor | 11 | CLAY TILE | 50 |
| Interior Floor | 14 | CARPET | 50 |
| Ceiling | 09 | 9 FT | 100 |
| Heating Type | 04 | AIR DUCTED | 100 |
| Air Condition | 03 | CENTRAL | 100 |
| Bedrooms | | 3 | 100 |
| Bathrooms | | 2 | 100 |
| Story Height | | 0 | 100 |
| Stories | 1. | 1.100 | |
| Units | | 0 | 100 |
| Quality | 03 | AVERAGE | |
| DOR CODE | 0100 | SINGLE FAMILY | |
| MAP NUM | 2 | MKT AREA | 10 |
| NEIGHBORHOOD/LOC | 350.00 | 1.10/ | |
| AREA TYPE | TOTAL GROSS AREA | PCT OF BASE | YEAR |
| BAS | 1,406 | 100 | 2008 |
| FGR | 315 | 50 | 2008 |
| FOP | 108 | 30 | 2008 |
| PTO | 80 | 5 | 2008 |
| TOTALS | 1,909 | | |

| MARKET ADJUSTMENTS | | | | | | | | | | | | | |
|--------------------|------------|-----------|-------------|----------------|----------------|-----|-----|------|------|------|--------|-------------------|-----------------|
| TYPE | MDL | EFF. AREA | TOT ADJ PTS | EFF. BASE RATE | REPL. COST NEW | AYB | EYB | ECON | FNCT | NORM | % COND | | |
| 1 | SINGLE FAM | 100% | - 2022 | | | | | | | | | Heated Area: 1406 | HX Base Yr 2022 |

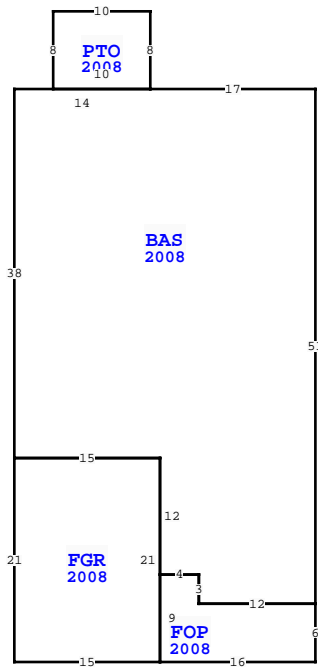

| WAKULLA COUNTY PROPERTY | | | | PAGE 1 of 1 | 3 | |
|--|-------------------|-----------|------------|-----------------|--------|------------|
| VALUATION SUMMARY | | | | | | |
| VALUATION BY | | | | STANDARD | | |
| Tax Group: 3 | | | | Tax Dist: | | |
| BUILDING MARKET VALUE | | | | 181,823 | | |
| TOTAL MARKET OB/XF VALUE | | | | 1,199 | | |
| TOTAL LAND VALUE - MARKET | | | | 40,000 | | |
| TOTAL MARKET VALUE | | | | 223,022 | | |
| SOH/AGL Deduction | | | | 24,463 | | |
| ASSESSED VALUE | | | | 198,559 | | |
| TOTAL EXEMPTION VALUE | | | | HX HB DX 55,000 | | |
| BASE TAXABLE VALUE | | | | 143,559 | | |
| TOTAL JUST VALUE | | | | 223,022 | | |
| NCON VALUE | | | | 0 | | |
| INCOME VALUE | | | | | | |
| PREVIOUS YEAR MKT VALUE | | | | 192,776 | | |
| INCR EYB 2008-2010 HVAC OB22-586 CC 2/6/2023 | | | | | | |
| 2022 HX APP AND PHYSICIAN CERTIFICATION | | | | | | |
| REMOVE HX- HAS HX IN OCALA FL-ALACHUA CO | | | | | | |
| PULLOUT LIST, OWNER MLD RNWL CRD | | | | | | |
| PERMIT NUM | DESCRIPTION | AMT | ISSUED | | | |
| OB22-000586 | HVAC CHANGE OUT-C | | 09/22/2022 | | | |
| OBN21-00027 | INSTALL GENERATOR | 0 | 10/21/2021 | | | |
| 20071325 | SFD-CO | 0 | 10/03/2007 | | | |
| 20071268 | SFD-VOID PERMIT | 0 | 09/25/2007 | | | |
| SALES DATA | | | | | | |
| OFF RECORD Number | DATE | TYPE INST | Q / U | V / I | RSN CD | SALE PRICE |
| 1221/0809 | 7/27/2021 | WD Q | Q | I | 01 | 220,000 |
| GRANTOR: ST. MARTIN AARON JACO | | | | | | |
| GRANTEE: SIBLE MARSHA E | | | | | | |
| 1056/0589 | 12/08/2017 | WD Q | Q | I | 01 | 143,000 |
| GRANTOR: DOHME IAN | | | | | | |
| GRANTEE: ST. MARTIN AARON JA | | | | | | |
| BUILDING NOTES | | | | | | |
| BUILDING DIMENSIONS | | | | | | |
| BAS=[YR=2008] W17 PTO=[YR=2008] N8 W10 S8 E10\$ W14 S38 | | | | | | |
| FGR=[YR=2008] S21 E15 N21 W15\$ E15 S12 FOP=[YR=2008] S9 E16 | | | | | | |
| N6 W12 N3 W4\$ E4 S3 E12 N53\$. | | | | | | |

| EXTRA FEATURES | | | | | | | | | | | | | | 24 EVENING STAR DR, CRAWFORDVILLE | | |
|----------------|------------|-------------|---------|-----|----|-------|----|-------|----------------|-----------|---------|-------------|---|-----------------------------------|-----------------|-------|
| L N | OB/XF CODE | DESCRIPTION | BLD CAP | L | W | UNITS | UT | Adj R | ADJ UNIT PRICE | ORIG COND | YEAR ON | YEAR ACTUAL | Q | % COND | OB/XF MKT VALUE | NOTES |
| 1 | 0210 | CONCRETE D | 0 | 100 | 46 | 12 | SF | 6.00 | 6.00 | 100 | 2008 | 2008 | 3 | 34 | 1,126 | |
| 2 | 0211 | CONCRETE W | 0 | 100 | 6 | 6 | SF | 6.00 | 6.00 | 100 | 2008 | 2008 | 3 | 34 | 73 | |

| LAND DESCRIPTION | | | | | | | | | | | | | | TOTAL OB/XF | | | | | | | | | | 1,199 | |
|------------------|----------|-----|----------------------|-----|-----|----------|-------|-------|-------------|-----------|-----|----------|--------|-------------|------------|----------------|------------|-----------------------------|------|---------|------|-----|----|--------|--|
| L N | USE CODE | CLS | LAND USE DESCRIPTION | CAP | R D | LOC ZONE | FRONT | DEPTH | TOT LND UTS | UNIT TYPE | D T | DPH FACT | % COND | TOT ADJ | UNIT PRICE | ADJ UNIT PRICE | LAND VALUE | OTHER ADJUSTMENTS AND NOTES | YEAR | DENSITY | DECL | FRZ | YR | CONSRV | |
| 1 | 000100 | C | SFR | 100 | | | 0.00 | 0.00 | 1.00 | LT | | 1.00 | 1.00 | 0.80 | 50,000.00 | 40,000.00 | 40,000 | | | | | | | | |