

| ELEMENT          |                  | CD            | CONSTRUCTION |              |                      |
|------------------|------------------|---------------|--------------|--------------|----------------------|
| Foundation       | 02               | CONCR         | SLAB         | 100          |                      |
| Frame            | 02               | WOOD          | FRAME        | 100          |                      |
| Exterior Wall    | 05               | HARDIE        | BRD          | 100          |                      |
| Roof Structur    | 03               | GABLE         | HIP          | 100          |                      |
| Roof Cover       | 03               | COMP          | SHNGL        | 100          |                      |
| Interior Wall    | 05               | DRYWALL       |              | 100          |                      |
| Interior Floo    | 07               | VYL           | PLANK        | 70           |                      |
| Interior Floo    | 14               | CARPET        |              | 30           |                      |
| Heating Type     | 13               | HEAT          | PUMP         | 100          |                      |
| Air Condition    | 13               | HEAT          | PUMP         | 100          |                      |
| Bedrooms         |                  |               |              | 3 100        |                      |
| Bathrooms        |                  |               |              | 2 100        |                      |
| Story Height     |                  |               |              | 0 100        |                      |
| Stories          | 1.               |               |              | 1. 100       |                      |
| Units            |                  |               |              | 0 100        |                      |
| Quality          | 03               | AVERAGE       |              |              |                      |
| DOR CODE         | 0100             | SINGLE FAMILY |              |              |                      |
| MAP NUM          | 3                | MKT AREA      | 10           |              |                      |
| NEIGHBORHOOD/LOC | 000              | 1.00/         |              |              |                      |
| AREA TYPE        | TOTAL GROSS AREA | PCT OF BASE   | YEAR         | TOT ADJ AREA | SUBAREA MARKET VALUE |
| BAS              | 1,633            | 100           | 2021         | 1,633        | 170,116              |
| FGR              | 441              | 50            | 2021         | 220          | 22,918               |
| FOP              | 132              | 30            | 2021         | 40           | 4,167                |
| FSP              | 120              | 55            | 2021         | 66           | 6,876                |
| TOTALS           | 2,326            |               |              | 1,959        | 204,077              |

| MARKET ADJUSTMENTS |            |           |             |                |                   |                 |     |      |      |      |        |
|--------------------|------------|-----------|-------------|----------------|-------------------|-----------------|-----|------|------|------|--------|
| TYPE               | MDL        | EFF. AREA | TOT ADJ PTS | EFF. BASE RATE | REPL. COST NEW    | AYB             | EYB | ECON | FNCT | NORM | % COND |
| 1                  | SINGLE FAM | 100%      | - 2022      |                |                   |                 |     |      |      |      |        |
|                    |            |           |             |                | Heated Area: 1633 |                 |     |      |      |      |        |
|                    |            |           |             |                |                   | HX Base Yr 2022 |     |      |      |      |        |

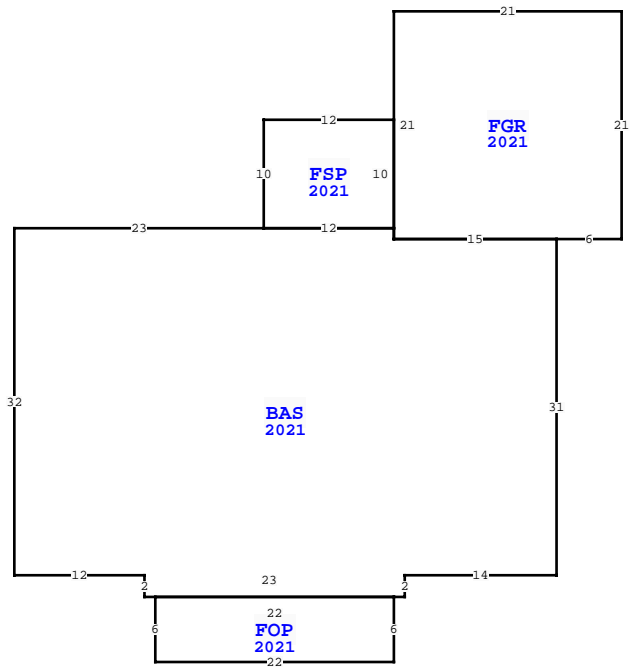

| WAKULLA COUNTY PROPERTY   |              |           |            | PAGE 1 of 1  | 3      |            |
|---|--------------|-----------|------------|--------------|--------|------------|
| VALUATION SUMMARY   |              |           |            |              |        |            |
| VALUATION BY  |              |           |            | STANDARD     |        |            |
| Tax Group: 3  |              |           |            | Tax Dist:    |        |            |
| BUILDING MARKET VALUE   |              |           |            | 204,077      |        |            |
| TOTAL MARKET OB/XF VALUE  |              |           |            | 26,746       |        |            |
| TOTAL LAND VALUE - MARKET   |              |           |            | 55,000       |        |            |
| TOTAL MARKET VALUE  |              |           |            | 285,823      |        |            |
| SOH/AGL Deduction   |              |           |            | 19,091       |        |            |
| ASSESSED VALUE  |              |           |            | 266,732      |        |            |
| TOTAL EXEMPTION VALUE   |              |           |            | HX HB 50,000 |        |            |
| BASE TAXABLE VALUE  |              |           |            | 216,732      |        |            |
| TOTAL JUST VALUE  |              |           |            | 285,823      |        |            |
| NCON VALUE  |              |           |            | 9,995        |        |            |
| INCOME VALUE  |              |           |            |              |        |            |
| PREVIOUS YEAR MKT VALUE   |              |           |            | 275,589      |        |            |
| 5 YR PRCL CK, N/C   |              |           |            |              |        |            |
| RMVD H4 - CONFIRMED W/ DMV NO CHANGE OF ADDRESS.                        |              |           |            |              |        |            |
| H4 - MAILED QUESTIONNAIRE DUE TO NOTE DATED 3/28/2                      |              |           |            |              |        |            |
| 2024 HX CARD RETURN NO COA  |              |           |            |              |        |            |
| PERMIT NUM  | DESCRIPTION  | AMT       | ISSUED     |              |        |            |
| B23-000136  | POLE BARN-CC | 0         | 02/23/2023 |              |        |            |
| 21000532  | SFD          | 0         | 05/12/2021 |              |        |            |
| SALES DATA  |              |           |            |              |        |            |
| OFF RECORD Number   | DATE         | TYPE INST | Q U        | V I          | RSN CD | SALE PRICE |
| 1245/0867   | 1/03/2022    | WD Q      | Q          | I            | 01     | 281,600    |
| GRANTOR: STEVE BYRD CONSTRUCTI  |              |           |            |              |        |            |
| GRANTEE: FANNON CHASE ANDREW  |              |           |            |              |        |            |
| BUILDING NOTES  |              |           |            |              |        |            |
| BUILDING DIMENSIONS   |              |           |            |              |        |            |
| BAS=[YR=2021;ORIG=-6,21] W15 N1 W12 W23 S32 E12 S2 E23 E1 N2 E14 N31 \$ |              |           |            |              |        |            |
| FGR=[YR=2021;ORIG=0,0] W21 S21 E15 E6 N21 \$                            |              |           |            |              |        |            |
| FOP=[YR=2021;ORIG=-21,54] W22 S6 E22 N6 \$                              |              |           |            |              |        |            |
| FSP=[YR=2021;ORIG=-33,20] E12 N10 W12 S10 \$                            |              |           |            |              |        |            |

| EXTRA FEATURES |            |             |     |     |     |    |          |    |       |                |           |         |             |    | BLD DATE |                 |       | LGL DATE |  |  |
|----------------|------------|-------------|-----|-----|-----|----|----------|----|-------|----------------|-----------|---------|-------------|----|----------|-----------------|-------|----------|--|--|
| L N            | OB/XF CODE | DESCRIPTION | BLD | CAP | L   | W  | UNITS    | UT | Adj R | ADJ UNIT PRICE | ORIG COND | YEAR ON | YEAR ACTUAL | Q  | % COND   | OB/XF MKT VALUE | NOTES |          |  |  |
| 1              | 0210       | CONCRETE D  | 0   | 100 | 193 | 14 | 2,702.00 | SF | 6.00  | 6.00           | 100       | 2021    | 2021        | 3  | 93       | 15,077          |       |          |  |  |
| 2              | 0211       | CONCRETE W  | 0   | 100 | 33  | 4  | 132.00   | SF | 6.00  | 6.00           | 100       | 2021    | 2021        | 3  | 93       | 737             |       |          |  |  |
| 3              | 0210       | CONCRETE D  | 0   | 100 | 0   | 0  | 168.00   | SF | 6.00  | 6.00           | 100       | 2021    | 2021        | 3  | 93       | 937             |       |          |  |  |
| 4              | 0955       | PRIVACY FE  | 0   | 100 | 0   | 0  | 324.00   | LF | 15.00 | 15.00          | 100       | 2024    | 2022        | AV | 99       | 4,811           |       |          |  |  |
| 5              | 0030       | BARN, POLE  | 0   | 100 | 36  | 16 | 576.00   | SF | 9.00  | 9.00           | 100       | 2024    | 2023        | AV | 100      | 5,184           |       |          |  |  |
| TOTALS         |            |             |     |     |     |    |          |    |       |                |           |         |             |    | 26,746   |                 |       |          |  |  |

| LAND DESCRIPTION |          |     |                      |     |     |          |       |       |             |           |     |          |        |         | TOTAL OB/XF |                |            |                             |      |         |      |     |    |        |
|------------------|----------|-----|----------------------|-----|-----|----------|-------|-------|-------------|-----------|-----|----------|--------|---------|-------------|----------------|------------|-----------------------------|------|---------|------|-----|----|--------|
| L N              | USE CODE | CLS | LAND USE DESCRIPTION | CAP | R D | LOC ZONE | FRONT | DEPTH | TOT LND UTS | UNIT TYPE | D T | DPH FACT | % COND | TOT ADJ | UNIT PRICE  | ADJ UNIT PRICE | LAND VALUE | OTHER ADJUSTMENTS AND NOTES | YEAR | DENSITY | DECL | FRZ | YR | CONSRV |
| 1                | 000100   | C   | SFR                  | 100 |     | LDR      | 0.00  | 0.00  | 1.00        | LT        |     | 1.00     | 1.00   | 1.00    | 55,000.00   | 55,000.00      | 55,000     |                             |      |         |      |     |    |        |