

MALLARD POND
OR 602 P 465
OR 927 P 491

LOT 89
OR 914 P 370
OR 1013 P 197

HORNE GERALD/HORNE TAMMY
12 WIGEON WAY
CRAWFORDVILLE, FL 32327

2024

00-00-072-331-10157-089

| ELEMENT | | CD | CONSTRUCTION |
|------------------|------------------|---------------|--------------|
| Foundation | 02 | CONCR | SLAB 100 |
| Frame | 02 | WOOD | FRAME 100 |
| Exterior Wall | 05 | HARDIE BRD | 90 |
| Exterior Wall | 11 | AVERAGE | 10 |
| Roof Structur | 03 | GABLE/HIP | 100 |
| Roof Cover | 03 | COMP SHNGL | 100 |
| Interior Wall | 05 | DRYWALL | 100 |
| Interior Floo | 10 | LAMINATED | 80 |
| Interior Floo | 11 | CLAY TILE | 20 |
| Heating Type | 13 | HEAT PUMP | 100 |
| Air Condition | 13 | HEAT PUMP | 100 |
| Bedrooms | | | 3 100 |
| Bathrooms | | | 2 100 |
| Story Height | | | 0 100 |
| Stories | 1. | 1. 100 | |
| Units | | | 0 100 |
| Quality | 03 | AVERAGE | |
| DOR CODE | 0100 | SINGLE FAMILY | |
| MAP NUM | 3 | MKT AREA | 10 |
| NEIGHBORHOOD/LOC | 331.00 | 1.10/ | |
| AREA TYPE | TOTAL GROSS AREA | PCT OF BASE | YEAR |
| BAS | 1,700 | 100 | 2017 |
| FGR | 400 | 50 | 2017 |
| FOP | 30 | 30 | 2017 |
| FOP | 150 | 30 | 2017 |
| PTO | 90 | 5 | 2017 |
| TOTALS | 2,370 | | |

| MARKET ADJUSTMENTS | | | | | | | | | | | |
|--|-----|-----------|-------------|----------------|----------------|------|------|------|------|------|--------|
| TYPE | MDL | EFF. AREA | TOT ADJ PTS | EFF. BASE RATE | REPL. COST NEW | AYB | EYB | ECON | FNCT | NORM | % COND |
| 0100 | 01 | 1,958 | 114.5000 | 119.65 | 234,275 | 2017 | 2017 | 0 | 0 | 6.00 | 94.00 |
| 1 SINGLE FAM 100% - 2018 Heated Area: 1700 HX Base Yr 2018 | | | | | | | | | | | |

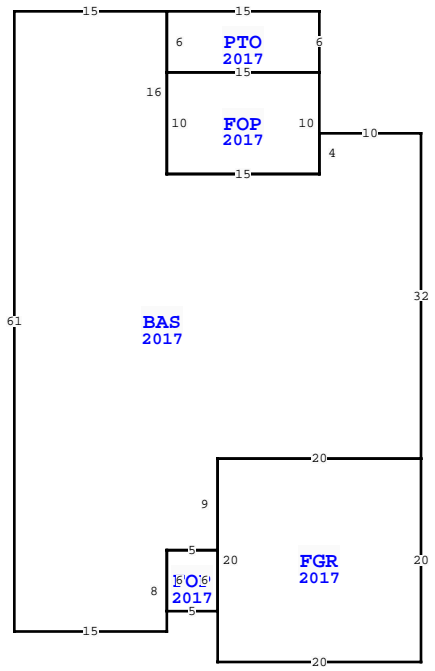

| WAKULLA COUNTY PROPERTY | | | |
|---|-------------|-----------|----------------|
| VALUATION SUMMARY | | | PAGE 1 of 1 |
| VALUATION BY | | | STANDARD |
| Tax Group: 3 | Tax Dist: | | |
| BUILDING MARKET VALUE | | | 220,218 |
| TOTAL MARKET OB/XF VALUE | | | 4,569 |
| TOTAL LAND VALUE - MARKET | | | 55,000 |
| TOTAL MARKET VALUE | | | 279,787 |
| SOH/AGL Deduction | | | 94,887 |
| ASSESSED VALUE | | | 184,900 |
| TOTAL EXEMPTION VALUE | HX HB | | 50,000 |
| BASE TAXABLE VALUE | | | 134,900 |
| TOTAL JUST VALUE | | | 279,787 |
| NCON VALUE | | | 0 |
| INCOME VALUE | | | |
| PREVIOUS YEAR MKT VALUE | | | 247,244 |
| 5 YR PRCL CK, N/C | | | |
| FR 5 YR CK, PU EXW, PU XFOB | | | |
| ADD HX FOR 2018 | | | |
| 5 YR PRCL CH, PU NEW SFD, PU XFOB LN 1-3 | | | |
| PERMIT NUM | DESCRIPTION | AMT | ISSUED |
| 17000126 | SFD-CO | 0 | 02/06/2017 |
| SALES DATA | | | |
| OFF RECORD Number | DATE | TYPE INST | Q / V / RSN CD |
| 1044/0732 | 8/18/2017 | WD Q | I 01 |
| | | | SALE PRICE |
| | | | 212,000 |
| GRANTOR: SOUTHERN CONSTRUCTION | | | |
| GRANTEE: HORNE GERALD & TAMM | | | |
| 1013/0197 | 9/29/2016 | WD Q | V 05 |
| GRANTOR: MALLARD POND, LLC | | | |
| GRANTEE: SOUTHERN CONSTRUCTI | | | |
| BUILDING NOTES | | | |
| BUILDING DIMENSIONS | | | |
| BAS=[YR=2017] W10 S4 W15 FOP=[YR=2017] E15 N10 W15 | | | |
| PTO=[YR=2017] E15 N6 W15 S6\$ S10\$ N16 W15 S61 E15 N8 | | | |
| FOP=[YR=2017] S6 E5 N6 W5\$ E5 N9 E20 FGR=[YR=2017] W20 S20 | | | |
| E20 N20\$ N32\$. | | | |

| EXTRA FEATURES | | | | | | | | | | | |
|----------------|------------|-------------|---------|----|----|--------|----|-------|----------------|-----------|---------|
| L N | OB/XF CODE | DESCRIPTION | BLD CAP | L | W | UNITS | UT | Adj R | ADJ UNIT PRICE | ORIG COND | YEAR ON |
| 1 | 0210 | CONCRETE D | 0 100 | 50 | 16 | 800.00 | SF | 6.00 | 6.00 | 100 | 2017 |
| 2 | 0210 | CONCRETE D | 0 100 | 0 | 0 | 124.00 | SF | 6.00 | 6.00 | 100 | 2017 |
| 3 | 0211 | CONCRETE W | 0 100 | 0 | 0 | 78.00 | SF | 6.00 | 6.00 | 100 | 2017 |
| 4 | 0625 | PORT WD UT | 0 100 | 8 | 10 | 80.00 | SF | 0.00 | 0.00 | 100 | 2017 |

| TOTAL OB/XF | | | | | | | | | | | |
|-------------|----------|-----|----------------------|-----|-----|----------|-------|-------|-------------|-----------|------|
| 4,569 | | | | | | | | | | | |
| L N | USE CODE | CLS | LAND USE DESCRIPTION | CAP | R D | LOC ZONE | FRONT | DEPTH | TOT LND UTS | UNIT TYPE | D T |
| 1 | 000100 | C | SFR | 100 | | | 0.00 | 0.00 | 1.00 | LT | 1.00 |

| LAND DESCRIPTION | | | | | | | | | | | | TOTAL OB/XF | | | | | | | | | | | | | | |
|------------------|----------|-----|----------------------|-----|-----|----------|-------|-------|-------------|-----------|------|-------------|---------|-------------|---|--------|-----------------|----------------|------------|-----------------------------|------|---------|------|-----|----|--------|
| L N | USE CODE | CLS | LAND USE DESCRIPTION | CAP | R D | LOC ZONE | FRONT | DEPTH | TOT LND UTS | UNIT TYPE | D T | ORIG COND | YEAR ON | YEAR ACTUAL | Q | % COND | OB/XF MKT VALUE | ADJ UNIT PRICE | LAND VALUE | OTHER ADJUSTMENTS AND NOTES | YEAR | DENSITY | DECL | FRZ | YR | CONSRV |
| 1 | 000100 | C | SFR | 100 | | | 0.00 | 0.00 | 1.00 | LT | 1.00 | 1.00 | 2017 | 2017 | 3 | 76 | 55,000.00 | 55,000.00 | 55,000 | | | | | | | |