

AMELIAWOOD SUBD
BLOCK C LOT 5
OR 57 P 502 & OR 64 P 126

TRUJILLO ERNESTO MIGUEL
63 ANNA DR
CRAWFORDVILLE, FL 32327

2024

00-00-073-112-10189-024



| ELEMENT | | CD | | CONSTRUCTION | |
|------------------|------------------|---------------|-------|--------------|----------------------|
| Foundation | 02 | CONCR | SLAB | 100 | |
| Frame | 02 | WOOD | FRAME | 100 | |
| Exterior Wall | 30 | VINYL | 70 | | |
| Exterior Wall | 19 | COMMON | BRK | 30 | |
| Roof Structure | 03 | GABLE/HIP | 100 | | |
| Roof Cover | 03 | COMP | SHNGL | 100 | |
| Interior Wall | 05 | DRYWALL | 100 | | |
| Interior Floor | 14 | CARPET | 70 | | |
| Interior Floor | 11 | CLAY TILE | 30 | | |
| Heating Type | 13 | HEAT PUMP | 100 | | |
| Air Condition | 13 | HEAT PUMP | 100 | | |
| Bedrooms | | 3 | 100 | | |
| Bathrooms | | 1.5 | 100 | | |
| Story Height | | 0 | 100 | | |
| Stories | 1. | 1. | 100 | | |
| Units | | 0 | 100 | | |
| Quality | 03 | AVERAGE | | | |
| DOR CODE | 0100 | SINGLE FAMILY | | | |
| MAP NUM | 3 | MKT AREA | | 10 | |
| NEIGHBORHOOD/LOC | 112.00 | 1.10/ | | | |
| AREA TYPE | TOTAL GROSS AREA | PCT OF BASE | YEAR | TOT ADJ AREA | SUBAREA MARKET VALUE |
| BAS | 1,008 | 100 | 1993 | 1,008 | 106,217 |
| BAS | 288 | 100 | 1994 | 288 | 30,348 |
| FOP | 24 | 30 | 1993 | 7 | 738 |
| FOP | 87 | 30 | 1993 | 26 | 2,740 |
| TOTALS | 1,407 | | | 1,329 | 140,042 |

| MARKET ADJUSTMENTS | | | | | | | | | | | |
|--------------------|------------|-----------|-------------|-------------------|----------------|-----|-----------------|------|------|------|--------|
| TYPE | MDL | EFF. AREA | TOT ADJ PTS | EFF. BASE RATE | REPL. COST NEW | AYB | EYB | ECON | FNCT | NORM | % COND |
| 1 | SINGLE FAM | 100% | - 2022 | | | | | | | | |
| | | | | Heated Area: 1296 | | | HX Base Yr 2022 | | | | |

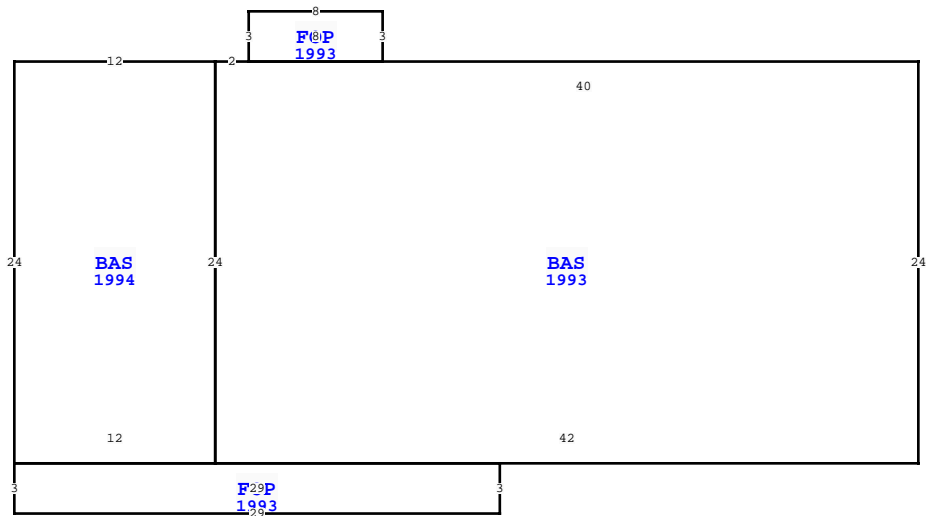

| WAKULLA COUNTY PROPERTY | | | |
|--|-------------------|----------|-------------|
| VALUATION SUMMARY | | | PAGE 1 of 1 |
| VALUATION BY | | STANDARD | |
| Tax Group: 3 | Tax Dist: | | |
| BUILDING MARKET VALUE | | | 140,042 |
| TOTAL MARKET OB/XF VALUE | | | 6,648 |
| TOTAL LAND VALUE - MARKET | | | 15,000 |
| TOTAL MARKET VALUE | | | 161,690 |
| SOH/AGL Deduction | | | 0 |
| ASSESSED VALUE | | | 161,690 |
| TOTAL EXEMPTION VALUE | HX HB | 50,000 | |
| BASE TAXABLE VALUE | | | 111,690 |
| TOTAL JUST VALUE | | | 161,690 |
| NCON VALUE | | | 0 |
| INCOME VALUE | | | 0 |
| PREVIOUS YEAR MKT VALUE | | | 166,118 |
| 5 YR PRCL CK, CHG QUAL FROM FAIR TO AVG, CHG XFOBS | | | |
| FR PRMT, PU SLR PNLS CC 10/2022 | | | |
| 2022 PORT TO JACKSON - PASCARELLA | | | |
| DEL XFOB 0060 | | | |
| PERMIT NUM | DESCRIPTION | AMT | ISSUED |
| B24-000405 | HVAC CHANGE OUT-C | | 04/12/2024 |
| OBN22-00023 | SOLAR PANELS-CC | 0 | 08/24/2022 |
| 18000922 | REROOF-CO | 0 | 09/12/2018 |
| 2011847 | WINDOWS/DOORS | 0 | 12/14/2011 |
| 23698 | ELECT | 0 | 06/11/1998 |

| SALES DATA | | | | | | |
|--------------------------------|------------|-----------|-------|-------|--------|------------|
| OFF RECORD Number | DATE | TYPE INST | Q / U | V / I | RSN CD | SALE PRICE |
| 1236/0160 | 10/27/2021 | WD Q | I | 01 | | 173,400 |
| GRANTOR: PASCARELLA GENE & MAR | | | | | | |
| GRANTEE: TRUJILLO ERNESTO MI | | | | | | |
| 0064/0126 | 7/01/1978 | WD U | I | | | 24,000 |
| GRANTOR: | | | | | | |
| GRANTEE: | | | | | | |

| EXTRA FEATURES | | BLD DATE | XF DATE | INC DATE | FRFR | LGL DATE | LAND DATE | AG DATE | FRFR |
|---------------------------|--|------------|------------|----------|------|------------|-----------|---------|------|
| 63 ANNA DR, CRAWFORDVILLE | | 02/24/2021 | 02/24/2021 | | | 02/24/2021 | | | |

| L N | OB/XF CODE | DESCRIPTION | BLD | CAP | L | W | UNITS | UT | Adj R | ADJ UNIT PRICE | ORIG COND | YEAR ON | YEAR ACTUAL | Q | % COND | OB/XF MKT VALUE | NOTES |
|--------------------|------------|-------------|-----|-----|----|----|--------|----|-------|----------------|-----------|---------|-------------|---|--------|-----------------|-------|
| 1 | 0210 | CONCRETE D | 0 | 100 | 56 | 10 | 560.00 | SF | 6.00 | 6.00 | 100 | 1980 | 1980 | 3 | 20 | 672 | |
| 2 | 0050 | CARPOT UN | 0 | 100 | 16 | 20 | 320.00 | SF | 9.00 | 9.00 | 100 | 1981 | 1981 | 3 | 58 | 1,670 | |
| 3 | 0040 | CARPOT FI | 0 | 100 | 23 | 20 | 460.00 | SF | 12.00 | 12.00 | 100 | 2012 | 2012 | 3 | 78 | 4,306 | |
| 4 | 0055 | PORTABLE C | 0 | 100 | 20 | 20 | 400.00 | SF | 0.00 | 0.00 | 100 | 2013 | 2013 | 3 | 57 | 0 | |
| 5 | 0625 | PORT WD UT | 0 | 100 | 12 | 10 | 120.00 | SF | 0.00 | 0.00 | 100 | 2012 | 2012 | 3 | 52 | 0 | |
| 6 | 0605 | PORT VINYL | 0 | 100 | 8 | 6 | 48.00 | SF | 0.00 | 0.00 | 100 | 2013 | 2013 | 3 | 57 | 0 | |
| 7 | 1450 | SOLAR PANE | 0 | 100 | 0 | 0 | 29.00 | UT | 0.00 | 0.00 | 100 | 2022 | 2022 | 3 | 97 | 0 | |
| TOTAL OB/XF | | | | | | | | | | | | | | | | 6,648 | |

| BUILDING NOTES | | | | | | | | | | | |
|--|--|--|--|--|--|--|--|--|--|--|--|
| | | | | | | | | | | | |
| BUILDING DIMENSIONS | | | | | | | | | | | |
| BAS=[YR=1993] W40 FOP=[YR=1993] E8 N3 W8 S3\$ W2 BAS=[YR=1994] W12 S24 FOP=[YR=1993] S3 E29 N3 W29\$ E12 N24 \$ S24 E42 N24\$. | | | | | | | | | | | |

| LAND DESCRIPTION | | TOTAL OB/XF | | | | | | | | | | | | | | | | | | | | | | |
|------------------|----------|-------------|----------------------|-----|-----|----------|--------|--------|-------------|-----------|-----|----------|--------|---------|------------|----------------|------------|-----------------------------|------|---------|------|-----|----|--------|
| L N | USE CODE | CLS | LAND USE DESCRIPTION | CAP | R D | LOC ZONE | FRONT | DEPTH | TOT LND UTS | UNIT TYPE | D T | DPH FACT | % COND | TOT ADJ | UNIT PRICE | ADJ UNIT PRICE | LAND VALUE | OTHER ADJUSTMENTS AND NOTES | YEAR | DENSITY | DECL | FRZ | YR | CONSRV |
| 1 | 000100 | C | SFR | 100 | | R1 | 113.00 | 192.00 | 1.00 | LT | | 1.00 | 1.00 | 1.00 | 15,000.00 | 15,000.00 | 15,000 | | | | | | | |