

AMELIA WOOD SUBD  
BLOCK A LOT 7  
OR 64 P 938 & OR 67 P 39

SPIVEY DENISE ANNE  
7 MARIE CIRCLE  
CRAWFORDVILLE, FL 32327

2024

00-00-073-112-10195-007

| BUILDING CHARACTERISTICS |                  | CONSTRUCTION  |      |
|--------------------------|------------------|---------------|------|
| ELEMENT                  | CD               |               |      |
| Foundation               | 02               | CONCR SLAB    | 100  |
| Frame                    | 02               | WOOD FRAME    | 100  |
| Exterior Wall            | 13               | PREFAB PNL    | 80   |
| Exterior Wall            | 19               | COMMON BRK    | 20   |
| Roof Structur            | 03               | GABLE/HIP     | 100  |
| Roof Cover               | 12               | MODULAR MT    | 100  |
| Interior Wall            | 05               | DRYWALL       | 100  |
| Interior Floo            | 11               | CLAY TILE     | 50   |
| Interior Floo            | 14               | CARPET        | 50   |
| Heating Type             | 04               | AIR DUCTED    | 100  |
| Air Condition            | 03               | CENTRAL       | 100  |
| Bedrooms                 |                  | 3             | 100  |
| Bathrooms                |                  | 2             | 100  |
| Story Height             |                  | 0             | 100  |
| Stories                  | 1.               | 1.            | 100  |
| Units                    |                  | 0             | 100  |
| Quality                  | 08               | FAIR          |      |
| DOR CODE                 | 0100             | SINGLE FAMILY |      |
| MAP NUM                  | 3                | MKT AREA      | 10   |
| NEIGHBORHOOD/LOC         | 112.00           | 1.10/         |      |
| AREA TYPE                | TOTAL GROSS AREA | PCT OF BASE   | YEAR |
| BAS                      | 1,008            | 100           | 1993 |
| FGR                      | 216              | 50            | 1993 |
| FOP                      | 51               | 30            | 1993 |
| UST                      | 72               | 45            | 1993 |
| TOTALS                   | 1,347            |               |      |

| MARKET ADJUSTMENTS |            |           |             |                |                   |     |     |      |      |                 |        |
|--------------------|------------|-----------|-------------|----------------|-------------------|-----|-----|------|------|-----------------|--------|
| TYPE               | MDL        | EFF. AREA | TOT ADJ PTS | EFF. BASE RATE | REPL. COST NEW    | AYB | EYB | ECON | FNCT | NORM            | % COND |
| 1                  | SINGLE FAM | 100%      | - 2000      |                | Heated Area: 1008 |     |     |      |      | HX Base Yr 2000 |        |

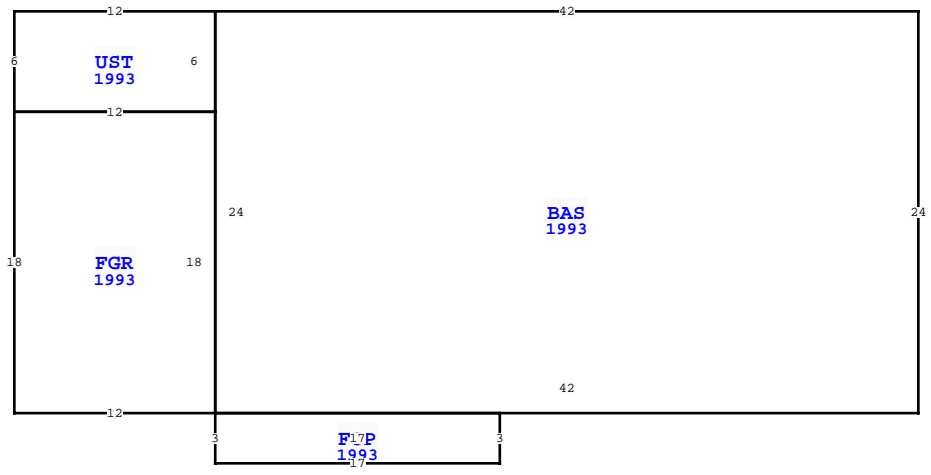

| WAKULLA COUNTY PROPERTY                            |              |     |             |
|--|--------------|-----|-------------|
| VALUATION SUMMARY                                  |              |     | PAGE 1 of 1 |
| VALUATION BY                                       |              |     | STANDARD    |
| Tax Group: 3                                       | Tax Dist:    |     |             |
| BUILDING MARKET VALUE                              |              |     | 99,470      |
| TOTAL MARKET OB/XF VALUE                           |              |     | 1,183       |
| TOTAL LAND VALUE - MARKET                          |              |     | 15,000      |
| TOTAL MARKET VALUE                                 |              |     | 115,653     |
| SOH/AGL Deduction                                  |              |     | 38,045      |
| ASSESSED VALUE                                     |              |     | 77,608      |
| TOTAL EXEMPTION VALUE                              | HX HB        |     | 50,000      |
| BASE TAXABLE VALUE                                 |              |     | 27,608      |
| TOTAL JUST VALUE                                   |              |     | 115,653     |
| NCON VALUE   |              |     | 0           |
| INCOME VALUE                                       |              |     |             |
| PREVIOUS YEAR MKT VALUE                            |              |     | 125,226     |
| FR PRMT CK 7/5/23 - CH BLDG ELMNT, ADJ EYB FOR NEW |              |     |             |
| 5 YR PRCL CH, N/C                                  |              |     |             |
| XFOB LN 1, CHG CODE XFOB LN 2                      |              |     |             |
| 5 YR PRCL CH, CORR EXW, QUAL, PU CORR DIMENS       |              |     |             |
| PERMIT NUM   | DESCRIPTION  | AMT | ISSUED      |
| OBN23-00018  | WINDOWS-CC   | 0   | 04/13/2023  |
| B22-001214   | ROOF OVER-CC | 0   | 12/19/2022  |

| SALES DATA                  |           |           |     |     |        |            |
|-----------------------------|-----------|-----------|-----|-----|--------|------------|
| OFF RECORD Number           | DATE      | TYPE INST | Q U | V I | RSN CD | SALE PRICE |
| 0349/0397                   | 3/31/1999 | WD Q      | Q   | I   |        | 70,000     |
| GRANTOR: SPIVEY DENISE ANNE |           |           |     |     |        |            |
| GRANTEE:                    |           |           |     |     |        |            |
| 0349/0396                   | 3/31/1999 | QC U      | U   | I   |        | 100        |
| GRANTOR: SPIVEY DENISE ANNE |           |           |     |     |        |            |
| GRANTEE:                    |           |           |     |     |        |            |

| EXTRA FEATURES |            |             |         |     |       |    |       |                |           |         |             |
|----------------|------------|-------------|---------|-----|-------|----|-------|----------------|-----------|---------|-------------|
| L N            | OB/XF CODE | DESCRIPTION | BLD CAP | L W | UNITS | UT | Adj R | ADJ UNIT PRICE | ORIG COND | YEAR ON | YEAR ACTUAL |
| 1              | 0210       | CONCRETE D  | 0       | 100 | 57    | 10 |       | 6.00           | 100       | 1980    | 1980        |
| 2              | 0090       | CHAINLINK   | 0       | 100 | 0     | 0  |       | 12.00          | 100       | 1999    | 1999        |

| TOTAL OB/XF |         |          |      |          |           |         |            |      |  |  |  |
|-------------|---------|----------|------|----------|-----------|---------|------------|------|--|--|--|
| 1,183       |         |          |      |          |           |         |            |      |  |  |  |
| BLD DATE    | XF DATE | INC DATE | FREB | LGL DATE | LAND DATE | AG DATE | 03/01/2021 | FREB |  |  |  |

| BUILDING NOTES |  |  |  |  |  |  |  |  |  |  |  |
|----------------|--|--|--|--|--|--|--|--|--|--|--|
|----------------|--|--|--|--|--|--|--|--|--|--|--|

| BUILDING DIMENSIONS   |  |  |  |  |  |  |  |  |  |  |  |
|---|--|--|--|--|--|--|--|--|--|--|--|
| BAS=[YR=1993] W42 UST=[YR=1993] W12 S6 FGR=[YR=1993] S18 E12 N18 W12\$ E12 N6\$ S24 FOP=[YR=1993] S3 E17 N3 W17 \$ E42 N24\$. |  |  |  |  |  |  |  |  |  |  |  |

| LAND DESCRIPTION |          |     |                      |     |     |          |        |        |             |           |     |
|------------------|----------|-----|----------------------|-----|-----|----------|--------|--------|-------------|-----------|-----|
| L N              | USE CODE | CLS | LAND USE DESCRIPTION | CAP | R D | LOC ZONE | FRONT  | DEPTH  | TOT LND UTS | UNIT TYPE | D T |
| 1                | 000100   | C   | SFR                  | 100 |     | R1       | 130.00 | 217.00 | 1.00        | LT        |     |