

AMELIAWOOD UNIT 2
BLOCK A LOT 41
OR 78 P 858

WINDHAM DANNA JEAN
185 MARIE CIR
CRAWFORDVILLE, FL 32327

2024

00-00-073-138-10189-A41



| BUILDING CHARACTERISTICS | | |
|--------------------------|------------------|----------------|
| ELEMENT | CD | CONSTRUCTION |
| Foundation | 02 | CONCR SLAB 100 |
| Frame | 02 | WOOD FRAME 100 |
| Exterior Wall | 13 | PREFAB PNL 80 |
| Exterior Wall | 19 | COMMON BRK 20 |
| Roof Structur | 03 | GABLE/HIP 100 |
| Roof Cover | 12 | MODULAR MT 100 |
| Interior Wall | 04 | PLYWOOD 50 |
| Interior Wall | 05 | DRYWALL 50 |
| Interior Floo | 11 | CLAY TILE 100 |
| Heating Type | 13 | HEAT PUMP 100 |
| Air Condition | 13 | HEAT PUMP 100 |
| Bedrooms | | 3 100 |
| Bathrooms | | 1.5 100 |
| Story Height | | 0 100 |
| Stories | 1. | 1. 100 |
| Units | | 0 100 |
| Quality | 03 | AVERAGE |
| DOR CODE | 0100 | SINGLE FAMILY |
| MAP NUM | 3 | MKT AREA 01 |
| NEIGHBORHOOD/LOC | 112.00 | 1.10/ |
| AREA TYPE | TOTAL GROSS AREA | PCT OF BASE |
| BAS | 1,008 | 100 |
| FGR | 216 | 50 |
| FOP | 21 | 30 |
| FOP | 84 | 30 |
| FST | 72 | 55 |
| UOP | 533 | 20 |
| TOTALS | 1,934 | |

| MARKET ADJUSTMENTS | | | | | | | | | | | | |
|------------------------------|------------|-----------|-------------|----------------|----------------|-----|-----|------|------|------|--------|--|
| TYPE | MDL | EFF. AREA | TOT ADJ PTS | EFF. BASE RATE | REPL. COST NEW | AYB | EYB | ECON | FNCT | NORM | % COND | |
| 1 | SINGLE FAM | 100% | - 0 | | | | | | | | | |
| Heated Area: 1008 HX Base Yr | | | | | | | | | | | | |

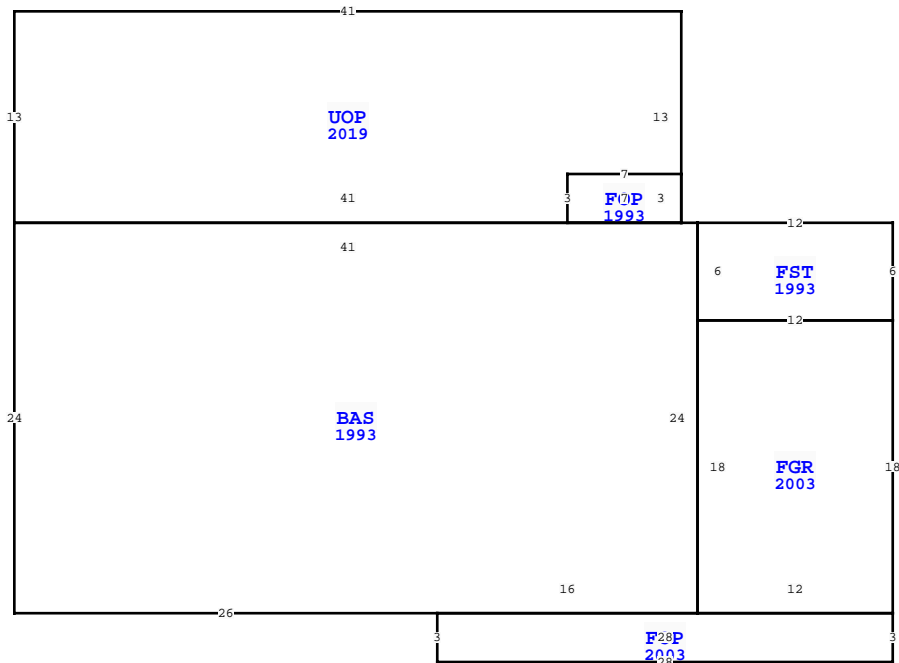

| WAKULLA COUNTY PROPERTY | | | |
|---|--------------|-----------|-------------------------------|
| VALUATION SUMMARY | | | PAGE 1 of 1 |
| VALUATION BY | | | STANDARD |
| Tax Group: 3 | Tax Dist: | | |
| BUILDING MARKET VALUE | | | 156,235 |
| TOTAL MARKET OB/XF VALUE | | | 13,540 |
| TOTAL LAND VALUE - MARKET | | | 15,000 |
| TOTAL MARKET VALUE | | | 184,775 |
| SOH/AGL Deduction | | | 106,481 |
| ASSESSED VALUE | | | 78,294 |
| TOTAL EXEMPTION VALUE | HX HB | | 50,000 |
| BASE TAXABLE VALUE | | | 28,294 |
| TOTAL JUST VALUE | | | 184,775 |
| NCON VALUE | | | 0 |
| INCOME VALUE | | | |
| PREVIOUS YEAR MKT VALUE | | | 138,098 |
| 5 YR PRCL CK, CHG EYB ON HOME & XFOBS | | | |
| PU NEW TRAVERSE | | | |
| PU XFOB 0955, 0080 CHG CODE LN 8, | | | |
| CHG RCVR, CORR DIMS XFOB LN 4, DEL XFOB 0055, | | | |
| PERMIT NUM | DESCRIPTION | AMT | ISSUED |
| 19000193 | ROOF OVER-CO | 0 | 04/01/2019 |
| SALES DATA | | | |
| OFF RECORD Number | DATE | TYPE INST | Q U / V I / RSN CD SALE PRICE |
| 0115/0559 | 10/01/1985 | WD U V | |
| GRANTOR: | | | |
| GRANTEE: | | | |
| BUILDING NOTES | | | |
| BUILDING DIMENSIONS | | | |
| FST=[YR=1993] W12 BAS=[YR=1993] W1 FOP=[YR=1993] W7 N3 E7 S3\$ UOP=[YR=2019] N13 W41 S13 E41\$ W41 S24 E26 FOP=[YR=2003] S3 E28 N3 W28\$ E16 N24\$ S6 FGR=[YR=2003] S18 E12 N18 W12\$ E12 N6\$. | | | |

| EXTRA FEATURES | | | | | | | | | | | | | | | | |
|----------------|------------|-------------|---------|----|----|--------|----|-------|----------------|-----------|---------|-------------|---|--------|-----------------|-------|
| L N | OB/XF CODE | DESCRIPTION | BLD CAP | L | W | UNITS | UT | Adj R | ADJ UNIT PRICE | ORIG COND | YEAR ON | YEAR ACTUAL | Q | % COND | OB/XF MKT VALUE | NOTES |
| 1 | 0210 | CONCRETE D | 0 100 | 54 | 10 | 540.00 | SF | 6.00 | 6.00 | 100 | 1981 | 1981 | 3 | 52 | 1,685 | |
| 2 | 0955 | PRIVACY FE | 0 100 | 0 | 0 | 162.00 | LF | 15.00 | 15.00 | 100 | 2003 | 2003 | 3 | 60 | 1,458 | |
| 3 | 0211 | CONCRETE W | 0 100 | 20 | 3 | 60.00 | SF | 6.00 | 6.00 | 100 | 2003 | 2003 | 3 | 67 | 241 | |
| 4 | 0050 | CARPORT UN | 0 100 | 39 | 10 | 390.00 | SF | 9.00 | 9.00 | 100 | 2003 | 2003 | 3 | 60 | 2,106 | |
| 6 | 0080 | 4' CHAINLI | 0 100 | 0 | 0 | 60.00 | LF | 13.00 | 13.00 | 100 | 2003 | 2003 | 3 | 62 | 484 | |
| 7 | 0740 | UNFINISH O | 0 100 | 10 | 10 | 100.00 | SF | 11.00 | 11.00 | 100 | 2012 | 2012 | 3 | 78 | 858 | |
| 9 | 0700 | PORT BLDG | 0 100 | 0 | 0 | 1.00 | SF | 0.00 | 0.00 | 100 | 2012 | 2012 | 3 | 78 | 0 | |
| 10 | 0955 | PRIVACY FE | 0 100 | 0 | 0 | 186.00 | LF | 15.00 | 15.00 | 100 | 2017 | 2017 | 3 | 91 | 2,539 | |
| 11 | 0080 | 4' CHAINLI | 0 100 | 0 | 0 | 422.00 | LF | 13.00 | 13.00 | 100 | 2017 | 2017 | 3 | 76 | 4,169 | |

| TOTAL OB/XF | | | | | | | | | | | | |
|-------------|------------|------|-----------|------------|--|--|--|--|--|--|--|--|
| 13,540 | | | | | | | | | | | | |
| BLD DATE | 02/26/2021 | FRFR | LGL DATE | | | | | | | | | |
| XF DATE | 02/26/2021 | FRFR | LAND DATE | 02/26/2021 | | | | | | | | |
| INC DATE | | | AG DATE | | | | | | | | | |

| LAND DESCRIPTION | | | | | | | | | | | | | | | | | | | | | | | | |
|------------------|----------|-----|----------------------|-----|-----|----------|-------|-------|-------------|-----------|-----|-----------|--------|---------|------------|----------------|------------|-----------------------------|------|---------|------|-----|----|--------|
| L N | USE CODE | CLS | LAND USE DESCRIPTION | CAP | R D | LOC ZONE | FRONT | DEPTH | TOT LND UTS | UNIT TYPE | D T | DPTH FACT | % COND | TOT ADJ | UNIT PRICE | ADJ UNIT PRICE | LAND VALUE | OTHER ADJUSTMENTS AND NOTES | YEAR | DENSITY | DECL | FRZ | YR | CONSRV |
| 1 | 000100 | C | SFR | 100 | | R1 | 0.00 | 0.00 | 1.00 | LT | | 1.00 | 1.00 | 1.00 | 15,000.00 | 15,000.00 | 15,000 | | | | | | | |