

THE HAMMOCKS PHASE I
 LOT 59 OR 692 P 530
 OR 700 P 67 OR 719 P 781

TETREault RONALD/TETREault KAYTLYN
 46 HAWTHORN PASS
 CRAWFORDVILLE, FL 32327

2024

00-00-073-335-10187-059

| ELEMENT | | CD | CONSTRUCTION | | |
|------------------|------------------|---------------|--------------|--------------|----------------------|
| Foundation | 02 | CONCR | SLAB 100 | | |
| Frame | 02 | WOOD | FRAME 100 | | |
| Exterior Wall | 05 | HARDIE BRD | 70 | | |
| Exterior Wall | 19 | COMMON BRK | 30 | | |
| Roof Structur | 03 | GABLE/HIP | 100 | | |
| Roof Cover | 03 | COMP SHNGL | 100 | | |
| Interior Wall | 05 | DRYWALL | 100 | | |
| Interior Floo | 13 | PARQUET | 70 | | |
| Interior Floo | 14 | CARPET | 30 | | |
| Heating Type | 13 | HEAT PUMP | 100 | | |
| Air Condition | 13 | HEAT PUMP | 100 | | |
| Bedrooms | | 4 | 100 | | |
| Bathrooms | | 2 | 100 | | |
| Story Height | | 0 | 100 | | |
| Stories | 1. | 1. | 100 | | |
| Fireplace Units | 01 | FIREPLACE | 100 | | |
| | | N/A | 100 | | |
| Quality | 03 | AVERAGE | | | |
| DOR CODE | 0100 | SINGLE FAMILY | | | |
| MAP NUM | 3 | MKT AREA | 10 | | |
| NEIGHBORHOOD/LOC | 335.00 | 1.00/ | | | |
| AREA TYPE | TOTAL GROSS AREA | PCT OF BASE | YEAR | TOT ADJ AREA | SUBAREA MARKET VALUE |
| BAS | 1,712 | 100 | 2007 | 1,712 | 175,208 |
| FGR | 529 | 50 | 2007 | 264 | 27,018 |
| FOP | 30 | 30 | 2007 | 9 | 921 |
| PTO | 250 | 5 | 2007 | 12 | 1,228 |
| TOTALS | 2,521 | | | 1,997 | 204,374 |

| MARKET ADJUSTMENTS | | | | | | | | | | | | |
|--------------------|------------|-----------|-------------|----------------|-------------------|-----|-----|------|------|-----------------|--------|--|
| TYPE | MDL | EFF. AREA | TOT ADJ PTS | EFF. BASE RATE | REPL. COST NEW | AYB | EYB | ECON | FNCT | NORM | % COND | |
| 1 | SINGLE FAM | 100% | - 2018 | | Heated Area: 1712 | | | | | HX Base Yr 2018 | | |

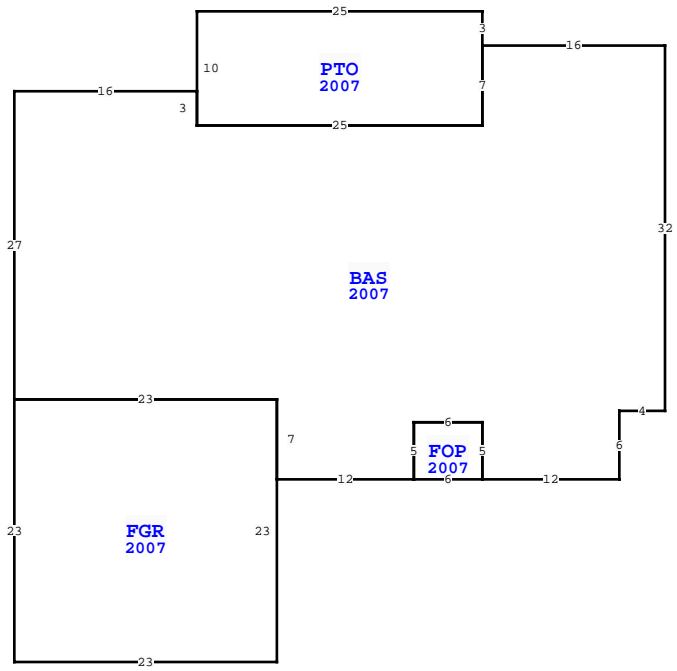

| WAKULLA COUNTY PROPERTY | | | |
|---|-------------|--------|-------------|
| VALUATION SUMMARY | | | PAGE 1 of 1 |
| VALUATION BY | | | STANDARD |
| Tax Group: 3 | Tax Dist: | | |
| BUILDING MARKET VALUE | | | 204,374 |
| TOTAL MARKET OB/XF VALUE | | | 6,998 |
| TOTAL LAND VALUE - MARKET | | | 55,000 |
| TOTAL MARKET VALUE | | | 266,372 |
| SOH/AGL Deduction | | | 71,951 |
| ASSESSED VALUE | | | 194,421 |
| TOTAL EXEMPTION VALUE | HX HB | 50,000 | |
| BASE TAXABLE VALUE | | | 144,421 |
| TOTAL JUST VALUE | | | 266,372 |
| NCON VALUE | | | 0 |
| INCOME VALUE | | | |
| PREVIOUS YEAR MKT VALUE | | | 236,576 |
| 5 YR PRCL CK, CHG EYB ON HOME & XFOBS, COULDN'T G | | | |
| 5 YR PRCL CK, CHG FLOR | | | |
| ADD HX FOR 2018 | | | |
| 5 YR PRCL CH, PU XFOB LN 5 | | | |
| PERMIT NUM | DESCRIPTION | AMT | ISSUED |
| 2007223 | SFD-CO | 0 | 02/14/2007 |

| SALES DATA | | | | | | |
|-------------------------------|-----------|-----------|-------|-------|--------|------------|
| OFF RECORD Number | DATE | TYPE INST | Q / U | V / I | RSN CD | SALE PRICE |
| 1010/0712 | 8/31/2016 | WD Q | Q | I | 01 | 193,900 |
| GRANTOR: KEETON ELIZABETH M F | | | | | | |
| GRANTEE: TETREault RONALD & | | | | | | |
| 0719/0781 | 7/13/2007 | WD Q | Q | V | | 206,000 |
| GRANTOR: MILLER GIBBES U JR | | | | | | |
| GRANTEE: DRENKHAHN ELIZABETH | | | | | | |

| EXTRA FEATURES | | | | | | | | | | | | | | | |
|----------------|------------|-------------|---------|-----------|--------|----|-------|----------------|-----------|---------|-------------|---|--------|-----------------|-------|
| L N | OB/XF CODE | DESCRIPTION | BLD CAP | L W | UNITS | UT | Adj R | ADJ UNIT PRICE | ORIG COND | YEAR ON | YEAR ACTUAL | Q | % COND | OB/XF MKT VALUE | NOTES |
| 1 | 0210 | CONCRETE D | 0 | 100 50 17 | 850.00 | SF | 6.00 | 6.00 | 100 | 2007 | 2007 | 3 | 67 | 3,417 | |
| 2 | 0211 | CONCRETE W | 0 | 100 36 3 | 108.00 | SF | 6.00 | 6.00 | 100 | 2007 | 2007 | 3 | 80 | 518 | |
| 4 | 0955 | PRIVACY FE | 0 | 100 0 0 | 252.00 | LF | 15.00 | 15.00 | 100 | 2008 | 2008 | 3 | 79 | 2,986 | |
| 5 | 0211 | CONCRETE W | 0 | 100 4 4 | 16.00 | SF | 6.00 | 6.00 | 100 | 2007 | 2007 | 3 | 80 | 77 | |

| BUILDING NOTES | | | | | | | | | | | | |
|---|--|--|--|--|--|--|--|--|--|--|--|--|
| BLD DATE 10/27/2020 MMJT LGL DATE 03/03/2020 JBBH | | | | | | | | | | | | |
| XF DATE 10/27/2020 MMJT LAND DATE | | | | | | | | | | | | |
| INC DATE AG DATE | | | | | | | | | | | | |

| BUILDING DIMENSIONS | | | | | | | | | | | | |
|--|--|--|--|--|--|--|--|--|--|--|--|--|
| BAS=[YR=2007] W16 PTO=[YR=2007] N3 W25 S10 E25 N7\$ S7 W25 N3 W16 S27 FGR=[YR=2007] S23 E23 N23 W23\$ E23 S7 E12 FOP=[YR=2007] E6 N5 W6 S5\$ N5 E6 S5 E12 N6 E4 N32\$. | | | | | | | | | | | | |

| LAND DESCRIPTION | | | | | | | | | | | | | TOTAL OB/XF | | | | | | | | | | | | |
|------------------|----------|-----|----------------------|-----|-----|----------|-------|-------|-------------|-----------|-----|----------|-------------|---------|------------|----------------|------------|-----------------------------|------|---------|------|-----|----|--------|--|
| L N | USE CODE | CLS | LAND USE DESCRIPTION | CAP | R D | LOC ZONE | FRONT | DEPTH | TOT LND UTS | UNIT TYPE | D T | DPH FACT | % COND | TOT ADJ | UNIT PRICE | ADJ UNIT PRICE | LAND VALUE | OTHER ADJUSTMENTS AND NOTES | YEAR | DENSITY | DECL | FRZ | YR | CONSRV | |
| 1 | 000100 | C | SFR | 100 | | | 0.00 | 0.00 | 1.00 | LT | | 1.00 | 1.00 | 1.00 | 55,000.00 | 55,000.00 | 55,000 | | | | | | | | |