

CAMELOT PHASE III LOT 35
 OR 527 P 361 OR 544 P 238
 OR 669 P 454 OR 720 P 263

MORRILL HERBERT L/MORILL KAREN MARIE
 22 EXCALIBUR DR
 CRAWFORDVILLE, FL 32327

2024

00-00-076-314-10250-E35

| ELEMENT | | CD | CONSTRUCTION | | |
|------------------|------------------|-------------|---------------|--------------|----------------------|
| Foundation | 02 | | CONCR | SLAB 100 | |
| Frame | 02 | | WOOD | FRAME 100 | |
| Exterior Wall | 30 | | VINYL | 80 | |
| Exterior Wall | 20 | | FACE | BRICK 20 | |
| Roof Structur | 03 | | GABLE/HIP | 100 | |
| Roof Cover | 03 | | COMP | SHNGL 100 | |
| Interior Wall | 05 | | DRYWALL | 100 | |
| Interior Floor | 10 | | LAMINATED | 50 | |
| Interior Floor | 14 | | CARPET | 50 | |
| Heating Type | 13 | | HEAT PUMP | 100 | |
| Air Condition | 13 | | HEAT PUMP | 100 | |
| Bedrooms | | | 3 | 100 | |
| Bathrooms | | | 2 | 100 | |
| Story Height | | | 0 | 100 | |
| Stories | | 1. | 1. | 100 | |
| Units | | | 0 | 100 | |
| Quality | 03 | | AVERAGE | | |
| DOR CODE | 0100 | | SINGLE FAMILY | | |
| MAP NUM | 3 | | MKT AREA | 01 | |
| NEIGHBORHOOD/LOC | 314.00 | | 1.00/ | | |
| AREA TYPE | TOTAL GROSS AREA | PCT OF BASE | YEAR | TOT ADJ AREA | SUBAREA MARKET VALUE |
| BAS | 1,158 | 100 | 2021 | 1,158 | 115,719 |
| FGR | 264 | 50 | 2021 | 132 | 13,191 |
| FOP | 24 | 30 | 2021 | 7 | 700 |
| PTO | 162 | 5 | 2021 | 8 | 800 |
| TOTALS | 1,608 | | | 1,305 | 130,410 |

| MARKET ADJUSTMENTS | | | | | | | | | | | | | | | |
|--------------------|-----------|-----------|-------------|----------------|----------------|-----|-----|------|------|------|--------|-------------------|--|--|-----------------|
| TYPE | MDL | EFF. AREA | TOT ADJ PTS | EFF. BASE RATE | REPL. COST NEW | AYB | EYB | ECON | FNCT | NORM | % COND | | | | |
| 1 | HALF-PLEX | 100% | - 2022 | | | | | | | | | Heated Area: 1158 | | | HX Base Yr 2022 |

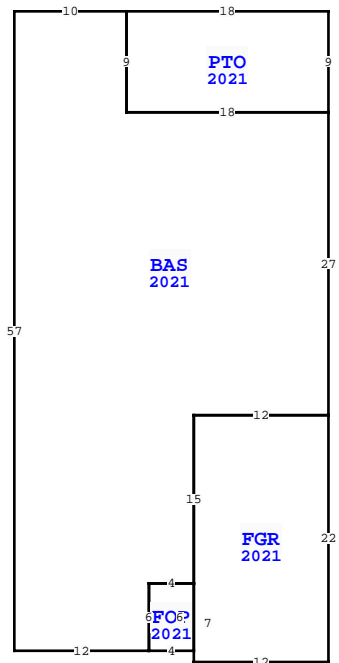

| WAKULLA COUNTY PROPERTY | | | |
|--|-------------|-----|-------------|
| VALUATION SUMMARY | | | PAGE 1 of 1 |
| VALUATION BY | | | STANDARD |
| Tax Group: 3 | Tax Dist: | | |
| BUILDING MARKET VALUE | | | 130,410 |
| TOTAL MARKET OB/XF VALUE | | | 3,264 |
| TOTAL LAND VALUE - MARKET | | | 20,000 |
| TOTAL MARKET VALUE | | | 153,674 |
| SOH/AGL Deduction | | | 20,640 |
| ASSESSED VALUE | | | 133,034 |
| TOTAL EXEMPTION VALUE | HX HB WR | | 55,000 |
| BASE TAXABLE VALUE | | | 78,034 |
| TOTAL JUST VALUE | | | 153,674 |
| NCON VALUE | | | 0 |
| INCOME VALUE | | | |
| PREVIOUS YEAR MKT VALUE | | | 155,116 |
| 5 YR PRCL CK, N/ C, BK YD GTE LOCKED | | | |
| SUBAREA YR CORRECTED TO 2021 NEW CONST ISSUE | | | |
| PU DUPLEX, XFOB POWER 12/06/2021 | | | |
| 5 YR PRCL CH, N/C | | | |
| PERMIT NUM | DESCRIPTION | AMT | ISSUED |
| 21000050 | SFD-CO | 0 | 06/28/2021 |

| SALES DATA | | | | | | |
|------------------------------|------------|-----------|-------|-------|--------|------------|
| OFF RECORD Number | DATE | TYPE INST | Q / U | V / I | RSN CD | SALE PRICE |
| 1267/0820 | 6/01/2022 | CD | U | I | 11 | 100 |
| GRANTOR: DEVORO HOMES, LLC | | | | | | |
| GRANTEE: MORRILL HERBERT L & | | | | | | |
| 1245/0887 | 12/30/2021 | WD | Q | I | 01 | 168,700 |
| GRANTOR: DEVORO HOMES, LLC | | | | | | |
| GRANTEE: MORRILL HERBERT L & | | | | | | |

| EXTRA FEATURES | | | | | | | | | | | | | | | | |
|----------------|------------|-------------|---------|-----|----|-------|----|-------|----------------|-----------|---------|-------------|---|--------|-----------------|-------|
| L N | OB/XF CODE | DESCRIPTION | BLD CAP | L | W | UNITS | UT | Adj R | ADJ UNIT PRICE | ORIG COND | YEAR ON | YEAR ACTUAL | Q | % COND | OB/XF MKT VALUE | NOTES |
| 1 | 0210 | CONCRETE D | 0 | 100 | 34 | 12 | | | 408.00 | 100 | 2021 | 2021 | 3 | 93 | 2,277 | |
| 2 | 0211 | CONCRETE W | 0 | 100 | 6 | 4 | | | 24.00 | 100 | 2021 | 2021 | 3 | 93 | 134 | |
| 3 | 0955 | PRIVACY FE | 0 | 100 | 0 | 0 | | | 58.00 | 100 | 2021 | 2021 | 3 | 98 | 853 | |

| BUILDING NOTES | | | |
|---|--|--|--|
| BLD DATE 01/18/2022 FRFR LGL DATE 01/18/2022 FRFR | | | |
| XF DATE 01/18/2022 FRFR LAND DATE 01/18/2022 FRFR | | | |
| INC DATE AG DATE | | | |

| BUILDING DIMENSIONS | | | |
|--|--|--|--|
| PTO=[YR=2021] W18 S9 E18 BAS=[YR=2021] W18 N9 W10 S57 E12 | | | |
| FOP=[YR=2021] E4 N6 W4 S6\$ N6 E4 FGR=[YR=2021] S7 E12 N22 W12 | | | |
| S15\$ N15 E12 N27\$ N9\$. | | | |

| LAND DESCRIPTION | | | | | | | | | | | | | | | TOTAL OB/XF | | | | | | | | | |
|------------------|----------|-----|----------------------|-----|-----|----------|-------|--------|-------------|-----------|-----|----------|--------|---------|-------------|----------------|------------|-----------------------------|------|---------|------|-----|----|--------|
| L N | USE CODE | CLS | LAND USE DESCRIPTION | CAP | R D | LOC ZONE | FRONT | DEPTH | TOT LND UTS | UNIT TYPE | D T | DPH FACT | % COND | TOT ADJ | UNIT PRICE | ADJ UNIT PRICE | LAND VALUE | OTHER ADJUSTMENTS AND NOTES | YEAR | DENSITY | DECL | FRZ | YR | CONSRV |
| 1 | 000100 | C | SFR | 100 | | HDR | 35.00 | 107.00 | 1.00 | LT | | 1.00 | 1.00 | 1.00 | 20,000.00 | 20,000.00 | 20,000 | | | | | | | |