

| ELEMENT | | CD | CONSTRUCTION | | |
|------------------|------------------|---------------|--------------|--------------|----------------------|
| Foundation | 02 | CONCR | SLAB | 100 | |
| Frame | 02 | WOOD | FRAME | 100 | |
| Exterior Wall | 30 | VINYL | 70 | | |
| Exterior Wall | 20 | FACE | BRICK | 30 | |
| Roof Structur | 03 | GABLE/HIP | 100 | | |
| Roof Cover | 03 | COMP | SHNGL | 100 | |
| Interior Wall | 05 | DRYWALL | 100 | | |
| Interior Floo | 14 | CARPET | 70 | | |
| Interior Floo | 11 | CLAY TILE | 30 | | |
| Heating Type | 13 | HEAT PUMP | 100 | | |
| Air Condition | 13 | HEAT PUMP | 100 | | |
| Bedrooms | | 3 | 100 | | |
| Bathrooms | | 2 | 100 | | |
| Story Height | | 0 | 100 | | |
| Stories | 1. | 1. | 100 | | |
| Fireplace | 01 | FIREPLACE | 100 | | |
| Units | | 0 | 100 | | |
| Quality | 03 | AVERAGE | | | |
| DOR CODE | 0100 | SINGLE FAMILY | | | |
| MAP NUM | 3 | MKT AREA | 10 | | |
| NEIGHBORHOOD/LOC | 14.00 | 1.25/ | | | |
| AREA TYPE | TOTAL GROSS AREA | PCT OF BASE | YEAR | TOT ADJ AREA | SUBAREA MARKET VALUE |
| BAS | 1,287 | 100 | 2006 | 1,287 | 151,835 |
| FGR | 546 | 50 | 2006 | 273 | 32,207 |
| FOP | 29 | 30 | 2006 | 9 | 1,062 |
| FOP | 142 | 30 | 2006 | 43 | 5,073 |
| TOTALS | 2,004 | | | 1,612 | 190,178 |

| MARKET ADJUSTMENTS | | | | | | | | | | | |
|--|-----|-----------|-------------|----------------|----------------|------|------|------|------|-------|--------|
| TYPE | MDL | EFF. AREA | TOT ADJ PTS | EFF. BASE RATE | REPL. COST NEW | AYB | EYB | ECON | FNCT | NORM | % COND |
| 0100 | 01 | 1,612 | 119.7000 | 142.14 | 229,130 | 2006 | 2006 | 0 | 0 | 17.00 | 83.00 |
| 1 SINGLE FAM 100% - 2019 Heated Area: 1287 HX Base Yr 2019 | | | | | | | | | | | |

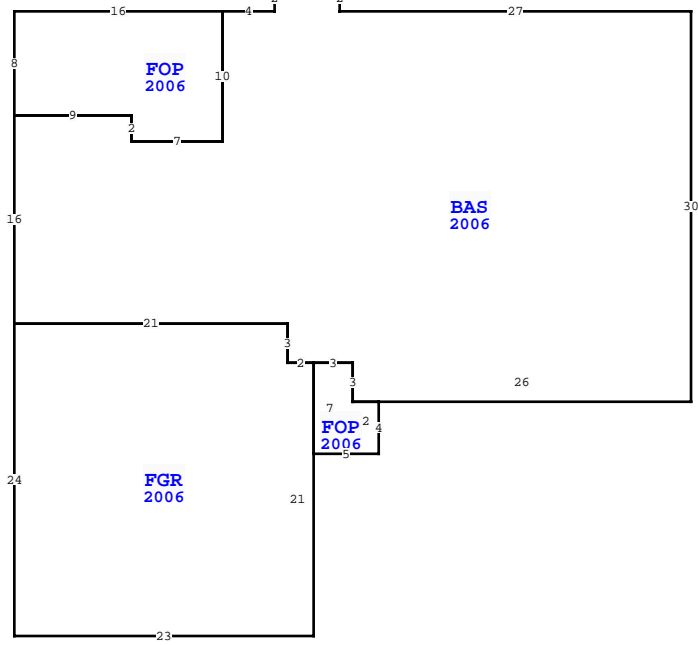

| WAKULLA COUNTY PROPERTY | | | |
|--|-------------|----------|-------------|
| VALUATION SUMMARY | | | PAGE 1 of 1 |
| VALUATION BY | | STANDARD | |
| Tax Group: 3 | Tax Dist: | | |
| BUILDING MARKET VALUE | 190,178 | | |
| TOTAL MARKET OB/XF VALUE | 2,696 | | |
| TOTAL LAND VALUE - MARKET | 12,000 | | |
| TOTAL MARKET VALUE | 204,874 | | |
| SOH/AGL Deduction | 57,332 | | |
| ASSESSED VALUE | 147,542 | | |
| TOTAL EXEMPTION VALUE | HX HB | 50,000 | |
| BASE TAXABLE VALUE | 97,542 | | |
| TOTAL JUST VALUE | 204,874 | | |
| NCON VALUE | 0 | | |
| INCOME VALUE | | | |
| PREVIOUS YEAR MKT VALUE | 146,595 | | |
| 5 YR PRCL CK, CHG QUAL TO AVG | | | |
| 5 YR PRCL CH, PU XFOB LN 5 | | | |
| ADD HX FOR 2019-RODDENBERRY | | | |
| SOH PORTED FROM 05065-S19 FOR 2017/HIGGINS | | | |
| PERMIT NUM | DESCRIPTION | AMT | ISSUED |
| 20051907 | SFD/CO | 0 | 11/28/2005 |

| SALES DATA | | | | | | |
|--------------------------------|-----------|-----------|-----|-----|--------|------------|
| OFF RECORD Number | DATE | TYPE INST | Q U | V I | RSN CD | SALE PRICE |
| 1077/0502 | 6/15/2018 | WD Q | I | 01 | | 147,000 |
| GRANTOR: HIGGINS KYLE & ALYSSA | | | | | | |
| 1002/0892 | 6/15/2016 | WD Q | I | 01 | | 131,000 |
| GRANTOR: WATTS THOMAS D JR & J | | | | | | |
| GRANTEE: HIGGINS KYLE & ALYS | | | | | | |

| EXTRA FEATURES | | | | | | | | | | | | | | | | | |
|----------------|------------|-------------|---------|-----|----|-------|----|-------|----------------|-----------|---------|-------------|------|--------|-----------------|-------|-------|
| L N | OB/XF CODE | DESCRIPTION | BLD CAP | L | W | UNITS | UT | Adj R | ADJ UNIT PRICE | ORIG COND | YEAR ON | YEAR ACTUAL | Q | % COND | OB/XF MKT VALUE | NOTES | |
| 2 | 0210 | CONCRETE D | 0 | 100 | 36 | 16 | | | 576.00 | SF | 6.00 | 100 | 2006 | 2006 | 3 | 27 | 933 |
| 3 | 0211 | CONCRETE W | 0 | 100 | 25 | 4 | | | 100.00 | SF | 6.00 | 100 | 2006 | 2006 | 3 | 27 | 162 |
| 4 | 0955 | PRIVACY FE | 0 | 100 | 0 | 0 | | | 175.00 | LF | 15.00 | 100 | 2010 | 2010 | 3 | 60 | 1,575 |
| 5 | 0211 | CONCRETE W | 0 | 100 | 4 | 4 | | | 16.00 | SF | 6.00 | 100 | 2006 | 2006 | 3 | 27 | 26 |

| TOTAL OB/XF | | | | | | | | | | | |
|-------------|--|--|--|--|--|--|--|--|--|--|--|
| 2,696 | | | | | | | | | | | |

| BUILDING NOTES | | | | | | | | | | | |
|--|--|--|--|--|--|--|--|--|--|--|--|
| BLD DATE 10/28/2019 MMAK LGL DATE 10/28/2019 MMAK XF DATE 07/16/2015 MMAK LAND DATE AG DATE INC DATE | | | | | | | | | | | |

| BUILDING DIMENSIONS | | | | | | | | | | | |
|---|--|--|--|--|--|--|--|--|--|--|--|
| BAS=[YR=2006] W27 N2 W5 S2 W4 FOP=[YR=2006] W16 S8 E9 S2 E7 N10\$ S10 W7 N2 W9 S16 FGR=[YR=2006] S24 E23 N21 W2 N3 W21\$ E21 S3 E2 FOP=[YR=2006] S7 E5 N4 W2 N3 W3\$ E3 S3 E26 N30\$. | | | | | | | | | | | |

| LAND DESCRIPTION | | | | | | | | | | | | | | | | | | | | | | | | |
|------------------|----------|-----|----------------------|-----|-----|----------|-------|--------|-------------|-----------|-----|----------|--------|---------|------------|----------------|------------|-----------------------------|------|---------|------|-----|----|--------|
| L N | USE CODE | CLS | LAND USE DESCRIPTION | CAP | R D | LOC ZONE | FRONT | DEPTH | TOT LND UTS | UNIT TYPE | D T | DPH FACT | % COND | TOT ADJ | UNIT PRICE | ADJ UNIT PRICE | LAND VALUE | OTHER ADJUSTMENTS AND NOTES | YEAR | DENSITY | DECL | FRZ | YR | CONSRV |
| 1 | 000100 | C | SFR | 100 | | | 75.00 | 100.00 | 1.00 | LT | | 1.00 | 1.00 | 1.00 | 12,000.00 | 12,000.00 | 12,000 | | | | | | | |