

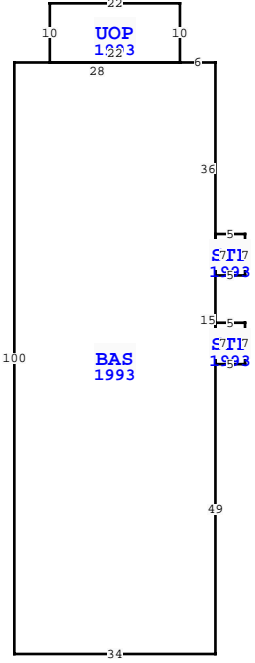

| BUILDING CHARACTERISTICS |                  | CONSTRUCTION       |      |
|--------------------------|------------------|--------------------|------|
| ELEMENT                  | CD               |                    |      |
| Foundation               | 02               | CONCR SLAB         | 100  |
| Frame                    | 03               | MASONRY            | 100  |
| Exterior Wall            | 15               | CONC BLOCK         | 100  |
| Roof Structur            | 03               | GABLE/HIP          | 100  |
| Roof Cover               | 13               | GALVALUM           | 100  |
| Interior Wall            | 05               | DRYWALL            | 100  |
| Interior Floor           | 05               | ASPH TILE          | 50   |
| Interior Floor           | 14               | CARPET             | 50   |
| Ceiling                  | 01               | FIN.SUSPD          | 100  |
| Heating Type             | 13               | HEAT PUMP          | 100  |
| Air Condition            | 13               | HEAT PUMP          | 100  |
| Fixtures                 |                  | 5                  | 100  |
| Story Height             |                  | 0                  | 100  |
| RMS                      |                  | 5                  | 100  |
| Stories                  | 1.1              | 1.100              |      |
| Class                    | 00               | N/A                | 100  |
| Units                    |                  | 0                  | 100  |
| Quality                  | 03               | AVERAGE            |      |
| DOR CODE                 | 7700             | CLUBS/LODGES/HALLS |      |
| MAP NUM                  | 3                | MKT AREA           | 10   |
| NEIGHBORHOOD/LOC         | 000              | 1.00/              |      |
| AREA TYPE                | TOTAL GROSS AREA | PCT OF BASE        | YEAR |
| BAS                      | 3,400            | 100                | 1993 |
| STP                      | 35               | 10                 | 1993 |
| STP                      | 35               | 10                 | 1993 |
| UOP                      | 220              | 20                 | 1993 |
| TOTALS                   | 3,690            |                    |      |

| MARKET ADJUSTMENTS |            |           |             |                |                |     |     |      |      |      |        |                   |  |
|--------------------|------------|-----------|-------------|----------------|----------------|-----|-----|------|------|------|--------|-------------------|--|
| TYPE               | MDL        | EFF. AREA | TOT ADJ PTS | EFF. BASE RATE | REPL. COST NEW | AYB | EYB | ECON | FNCT | NORM | % COND |                   |  |
| 1                  | CLUB/RECRE | 0%        | 0           |                |                |     |     |      |      |      |        | Heated Area: 3400 |  |
|                    |            |           |             |                |                |     |     |      |      |      |        | HX Base Yr        |  |



| WAKULLA COUNTY PROPERTY                               |              |           |                               |
|---|--------------|-----------|-------------------------------|
| VALUATION SUMMARY                                     |              |           | PAGE 1 of 1                   |
| VALUATION BY  |              |           | STANDARD                      |
| Tax Group: 3  | Tax Dist:    |           |                               |
| BUILDING MARKET VALUE                                 |              |           | 183,570                       |
| TOTAL MARKET OB/XF VALUE                              |              |           | 0                             |
| TOTAL LAND VALUE - MARKET                             |              |           | 39,500                        |
| TOTAL MARKET VALUE                                    |              |           | 223,070                       |
| SOH/AGL Deduction                                     |              |           | 133,132                       |
| ASSESSED VALUE  |              |           | 89,938                        |
| TOTAL EXEMPTION VALUE                                 | 10           |           | 89,938                        |
| BASE TAXABLE VALUE                                    |              |           | 0                             |
| TOTAL JUST VALUE                                      |              |           | 223,070                       |
| NCON VALUE  |              |           | 0                             |
| INCOME VALUE  |              |           |                               |
| PREVIOUS YEAR MKT VALUE                               |              |           | 171,991                       |
| 5 YR PRCL CK, CHG EYB 1980 TO 1990, CHG TRAV FOP T    |              |           |                               |
| 5 YR PRCL CHK, N/C                                    |              |           |                               |
| & A/C, PU CORR TRAV                                   |              |           |                               |
| 5 YR PRCL CH, CHG FIXT & RMS, CORR RCVR, HTTP         |              |           |                               |
| PERMIT NUM  | DESCRIPTION  | AMT       | ISSUED                        |
| 1600037   | SEWER & ELEC | 0         | 01/20/2016                    |
| 16000037  | SEWER        | 0         | 01/20/2016                    |
| 2014344   | MECH         | 0         | 04/28/2014                    |
| 2014169   | FNDN         | 0         | 03/04/2014                    |
| SALES DATA  |              |           |                               |
| OFF RECORD Number                                     | DATE         | TYPE INST | Q / V / I / RSN CD SALE PRICE |
|   |              |           |                               |
| BUILDING NOTES  |              |           |                               |
| BUILDING DIMENSIONS                                   |              |           |                               |
| BAS=[YR=1993;ORIG=0,0] W6 W28 S100 E34 N49 N15 N36 \$ |              |           |                               |
| UOP=[YR=1993;ORIG=-6,0] N10 W22 S10 E22 \$            |              |           |                               |
| STP=[YR=1993;ORIG=0,51] E5 N7 W5 S7 \$                |              |           |                               |
| STP=[YR=1993;ORIG=0,36] E5 N7 W5 S7 \$                |              |           |                               |

| EXTRA FEATURES |            |             |         |   |   |       |    |       |                |           |         |             |   |        |                 |       |
|----------------|------------|-------------|---------|---|---|-------|----|-------|----------------|-----------|---------|-------------|---|--------|-----------------|-------|
| L N            | OB/XF CODE | DESCRIPTION | BLD CAP | L | W | UNITS | UT | Adj R | ADJ UNIT PRICE | ORIG COND | YEAR ON | YEAR ACTUAL | Q | % COND | OB/XF MKT VALUE | NOTES |
|                |            |             |         |   |   |       |    |       |                |           |         |             |   |        |                 |       |

| LAND DESCRIPTION |          |     |                      |     |     |          |       |        |             |           |     |           |        | TOTAL OB/XF |            |                |            |                             |      |         |      |     |    |        |
|------------------|----------|-----|----------------------|-----|-----|----------|-------|--------|-------------|-----------|-----|-----------|--------|-------------|------------|----------------|------------|-----------------------------|------|---------|------|-----|----|--------|
| L N              | USE CODE | CLS | LAND USE DESCRIPTION | CAP | R D | LOC ZONE | FRONT | DEPTH  | TOT LND UTS | UNIT TYPE | D T | DPHT FACT | % COND | TOT ADJ     | UNIT PRICE | ADJ UNIT PRICE | LAND VALUE | OTHER ADJUSTMENTS AND NOTES | YEAR | DENSITY | DECL | FRZ | YR | CONSRV |
| 1                | 007700   | C   | CLUB                 | 0   |     | R1       | 82.00 | 171.00 | 1.00        | LT        |     | 1.00      | 1.00   | 1.00        | 39,500.00  | 39,500.00      | 39,500     |                             |      |         |      |     |    |        |