

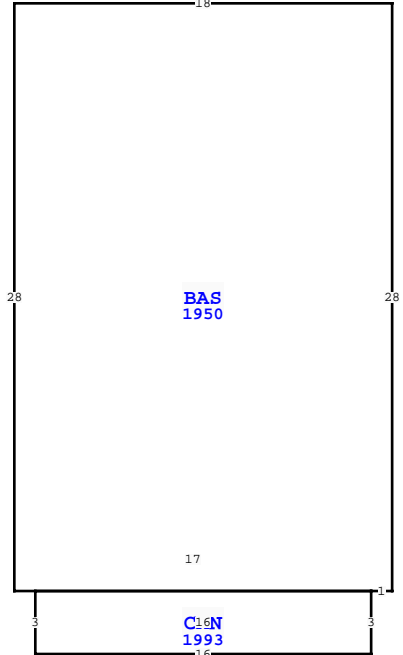

BUILDING CHARACTERISTICS		CONSTRUCTION	
ELEMENT	CD		
Foundation	02	CONCR	SLAB 100
Frame	03	MASONRY	100
Exterior Wall	15	CONC	BLOCK 100
Roof Structure	03	GABLE/HIP	100
Roof Cover	01	MINIMUM	100
Interior Wall	04	PLYWOOD	100
Interior Floor	14	CARPET	100
Ceiling	01	FIN.SUSPD	100
Heating Type	02	CONVECTION	100
Air Condition	02	WINDOW	100
Fixtures		2	100
Story Height		0	100
RMS		2	100
Stories	0	0	100
Class	00	N/A	100
Units		0	100
Quality	03	AVERAGE	
DOR CODE	1700	OFFICE	BUILDING
MAP NUM	3	MKT AREA	10
NEIGHBORHOOD/LOC	000	1.00/	
AREA TYPE	TOTAL GROSS AREA	PCT OF BASE	YEAR
BAS	504	100	1950
CAN	48	30	1993
TOTALS	552		

MARKET ADJUSTMENTS											
TYPE	MDL	EFF. AREA	TOT ADJ PTS	EFF. BASE RATE	REPL. COST NEW	AYB	EYB	ECON	FNCT	NORM	% COND
1 OFFICE	0%	0			75,183	1950	1950	0	0	60.00	40.00
Heated Area: 504 HX Base Yr											



WAKULLA COUNTY PROPERTY			
VALUATION SUMMARY			3
VALUATION BY		STANDARD	
Tax Group: 3	Tax Dist:		
BUILDING MARKET VALUE			94,529
TOTAL MARKET OB/XF VALUE			597
TOTAL LAND VALUE - MARKET			43,900
TOTAL MARKET VALUE			139,026
SOH/AGL Deduction			67,932
ASSESSED VALUE			71,094
TOTAL EXEMPTION VALUE			0
BASE TAXABLE VALUE			71,094
TOTAL JUST VALUE			139,026
NCON VALUE			0
INCOME VALUE			
PREVIOUS YEAR MKT VALUE			105,952
5 YR PRCL CK, CHG QUAL MIN TO AVG BUILD-1,CHG QUAL			
CHG QUALITY, PU XFOB 0060 ON CARD 2			
XFOB LN 2			
5 YR PRCL CH, N/C CARD 1, CORR INT CARD 2, PU			
PERMIT NUM	DESCRIPTION	AMT	ISSUED
21000578	SAFETY INSPEC-CO	0	05/26/2021
19000059	REROOF-CO	0	02/04/2019
16000976	SAFETY INSP	0	10/03/2016
201425	MECH	0	01/13/2014
2013871	RE-ROOF	0	12/04/2013

SALES DATA						
OFF RECORD Number	DATE	TYPE INST	Q U	V I	RSN CD	SALE PRICE
0149/0821	2/13/1989	QC	U	V		100

EXTRA FEATURES																
L N	OB/XF CODE	DESCRIPTION	BLD CAP	L	W	UNITS	UT	Adj R	ADJ UNIT PRICE	ORIG COND	YEAR ON	YEAR ACTUAL	Q	% COND	OB/XF MKT VALUE	NOTES
1	0211	CONCRETE W	0	0	24	12			6.00	100	1980	1980	3	24	415	
2	0211	CONCRETE W	0	0	0	0			6.00	100	1990	1990	3	20	182	

BLD DATE		06/17/2021	MMJS	LGL DATE	06/17/2021	MMJS
XF DATE	06/17/2021	MMJS	LAND DATE	06/17/2021	MMJS	
INC DATE			AG DATE			

BUILDING NOTES														
BUILDING DIMENSIONS														
BAS=[YR=1950] W18 S28 E17 CAN=[YR=1993] W16 S3 E16 N3\$ E1 N28\$.														

LAND DESCRIPTION										TOTAL OB/XF														
L N	USE CODE	CLS	LAND USE DESCRIPTION	CAP	R D	LOC ZONE	FRONT	DEPTH	TOT LND UTS	UNIT TYPE	D T	DPH FACT	% COND	TOT ADJ	UNIT PRICE	ADJ UNIT PRICE	LAND VALUE	OTHER ADJUSTMENTS AND NOTES	YEAR	DENSITY	DECL	FRZ	YR	CONSRV
1	001700	C	1STORY OFF	0		C3	58.00	85.00	58.00	FF		1.00	1.00	1.00	550.00	550.00	31,900							
2	001000	C	VAC COMMERCI	0		C3	58.00	85.00	2.00	LT		1.00	1.00	1.00	6,000.00	6,000.00	12,000							

