

| BUILDING CHARACTERISTICS |                  | CONSTRUCTION |      |
|--------------------------|------------------|--------------|------|
| ELEMENT                  | CD               |              |      |
| Foundation               | 02               | CONCR SLAB   | 100  |
| Frame                    | 02               | WOOD FRAME   | 100  |
| Exterior Wall            | 30               | VINYL        | 90   |
| Exterior Wall            | 20               | FACE BRICK   | 10   |
| Roof Structur            | 03               | GABLE/HIP    | 100  |
| Roof Cover               | 03               | COMP SHNGL   | 100  |
| Interior Wall            | 05               | DRYWALL      | 100  |
| Interior Floo            | 11               | CLAY TILE    | 50   |
| Interior Floo            | 14               | CARPET       | 50   |
| Heating Type             | 13               | HEAT PUMP    | 100  |
| Air Condition            | 13               | HEAT PUMP    | 100  |
| Bedrooms                 |                  | 3            | 100  |
| Bathrooms                |                  | 2            | 100  |
| Story Height             |                  | 0            | 100  |
| Stories                  | 1.               | 1.           | 100  |
| Fireplace                | 01               | FIREPLACE    | 100  |
| Units                    |                  | 0            | 100  |
| Quality                  | 03               | AVERAGE      |      |
| DOR CODE                 | 0401 TOWNHOUSE   |              |      |
| MAP NUM                  | 3                | MKT AREA     | 10   |
| NEIGHBORHOOD/LOC         | 306.00 1.00/     |              |      |
| AREA TYPE                | TOTAL GROSS AREA | PCT OF BASE  | YEAR |
| BAS                      | 1,514            | 100          | 2006 |
| FEP                      | 84               | 80           | 2006 |
| FGR                      | 360              | 50           | 2006 |
| FOP                      | 50               | 30           | 2006 |
| TOTALS                   | 2,008            |              |      |

| MARKET ADJUSTMENTS |           |           |             |                |                |     |     |      |      |      |        |                   |                 |
|--------------------|-----------|-----------|-------------|----------------|----------------|-----|-----|------|------|------|--------|-------------------|-----------------|
| TYPE               | MDL       | EFF. AREA | TOT ADJ PTS | EFF. BASE RATE | REPL. COST NEW | AYB | EYB | ECON | FNCT | NORM | % COND |                   |                 |
| 1                  | HALF-PLEX | 100%      | - 2008      |                |                |     |     |      |      |      |        | Heated Area: 1581 | HX Base Yr 2008 |

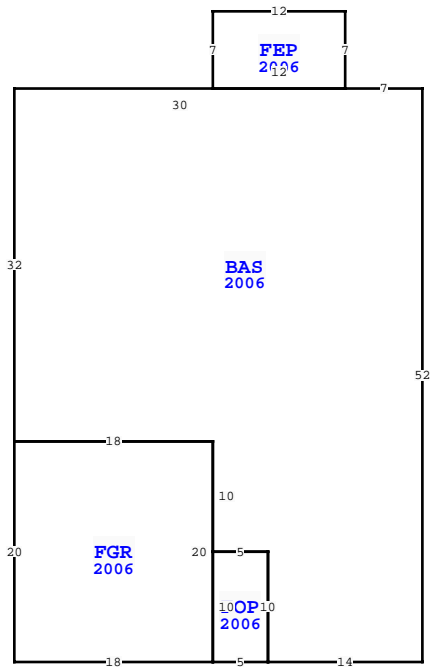

| WAKULLA COUNTY PROPERTY                |                  |     |             |
|--|------------------|-----|-------------|
| VALUATION SUMMARY                      |                  |     | PAGE 1 of 1 |
| VALUATION BY                           |                  |     | STANDARD    |
| Tax Group: 3                           | Tax Dist:        |     |             |
| BUILDING MARKET VALUE                  |                  |     | 144,438     |
| TOTAL MARKET OB/XF VALUE               |                  |     | 1,810       |
| TOTAL LAND VALUE - MARKET              |                  |     | 30,000      |
| TOTAL MARKET VALUE                     |                  |     | 176,248     |
| SOH/AGL Deduction                      |                  |     | 62,777      |
| ASSESSED VALUE                         |                  |     | 113,471     |
| TOTAL EXEMPTION VALUE                  | HX HB WX SX DX   |     | 110,000     |
| BASE TAXABLE VALUE                     |                  |     | 3,471       |
| TOTAL JUST VALUE                       |                  |     | 176,248     |
| NCON VALUE                             |                  |     | 0           |
| INCOME VALUE                           |                  |     |             |
| PREVIOUS YEAR MKT VALUE                |                  |     | 178,226     |
| DC OR 1373 P 348 ELIZABETH HICKMAN     |                  |     |             |
| 5 YR PRCL CK, CHG EYB ON HOME AND XFOB |                  |     |             |
| 5 YR PRCL CH, PU XFOB LN 4             |                  |     |             |
| 5 YR PRCL CH, CHG EXW                  |                  |     |             |
| PERMIT NUM                             | DESCRIPTION      | AMT | ISSUED      |
| 17000862                               | MECH             | 0   | 06/22/2017  |
| 20051373                               | CONDO - CO 8/1/6 | 0   | 09/06/2005  |

| SALES DATA                   |            |           |     |     |        |            |
|------------------------------|------------|-----------|-----|-----|--------|------------|
| OFF RECORD Number            | DATE       | TYPE INST | Q U | V I | RSN CD | SALE PRICE |
| 1096/0296                    | 12/27/2018 | QC        | U   | I   | 14     | 100        |
| GRANTOR: HICKMAN ELIZABETH A |            |           |     |     |        |            |
| GRANTEE: GILBERT TYLER ANNE  |            |           |     |     |        |            |
| 0706/0480                    | 4/13/2007  | WD        | Q   | I   |        | 170,000    |
| GRANTOR: BRACKENCHASE        |            |           |     |     |        |            |
| GRANTEE: HICKMAN ELIZABETH & |            |           |     |     |        |            |

| EXTRA FEATURES |            |             |         |     |    |       |    |       |                |           |         |             |     |        |                 |       |    |       |  |
|----------------|------------|-------------|---------|-----|----|-------|----|-------|----------------|-----------|---------|-------------|-----|--------|-----------------|-------|----|-------|--|
| L N            | OB/XF CODE | DESCRIPTION | BLD CAP | L   | W  | UNITS | UT | Adj R | ADJ UNIT PRICE | ORIG COND | YEAR ON | YEAR ACTUAL | Q   | % COND | OB/XF MKT VALUE | NOTES |    |       |  |
| 1              | 0210       | CONCRETE D  | 0       | 100 | 24 | 14    |    |       | 336.00         | SF        | 6.00    | 6.00        | 100 | 2006   | 2006            | 3     | 57 | 1,149 |  |
| 2              | 0211       | CONCRETE W  | 0       | 100 | 11 | 5     |    |       | 55.00          | SF        | 6.00    | 6.00        | 100 | 2006   | 2006            | 3     | 57 | 188   |  |
| 4              | 0955       | PRIVACY FE  | 0       | 100 | 0  | 0     |    |       | 45.00          | LF        | 15.00   | 15.00       | 100 | 2006   | 2006            | 3     | 70 | 473   |  |

| BLD DATE |            | 06/29/2020 | MMAK      | LGL DATE   | 06/29/2020 | MMAK |
|----------|------------|------------|-----------|------------|------------|------|
| XF DATE  | 06/29/2020 | MMAK       | LAND DATE | 06/29/2020 | MMAK       |      |
| INC DATE |            |            | AG DATE   |            |            |      |

| BUILDING NOTES  |  |
|---|--|
| 34 COVINGTON CIR, CRAWFORDVILLE   |  |
| BUILDING DIMENSIONS   |  |
| BAS=[YR=2006] W7 FEP=[YR=2006] N7 W12 S7 E12\$ W30 S32                                  |  |
| FGR=[YR=2006] S20 E18 N20 W18\$ E18 S10 FOP=[YR=2006] S10 E5 N10 W5\$ E5 S10 E14 N52\$. |  |

| LAND DESCRIPTION |          |     |                      |     |     |          |       |        |             | TOTAL OB/XF |     |          |        |         |            |                |            |                             |      |         |      |     |    |        |
|------------------|----------|-----|----------------------|-----|-----|----------|-------|--------|-------------|-------------|-----|----------|--------|---------|------------|----------------|------------|-----------------------------|------|---------|------|-----|----|--------|
| L N              | USE CODE | CLS | LAND USE DESCRIPTION | CAP | R D | LOC ZONE | FRONT | DEPTH  | TOT LND UTS | UNIT TYPE   | D T | DPH FACT | % COND | TOT ADJ | UNIT PRICE | ADJ UNIT PRICE | LAND VALUE | OTHER ADJUSTMENTS AND NOTES | YEAR | DENSITY | DECL | FRZ | YR | CONSRV |
| 1                | 000100   | C   | SFR                  | 100 |     | RTH      | 45.00 | 106.00 | 1.00        | LT          |     | 1.00     | 1.00   | 1.00    | 30,000.00  | 30,000.00      | 30,000     |                             |      |         |      |     |    |        |