

| BUILDING CHARACTERISTICS | | | | | |
|--------------------------|------------------|----------------|------|--------------|----------------------|
| ELEMENT | CD | CONSTRUCTION | | | |
| Foundation | 02 | CONCR SLAB 100 | | | |
| Frame | 02 | WOOD FRAME 100 | | | |
| Exterior Wall | 30 | VINYL 100 | | | |
| Roof Structur | 03 | GABLE/HIP 100 | | | |
| Roof Cover | 03 | COMP SHNGL 100 | | | |
| Interior Wall | 05 | DRYWALL 100 | | | |
| Interior Floor | 14 | CARPET 80 | | | |
| Interior Floor | 11 | CLAY TILE 20 | | | |
| Heating Type | 13 | HEAT PUMP 100 | | | |
| Air Condition | 13 | HEAT PUMP 100 | | | |
| Bedrooms | | 3 100 | | | |
| Bathrooms | | 2 100 | | | |
| Story Height | | 0 100 | | | |
| Stories | 1. | 1. 100 | | | |
| Units | | 0 100 | | | |
| Quality | 08 | FAIR | | | |
| DOR CODE | 0100 | SINGLE FAMILY | | | |
| MAP NUM | 3 | MKT AREA 10 | | | |
| NEIGHBORHOOD/LOC | 13.00 | 1.25/ | | | |
| AREA TYPE | TOTAL GROSS AREA | PCT OF BASE | YEAR | TOT ADJ AREA | SUBAREA MARKET VALUE |
| BAS | 1,213 | 100 | 2007 | 1,213 | 127,101 |
| FOP | 24 | 30 | 2007 | 7 | 734 |
| FOP | 50 | 30 | 2007 | 15 | 1,572 |
| TOTALS | 1,287 | | | 1,235 | 129,406 |

| MARKET ADJUSTMENTS | | | | | | | | | | | | | |
|---|-----|-----------|-------------|----------------|----------------|------|------|------|------|-------|--------|--|--|
| TYPE | MDL | EFF. AREA | TOT ADJ PTS | EFF. BASE RATE | REPL. COST NEW | AYB | EYB | ECON | FNCT | NORM | % COND | | |
| 0100 | 01 | 1,235 | 102.6000 | 121.84 | 150,472 | 2007 | 2009 | 0 | 0 | 14.00 | 86.00 | | |
| 1 SINGLE FAM 0% - 2023 Heated Area: 1213 HX Base Yr | | | | | | | | | | | | | |

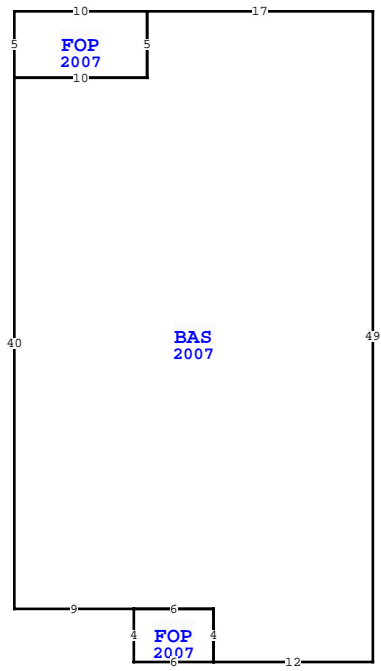

| WAKULLA COUNTY PROPERTY | | | |
|---|-------------|-----------|-------------|
| VALUATION SUMMARY | | | PAGE 1 of 1 |
| VALUATION BY | | STANDARD | |
| Tax Group: 3 | | Tax Dist: | |
| BUILDING MARKET VALUE | | 129,406 | |
| TOTAL MARKET OB/XF VALUE | | 2,118 | |
| TOTAL LAND VALUE - MARKET | | 15,300 | |
| TOTAL MARKET VALUE | | 146,824 | |
| SOH/AGL Deduction | | 15,135 | |
| ASSESSED VALUE | | 131,689 | |
| TOTAL EXEMPTION VALUE | | 0 | |
| BASE TAXABLE VALUE | | 131,689 | |
| TOTAL JUST VALUE | | 146,824 | |
| NCON VALUE | | 0 | |
| INCOME VALUE | | | |
| PREVIOUS YEAR MKT VALUE | | 119,717 | |
| 5 YR PRCL CK, CHG QUAL FAIR TO AVG, XFOB - FUTURE P | | | |
| INCR EYB 2007-2009 HVAC-CC 9-2022 | | | |
| 5 YR PRCL CH, CHG CODE XFOB LN 2 | | | |
| RECALC 2019 & 2020 SOH- PRGRM ERROR | | | |
| PERMIT NUM | DESCRIPTION | AMT | ISSUED |
| 22000594 | HVAC-CC | 0 | 09/23/2022 |
| 2007760 | SFD-CO | 0 | 05/22/2007 |

| SALES DATA | | | | | | |
|--------------------------------|------------|-----------|-----|-----|--------|------------|
| OFF RECORD Number | DATE | TYPE INST | Q U | V I | RSN CD | SALE PRICE |
| 1277/0826 | 8/03/2022 | WD | Q | I | 01 | 179,000 |
| GRANTOR: POLLARD MARION L & ER | | | | | | |
| GRANTEE: REYES RAMIRO G & AN | | | | | | |
| 0780/0222 | 11/26/2008 | WD | Q | I | | 119,100 |
| GRANTOR: BROWN STACY P. & VICK | | | | | | |
| GRANTEE: POLLARD MARION L. & | | | | | | |

| EXTRA FEATURES | | | | | | | | | | | | | | | | |
|----------------|------------|-------------|---------|---|----|--------|----|-------|----------------|-----------|---------|-------------|---|--------|-----------------|-------|
| L N | OB/XF CODE | DESCRIPTION | BLD CAP | L | W | UNITS | UT | Adj R | ADJ UNIT PRICE | ORIG COND | YEAR ON | YEAR ACTUAL | Q | % COND | OB/XF MKT VALUE | NOTES |
| 1 | 0955 | PRIVACY FE | 0 | 0 | 0 | 166.00 | LF | 15.00 | 15.00 | 100 | 2013 | 2013 | 3 | 75 | 1,868 | |
| 2 | 0625 | PORT WD UT | 0 | 0 | 10 | 80.00 | SF | 6.00 | 6.00 | 100 | 2012 | 2012 | 3 | 52 | 250 | |

| BLD DATE | | 03/06/2020 | FRAK | LGL DATE | |
|----------|------------|------------|-----------|------------|----|
| XF DATE | 03/06/2020 | FRAK | LAND DATE | 03/09/2019 | JB |
| INC DATE | | | AG DATE | | |

| BUILDING NOTES | |
|--|--|
| | |
| BUILDING DIMENSIONS | |
| BAS=[YR=2007] W17 FOP=[YR=2007] W10 S5 E10 N5\$ S5 W10 S40 E9 FOP=[YR=2007] S4 E6 N4 W6\$ E6 S4 E12 N49\$. | |

| LAND DESCRIPTION | | | | | | | | | | TOTAL OB/XF | | | | | | | | | | | | | | |
|------------------|----------|-----|----------------------|-----|-----|----------|-------|--------|-------------|-------------|-----|----------|--------|---------|------------|----------------|------------|-----------------------------|------|---------|------|-----|----|--------|
| L N | USE CODE | CLS | LAND USE DESCRIPTION | CAP | R D | LOC ZONE | FRONT | DEPTH | TOT LND UTS | UNIT TYPE | D T | DPH FACT | % COND | TOT ADJ | UNIT PRICE | ADJ UNIT PRICE | LAND VALUE | OTHER ADJUSTMENTS AND NOTES | YEAR | DENSITY | DECL | FRZ | YR | CONSRV |
| 1 | 000100 | C | SFR | 0 | | | 50.00 | 100.00 | 1.00 | LT | | 1.00 | 1.00 | 1.00 | 15,300.00 | 15,300.00 | 15,300 | | | | | | | |