

| BUILDING CHARACTERISTICS |                  |                |
|--------------------------|------------------|----------------|
| ELEMENT                  | CD               | CONSTRUCTION   |
| Foundation               | 02               | CONCR SLAB 100 |
| Frame                    | 02               | WOOD FRAME 100 |
| Exterior Wall            | 30               | VINYL 100      |
| Roof Structur            | 03               | GABLE/HIP 100  |
| Roof Cover               | 03               | COMP SHNGL 100 |
| Interior Wall            | 05               | DRYWALL 100    |
| Interior Floo            | 08               | SHT VINYL 100  |
| Ceiling                  | 08               | 8 FT 100       |
| Heating Type             | 13               | HEAT PUMP 100  |
| Air Condition            | 13               | HEAT PUMP 100  |
| Bedrooms                 |                  | 3 100          |
| Bathrooms                |                  | 2 100          |
| Stories                  | 1.               | 1. 100         |
| Units                    |                  | 0 100          |
| Condition Adj            | 12               | AVERAGE 100    |
| Quality                  | 03               | AVERAGE        |
| DOR CODE                 | 0100             | SINGLE FAMILY  |
| MAP NUM                  | 3                | MKT AREA 10    |
| NEIGHBORHOOD/LOC         | 13.00            | 1.25/          |
| AREA TYPE                | TOTAL GROSS AREA | PCT OF BASE    |
| BAS                      | 1,271            | 100            |
| FOP                      | 42               | 30             |
| PTO                      | 12               | 5              |
| PTO                      | 87               | 5              |
| TOTALS                   | 1,412            |                |

| MARKET ADJUSTMENTS |            |           |                   |                |                |                 |      |      |      |      |        |
|--------------------|------------|-----------|-------------------|----------------|----------------|-----------------|------|------|------|------|--------|
| TYPE               | MDL        | EFF. AREA | TOT ADJ PTS       | EFF. BASE RATE | REPL. COST NEW | AYB             | EYB  | ECON | FNCT | NORM | % COND |
| 1                  | SINGLE FAM | 100%      | - 2024            |                | 165,314        | 2023            | 2023 | 0    | 0    | 0.00 | 100.00 |
|                    |            |           | Heated Area: 1271 |                |                | HX Base Yr 2024 |      |      |      |      |        |

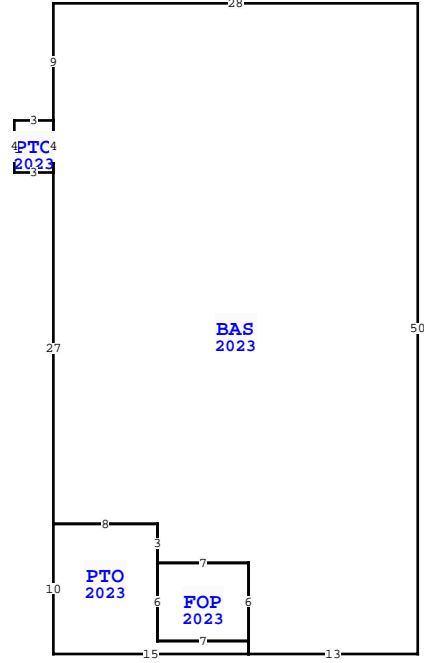

| WAKULLA COUNTY PROPERTY  |             |            |                    |
|--|-------------|------------|--------------------|
| VALUATION SUMMARY  |             |            | PAGE 1 of 1        |
| VALUATION BY   |             |            | STANDARD           |
| Tax Group: 3   | Tax Dist:   |            |                    |
| BUILDING MARKET VALUE  |             |            | 165,314            |
| TOTAL MARKET OB/XF VALUE   |             |            | 4,065              |
| TOTAL LAND VALUE - MARKET  |             |            | 12,000             |
| TOTAL MARKET VALUE   |             |            | 181,379            |
| SOH/AGL Deduction  |             |            | 0                  |
| ASSESSED VALUE   |             |            | 181,379            |
| TOTAL EXEMPTION VALUE  | HX HB       |            | 50,000             |
| BASE TAXABLE VALUE   |             |            | 131,379            |
| TOTAL JUST VALUE   |             |            | 181,379            |
| NCON VALUE   |             |            | 169,379            |
| INCOME VALUE   |             |            |                    |
| PREVIOUS YEAR MKT VALUE  |             |            | 11,475             |
| 5 YR PRCL CK, DEMO HX NO ONE LIVES HERE, SFD IS FO                 |             |            |                    |
| FR PU NCON & XFOBS 05-01-2023. LA 12/23                            |             |            |                    |
| 5 YR PRCL CH, N/C  |             |            |                    |
| 5 YR PRCL CH, N/C  |             |            |                    |
| PERMIT NUM   | DESCRIPTION | AMT        | ISSUED             |
| 22000116   | SFD-CO      | 0          | 12/19/2022         |
| SALES DATA   |             |            |                    |
| OFF RECORD Number  | DATE        | TYPE INST  | Q / V / I / RSN CD |
| 1310/0647  | 4/28/2023   | WD Q       | I 01               |
|  |             | SALE PRICE | 225,900            |
| GRANTOR: S & P CONSTRUCTION &                                      |             |            |                    |
| GRANTEE: LINDSTROM MARC AARO                                       |             |            |                    |
| 1274/0553  | 7/14/2022   | WD Q       | V 01               |
|  |             | SALE PRICE | 10,000             |
| GRANTOR: MILEY MARCIA  |             |            |                    |
| GRANTEE: S & P CONSTRUCTION  |             |            |                    |
| BUILDING NOTES   |             |            |                    |
| BUILDING DIMENSIONS  |             |            |                    |
| BAS=[YR=2023;ORIG=-60,-10] S9 S4 S27 E8 S3 E7 S6 S1 E13 N50 W28 \$ |             |            |                    |
| PTO=[YR=2023;ORIG=-63,-1] E3 S4 W3 N4 \$                           |             |            |                    |
| PTO=[YR=2023;ORIG=-60,30] S10 E15 N1 W7 N6 N3 W8 \$                |             |            |                    |
| FOP=[YR=2023;ORIG=-52,33] E7 S6 W7 N6 \$                           |             |            |                    |

| EXTRA FEATURES |            |             |         |    |    |        |    |       |                |           |         |             |    |        |                 |         |  |
|----------------|------------|-------------|---------|----|----|--------|----|-------|----------------|-----------|---------|-------------|----|--------|-----------------|---------|--|
| L N            | OB/XF CODE | DESCRIPTION | BLD CAP | L  | W  | UNITS  | UT | Adj R | ADJ UNIT PRICE | ORIG COND | YEAR ON | YEAR ACTUAL | Q  | % COND | OB/XF MKT VALUE | NOTES   |  |
| 1              | 0210       | CONCRETE D  | 0 100   | 20 | 20 | 400.00 | SF | 6.00  | 6.00           | 100       | 2024    | 2023        | AV | 100    | 2,400           |         |  |
| 2              | 0211       | CONCRETE W  | 0 100   | 5  | 3  | 15.00  | SF | 6.00  | 6.00           | 100       | 2024    | 2023        | AV | 100    | 90              |         |  |
| 3              | 0955       | PRIVACY FE  | 0 100   | 0  | 0  | 105.00 | LF | 15.00 | 15.00          | 100       | 2024    | 2023        | AV | 100    | 1,575           |         |  |
| TOTALS         |            |             |         |    |    |        |    |       |                |           |         |             |    |        | 1,289           | 165,314 |  |

| LAND DESCRIPTION |          |     |                      |     |     |          |       |       |             |           |     |          |        |         | TOTAL OB/XF |                |            |                             |      |         |      |     |    |        |
|------------------|----------|-----|----------------------|-----|-----|----------|-------|-------|-------------|-----------|-----|----------|--------|---------|-------------|----------------|------------|-----------------------------|------|---------|------|-----|----|--------|
| L N              | USE CODE | CLS | LAND USE DESCRIPTION | CAP | R D | LOC ZONE | FRONT | DEPTH | TOT LND UTS | UNIT TYPE | D T | DPH FACT | % COND | TOT ADJ | UNIT PRICE  | ADJ UNIT PRICE | LAND VALUE | OTHER ADJUSTMENTS AND NOTES | YEAR | DENSITY | DECL | FRZ | YR | CONSRV |
| 1                | 000100   | C   | SFR                  | 100 |     |          | 50.00 | 93.00 | 1.00        | LT        |     | 1.00     | 1.00   | 1.00    | 12,000.00   | 12,000.00      | 12,000     |                             |      |         |      |     |    |        |