

MAGNOLIA GARDENS BLOCK J
 LOT 41 OR 72 P 878
 OR 73 P 514 OR 431 P 611

COX DARIN L/COX BECKY
 621 WOODVILLE HWY
 CRAWFORDVILLE, FL 32327

2024

00-00-078-013-11076-041

| ELEMENT | | CD | | CONSTRUCTION | |
|------------------|------------------|-------------|--------|--------------|----------------------|
| Foundation | 02 | CONCR | SLAB | 100 | |
| Frame | 02 | WOOD | FRAME | 100 | |
| Exterior Wall | 30 | VINYL | 90 | | |
| Exterior Wall | 19 | COMMON | BRK | 10 | |
| Roof Structur | 03 | GABLE/HIP | 100 | | |
| Roof Cover | 03 | COMP | SHNGL | 100 | |
| Interior Wall | 05 | DRYWALL | 100 | | |
| Interior Floo | 08 | SHT | VINYL | 50 | |
| Interior Floo | 14 | CARPET | 50 | | |
| Heating Type | 04 | AIR | DUCTED | 100 | |
| Air Condition | 03 | CENTRAL | 100 | | |
| Bedrooms | | 3 | 100 | | |
| Bathrooms | | 2 | 100 | | |
| Story Height | | 0 | 100 | | |
| Stories | 1. | 1. | 100 | | |
| Units | | 0 | 100 | | |
| Quality | 08 | FAIR | | | |
| DOR CODE | 0100 | SINGLE | FAMILY | | |
| MAP NUM | 3 | MKT | AREA | 10 | |
| NEIGHBORHOOD/LOC | 13.00 | 1.25/ | | | |
| AREA TYPE | TOTAL GROSS AREA | PCT OF BASE | YEAR | TOT ADJ AREA | SUBAREA MARKET VALUE |
| BAS | 1,230 | 100 | 2007 | 1,230 | 121,246 |
| BAS | 150 | 100 | 2013 | 150 | 14,787 |
| FOP | 30 | 30 | 2007 | 9 | 887 |
| TOTALS | 1,410 | | | 1,389 | 136,919 |

| MARKET ADJUSTMENTS | | | | | | | | | | | | | |
|--|-----|-----------|-------------|----------------|----------------|------|------|------|------|-------|--------|--|--|
| TYPE | MDL | EFF. AREA | TOT ADJ PTS | EFF. BASE RATE | REPL. COST NEW | AYB | EYB | ECON | FNCT | NORM | % COND | | |
| 0100 | 01 | 1,389 | 98.8200 | 117.35 | 162,999 | 2007 | 2007 | 0 | 0 | 16.00 | 84.00 | | |
| 1 SINGLE FAM 100% - 2015 Heated Area: 1380 HX Base Yr 2015 | | | | | | | | | | | | | |

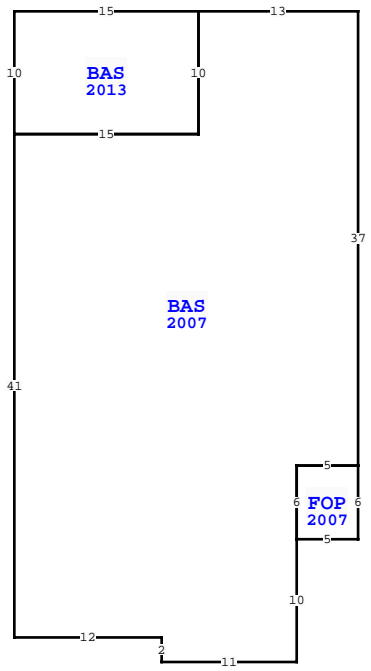

| WAKULLA COUNTY PROPERTY | | | | PAGE 1 of 1 | 3 | |
|---|-------------|-----------|------------|-------------|--------|------------|
| VALUATION SUMMARY | | | | | | |
| VALUATION BY | | | | STANDARD | | |
| Tax Group: 3 | | Tax Dist: | | | | |
| BUILDING MARKET VALUE | | | | 136,919 | | |
| TOTAL MARKET OB/XF VALUE | | | | 1,386 | | |
| TOTAL LAND VALUE - MARKET | | | | 15,300 | | |
| TOTAL MARKET VALUE | | | | 153,605 | | |
| SOH/AGL Deduction | | | | 47,080 | | |
| ASSESSED VALUE | | | | 106,525 | | |
| TOTAL EXEMPTION VALUE | | | | 50,000 | | |
| BASE TAXABLE VALUE | | | | 56,525 | | |
| TOTAL JUST VALUE | | | | 153,605 | | |
| NCON VALUE | | | | 0 | | |
| INCOME VALUE | | | | | | |
| PREVIOUS YEAR MKT VALUE | | | | 125,093 | | |
| H5 DUE TO COA PER NCOA REPORT | | | | | | |
| 5 YR PRCL CK, DEMO/PU XFOB, CHG QUAL FROM FAIR TO | | | | | | |
| 5 YR PRCL CHK, N/C | | | | | | |
| CORR TRAV, PU XFOB LN 2-4 | | | | | | |
| PERMIT NUM | DESCRIPTION | AMT | ISSUED | | | |
| 20061357 | SFD-CO | 0 | 08/18/2006 | | | |
| SALES DATA | | | | | | |
| OFF RECORD Number | DATE | TYPE INST | Q / U | V / I | RSN CD | SALE PRICE |
| 1373/0779 | 8/15/2024 | WD | Q | I | 01 | 150,000 |
| GRANTOR: CORT LINDA A | | | | | | |
| GRANTEE: COX DARIN L | | | | | | |
| 0943/0068 | 5/23/2014 | QC | U | I | 11 | 100,000 |
| GRANTOR: DEERING PHILIP A. & V | | | | | | |
| GRANTEE: CORT LINDA A & PAUL | | | | | | |
| BUILDING NOTES | | | | | | |
| BUILDING DIMENSIONS | | | | | | |
| BAS=[YR=2007] W13 BAS=[YR=2013] W15 S10 E15 N10\$ S10 W15 S41 E12 S2 E11 N10 FOP=[YR=2007] E5 N6 W5 S6\$ N6 E5 N37\$. | | | | | | |

| EXTRA FEATURES | | | | | | | | | | | | | | | | |
|----------------|------------|-------------|---------|-----|----|-------|----|-------|----------------|-----------|---------|-------------|---|--------|-----------------|-------|
| L N | OB/XF CODE | DESCRIPTION | BLD CAP | L | W | UNITS | UT | Adj R | ADJ UNIT PRICE | ORIG COND | YEAR ON | YEAR ACTUAL | Q | % COND | OB/XF MKT VALUE | NOTES |
| 1 | 0210 | CONCRETE D | 0 | 100 | 39 | 8 | | | 312.00 | 100 | 2007 | 2007 | 3 | 30 | 562 | |
| 2 | 0955 | PRIVACY FE | 0 | 100 | 0 | 0 | | | 8.00 | 100 | 2009 | 2009 | 3 | 55 | 66 | |
| 3 | 0955 | PRIVACY FE | 0 | 100 | 0 | 0 | | | 64.00 | 100 | 2014 | 2014 | 3 | 79 | 758 | |
| 4 | 0605 | PORT VINYL | 0 | 100 | 8 | 6 | | | 48.00 | 100 | 2013 | 2013 | 3 | 57 | 0 | |
| TOTALS | | | | | | | | | | | | | | 1,386 | | |

| LAND DESCRIPTION | | | | | | | | | | | | | | TOTAL OB/XF | | | | | | | | | | |
|------------------|----------|-----|----------------------|-----|-----|----------|-------|--------|-------------|-----------|-----|----------|--------|-------------|------------|----------------|------------|-----------------------------|------|---------|------|-----|----|--------|
| L N | USE CODE | CLS | LAND USE DESCRIPTION | CAP | R D | LOC ZONE | FRONT | DEPTH | TOT LND UTS | UNIT TYPE | D T | DPH FACT | % COND | TOT ADJ | UNIT PRICE | ADJ UNIT PRICE | LAND VALUE | OTHER ADJUSTMENTS AND NOTES | YEAR | DENSITY | DECL | FRZ | YR | CONSRV |
| 1 | 000100 | C | SFR | 100 | | | 50.00 | 100.00 | 1.00 | LT | | 1.00 | 1.00 | 1.00 | 15,300.00 | 15,300.00 | 15,300 | | | | | | | |