

WILDWOOD ACRES UNIT 1
 BLOCK B LOT 2
 OR 57 P 533 535 536 & 540

ROBERTS BOBBY E JR/ROBERTS ELIZABETH
 128 WILDWOOD DR
 CRAWFORDVILLE, FL 32327

2024

00-00-086-128-11586-020



| ELEMENT | | CD | | CONSTRUCTION | |
|------------------|------------------|---------------|--------|--------------|----------------------|
| Foundation | 02 | CONCR | SLAB | 100 | |
| Frame | 30 | WOOD | FRAME | 100 | |
| Exterior Wall | 02 | VINYL | 90 | | |
| Exterior Wall | 19 | COMMON | BRK | 10 | |
| Roof Structur | 03 | GABLE/HIP | 100 | | |
| Roof Cover | 03 | COMP | SHNGL | 100 | |
| Interior Wall | 05 | DRYWALL | 100 | | |
| Interior Floo | 08 | SHT | VINYL | 50 | |
| Interior Floo | 14 | CARPET | 50 | | |
| Heating Type | 04 | AIR | DUCTED | 100 | |
| Air Condition | 03 | CENTRAL | 100 | | |
| Bedrooms | | 3 | 100 | | |
| Bathrooms | | 2 | 100 | | |
| Story Height | | 0 | 100 | | |
| Stories | 1. | 1. | 100 | | |
| Units | | 0 | 100 | | |
| Quality | 03 | AVERAGE | | | |
| DOR CODE | 0100 | SINGLE FAMILY | | | |
| MAP NUM | 5 | MKT AREA | 08 | | |
| NEIGHBORHOOD/LOC | 000 | 1.00/ | | | |
| AREA TYPE | TOTAL GROSS AREA | PCT OF BASE | YEAR | TOT ADJ AREA | SUBAREA MARKET VALUE |
| BAS | 1,582 | 100 | 1998 | 1,582 | 119,890 |
| FGR | 440 | 50 | 1998 | 220 | 16,672 |
| FOP | 20 | 30 | 1998 | 6 | 454 |
| FOP | 96 | 30 | 2007 | 29 | 2,198 |
| FSP | 160 | 55 | 1999 | 88 | 6,669 |
| TOTALS | 2,298 | | | 1,925 | 145,883 |

| MARKET ADJUSTMENTS | | | | | | | | | | | | |
|--|-----|-----------|-------------|----------------|----------------|------|------|------|------|-------|--------|--|
| TYPE | MDL | EFF. AREA | TOT ADJ PTS | EFF. BASE RATE | REPL. COST NEW | AYB | EYB | ECON | FNCT | NORM | % COND | |
| 0100 | 01 | 1,925 | 107.8000 | 102.41 | 197,139 | 1997 | 1997 | 0 | 0 | 26.00 | 74.00 | |
| 1 SINGLE FAM 100% - 2000 Heated Area: 1582 HX Base Yr 2000 | | | | | | | | | | | | |

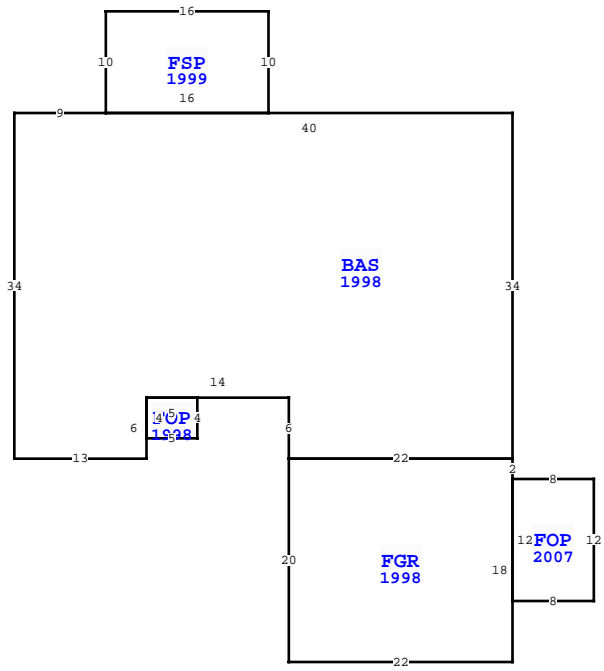

| WAKULLA COUNTY PROPERTY | | | |
|--|-------------|-----------|-------------|
| VALUATION SUMMARY | | | PAGE 1 of 1 |
| VALUATION BY | | STANDARD | |
| Tax Group: 3 | | Tax Dist: | |
| BUILDING MARKET VALUE | | 145,883 | |
| TOTAL MARKET OB/XF VALUE | | 6,181 | |
| TOTAL LAND VALUE - MARKET | | 20,000 | |
| TOTAL MARKET VALUE | | 172,064 | |
| SOH/AGL Deduction | | 42,649 | |
| ASSESSED VALUE | | 129,415 | |
| TOTAL EXEMPTION VALUE | | 50,000 | |
| BASE TAXABLE VALUE | | 79,415 | |
| TOTAL JUST VALUE | | 172,064 | |
| NCON VALUE | | 0 | |
| INCOME VALUE | | | |
| PREVIOUS YEAR MKT VALUE | | 174,073 | |
| 5 YR PRCL CH, DEL XFOB LN 11 | | | |
| 5 YR PRCL CH, CORR LF XFOB LN 1, PU XFOB LN 11 | | | |
| CODE XFOB LN 4, PU XFOB LN 9-10 | | | |
| LF XFOB LN 1, PU CORR DIMENS XFOB LN 2, CHG | | | |
| PERMIT NUM | DESCRIPTION | AMT | ISSUED |
| 19000309 | REROOF-CO | 0 | 03/13/2019 |
| 2007135 | UTL BLDG | 0 | 01/30/2007 |
| 22147 | N/A | 0 | 04/17/1997 |

| SALES DATA | | | | | | |
|--------------------------------|-----------|-----------|-------|-------|--------|------------|
| OFF RECORD Number | DATE | TYPE INST | Q / U | V / I | RSN CD | SALE PRICE |
| 0360/0542 | 8/18/1999 | WD Q | Q | I | | 111,000 |
| GRANTOR: ROBERTS BOBBY E JR & | | | | | | |
| GRANTEE: | | | | | | |
| 0344/0356 | 1/28/1999 | WD U | U | I | | 100 |
| GRANTOR: INDERDAHL HOWARD K JR | | | | | | |
| GRANTEE: | | | | | | |

| EXTRA FEATURES | | | | | | | | | | | | | | | | |
|----------------|------------|-------------|---------|-----|----|----------|----|----------|----------------|-----------|---------|-------------|---|--------|-----------------|-------|
| L N | OB/XF CODE | DESCRIPTION | BLD CAP | L | W | UNITS | UT | Adj R | ADJ UNIT PRICE | ORIG COND | YEAR ON | YEAR ACTUAL | Q | % COND | OB/XF MKT VALUE | NOTES |
| 1 | 0955 | PRIVACY FE | 0 | 100 | 0 | 403.00 | LF | 15.00 | 15.00 | 100 | 1999 | 1999 | 3 | 0 | 0 | |
| 2 | 0210 | CONCRETE D | 0 | 100 | 71 | 1,136.00 | SF | 6.00 | 6.00 | 100 | 1997 | 1997 | 3 | 20 | 1,363 | |
| 3 | 0130 | FIRE PLACE | 0 | 100 | 0 | 1.00 | UT | 1,300.00 | 1,300.00 | 100 | 1997 | 1997 | 3 | 54 | 702 | |
| 4 | 0055 | PORTABLE C | 0 | 100 | 20 | 360.00 | SF | 3.00 | 3.00 | 100 | 1999 | 1999 | 3 | 20 | 216 | |
| 5 | 0700 | PORT BLDG | 0 | 100 | 10 | 80.00 | SF | 8.00 | 8.00 | 100 | 1999 | 1999 | 3 | 56 | 358 | |
| 6 | 0211 | CONCRETE W | 0 | 100 | 42 | 3 | SF | 6.00 | 6.00 | 100 | 1997 | 1997 | 3 | 20 | 151 | |
| 7 | 0625 | PORT WD UT | 0 | 100 | 24 | 14 | SF | 6.00 | 6.00 | 100 | 2007 | 2007 | 3 | 30 | 605 | |
| 8 | 0940 | OPEN SHED | 0 | 100 | 24 | 11 | SF | 4.00 | 4.00 | 100 | 2007 | 2007 | 3 | 30 | 317 | |
| 9 | 0770 | PUMP HOUSE | 0 | 100 | 5 | 4 | SF | 5.00 | 5.00 | 100 | 2007 | 2007 | 3 | 40 | 40 | |
| 10 | 0955 | PRIVACY FE | 0 | 100 | 0 | 205.00 | LF | 15.00 | 15.00 | 100 | 2014 | 2014 | 3 | 79 | 2,429 | |

| TOTAL OB/XF | | | | | | | | | | | | |
|--------------------------------|------------|------|----------|------------|------|-----------|------------|------|---------|--|--|--|
| BLD DATE | 11/25/2019 | MMSR | LGL DATE | 11/25/2019 | MMSR | LAND DATE | 11/25/2019 | MMSR | AG DATE | | | |
| 128 WILDWOOD DR, CRAWFORDVILLE | | | | | | | | | | | | |
| TOTALS 6,181 | | | | | | | | | | | | |

| BUILDING NOTES | | | | | | | | | | | | |
|----------------|--|--|--|--|--|--|--|--|--|--|--|--|
| | | | | | | | | | | | | |

| BUILDING DIMENSIONS | | | | | | | | | | | | |
|---|--|--|--|--|--|--|--|--|--|--|--|--|
| BAS=[YR=1998] W40 FSP=[YR=1999] E16 N10 W16 S10\$ W9 S34 E13 N6 FOP=[YR=1998] S4 E5 N4 W5\$ E14 S6 E22 FGR=[YR=1998] W22 S20 E22 N18 FOP=[YR=2007] S12 E8 N12 W8\$ N2\$ N34 \$. | | | | | | | | | | | | |

| LAND DESCRIPTION | | | | | | | | | | | | | | | | | | | | | | | | |
|------------------|----------|-----|----------------------|-----|-----|----------|--------|--------|-------------|-----------|-----|----------|--------|---------|------------|----------------|------------|-----------------------------|------|---------|------|-----|----|--------|
| L N | USE CODE | CLS | LAND USE DESCRIPTION | CAP | R D | LOC ZONE | FRONT | DEPTH | TOT LND UTS | UNIT TYPE | D T | DPH FACT | % COND | TOT ADJ | UNIT PRICE | ADJ UNIT PRICE | LAND VALUE | OTHER ADJUSTMENTS AND NOTES | YEAR | DENSITY | DECL | FRZ | YR | CONSRV |
| 1 | 000100 | C | SFR | 100 | | | 207.00 | 210.00 | 1.00 | LT | | 1.00 | 1.00 | 1.00 | 20,000.00 | 20,000.00 | 20,000 | | | | | | | |