

| ELEMENT | CD | CONSTRUCTION |
|------------------|------------------|----------------|
| Foundation | 01 | WOOD FRAME 100 |
| Frame | 02 | WOOD FRAME 100 |
| Exterior Wall | 06 | BD/BATTEN 100 |
| Roof Structur | 03 | GABLE/HIP 100 |
| Roof Cover | 13 | GALVALUM 100 |
| Interior Wall | 05 | DRYWALL 100 |
| Interior Floo | 09 | PINE WOOD 100 |
| Heating Type | 02 | CONVECTION 100 |
| Air Condition | 02 | WINDOW 100 |
| Bedrooms | | 3 100 |
| Bathrooms | | 1 100 |
| Story Height | | 0 100 |
| Stories | 1. | 1. 100 |
| Units | | 0 100 |
| Quality | 02 | BELOW AVERAGE |
| DOR CODE | 5000 | IMPRVD AG RES |
| MAP NUM | 4 | MKT AREA 08 |
| NEIGHBORHOOD/LOC | 000 | 1.00/ |
| AREA TYPE | TOTAL GROSS AREA | PCT OF BASE |
| BAS | 768 | 100 |
| BAS | 112 | 100 |
| FOP | 160 | 30 |
| UOP | 112 | 20 |
| TOTALS | 1,152 | 950 |

| MARKET ADJUSTMENTS | | | | | | | | | | | |
|----------------------------------|------------|-----------|-------------|----------------|----------------|--------|------|------|------|------|--------|
| TYPE | MDL | EFF. AREA | TOT ADJ PTS | EFF. BASE RATE | REPL. COST NEW | AYB | EYB | ECON | FNCT | NORM | % COND |
| 1 | SINGLE FAM | 100% | - 2020 | | 85.60 | 81,320 | 1950 | 1950 | 0 | 0 | 60.00 |
| Heated Area: 880 HX Base Yr 2020 | | | | | | | | | | | |

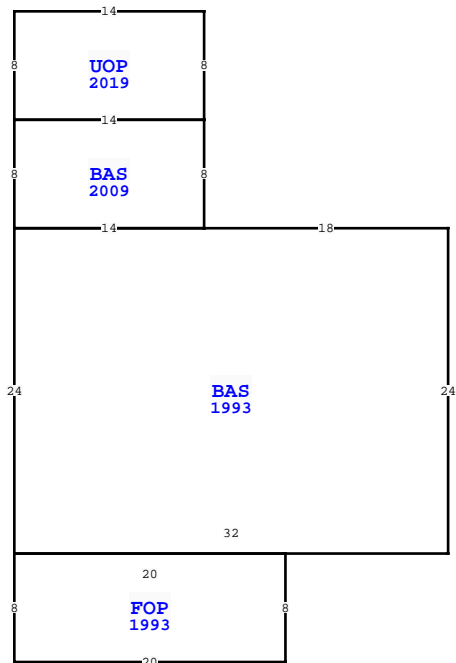

| WAKULLA COUNTY PROPERTY | | | |
|--|--------------|-----------|----------------|
| VALUATION SUMMARY | | | |
| VALUATION BY | STANDARD | | |
| Tax Group: 3 | Tax Dist: | | |
| BUILDING MARKET VALUE | 32,528 | | |
| TOTAL MARKET OB/XF VALUE | 5,406 | | |
| TOTAL LAND VALUE - MARKET | 45,000 | | |
| TOTAL MARKET VALUE | 54,234 | | |
| SOH/AGL Deduction | 12,452 | | |
| ASSESSED VALUE | 41,782 | | |
| TOTAL EXEMPTION VALUE | HX HB 25,000 | | |
| BASE TAXABLE VALUE | 16,782 | | |
| TOTAL JUST VALUE | 82,934 | | |
| NCON VALUE | 0 | | |
| INCOME VALUE | | | |
| PREVIOUS YEAR MKT VALUE | 53,300 | | |
| 5YR PRCL CK NC | | | |
| 2022 AG RENEWAL RECD | | | |
| OR 1250 P 551 | | | |
| PU NEW TRAVERSE, PU XFOB LNS 4-8 | | | |
| PERMIT NUM | DESCRIPTION | AMT | ISSUED |
| 2014765 | RE-ROOF | 0 | 09/15/2014 |
| SALES DATA | | | |
| OFF RECORD Number | DATE | TYPE INST | Q / V / RSN CD |
| 1125/0091 | 8/14/2019 | WD U | I 30 |
| GRANTOR: MOORE PHYLLIS S | | | |
| GRANTEE: MOORE PHYLLIS S & M | | | |
| 0761/0139 | 4/21/2008 | QC Q | I 01 |
| GRANTOR: MOORE ALBERT & PHYLL | | | |
| GRANTEE: MOORE PHYLLIS S | | | |
| BUILDING NOTES | | | |
| BUILDING DIMENSIONS | | | |
| BAS=[YR=1993] W18 BAS=[YR=2009] N8 UOP=[YR=2019] N8 W14 S8 E14\$ W14 S8 E14\$ W14 S24 FOP=[YR=1993] S8 E20 N8 W20\$ E32 N24\$. | | | |

| EXTRA FEATURES | | | | | | | | | | | | | | | | | |
|----------------|------------|-------------|---------|----|----|--------|----|-------|----------------|-----------|---------|-------------|--------|--------|-----------------|-------|--|
| L N | OB/XF CODE | DESCRIPTION | BLD CAP | L | W | UNITS | UT | Adj R | ADJ UNIT PRICE | ORIG COND | YEAR ON | YEAR ACTUAL | Q | % COND | OB/XF MKT VALUE | NOTES | |
| 1 | 0940 | OPEN SHED | 0 100 | 12 | 10 | 120.00 | SF | 4.00 | 4.00 | 100 | 2012 | 2012 | 3 | 52 | 250 | | |
| 2 | 0620 | WOOD UTL B | 0 100 | 14 | 10 | 140.00 | SF | 6.00 | 6.00 | 100 | 2012 | 2012 | 3 | 52 | 437 | | |
| 3 | 0940 | OPEN SHED | 0 100 | 16 | 14 | 224.00 | SF | 4.00 | 4.00 | 100 | 2012 | 2012 | 3 | 52 | 466 | | |
| 4 | 0211 | CONCRETE W | 0 100 | 12 | 10 | 120.00 | SF | 6.00 | 6.00 | 100 | 2012 | 2012 | 3 | 52 | 374 | | |
| 5 | 0211 | CONCRETE W | 0 100 | 16 | 14 | 224.00 | SF | 6.00 | 6.00 | 100 | 2012 | 2012 | 3 | 52 | 699 | | |
| 6 | 0625 | PORT WD UT | 0 100 | 8 | 8 | 64.00 | SF | 6.00 | 6.00 | 100 | 2018 | 2018 | 3 | 80 | 307 | | |
| 7 | 0940 | OPEN SHED | 0 100 | 13 | 26 | 338.00 | SF | 4.00 | 4.00 | 100 | 2019 | 2019 | 3 | 85 | 1,149 | | |
| 8 | 0211 | CONCRETE W | 0 100 | 13 | 26 | 338.00 | SF | 6.00 | 6.00 | 100 | 2019 | 2019 | 3 | 85 | 1,724 | | |
| TOTALS | | | | | | | | | | | | 950 | 32,528 | | | | |

| LAND DESCRIPTION | | | | | | | | | | | | | | | | | | | | | | | | |
|------------------|----------|-----|----------------------|-----|-----|----------|-------|-------|-------------|-----------|-----|----------|--------|---------|------------|----------------|------------|-----------------------------|------|---------|------|-----|----|--------|
| L N | USE CODE | CLS | LAND USE DESCRIPTION | CAP | R D | LOC ZONE | FRONT | DEPTH | TOT LND UTS | UNIT TYPE | D T | DPH FACT | % COND | TOT ADJ | UNIT PRICE | ADJ UNIT PRICE | LAND VALUE | OTHER ADJUSTMENTS AND NOTES | YEAR | DENSITY | DECL | FRZ | YR | CONSRV |
| 1 | 000110 | C | SFR RURAL | 100 | | | 0.00 | 0.00 | 1.00 | AC | | 1.00 | 1.00 | 1.00 | 15,000.00 | 15,000.00 | 15,000 | | | | | | | |
| 2 | 005970 | A | TIMBER MIX 1 | 0 | | | 0.00 | 0.00 | 4.00 | AC | | 1.00 | 1.00 | 1.00 | 325.00 | 325.00 | 1,300 | | | | | | | |