

| BUILDING CHARACTERISTICS | | CONSTRUCTION | |
|--------------------------|------------------|---------------|------|
| ELEMENT | CD | | |
| Foundation | 01 | WOOD FRAME | 100 |
| Frame | 02 | WOOD FRAME | 100 |
| Exterior Wall | 13 | PREFAB PNL | 100 |
| Roof Structur | 03 | GABLE/HIP | 100 |
| Roof Cover | 03 | COMP SHNGL | 100 |
| Interior Wall | 04 | PLYWOOD | 100 |
| Interior Floor | 08 | SHT VINYL | 100 |
| Heating Type | 04 | AIR DUCTED | 100 |
| Air Condition | 03 | CENTRAL | 100 |
| Bedrooms | | 2 | 100 |
| Bathrooms | | 2 | 100 |
| Stories | 1. | 1. | 100 |
| Class | 00 | N/A | 100 |
| Units | | 0 | 100 |
| Quality | 02 | BELOW AVERAGE | |
| DOR CODE | 0200 | MOBILE HOME | |
| MAP NUM | 4 | MKT AREA | 08 |
| NEIGHBORHOOD/LOC | 000 | 1.00/ | |
| AREA TYPE | TOTAL GROSS AREA | PCT OF BASE | YEAR |
| BAS | 960 | 100 | 1988 |
| DCK | 112 | 10 | 2006 |
| UOP | 16 | 25 | 2013 |
| TOTALS | 1,088 | | |

| MARKET ADJUSTMENTS | | | | | | | | | | | | |
|--------------------|------------|-------------|------------------|----------------|----------------|-----------------|------|------|------|----|-------|--------|
| TYPE | MDL | EFF. AREA | TOT ADJ PTS | EFF. BASE RATE | REPL. COST NEW | AYB | EYB | ECON | FNCT | PD | NORM | % COND |
| 1 | MOBILE HOM | 100% - 2022 | | 61.60 | 60,060 | 1988 | 1988 | 0 | 0 | 20 | 55.00 | 20.00 |
| | | | Heated Area: 960 | | | HX Base Yr 2022 | | | | | | |

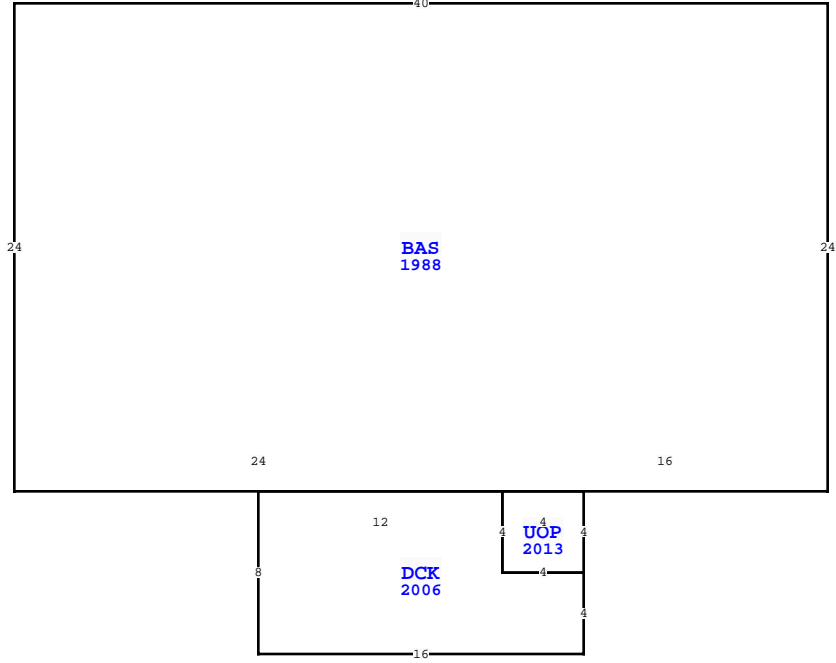

| WAKULLA COUNTY PROPERTY | | | |
|--|-------------|-----|-------------|
| VALUATION SUMMARY | | | PAGE 1 of 1 |
| VALUATION BY | | | STANDARD |
| Tax Group: 3 | Tax Dist: | | |
| BUILDING MARKET VALUE | | | 12,012 |
| TOTAL MARKET OB/XF VALUE | | | 1,584 |
| TOTAL LAND VALUE - MARKET | | | 10,500 |
| TOTAL MARKET VALUE | | | 24,096 |
| SOH/AGL Deduction | | | 1,897 |
| ASSESSED VALUE | | | 22,199 |
| TOTAL EXEMPTION VALUE | HX HB | | 22,199 |
| BASE TAXABLE VALUE | | | 0 |
| TOTAL JUST VALUE | | | 24,096 |
| NCON VALUE | | | 0 |
| INCOME VALUE | | | |
| PREVIOUS YEAR MKT VALUE | | | 21,552 |
| 5 YR PRCL CK, CHG ELMNTS TAKE VAL OUT OF PORT XFOB | | | |
| ADD PD TO 20% PER TB R210115 | | | |
| 5 YR PRCL CH, N/C | | | |
| QUAL, PU CORR TRAV, PU XFOB LN 6 | | | |
| PERMIT NUM | DESCRIPTION | AMT | ISSUED |
| 32044 | WETHR MH | 0 | 07/01/2004 |

| SALES DATA | | | | | | |
|--------------------------------|-----------|-----------|-------|-------|--------|------------|
| OFF RECORD Number | DATE | TYPE INST | Q / U | V / I | RSN CD | SALE PRICE |
| 0965/0034 | 3/18/2015 | WD Q | Q | I | 01 | 24,000 |
| GRANTOR: MURPHY WENDY & DENNIS | | | | | | |
| GRANTEE: MEDLEY MICHAEL & MA | | | | | | |
| 0579/0239 | 2/16/2005 | WD Q | Q | I | | 35,000 |
| GRANTOR: SLUSHER | | | | | | |
| GRANTEE: MURPHY | | | | | | |

| EXTRA FEATURES | | | | | | | | | | | | | |
|----------------|------------|-------------|---------|-----|----|-------|----|-------|----------------|-----------|---------|-------------|--------|
| L N | OB/XF CODE | DESCRIPTION | BLD CAP | L | W | UNITS | UT | Adj R | ADJ UNIT PRICE | ORIG COND | YEAR ON | YEAR ACTUAL | |
| 1 | 0700 | PORT BLDG | 0 | 100 | 8 | 10 | | 8.00 | 8.00 | 100 | 1988 | 1988 | |
| 2 | 0940 | OPEN SHED | 0 | 100 | 36 | 11 | SF | 4.00 | 4.00 | 100 | 2006 | 2006 | |
| 3 | 0210 | CONCRETE D | 0 | 100 | 24 | 11 | SF | 6.00 | 6.00 | 100 | 2006 | 2006 | |
| 4 | 0620 | WOOD UTL B | 0 | 100 | 8 | 8 | SF | 6.00 | 6.00 | 100 | 2006 | 2006 | |
| 5 | 0620 | WOOD UTL B | 0 | 100 | 12 | 10 | SF | 6.00 | 6.00 | 100 | 2009 | 2009 | |
| 6 | 0940 | OPEN SHED | 0 | 100 | 8 | 3 | SF | 4.00 | 4.00 | 100 | 2013 | 2013 | |
| TOTALS | | | | | | | | | | | 1,088 | 975 | 12,012 |

| BUILDING NOTES | | | |
|--------------------------------------|--|--|--|
| 3583 SPRING CREEK HWY, CRAWFORDVILLE | | | |

| BUILDING DIMENSIONS | | | |
|---|--|--|--|
| BAS=[YR=1988] W40 S24 E24 DCK=[YR=2006] W12 S8 E16 N4 W4 N4\$ | | | |
| UOP=[YR=2013] S4 E4 N4 W4\$ E16 N24\$. | | | |

| LAND DESCRIPTION | | | | | | | | | | | | | TOTAL OB/XF | | | | | | | | | | | | |
|------------------|----------|-----|----------------------|-----|-----|----------|-------|-------|-------------|-----------|-----|----------|-------------|---------|------------|----------------|------------|-----------------------------|------|---------|------|-----|----|--------|--|
| L N | USE CODE | CLS | LAND USE DESCRIPTION | CAP | R D | LOC ZONE | FRONT | DEPTH | TOT LND UTS | UNIT TYPE | D T | DPH FACT | % COND | TOT ADJ | UNIT PRICE | ADJ UNIT PRICE | LAND VALUE | OTHER ADJUSTMENTS AND NOTES | YEAR | DENSITY | DECL | FRZ | YR | CONSRV | |
| 1 | 000201 | C | MH | 100 | | | 0.00 | 0.00 | 1.40 | AC | | 1.00 | 1.00 | 1.00 | 7,500.00 | 7,500.00 | 10,500 | | | | | | | | |