

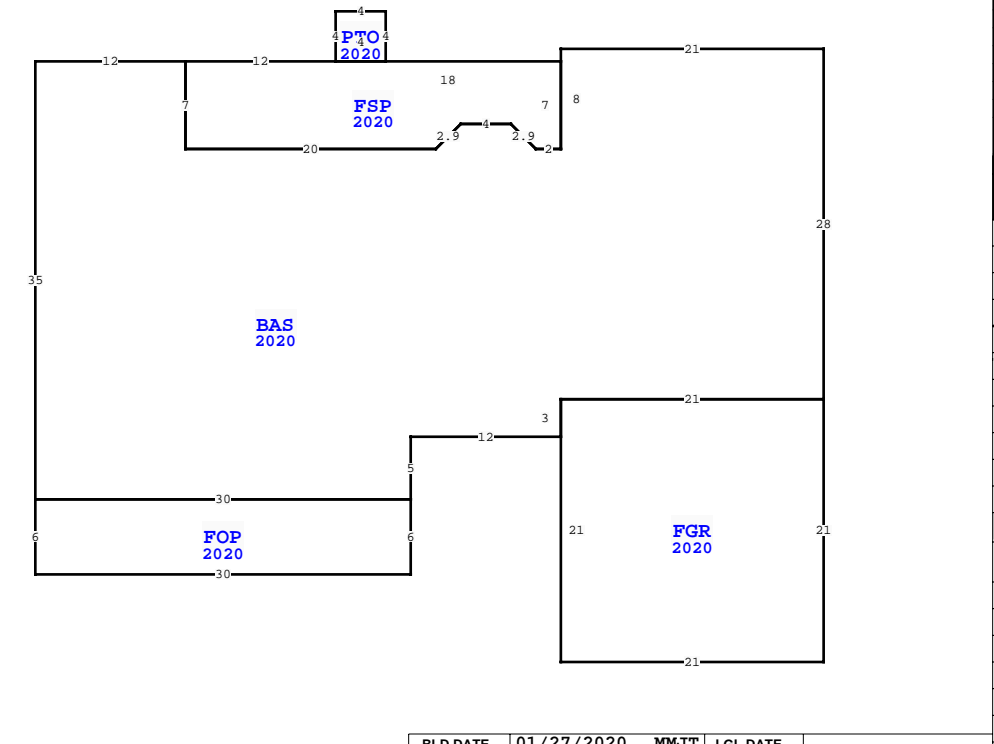

BUILDING CHARACTERISTICS		
ELEMENT	CD	CONSTRUCTION
Foundation	02	CONCR SLAB 100
Frame	02	WOOD FRAME 100
Exterior Wall	05	HARDIE BRD 100
Roof Structur	03	GABLE/HIP 100
Roof Cover	03	COMP SHNGL 100
Interior Wall	05	DRYWALL 100
Interior Floor	12	HARDWOOD 70
Interior Floor	14	CARPET 30
Heating Type	04	AIR DUCTED 100
Air Condition	03	CENTRAL 100
Bedrooms		3 100
Bathrooms		2 100
Story Height		0 100
Stories	1.	1. 100
Units		0 100

MARKET ADJUSTMENTS											
TYPE	MDL	EFF. AREA	TOT ADJ PTS	EFF. BASE RATE	REPL. COST NEW	AYB	EYB	ECON	FNCT	NORM	% COND
0100	01	2,184	116.1000	110.30	240,895	2020	2020	0	0	3.00	97.00



WAKULLA COUNTY PROPERTY			
VALUATION SUMMARY			
VALUATION BY	STANDARD		
Tax Group: 3	Tax Dist:		
BUILDING MARKET VALUE	233,668		
TOTAL MARKET OB/XF VALUE	10,829		
TOTAL LAND VALUE - MARKET	65,000		
TOTAL MARKET VALUE	309,497		
SOH/AGL Deduction	3,081		
ASSESSED VALUE	306,416		
TOTAL EXEMPTION VALUE	HX HB 50,000		
BASE TAXABLE VALUE	256,416		
TOTAL JUST VALUE	309,497		
NCON VALUE	0		
INCOME VALUE			
PREVIOUS YEAR MKT VALUE	297,491		

SALES DATA				
OFF RECORD Number	DATE	TYPE INST	Q / V / I / RSN CD	SALE PRICE
1260/0525	4/11/2022	WD Q	I 01	360,000

EXTRA FEATURES															
L N	OB/XF CODE	DESCRIPTION	BLD CAP	L W	UNITS	UT	Adj R	ADJ UNIT PRICE	ORIG COND	YEAR ON	YEAR ACTUAL	Q	% COND	OB/XF MKT VALUE	NOTES
1	0210	CONCRETE D	0 100	64 18	1,152.00	SF	6.00	6.00	100	2020	2020	3	89	6,152	
2	0210	CONCRETE D	0 100	0 0	669.00	SF	6.00	6.00	100	2020	2020	3	89	3,572	
3	0211	CONCRETE W	0 100	69 3	207.00	SF	6.00	6.00	100	2020	2020	3	89	1,105	

LAND DESCRIPTION																								
L N	USE CODE	CLS	LAND USE DESCRIPTION	CAP	R D	LOC ZONE	FRONT	DEPTH	TOT LND UTS	UNIT TYPE	D T	DPH FACT	% COND	TOT ADJ	UNIT PRICE	ADJ UNIT PRICE	LAND VALUE	OTHER ADJUSTMENTS AND NOTES	YEAR	DENSITY	DECL	FRZ	YR	CONSRV
1	000100	C	SFR	100			0.00	0.00	1.00	LT		1.00	1.00	1.00	65,000.00	65,000.00	65,000							

EXTRA FEATURES											
BLD DATE	XF DATE	INC DATE	MMJTT	LGL DATE	LAND DATE	AG DATE					
01/27/2020	01/27/2020		MMJTT		01/16/2007	JBHC					

TOTAL OB/XF																
10,829																