

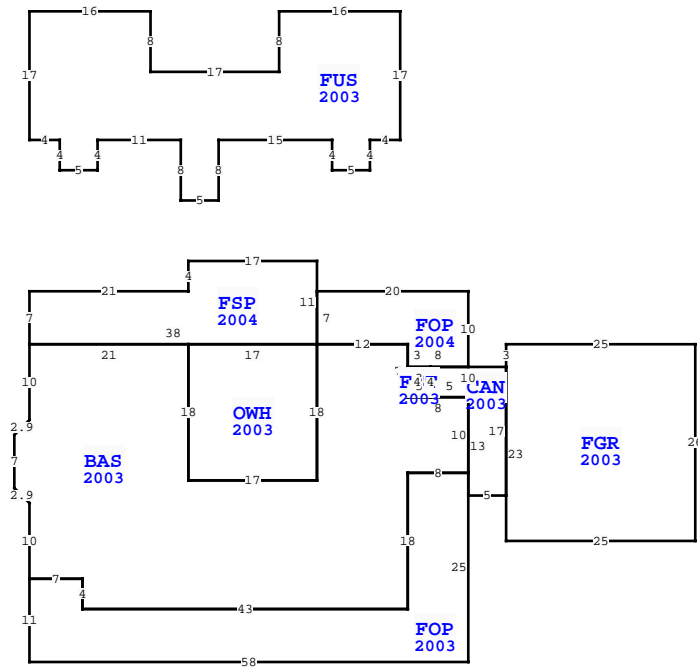

ELEMENT		CD	CONSTRUCTION
Foundation	02	CONCR	SLAB 100
Frame	02	WOOD	FRAME 100
Exterior Wall	20	FACE	BRICK 80
Exterior Wall	30	VINYL	20
Roof Structur	03	GABLE/HIP	100
Roof Cover	03	COMP	SHNGL 100
Interior Wall	05	DRYWALL	100
Interior Floo	12	HARDWOOD	90
Interior Floo	11	CLAY TILE	10
Heating Type	04	AIR DUCTED	100
Air Condition	03	CENTRAL	100
Bedrooms			4 100
Bathrooms			2.5 100
Story Height			0 100
Stories	2.		2. 100
Units			0 100
Quality	07		GOOD
DOR CODE	0100	SINGLE FAMILY	
MAP NUM	5	MKT AREA	02
NEIGHBORHOOD/LOC	000	1.00/	
AREA TYPE	TOTAL GROSS AREA	PCT OF BASE	YEAR
TOTALS	4,440		

MARKET ADJUSTMENTS											
TYPE	MDL	EFF. AREA	TOT ADJ PTS	EFF. BASE RATE	REPL. COST NEW	AYB	EYB	ECON	FNCT	NORM	% COND
0100	01	3,367	135.0100	128.26	431,851	2003	2005	0	0	18.00	82.00
1 SINGLE FAM 100% - 1997 Heated Area: 2597 HX Base Yr 1997											



WAKULLA COUNTY PROPERTY PAGE 1 of 1 3

VALUATION BY		STANDARD
Tax Group: 3	Tax Dist:	
BUILDING MARKET VALUE		354,118
TOTAL MARKET OB/XF VALUE		1,807
TOTAL LAND VALUE - MARKET		76,575
TOTAL MARKET VALUE		432,500
SOH/AGL Deduction		125,249
ASSESSED VALUE		307,251
TOTAL EXEMPTION VALUE	HX HB	50,000
BASE TAXABLE VALUE		257,251
TOTAL JUST VALUE		432,500
NCON VALUE		0
INCOME VALUE		
PREVIOUS YEAR MKT VALUE		436,942

R240004 UPDATE SOH CAP YR TO 1997
 5 YR PRCL CK NC MM
 INCR EYB 2003-2005 HVAC-CC 3-2022
 5YR PRCL CK NC MM

PERMIT NUM	DESCRIPTION	AMT	ISSUED
OB22-000140	HVAC-CC	0	03/08/2022
29067	SFD	0	05/22/2002
021239	N/A	0	08/01/1996

SALES DATA						
OFF RECORD Number	DATE	TYPE INST	Q / U	V / I	RSN CD	SALE PRICE
0279/0135	6/28/1996	WD	Q	I		37,500

GRANTOR: STRICKLAND ROBERT B
 GRANTEE:
 0183/0429 10/11/1991 WD U V 100
 GRANTOR:
 GRANTEE:

BUILDING NOTES

BUILDING DIMENSIONS
 FOP=[YR=2004] W20 S7 E12 BAS=[YR=2003] W12 S18 W17 N18 W21
 FSP=[YR=2004] E38 OWH=[YR=2003] W17 S18 E17 N18\$ N11 W17 S4
 W21 PTR=N20 FUS=[YR=2003] E4 S4 E5 N4 E11 S8 E5 N8 E15 S4 E5
 N4 E4 N17 W16 S8 W17 N8 W16 S17\$ S20\$ S7\$ S10 D2 L2 S7 D2
 R2 S10E7 S4 E43 N18 E8 FOP=[YR=2003] W8 S18 W43 N4 W7 S11
 E58 N25\$ N10 CAN=[YR=2003] S13 E5 N17 FGR=[YR=2003] S23 E25
 N26W25 S3\$ W10 S4 E5\$ W8 FST=[YR=2003] E3 N4 W3 S4\$ N7\$ S3 E8
 N10\$.

EXTRA FEATURES																
L N	OB/XF CODE	DESCRIPTION	BLD CAP	L	W	UNITS	UT	Adj R	ADJ UNIT PRICE	ORIG COND	YEAR ON	YEAR ACTUAL	Q	% COND	OB/XF MKT VALUE	NOTES
1	0130	FIRE PLACE	0	100	0	1.00	UT	1,300.00	1,300.00	100	2003	2003	3	60	780	
2	0210	CONCRETE D	0	100	20	500.00	SF	6.00	6.00	100	2003	2003	3	21	630	
3	0211	CONCRETE W	0	100	105	315.00	SF	6.00	6.00	100	2003	2003	3	21	397	

TOTAL OB/XF									
1,807									

LAND DESCRIPTION										TOTAL OB/XF														
L N	USE CODE	CLS	LAND USE DESCRIPTION	CAP	R D	LOC ZONE	FRONT	DEPTH	TOT LND UTS	UNIT TYPE	D T	DPTH FACT	% COND	TOT ADJ	UNIT PRICE	ADJ UNIT PRICE	LAND VALUE	OTHER ADJUSTMENTS AND NOTES	YEAR	DENSITY	DECL	FRZ	YR	CONSRV
1	000100	C	SFR	100			0.00	0.00	10.21	AC		1.00	1.00	1.00	7,500.00	7,500.00	76,575							