

01-5S-3W P-8-1-M-26-A  
 LYING IN NE 1/4 OF SE 1/4  
 OR 29 P 83 & OR 98 P 382

EDWARDS LELIA R  
 434 PULLBACK RD  
 SOPCHOPPY, FL 32358

**2024**

01-5S-03W-000-00593-001  

| ELEMENT          |                  | CD            | CONSTRUCTION |              |                      |
|------------------|------------------|---------------|--------------|--------------|----------------------|
| Foundation       | 01               | WOOD          | FRAME        | 100          |                      |
| Frame            | 02               | WOOD          | FRAME        | 100          |                      |
| Exterior Wall    | 08               | WD ON PLY     | 100          |              |                      |
| Roof Structur    | 03               | GABLE/HIP     | 100          |              |                      |
| Roof Cover       | 01               | MINIMUM       | 100          |              |                      |
| Interior Wall    | 05               | DRYWALL       | 100          |              |                      |
| Interior Floo    | 09               | PINE WOOD     | 100          |              |                      |
| Heating Type     | 04               | AIR DUCTED    | 100          |              |                      |
| Air Condition    | 03               | CENTRAL       | 100          |              |                      |
| Bedrooms         |                  | 3             | 100          |              |                      |
| Bathrooms        |                  | 1             | 100          |              |                      |
| Story Height     |                  | 0             | 100          |              |                      |
| Stories          | 1.               | 1.            | 100          |              |                      |
| Units            |                  | 0             | 100          |              |                      |
| Quality          | 02               | BELOW AVERAGE |              |              |                      |
| DOR CODE         | 0100             | SINGLE FAMILY |              |              |                      |
| MAP NUM          | 5                | MKT AREA      |              | 02           |                      |
| NEIGHBORHOOD/LOC | 000              | 1.00/         |              |              |                      |
| AREA TYPE        | TOTAL GROSS AREA | PCT OF BASE   | YEAR         | TOT ADJ AREA | SUBAREA MARKET VALUE |
| BAS              | 1,240            | 100           | 1993         | 1,240        | 40,052               |
| BAS              | 240              | 100           | 2002         | 240          | 7,752                |
| BAS              | 192              | 100           | 2022         | 192          | 6,202                |
| DCK              | 80               | 10            | 2022         | 8            | 258                  |
| USP              | 160              | 40            | 1993         | 64           | 2,067                |
| TOTALS           | 1,912            |               |              | 1,744        | 56,331               |

| MARKET ADJUSTMENTS                                 |     |           |             |                |                |      |      |      |      |       |        |
|--|-----|-----------|-------------|----------------|----------------|------|------|------|------|-------|--------|
| TYPE   | MDL | EFF. AREA | TOT ADJ PTS | EFF. BASE RATE | REPL. COST NEW | AYB  | EYB  | ECON | FNCT | NORM  | % COND |
| 0100   | 01  | 1,744     | 85.0000     | 80.75          | 140,828        | 1955 | 1955 | 0    | 0    | 60.00 | 40.00  |
| 1 SINGLE FAM 100% - 0 Heated Area: 1672 HX Base Yr |     |           |             |                |                |      |      |      |      |       |        |

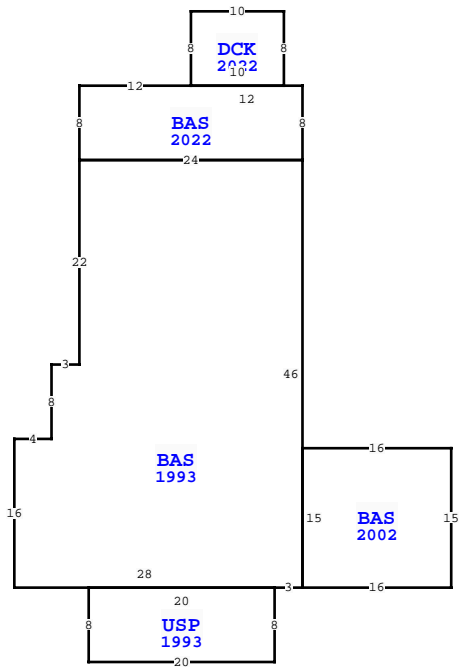

| WAKULLA COUNTY PROPERTY   |              |          |             |
|---------------------------|--------------|----------|-------------|
| VALUATION SUMMARY         |              |          | PAGE 1 of 1 |
| VALUATION BY              |              | STANDARD |             |
| Tax Group: 3              | Tax Dist:    |          |             |
| BUILDING MARKET VALUE     | 56,331       |          |             |
| TOTAL MARKET OB/XF VALUE  | 13,596       |          |             |
| TOTAL LAND VALUE - MARKET | 9,750        |          |             |
| TOTAL MARKET VALUE        | 79,677       |          |             |
| SOH/AGL Deduction         | 26,795       |          |             |
| ASSESSED VALUE            | 52,882       |          |             |
| TOTAL EXEMPTION VALUE     | HX HB 27,882 |          |             |
| BASE TAXABLE VALUE        | 25,000       |          |             |
| TOTAL JUST VALUE          | 79,677       |          |             |
| NCON VALUE                | 0            |          |             |
| INCOME VALUE              |              |          |             |
| PREVIOUS YEAR MKT VALUE   | 80,043       |          |             |

| PERMIT NUM | DESCRIPTION | AMT | ISSUED     |
|------------|-------------|-----|------------|
| 019659     | N/A         | 0   | 05/16/1995 |

| SALES DATA        |            |           |       |       |        |            |
|-------------------|------------|-----------|-------|-------|--------|------------|
| OFF RECORD Number | DATE       | TYPE INST | Q / U | V / I | RSN CD | SALE PRICE |
| 0098/0382         | 10/01/1983 | WD        | U     | I     |        | 14,100     |

| BLD DATE   |  | MMJTT | LGL DATE   |
|------------|--|-------|------------|
| 10/03/2018 |  |       | 10/03/2018 |
| XF DATE    |  | MMJTT | LAND DATE  |
| 10/03/2018 |  |       |            |
| INC DATE   |  |       | AG DATE    |
|            |  |       |            |

| BUILDING NOTES  |  |
|---|--|
|   |  |
| BUILDING DIMENSIONS   |  |
| BAS=[YR=2022] W12 DCK=[YR=2022] E10 N8 W10 S8\$ W12 S8 E24  |  |
| BAS=[YR=1993] W24 S22 W3 S8 W4 S16 E28 USP=[YR=1993] W20 S8 E20 N8\$ E3 BAS=[YR=2002] E16 N15 W16 S15\$ N46\$ N8\$. |  |

| EXTRA FEATURES     |            |             |         |    |    |          |    |       |                |           |         |             |   |        |                 |       |
|--------------------|------------|-------------|---------|----|----|----------|----|-------|----------------|-----------|---------|-------------|---|--------|-----------------|-------|
| L N                | OB/XF CODE | DESCRIPTION | BLD CAP | L  | W  | UNITS    | UT | Adj R | ADJ UNIT PRICE | ORIG COND | YEAR ON | YEAR ACTUAL | Q | % COND | OB/XF MKT VALUE | NOTES |
| 1                  | 0500       | WORK SHOP   | 0 100   | 32 | 20 | 640.00   | SF | 15.00 | 15.00          | 100       | 1993    | 1993        | 3 | 20     | 1,920           |       |
| 2                  | 0700       | PORT BLDG   | 0 100   | 20 | 10 | 200.00   | SF | 8.00  | 8.00           | 100       | 2006    | 2006        | 3 | 66     | 1,056           |       |
| 3                  | 0025       | BARN,POLE   | 0 100   | 36 | 30 | 1,080.00 | SF | 12.50 | 12.50          | 100       | 2013    | 2013        | 3 | 57     | 7,695           |       |
| 4                  | 0620       | WOOD UTL B  | 0 100   | 20 | 16 | 320.00   | SF | 6.00  | 6.00           | 100       | 2008    | 2008        | 3 | 34     | 653             |       |
| 5                  | 0940       | OPEN SHED   | 0 100   | 20 | 12 | 240.00   | SF | 4.00  | 4.00           | 100       | 2008    | 2008        | 3 | 34     | 326             |       |
| 6                  | 0055       | PORTABLE C  | 0 100   | 20 | 20 | 400.00   | SF | 3.00  | 3.00           | 100       | 2015    | 2015        | 3 | 67     | 804             |       |
| 7                  | 0625       | PORT WD UT  | 0 100   | 20 | 10 | 200.00   | SF | 6.00  | 6.00           | 100       | 2017    | 2017        | 3 | 76     | 912             |       |
| 8                  | 0620       | WOOD UTL B  | 0 100   | 12 | 4  | 48.00    | SF | 6.00  | 6.00           | 100       | 2018    | 2018        | 3 | 80     | 230             |       |
| TOTAL OB/XF 13,596 |            |             |         |    |    |          |    |       |                |           |         |             |   |        |                 |       |

| LAND DESCRIPTION |          |     |                      |     |     |          |       |       |             |           |     |          |        |         |            |                |            |                             |      |         |      |     |    |        |
|------------------|----------|-----|----------------------|-----|-----|----------|-------|-------|-------------|-----------|-----|----------|--------|---------|------------|----------------|------------|-----------------------------|------|---------|------|-----|----|--------|
| L N              | USE CODE | CLS | LAND USE DESCRIPTION | CAP | R D | LOC ZONE | FRONT | DEPTH | TOT LND UTS | UNIT TYPE | D T | DPH FACT | % COND | TOT ADJ | UNIT PRICE | ADJ UNIT PRICE | LAND VALUE | OTHER ADJUSTMENTS AND NOTES | YEAR | DENSITY | DECL | FRZ | YR | CONSRV |
| 1                | 000100   | C   | SFR                  | 100 |     |          | 0.00  | 0.00  | 1.30        | AC        |     | 1.00     | 1.00   | 1.00    | 7,500.00   | 7,500.00       | 9,750      |                             |      |         |      |     |    |        |