

BUILDING CHARACTERISTICS		CONSTRUCTION	
ELEMENT	CD		
Foundation	03	CONCR STEM	100
Frame	02	WOOD FRAME	100
Exterior Wall	19	COMMON BRK	70
Exterior Wall	08	WD ON PLY	30
Roof Structur	03	GABLE/HIP	100
Roof Cover	03	COMP SHNGL	100
Interior Wall	05	DRYWALL	100
Interior Floo	13	PARQUET	80
Interior Floo	08	SHT VINYL	20
Heating Type	04	AIR DUCTED	100
Air Condition	03	CENTRAL	100
Bedrooms		3	100
Bathrooms		1	100
Story Height		0	100
Stories	1.	1.	100
Units		0	100
Quality	03	AVERAGE	
DOR CODE	5000	IMPRVD AG RES	
MAP NUM	5	MKT AREA	10
NEIGHBORHOOD/LOC	000	1.00/	
AREA TYPE	TOTAL GROSS AREA	PCT OF BASE	YEAR
BAS	1,610	100	1993
DCK	196	10	1993
FOP	168	30	1993
TOTALS	1,974		

MARKET ADJUSTMENTS													
TYPE	MDL	EFF. AREA	TOT ADJ PTS	EFF. BASE RATE	REPL. COST NEW	AYB	EYB	ECON	FNCT	NORM	% COND		
1	SINGLE FAM	100%	- 0		171,730	1985	1985	0	0	38.00	62.00		
Heated Area: 1610 HX Base Yr													

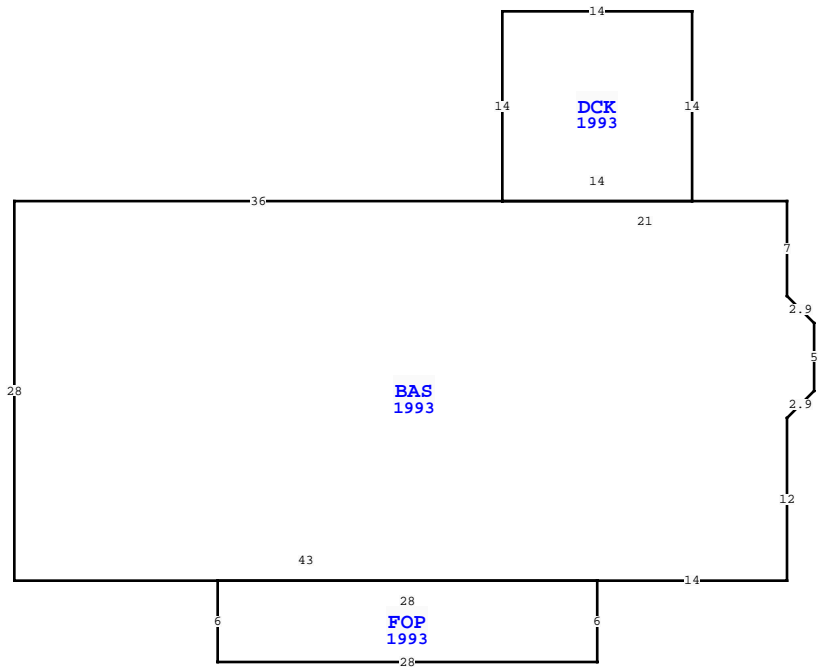

WAKULLA COUNTY PROPERTY				PAGE 1 of 1	3	
VALUATION SUMMARY						
VALUATION BY				STANDARD		
Tax Group: 3				Tax Dist:		
BUILDING MARKET VALUE				106,473		
TOTAL MARKET OB/XF VALUE				2,232		
TOTAL LAND VALUE - MARKET				107,925		
TOTAL MARKET VALUE				127,732		
SOH/AGL Deduction				35,438		
ASSESSED VALUE				92,294		
TOTAL EXEMPTION VALUE				HX HB 50,000		
BASE TAXABLE VALUE				42,294		
TOTAL JUST VALUE				216,630		
NCON VALUE				0		
INCOME VALUE						
PREVIOUS YEAR MKT VALUE				118,016		
XFOB 7-10						
NEW PRCL 01852-011 W/ MH SITE &						
OR 1290 P 112 QC DEED S/O 5 AC TO						
5 YR CHK NC						
PERMIT NUM	DESCRIPTION	AMT	ISSUED			
18001317	REROOF-CO	0	11/20/2018			
024217	MH	0	10/26/1999			
SALES DATA						
OFF RECORD Number	DATE	TYPE INST	Q U	V I	RSN CD	SALE PRICE
BUILDING NOTES						
BUILDING DIMENSIONS						
BAS=[YR=1993] W21 DCK=[YR=1993] E14 N14 W14 S14\$ W36 S28 E43 FOP=[YR=1993] W28 S6 E28 N6\$ E14 N12 U2 R2 N5 U2 L2 N7\$.						

EXTRA FEATURES																
L N	OB/XF CODE	DESCRIPTION	BLD CAP	L	W	UNITS	UT	Adj R	ADJ UNIT PRICE	ORIG COND	YEAR ON	YEAR ACTUAL	Q	% COND	OB/XF MKT VALUE	NOTES
1	0620	WOOD UTL B	0	100	24	20		SF	6.00	100	1980	1980	3	20	576	
2	0140	FIRE PLACE	0	100	0	0		UT	1,900.00	100	1985	1985	3	35	665	
3	0940	OPEN SHED	0	100	24	20		SF	4.00	100	1991	1991	3	20	384	
4	0210	CONCRETE D	0	100	22	17		SF	6.00	100	1988	1988	3	20	449	
5	0211	CONCRETE W	0	100	44	3		SF	6.00	100	1985	1985	3	20	158	

TOTAL OB/XF														2,232	
BLD DATE 08/28/2017 MMJT LGL DATE														08/28/2017 MMJT	
XF DATE 08/28/2017 MMJT LAND DATE														08/28/2017 MMJT	
INC DATE														AG DATE	

LAND DESCRIPTION														TOTAL OB/XF										
L N	USE CODE	CLS	LAND USE DESCRIPTION	CAP	R D	LOC ZONE	FRONT	DEPTH	TOT LND UTS	UNIT TYPE	D T	DPH FACT	% COND	TOT ADJ	UNIT PRICE	ADJ UNIT PRICE	LAND VALUE	OTHER ADJUSTMENTS AND NOTES	YEAR	DENSITY	DECL	FRZ	YR	CONSRV
1	000110	C	SFR RURAL	100			0.00	0.00	1.00	AC		1.00	1.00	1.00	15,000.00	15,000.00	15,000							
2	005970	A	TIMBER MIX 1	0			0.00	0.00	7.39	AC		1.00	1.00	1.00	325.00	325.00	2,402							
3	006100	A	PASTURE 2	0			0.00	0.00	5.00	AC		1.00	1.00	1.00	325.00	325.00	1,625							