

BUILDING CHARACTERISTICS		CONSTRUCTION	
ELEMENT	CD		
Foundation	03	CONCR STEM	100
Frame	03	MASONRY	100
Exterior Wall	15	CONC BLOCK	100
Roof Structur	03	GABLE/HIP	100
Roof Cover	03	COMP SHNGL	100
Interior Wall	01	MINIMUM	100
Interior Floo	09	PINE WOOD	100
Ceiling	01	FIN.SUSPD	100
Heating Type	02	CONVECTION	100
Air Condition	02	WINDOW	100
Fixtures		4	100
Story Height		0	100
RMS		3	100
Stories	1.	1.	100
Class	00	N/A	100
Units		0	100
Quality	02	BELOW AVERAGE	
DOR CODE	7100	CHURCHES	
MAP NUM	1	MKT AREA	11
NEIGHBORHOOD/LOC	000	1.00/	
AREA TYPE	TOTAL GROSS AREA	PCT OF BASE	YEAR
BAS	1,818	100	1993
UOP	80	20	1993
TOTALS	1,898		

MARKET ADJUSTMENTS											
TYPE	MDL	EFF. AREA	TOT ADJ PTS	EFF. BASE RATE	REPL. COST NEW	AYB	EYB	ECON	FNCT	NORM	% COND
1	CHURCH	0% - 0									
Heated Area: 1818 HX Base Yr											

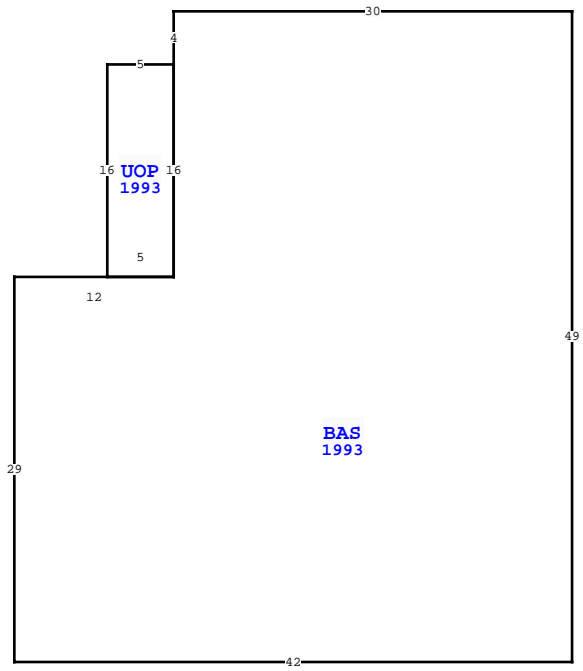

WAKULLA COUNTY PROPERTY			
VALUATION SUMMARY			PAGE 1 of 1
VALUATION BY			STANDARD
Tax Group: 3	Tax Dist:		
BUILDING MARKET VALUE			41,654
TOTAL MARKET OB/XF VALUE			144
TOTAL LAND VALUE - MARKET			5,000
TOTAL MARKET VALUE			46,798
SOH/AGL Deduction			6,552
ASSESSED VALUE			40,246
TOTAL EXEMPTION VALUE			0
BASE TAXABLE VALUE			40,246
TOTAL JUST VALUE			46,798
NCON VALUE			0
INCOME VALUE			
PREVIOUS YEAR MKT VALUE			46,825
ADVRSE POSSESSION CLAIM NOT ACCEPTED INCOMPLETE			
2023 REMOVE EX CODE FOR CHURCH PER EB			
5 YR PRCL CH, N/C			
5 YR PRCL CH, PU FNDN & FRME, CORR A/C			
PERMIT NUM	DESCRIPTION	AMT	ISSUED
2008353	ELECT.REPAIR	0	04/29/2008
SALES DATA			
OFF RECORD Number	DATE	TYPE INST	Q / V / I / RSN CD SALE PRICE
BUILDING NOTES			
BUILDING DIMENSIONS			
BAS=[YR=1993] W30 S4 UOP=[YR=1993] W5 S16 E5 N16\$ S16 W12 S29 E42 N49\$.			

EXTRA FEATURES											
L N	OB/XF CODE	DESCRIPTION	BLD CAP	L	W	UNITS	UT	Adj R	ADJ UNIT PRICE	ORIG COND	YEAR ON
1	0211	CONCRETE W	0	0	30	4	SF	6.00	6.00	100	1982
TOTAL OB/XF 144											

LAND DESCRIPTION											
L N	USE CODE	CLS	LAND USE DESCRIPTION	CAP	R D	LOC ZONE	FRONT	DEPTH	TOT LND UTS	UNIT TYPE	D T
1	007000	C	INSTITAL	0			0.00	0.00	1.00	LT	1.00
TOTAL ADJ 1.00											