

| ELEMENT          |                  | BUILDING CHARACTERISTICS |      |
|------------------|------------------|--------------------------|------|
| ELEMENT          | CD               | CONSTRUCTION             |      |
| Foundation       | 02               | CONCR SLAB 100           |      |
| Frame            | 02               | WOOD FRAME 100           |      |
| Exterior Wall    | 19               | COMMON BRK 100           |      |
| Roof Structur    | 07               | GAMBREL 100              |      |
| Roof Cover       | 03               | COMP SHNGL 100           |      |
| Interior Wall    | 04               | PLYWOOD 50               |      |
| Interior Wall    | 05               | DRYWALL 50               |      |
| Interior Floo    | 14               | CARPET 100               |      |
| Heating Type     | 01               | NONE 100                 |      |
| Air Condition    | 02               | WINDOW 100               |      |
| Bedrooms         |                  | 3 100                    |      |
| Bathrooms        |                  | 2 100                    |      |
| Story Height     |                  | 0 100                    |      |
| Stories          | 1.               | 1. 100                   |      |
| Units            |                  | 0 100                    |      |
| Quality          | 03               | AVERAGE                  |      |
| DOR CODE         | 0100             | SINGLE FAMILY            |      |
| MAP NUM          | 1                | MKT AREA                 | 09   |
| NEIGHBORHOOD/LOC | 000              | 1.00/                    |      |
| AREA TYPE        | TOTAL GROSS AREA | PCT OF BASE              | YEAR |
| BAS              | 1,880            | 100                      | 1993 |
| FEP              | 135              | 80                       | 1994 |
| TOTALS           | 2,015            |                          |      |

| MARKET ADJUSTMENTS                |            |           |             |                |                |      |      |      |      |       |        |
|-----------------------------------|------------|-----------|-------------|----------------|----------------|------|------|------|------|-------|--------|
| TYPE                              | MDL        | EFF. AREA | TOT ADJ PTS | EFF. BASE RATE | REPL. COST NEW | AYB  | EYB  | ECON | FNCT | NORM  | % COND |
| 1                                 | SINGLE FAM | 100%      | - 2013      | 99.75          | 198,303        | 1981 | 1982 | 0    | 0    | 41.00 | 59.00  |
| Heated Area: 1988 HX Base Yr 2013 |            |           |             |                |                |      |      |      |      |       |        |

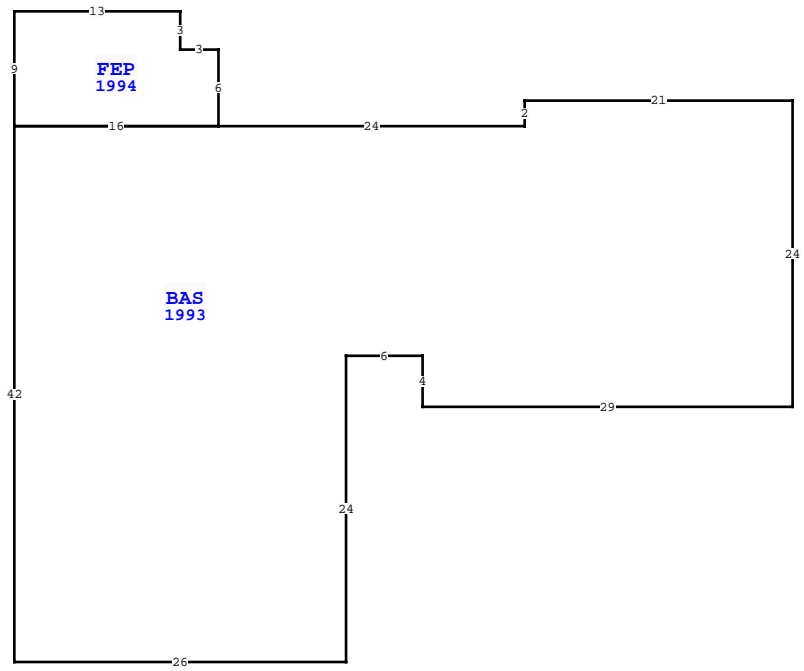

| WAKULLA COUNTY PROPERTY                       |             |        |             |
|---|-------------|--------|-------------|
| VALUATION SUMMARY                             |             |        | PAGE 1 of 1 |
| VALUATION BY                                  |             |        | STANDARD    |
| Tax Group: 3                                  | Tax Dist:   |        |             |
| BUILDING MARKET VALUE                         |             |        | 116,999     |
| TOTAL MARKET OB/XF VALUE                      |             |        | 10,132      |
| TOTAL LAND VALUE - MARKET                     |             |        | 13,725      |
| TOTAL MARKET VALUE                            |             |        | 140,856     |
| SOH/AGL Deduction                             |             |        | 33,691      |
| ASSESSED VALUE                                |             |        | 107,165     |
| TOTAL EXEMPTION VALUE                         | HX HB       | 50,000 |             |
| BASE TAXABLE VALUE                            |             |        | 57,165      |
| TOTAL JUST VALUE                              |             |        | 140,856     |
| NCON VALUE                                    |             |        | 0           |
| INCOME VALUE                                  |             |        |             |
| PREVIOUS YEAR MKT VALUE                       |             |        | 144,211     |
| JS 5YR CK DEMO XFOB                           |             |        |             |
| ADD HX FOR 2013-BOUTON JAMES                  |             |        |             |
| POLLY D BOURGEOIS DOD 01-12-2012 OR876P211 DC |             |        |             |
| P 660 PROBATE                                 |             |        |             |
| PERMIT NUM                                    | DESCRIPTION | AMT    | ISSUED      |
| 19000345                                      | REROOF-CO   | 0      | 06/27/2019  |
| 19560   | N/A         | 0      | 04/24/1995  |

| SALES DATA                    |           |           |     |     |        |            |
|-------------------------------|-----------|-----------|-----|-----|--------|------------|
| OFF RECORD Number             | DATE      | TYPE INST | Q U | V I | RSN CD | SALE PRICE |
| 1271/0129                     | 6/27/2022 | QC        | U   | I   | 11     | 100        |
| GRANTOR: BOUTON MARY ALICE    |           |           |     |     |        |            |
| GRANTEE: BOUTON JAMES RICHA   |           |           |     |     |        |            |
| 0883/0837                     | 7/06/2012 | WD        | Q   | I   | 01     | 115,000    |
| GRANTOR: BOURGEOIS CARL & TOM |           |           |     |     |        |            |
| GRANTEE: BOUTON JAMES RICHA   |           |           |     |     |        |            |

| EXTRA FEATURES |            |             |         |           |        |    |          |                |           |         |             |   |        |                 |       |
|----------------|------------|-------------|---------|-----------|--------|----|----------|----------------|-----------|---------|-------------|---|--------|-----------------|-------|
| L N            | OB/XF CODE | DESCRIPTION | BLD CAP | L W       | UNITS  | UT | Adj R    | ADJ UNIT PRICE | ORIG COND | YEAR ON | YEAR ACTUAL | Q | % COND | OB/XF MKT VALUE | NOTES |
| 1              | 0620       | WOOD UTL B  | 0       | 100 10 6  | 60.00  | SF | 6.00     | 6.00           | 100       | 1985    | 1985        | 3 | 20     | 72              |       |
| 2              | 0160       | GARAGE FIN  | 0       | 100 20 30 | 600.00 | SF | 40.00    | 40.00          | 100       | 1985    | 1985        | 3 | 35     | 8,400           |       |
| 3              | 0140       | FIRE PLACE  | 0       | 100 0 0   | 1.00   | UT | 1,900.00 | 1,900.00       | 100       | 1987    | 1987        | 3 | 44     | 836             |       |
| 4              | 0940       | OPEN SHED   | 0       | 100 20 11 | 220.00 | SF | 4.00     | 4.00           | 100       | 1996    | 1996        | 3 | 20     | 176             |       |
| 6              | 0211       | CONCRETE W  | 0       | 100 0 0   | 180.00 | SF | 6.00     | 6.00           | 100       | 1996    | 1996        | 3 | 20     | 216             |       |
| 7              | 0210       | CONCRETE D  | 0       | 100 20 18 | 360.00 | SF | 6.00     | 6.00           | 100       | 1996    | 1996        | 3 | 20     | 432             |       |

| TOTAL OB/XF |  |  |  |  |  |  |  |  |  |  |  |
|-------------|--|--|--|--|--|--|--|--|--|--|--|
| 10,132      |  |  |  |  |  |  |  |  |  |  |  |

| BUILDING NOTES                                    |  |  |  |  |  |  |  |  |  |  |  |
|---|--|--|--|--|--|--|--|--|--|--|--|
| 358 WOODVILLE HWY, CRAWFORDVILLE                  |  |  |  |  |  |  |  |  |  |  |  |
| BLD DATE 02/15/2018 RTJT LGL DATE 02/15/2018 RTJT |  |  |  |  |  |  |  |  |  |  |  |
| XF DATE 02/15/2018 RTJT LAND DATE 02/15/2018 RTJT |  |  |  |  |  |  |  |  |  |  |  |
| INC DATE AG DATE                                  |  |  |  |  |  |  |  |  |  |  |  |

| BUILDING DIMENSIONS   |  |  |  |  |  |  |  |  |  |  |  |
|---|--|--|--|--|--|--|--|--|--|--|--|
| BAS=[YR=1993] W21 S2 W24 FEP=[YR=1994] N6 W3 N3 W13 S9 E16\$ W16 S42 E26 N24 E6 S4 E29 N24\$. |  |  |  |  |  |  |  |  |  |  |  |

| LAND DESCRIPTION |          |     |                      |     |     |          |       |       |             |           |     |          |        |         |            |                |            |                             |      |         |      |     |    |        |
|------------------|----------|-----|----------------------|-----|-----|----------|-------|-------|-------------|-----------|-----|----------|--------|---------|------------|----------------|------------|-----------------------------|------|---------|------|-----|----|--------|
| L N              | USE CODE | CLS | LAND USE DESCRIPTION | CAP | R D | LOC ZONE | FRONT | DEPTH | TOT LND UTS | UNIT TYPE | D T | DPH FACT | % COND | TOT ADJ | UNIT PRICE | ADJ UNIT PRICE | LAND VALUE | OTHER ADJUSTMENTS AND NOTES | YEAR | DENSITY | DECL | FRZ | YR | CONSRV |
| 1                | 000100   | C   | SFR                  | 100 |     |          | 0.00  | 0.00  | 1.83        | AC        |     | 1.00     | 1.00   | 1.00    | 7,500.00   | 7,500.00       | 13,725     |                             |      |         |      |     |    |        |