

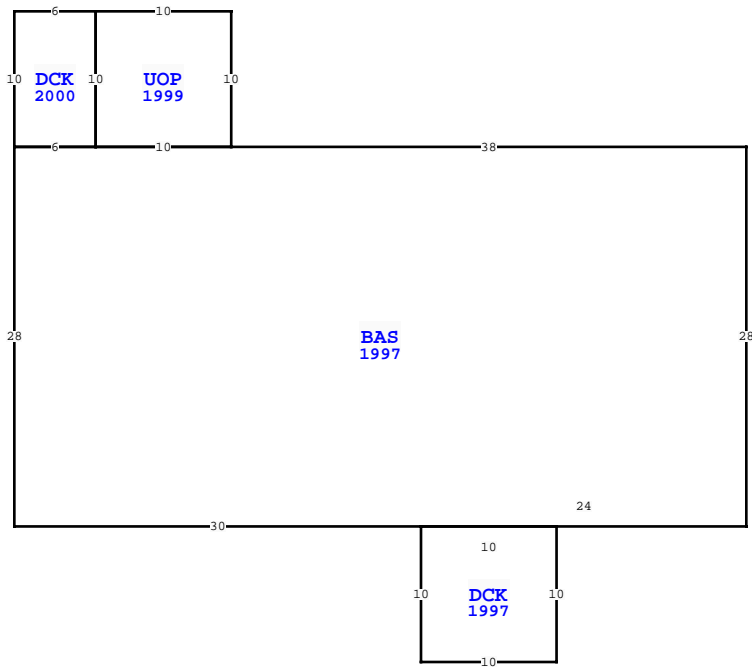

BUILDING CHARACTERISTICS		
ELEMENT	CD	CONSTRUCTION
Foundation	01	WOOD FRAME 100
Frame	02	WOOD FRAME 100
Exterior Wall	30	VINYL 100
Roof Structur	03	GABLE/HIP 100
Roof Cover	04	COMP SHNGL 100
Interior Wall	03	PLYWOOD 100
Interior Floo	08	SHT VINYL 50
Interior Floo	14	CARPET 50
Heating Type	04	AIR DUCTED 100
Air Condition	03	CENTRAL 100
Bedrooms		3 100
Bathrooms		2 100
Stories	1.	1. 100
Class	00	N/A 100
Units		0 100
Quality	03	AVERAGE
DOR CODE	0200	MOBILE HOME
MAP NUM	1	MKT AREA 09
NEIGHBORHOOD/LOC	254.00	1.50/
AREA TYPE	TOTAL GROSS AREA	PCT OF BASE
BAS	1,512	100
DCK	100	10
DCK	60	10
UOP	100	25
TOTALS	1,772	

MARKET ADJUSTMENTS											
TYPE	MDL	EFF. AREA	TOT ADJ PTS	EFF. BASE RATE	REPL. COST NEW	AYB	EYB	ECON	FNCT	NORM	% COND
1	MOBILE HOM	100%	1998		Heated Area: 1512					HX Base Yr 1998	



WAKULLA COUNTY PROPERTY			
VALUATION SUMMARY			PAGE 1 of 1
VALUATION BY			STANDARD
Tax Group: 3	Tax Dist:		
BUILDING MARKET VALUE			94,664
TOTAL MARKET OB/XF VALUE			1,690
TOTAL LAND VALUE - MARKET			35,000
TOTAL MARKET VALUE			131,354
SOH/AGL Deduction			68,498
ASSESSED VALUE			62,856
TOTAL EXEMPTION VALUE	HX HB		37,856
BASE TAXABLE VALUE			25,000
TOTAL JUST VALUE			131,354
NCON VALUE			0
INCOME VALUE			
PREVIOUS YEAR MKT VALUE			109,209
5 YR PRCL CH, N/C			
5 YR PRCL CH, PU XFOB LN 3-4, PU FNDN			
PU FRME			
5 YR PRCL CH, CHG CODES XFOB LN 1-2, NEW TRAV			
PERMIT NUM	DESCRIPTION	AMT	ISSUED
18001201	REROOF-CO	0	11/08/2018
024794	ELEC	0	03/08/1999
22804	N/A	0	10/08/1997

SALES DATA						
OFF RECORD Number	DATE	TYPE INST	Q / U	V / I	RSN CD	SALE PRICE
0309/0234	9/22/1997	WD Q	Q	V		25,000

GRANTOR: COOK VERNON E & BARBA
GRANTEE:

BUILDING NOTES											

BUILDING DIMENSIONS											
BAS=[YR=1997] W38 UOP=[YR=1999] N10 W10 S10 E10\$ W10											
DCK=[YR=2000] N10 W6 S10 E6\$ W6 S28 E30 DCK=[YR=1997] S10 E10 N10 W10\$ E24 N28\$.											

EXTRA FEATURES																
L N	OB/XF CODE	DESCRIPTION	BLD CAP	L	W	UNITS	UT	Adj R	ADJ UNIT PRICE	ORIG COND	YEAR ON	YEAR ACTUAL	Q	% COND	OB/XF MKT VALUE	NOTES
1	0700	PORT BLDG	0	100	8	10			8.00	100	1997	1997	3	54	346	
2	0700	PORT BLDG	0	100	10	20	SF	8.00	8.00	100	1999	1999	3	56	896	
3	0940	OPEN SHED	0	100	10	8	SF	4.00	4.00	100	2010	2010	3	43	138	
4	0055	PORTABLE C	0	100	20	12	SF	3.00	3.00	100	2010	2010	3	43	310	

LAND DESCRIPTION																								
L N	USE CODE	CLS	LAND USE DESCRIPTION	CAP	R D	LOC ZONE	FRONT	DEPTH	TOT LND UTS	UNIT TYPE	D T	DPH FACT	% COND	TOT ADJ	UNIT PRICE	ADJ UNIT PRICE	LAND VALUE	OTHER ADJUSTMENTS AND NOTES	YEAR	DENSITY	DECL	FRZ	YR	CONSRV
1	000201	C	MH	100			0.00	0.00	1.00	LT		1.00	1.00	1.00	35,000.00	35,000.00	35,000							