

EDGEWOOD LOT 13  
OR 137 P 565 & OR 143 717  
OR 213 P 861 OR 485 P 185

LAWRENCE LORETTA/LAWRENCE ALTON D  
133 EDGEWOOD DR  
CRAWFORDVILLE, FL 32327

2024

06-3S-01W-243-04301-013



| BUILDING CHARACTERISTICS |                  | CONSTRUCTION  |      |
|--------------------------|------------------|---------------|------|
| ELEMENT                  | CD               |               |      |
| Foundation               | 02               | CONCR SLAB    | 100  |
| Frame                    | 02               | WOOD FRAME    | 100  |
| Exterior Wall            | 30               | VINYL         | 90   |
| Exterior Wall            | 21               | STONE         | 10   |
| Roof Structure           | 03               | GABLE/HIP     | 100  |
| Roof Cover               | 03               | COMP SHNGL    | 100  |
| Interior Wall            | 05               | DRYWALL       | 100  |
| Interior Floor           | 11               | CLAY TILE     | 50   |
| Interior Floor           | 14               | CARPET        | 50   |
| Heating Type             | 04               | AIR DUCTED    | 100  |
| Air Condition            | 03               | CENTRAL       | 100  |
| Bedrooms                 |                  | 3             | 100  |
| Bathrooms                |                  | 2             | 100  |
| Story Height             |                  | 0             | 100  |
| Stories                  | 1.               | 1.            | 100  |
| Units                    |                  | 0             | 100  |
| Quality                  | 03               | AVERAGE       |      |
| DOR CODE                 | 0100             | SINGLE FAMILY |      |
| MAP NUM                  | 2                | MKT AREA      | 10   |
| NEIGHBORHOOD/LOC         | 243.00           | 1.00/         |      |
| AREA TYPE                | TOTAL GROSS AREA | PCT OF BASE   | YEAR |
| BAS                      | 1,960            | 100           | 2003 |
| FGR                      | 528              | 50            | 2003 |
| FOP                      | 168              | 30            | 2003 |
| PTO                      | 216              | 5             | 2003 |
| UCP                      | 480              | 20            | 2007 |
| UGR                      | 960              | 40            | 2007 |
| TOTALS                   | 4,312            |               |      |

| MARKET ADJUSTMENTS |            |           |             |                |                |                 |     |      |      |      |        |
|--------------------|------------|-----------|-------------|----------------|----------------|-----------------|-----|------|------|------|--------|
| TYPE               | MDL        | EFF. AREA | TOT ADJ PTS | EFF. BASE RATE | REPL. COST NEW | AYB             | EYB | ECON | FNCT | NORM | % COND |
| 1                  | SINGLE FAM | 100%      | - 2004      |                |                |                 |     |      |      |      |        |
| Heated Area: 1960  |            |           |             |                |                | HX Base Yr 2004 |     |      |      |      |        |

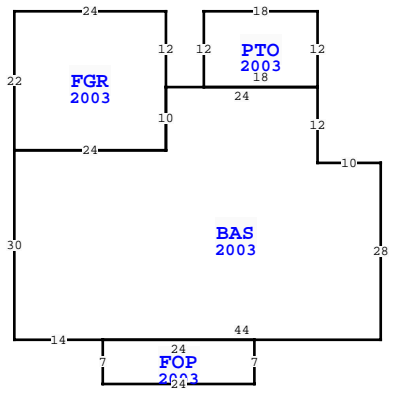
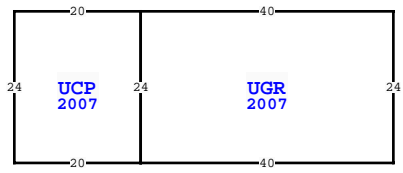

| WAKULLA COUNTY PROPERTY   |             |           |                    |
|---|-------------|-----------|--------------------|
| VALUATION SUMMARY   |             |           | PAGE 1 of 1        |
| VALUATION BY  |             |           | STANDARD           |
| Tax Group: 3  | Tax Dist:   |           |                    |
| BUILDING MARKET VALUE   |             |           | 246,063            |
| TOTAL MARKET OB/XF VALUE  |             |           | 4,397              |
| TOTAL LAND VALUE - MARKET   |             |           | 25,000             |
| TOTAL MARKET VALUE  |             |           | 275,460            |
| SOH/AGL Deduction   |             |           | 75,879             |
| ASSESSED VALUE  |             |           | 199,581            |
| TOTAL EXEMPTION VALUE   | HX HB       | 50,000    |                    |
| BASE TAXABLE VALUE  |             |           | 149,581            |
| TOTAL JUST VALUE  |             |           | 275,460            |
| NCON VALUE  |             |           | 0                  |
| INCOME VALUE  |             |           |                    |
| PREVIOUS YEAR MKT VALUE   |             |           | 278,926            |
| 5 YR PRCL CHK, CHG XFOB LN 5 DIMN   |             |           |                    |
| COMPELTED / RETURNED APP.   |             |           |                    |
| MAILED APPLICATOIN FOR \$500DX, PENDING   |             |           |                    |
| FNND & FRME   |             |           |                    |
| PERMIT NUM  | DESCRIPTION | AMT       | ISSUED             |
| 2007685   | POLE BARN   | 0         | 05/08/2007         |
| 29510   | SFD         | 0         | 10/14/2002         |
| SALES DATA  |             |           |                    |
| OFF RECORD Number   | DATE        | TYPE INST | Q / V / I / RSN CD |
| 0485/0185   | 4/29/2003   | WD Q      | I                  |
|   |             |           | SALE PRICE         |
|   |             |           | 166,000            |
| GRANTOR: ABBOTT LEWIS A & DORO  |             |           |                    |
| GRANTEE: LAWRENCE LORETTA &   |             |           |                    |
| BUILDING NOTES  |             |           |                    |
| BUILDING DIMENSIONS   |             |           |                    |
| PTO=[YR=2003] W18 S12 E18 BAS=[YR=2003] W24 FGR=[YR=2003] N12 W24 PTR= N20 UCP=[YR=2007] E20 UGR=[YR=2007] E40 N24 W40 S24\$ N24 W20 S24\$ S20\$ S22 E24 N10\$ S10 W24 S30 E14 POP=[YR=2003] S7 E24 N7 W24\$ E44 N28 W10 N12\$ N12\$. |             |           |                    |

| EXTRA FEATURES |            |             |         |     |    |       |    |       |                |           |         |             |   |        |
|----------------|------------|-------------|---------|-----|----|-------|----|-------|----------------|-----------|---------|-------------|---|--------|
| L N            | OB/XF CODE | DESCRIPTION | BLD CAP | L   | W  | UNITS | UT | Adj R | ADJ UNIT PRICE | ORIG COND | YEAR ON | YEAR ACTUAL | Q | % COND |
| 1              | 0620       | WOOD UTL B  | 0       | 100 | 20 | 12    |    |       | 6.00           | 100       | 1988    | 1988        | 3 | 20     |
| 2              | 0210       | CONCRETE D  | 0       | 100 | 0  | 0     | SF | 6.00  | 6.00           | 100       | 2003    | 2003        | 3 | 21     |
| 3              | 0211       | CONCRETE W  | 0       | 100 | 32 | 3     | SF | 6.00  | 6.00           | 100       | 2003    | 2003        | 3 | 21     |
| 4              | 0600       | GRN HSE FA  | 0       | 100 | 8  | 10    | SF | 4.00  | 4.00           | 100       | 2004    | 2004        | 3 | 23     |
| 5              | 0940       | OPEN SHED   | 0       | 100 | 8  | 20    | SF | 4.00  | 4.00           | 100       | 2004    | 2004        | 3 | 23     |
| TOTALS         |            |             |         |     |    |       |    |       |                |           |         |             |   |        |

| LAND DESCRIPTION |          |     |                      |     |     |          |       |       |             |           |     |          |        |         |
|------------------|----------|-----|----------------------|-----|-----|----------|-------|-------|-------------|-----------|-----|----------|--------|---------|
| L N              | USE CODE | CLS | LAND USE DESCRIPTION | CAP | R D | LOC ZONE | FRONT | DEPTH | TOT LND UTS | UNIT TYPE | D T | DPH FACT | % COND | TOT ADJ |
| 1                | 000100   | C   | SFR                  | 100 |     |          | 0.00  | 0.00  | 1.00        | LT        |     | 1.00     | 1.00   | 1.00    |