

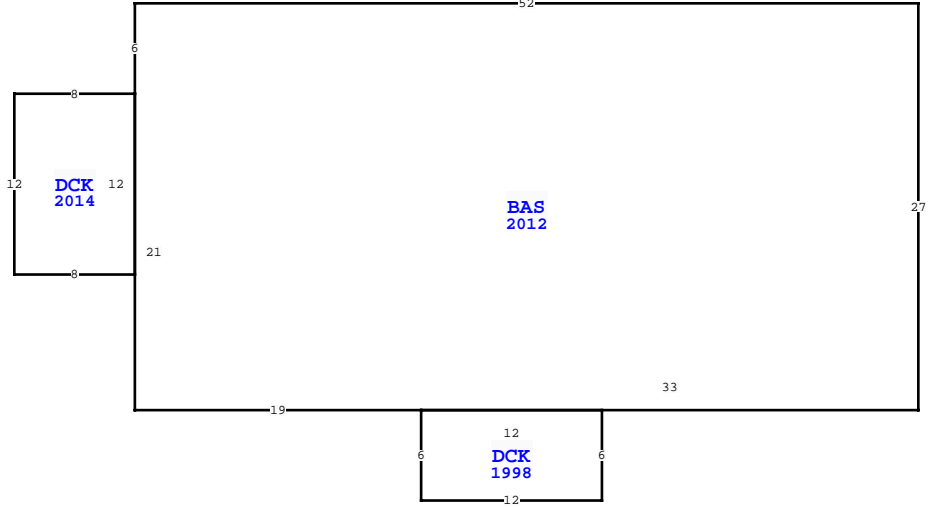

BUILDING CHARACTERISTICS					
ELEMENT	CD	CONSTRUCTION			
Foundation	01	WOOD FRAME 100			
Frame	02	WOOD FRAME 100			
Exterior Wall	30	VINYL 100			
Roof Structur	03	GABLE/HIP 100			
Roof Cover	03	COMP SHNGL 100			
Interior Wall	05	DRYWALL 100			
Interior Floo	14	CARPET 80			
Interior Floo	08	SHT VINYL 20			
Heating Type	04	AIR DUCTED 100			
Air Condition	03	CENTRAL 100			
Bedrooms		3 100			
Bathrooms		2 100			
Stories	1.	1. 100			
Class	00	N/A 100			
Units		0 100			
Quality	03	AVERAGE			
DOR CODE	0200	MOBILE HOME			
MAP NUM	2	MKT AREA 10			
NEIGHBORHOOD/LOC	115.00	1.00/			
AREA TYPE	TOTAL GROSS AREA	PCT OF BASE	YEAR	TOT ADJ AREA	SUBAREA MARKET VALUE
BAS	1,404	100	2012	1,404	58,595
DCK	72	10	1998	7	292
DCK	96	10	2014	10	417
TOTALS	1,572			1,421	59,304

MARKET ADJUSTMENTS											
TYPE	MDL	EFF. AREA	TOT ADJ PTS	EFF. BASE RATE	REPL. COST NEW	AYB	EYB	ECON	FNCT	NORM	% COND
1	MOBILE HOM	100% - 2013		75.88	107,825	1998	1998	0	0	45.00	55.00
			Heated Area: 1404				HX Base Yr 2013				



WAKULLA COUNTY PROPERTY				
VALUATION SUMMARY			PAGE 1 of 1	
VALUATION BY		STANDARD		
Tax Group: 3		Tax Dist:		
BUILDING MARKET VALUE		59,304		
TOTAL MARKET OB/XF VALUE		374		
TOTAL LAND VALUE - MARKET		25,000		
TOTAL MARKET VALUE		84,678		
SOH/AGL Deduction		44,428		
ASSESSED VALUE		40,250		
TOTAL EXEMPTION VALUE		25,000		
BASE TAXABLE VALUE		15,250		
TOTAL JUST VALUE		84,678		
NCON VALUE		0		
INCOME VALUE				
PREVIOUS YEAR MKT VALUE		72,507		
5YR CK JS PU XFOB				
MAILED RENEWAL CARD- 2020				
SPOUSE INFO				
2020 QUESTIONNAIRE RTND COMPLETE- UPDATED				
PERMIT NUM	DESCRIPTION	AMT	ISSUED	
2014805	RE-ROOF	0	09/29/2014	
2012713	MECH	0	10/22/2012	
2012674	MH SETUP-CO	0	10/05/2012	
SALES DATA				
OFF RECORD Number	DATE	TYPE INST	Q U / V I / RSN CD	SALE PRICE
0884/0503	7/12/2012	WD Q	V 03	17,500
GRANTOR: GEARHART ROSEMARY				
GRANTEE: BURNHAM CASSANDRA				
0676/0492	9/22/2006	WD Q	V 01	17,000
GRANTOR: GEARHART MARY M.				
GRANTEE: GEARHART ROSEMARY				
BUILDING NOTES				
BUILDING DIMENSIONS				
BAS=[YR=2012] W52 S6 DCK=[YR=2014] W8 S12 E8 N12\$ S21 E19				
DCK=[YR=1998] S6 E12 N6 W12\$ E33 N27\$.				

EXTRA FEATURES																
L N	OB/XF CODE	DESCRIPTION	BLD CAP	L	W	UNITS	UT	Adj R	ADJ UNIT PRICE	ORIG COND	YEAR ON	YEAR ACTUAL	Q	% COND	OB/XF MKT VALUE	NOTES
1	0625	PORT WD UT	0 100	10	12	120.00	SF	6.00	6.00	100	2012	2012	3	52	374	
2	0605	PORT VINYL	0 100	7	7	49.00	SF	0.00	0.00	100	2012	2012	3	52	0	
3	0700	PORT BLDG	0 100	10	12	120.00	SF	0.00	0.00	100	2019	2019	3	92	0	
TOTALS																

LAND DESCRIPTION																								
L N	USE CODE	CLS	LAND USE DESCRIPTION	CAP	R D	LOC ZONE	FRONT	DEPTH	TOT LND UTS	UNIT TYPE	D T	DPH FACT	% COND	TOT ADJ	UNIT PRICE	ADJ UNIT PRICE	LAND VALUE	OTHER ADJUSTMENTS AND NOTES	YEAR	DENSITY	DECL	FRZ	YR	CONSRV
1	000201	C	MH	100		RR1	125.00	180.00	1.00	LT		1.00	1.00	1.00	25,000.00	25,000.00	25,000							