

| ELEMENT       | CD | CONSTRUCTION   |
|---------------|----|----------------|
| Foundation    | 04 | PILE WOOD 100  |
| Frame         | 02 | WOOD FRAME 100 |
| Exterior Wall | 08 | WD ON PLY 100  |
| Roof Structur | 03 | GABLE/HIP 100  |
| Roof Cover    | 03 | COMP SHNGL 100 |
| Interior Wall | 05 | DRYWALL 100    |
| Interior Floo | 08 | SHT VINYL 50   |
| Interior Floo | 14 | CARPET 50      |
| Heating Type  | 04 | AIR DUCTED 100 |
| Air Condition | 03 | CENTRAL 100    |
| Bedrooms      |    | 3 100          |
| Bathrooms     |    | 2 100          |
| Story Height  |    | 0 100          |
| Stories       | 1. | 1. 100         |
| Units         |    | 0 100          |

| MARKET ADJUSTMENTS                               |     |           |             |                |                |      |      |      |      |      |        |       |
|--|-----|-----------|-------------|----------------|----------------|------|------|------|------|------|--------|-------|
| TYPE   | MDL | EFF. AREA | TOT ADJ PTS | EFF. BASE RATE | REPL. COST NEW | AYB  | EYB  | ECON | FNCT | NORM | % COND |       |
| 0100   | 01  | 2,780     | 98.6000     | 149.87         | 416,639        | 1987 | 1991 | 0    | 0    | 0    | 32.00  | 68.00 |
| 1 SINGLE FAM 0% - 0 Heated Area: 1912 HX Base Yr |     |           |             |                |                |      |      |      |      |      |        |       |

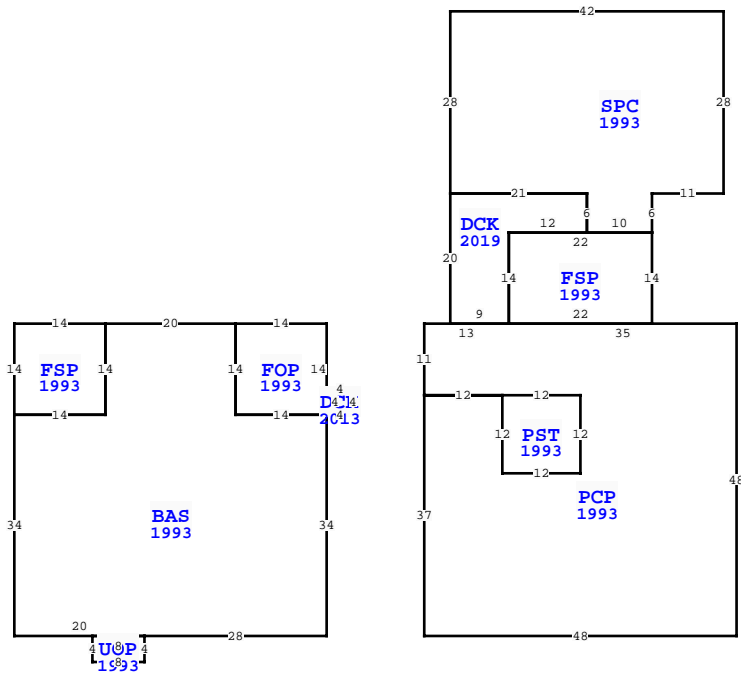

| Quality          |                  | 02 BELOW AVERAGE   |      |              |                      |
|------------------|------------------|--------------------|------|--------------|----------------------|
| DOR CODE         |                  | 0100 SINGLE FAMILY |      |              |                      |
| MAP NUM          |                  | 4 MKT AREA 03      |      |              |                      |
| NEIGHBORHOOD/LOC |                  | 27.100 1.60/       |      |              |                      |
| AREA TYPE        | TOTAL GROSS AREA | PCT OF BASE        | YEAR | TOT ADJ AREA | SUBAREA MARKET VALUE |
| BAS              | 1,912            | 100                | 1993 | 1,912        | 194,855              |
| DCK              | 16               | 10                 | 2013 | 2            | 204                  |
| DCK              | 252              | 10                 | 2019 | 25           | 2,548                |
| FOP              | 196              | 30                 | 1993 | 59           | 6,013                |
| FSP              | 196              | 55                 | 1993 | 108          | 11,006               |
| FSP              | 308              | 55                 | 1993 | 169          | 17,223               |
| PCP              | 2,304            | 10                 | 1993 | 230          | 23,440               |
| PST              | 144              | 15                 | 1993 | 22           | 2,242                |
| SPC              | 1,236            | 20                 | 1993 | 247          | 25,172               |
| UOP              | 32               | 20                 | 1993 | 6            | 611                  |
| <b>TOTALS</b>    | <b>6,596</b>     |                    |      | <b>2,780</b> | <b>283,315</b>       |

| WAKULLA COUNTY PROPERTY                          |  |  |  | PAGE 1 of 2            | 3 |
|--|--|--|--|------------------------|---|
| VALUATION SUMMARY                                |  |  |  | STANDARD               |   |
| VALUATION BY                                     |  |  |  | Tax Group: 3 Tax Dist: |   |
| BUILDING MARKET VALUE                            |  |  |  | 283,315                |   |
| TOTAL MARKET OB/XF VALUE                         |  |  |  | 59,793                 |   |
| TOTAL LAND VALUE - MARKET                        |  |  |  | 155,000                |   |
| TOTAL MARKET VALUE                               |  |  |  | 498,108                |   |
| SOH/AGL Deduction                                |  |  |  | 83,639                 |   |
| ASSESSED VALUE                                   |  |  |  | 414,469                |   |
| TOTAL EXEMPTION VALUE                            |  |  |  | 0                      |   |
| BASE TAXABLE VALUE                               |  |  |  | 414,469                |   |
| TOTAL JUST VALUE                                 |  |  |  | 498,108                |   |
| NCON VALUE                                       |  |  |  | 0                      |   |
| INCOME VALUE                                     |  |  |  | 0                      |   |
| PREVIOUS YEAR MKT VALUE                          |  |  |  | 443,278                |   |
| INCR EYB 1987-1991 RE-ROOF OB23-378 CC 8/24/2023 |  |  |  |                        |   |
| PU XFOB LN 11-12                                 |  |  |  |                        |   |
| XFOB LN 16-17, CHG BATHS, FLOR, QUAL & TRAV.     |  |  |  |                        |   |
| 5 YR PRCL CK, CHG DIM & UNITS XFOB LN 2, DEL     |  |  |  |                        |   |

| PERMIT NUM  | DESCRIPTION     | AMT | ISSUED     |
|-------------|-----------------|-----|------------|
| OB23-000378 | RE-ROOF - CC    | 0   | 08/01/2023 |
| 20000166    | GAS             | 0   | 08/28/2020 |
| 20000108    | GENERATOR-CO    | 0   | 07/07/2020 |
| 18000809    | REPLC BOAT LIFT | 0   | 08/06/2018 |
| 17000153    | DOCK REPAIR     | 0   | 02/21/2017 |
| 2014270     | MECH            | 0   | 04/07/2014 |

| SALES DATA                     |            |           |       |       |        |            |
|--------------------------------|------------|-----------|-------|-------|--------|------------|
| OFF RECORD Number              | DATE       | TYPE INST | Q / U | V / I | RSN CD | SALE PRICE |
| 1136/0248                      | 12/05/2019 | WD        | U     | I     | 30     | 284,000    |
| GRANTOR: BROWN MATTHEW THOMAS  |            |           |       |       |        |            |
| GRANTEE: BROWN BRANDI MARIE    |            |           |       |       |        |            |
| 1031/0424                      | 4/12/2017  | WD        | Q     | I     | 01     | 390,000    |
| GRANTOR: YELTON EMERY J & SUSA |            |           |       |       |        |            |
| GRANTEE: BROWN MATT T & BRAN   |            |           |       |       |        |            |

| EXTRA FEATURES |            |             |         |   |     |       |    |           |                |           |         |             |   |        |                 |       |
|----------------|------------|-------------|---------|---|-----|-------|----|-----------|----------------|-----------|---------|-------------|---|--------|-----------------|-------|
| L N            | OB/XF CODE | DESCRIPTION | BLD CAP | L | W   | UNITS | UT | Adj R     | ADJ UNIT PRICE | ORIG COND | YEAR ON | YEAR ACTUAL | Q | % COND | OB/XF MKT VALUE | NOTES |
| 1              | 0220       | POOL VINYL  | 0       | 0 | 32  | 15    | SF | 96.00     | 96.00          | 100       | 1987    | 1987        | 3 | 40     | 20,160          |       |
| 2              | 0770       | PUMP HOUSE  | 0       | 0 | 6   | 5     | SF | 8.00      | 8.00           | 100       | 1987    | 1987        | 3 | 0      | 0               |       |
| 3              | 0080       | 4' CHAINLI  | 0       | 0 | 180 | 0     | LF | 20.80     | 20.80          | 100       | 1987    | 1987        | 3 | 20     | 749             |       |
| 4              | 0005       | ELEVATOR    | 0       | 0 | 0   | 0     | UT | 46,400.00 | 46,400.00      | 100       | 1987    | 1987        | 3 | 44     | 20,416          |       |
| 5              | 0210       | CONCRETE D  | 0       | 0 | 0   | 0     | SF | 9.60      | 9.60           | 100       | 1987    | 1987        | 3 | 20     | 3,105           |       |
| 6              | 0350       | BOATDOCK A  | 0       | 0 | 15  | 8     | SF | 38.40     | 38.40          | 100       | 2000    | 2000        | 3 | 20     | 922             |       |
| 7              | 0007       | ELECTRIC L  | 0       | 0 | 0   | 0     | UT | 12,000.00 | 12,000.00      | 100       | 2000    | 2000        | 3 | 20     | 2,400           |       |
| 8              | 0375       | WOOD WALK   | 0       | 0 | 286 | 4     | SF | 24.00     | 24.00          | 100       | 2000    | 2000        | 3 | 20     | 5,491           |       |
| 9              | 0060       | DECK WOOD   | 0       | 0 | 4   | 8     | SF | 8.00      | 8.00           | 100       | 1987    | 1987        | 3 | 20     | 51              |       |
| 10             | 0080       | 4' CHAINLI  | 0       | 0 | 0   | 0     | LF | 20.80     | 20.80          | 100       | 1987    | 1987        | 3 | 20     | 1,331           |       |

| TOTAL OB/XF |          |     |                      |     |     |          |       |        |             |           |     | 54,625   |        |         |            |                |            |                             |      |         |      |     |    |        |
|-------------|----------|-----|----------------------|-----|-----|----------|-------|--------|-------------|-----------|-----|----------|--------|---------|------------|----------------|------------|-----------------------------|------|---------|------|-----|----|--------|
| L N         | USE CODE | CLS | LAND USE DESCRIPTION | CAP | R D | LOC ZONE | FRONT | DEPTH  | TOT LND UTS | UNIT TYPE | D T | DPH FACT | % COND | TOT ADJ | UNIT PRICE | ADJ UNIT PRICE | LAND VALUE | OTHER ADJUSTMENTS AND NOTES | YEAR | DENSITY | DECL | FRZ | YR | CONSRV |
| 1           | 000132   | C   | SFR RIVER            | 0   |     |          | 78.00 | 285.00 | 1.00        | LT        |     | 1.00     | 1.00   | 1.00    | 155,000.00 | 155,000.00     | 155,000    |                             |      |         |      |     |    |        |

| LAND DESCRIPTION |          |     |                      |     |     |          |       |        |             |           |     | TOTAL OB/XF |        |         |            |                | 54,625     |                             |      |         |      |     |    |        |
|------------------|----------|-----|----------------------|-----|-----|----------|-------|--------|-------------|-----------|-----|-------------|--------|---------|------------|----------------|------------|-----------------------------|------|---------|------|-----|----|--------|
| L N              | USE CODE | CLS | LAND USE DESCRIPTION | CAP | R D | LOC ZONE | FRONT | DEPTH  | TOT LND UTS | UNIT TYPE | D T | DPH FACT    | % COND | TOT ADJ | UNIT PRICE | ADJ UNIT PRICE | LAND VALUE | OTHER ADJUSTMENTS AND NOTES | YEAR | DENSITY | DECL | FRZ | YR | CONSRV |
| 1                | 000132   | C   | SFR RIVER            | 0   |     |          | 78.00 | 285.00 | 1.00        | LT        |     | 1.00        | 1.00   | 1.00    | 155,000.00 | 155,000.00     | 155,000    |                             |      |         |      |     |    |        |

