

| BUILDING CHARACTERISTICS | |
|--------------------------|-----------------------------|
| ELEMENT | CD |
| Foundation | 01 WOOD FRAME 100 |
| Frame | 02 WOOD FRAME 100 |
| Exterior Wall | 30 VINYL 100 |
| Roof Structur | 03 GABLE/HIP 100 |
| Roof Cover | 13 GALVALUM 100 |
| Interior Wall | 05 DRYWALL 100 |
| Interior Floo | 08 SHT VINYL 50 |
| Interior Floo | 14 CARPET 50 |
| Heating Type | 04 AIR DUCTED 100 |
| Air Condition | 03 CENTRAL 100 |
| Bedrooms | 3 100 |
| Bathrooms | 2 100 |
| Stories | 1. 1. 100 |
| Class | 00 N/A 100 |
| Units | 0 100 |
| Quality | 03 AVERAGE |
| DOR CODE | 0200 MOBILE HOME |
| MAP NUM | 2 MKT AREA 10 |
| NEIGHBORHOOD/LOC | 4348 1.00/ |
| AREA TYPE | TOTAL GROSS AREA |
| PCT OF BASE | YEAR |
| TOT ADJ AREA | SUBAREA MARKET VALUE |
| BAS | 1,716 100 1998 1,716 77,682 |
| CAN | 320 30 1999 96 4,346 |
| UOP | 36 25 2021 9 407 |
| TOTALS | 2,072 1,821 82,435 |

| MARKET ADJUSTMENTS | | | | | | | | | | | | | |
|--------------------|------------|-----------|-------------|----------------|-------------------|-----|-----------------|------|------|------|--------|--|--|
| TYPE | MDL | EFF. AREA | TOT ADJ PTS | EFF. BASE RATE | REPL. COST NEW | AYB | EYB | ECON | FNCT | NORM | % COND | | |
| 1 | MOBILE HOM | 100% | - 1998 | | Heated Area: 1716 | | HX Base Yr 1998 | | | | | | |

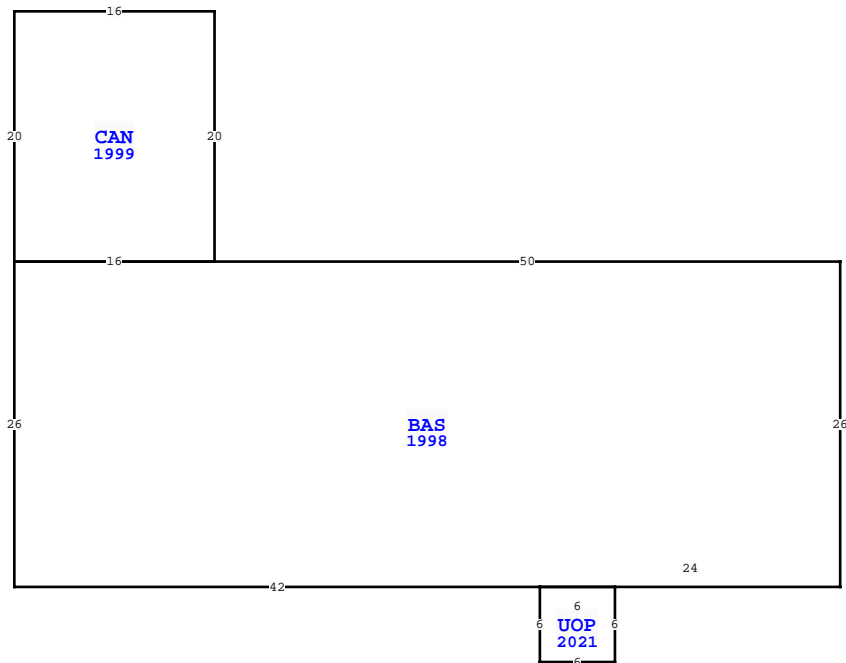

| WAKULLA COUNTY PROPERTY | | | |
|---|-------------|-----|-------------|
| VALUATION SUMMARY | | | PAGE 1 of 1 |
| VALUATION BY | | | STANDARD |
| Tax Group: 3 | | | Tax Dist: |
| BUILDING MARKET VALUE | | | 82,435 |
| TOTAL MARKET OB/XF VALUE | | | 1,524 |
| TOTAL LAND VALUE - MARKET | | | 11,250 |
| TOTAL MARKET VALUE | | | 95,209 |
| SOH/AGL Deduction | | | 51,048 |
| ASSESSED VALUE | | | 44,161 |
| TOTAL EXEMPTION VALUE | HX HB | | 25,000 |
| BASE TAXABLE VALUE | | | 19,161 |
| TOTAL JUST VALUE | | | 95,209 |
| NCON VALUE | | | 0 |
| INCOME VALUE | | | |
| PREVIOUS YEAR MKT VALUE | | | 71,661 |
| INCR EYB 97-01 NEW ROOF | | | |
| FR 5 YR CK, PU NEW TRAV, CH BLDG COMP, INCR E | | | |
| 5 YR PRCL CK, N/C | | | |
| 5 YR PRCL CH, PU FNDN & FRME | | | |
| PERMIT NUM | DESCRIPTION | AMT | ISSUED |
| 19000455 | ROOF OVER | 0 | 05/10/2019 |
| 22940 | N/A | 0 | 11/14/1997 |

| SALES DATA | | | | | | |
|-------------------|-----------|-----------|-----|-----|--------|------------|
| OFF RECORD Number | DATE | TYPE INST | Q U | V I | RSN CD | SALE PRICE |
| 0205/0751 | 1/19/1993 | WD | U | V | | 100 |

| EXTRA FEATURES | | | | | | | | | | | | | | | | |
|----------------|------------|-------------|---------|-----|----|-------|--------|-------|----------------|-----------|---------|-------------|---|--------|-----------------|-------|
| L N | OB/XF CODE | DESCRIPTION | BLD CAP | L | W | UNITS | UT | Adj R | ADJ UNIT PRICE | ORIG COND | YEAR ON | YEAR ACTUAL | Q | % COND | OB/XF MKT VALUE | NOTES |
| 1 | 0130 | FIRE PLACE | 0 | 100 | 0 | 0 | 1.00 | UT | 1,300.00 | 100 | 1997 | 1997 | 3 | 54 | 702 | |
| 2 | 0080 | 4' CHAINLI | 0 | 100 | 0 | 0 | 154.00 | LF | 13.00 | 100 | 1998 | 1998 | 3 | 20 | 400 | |
| 3 | 0700 | PORT BLDG | 0 | 100 | 12 | 8 | 96.00 | SF | 8.00 | 100 | 1998 | 1998 | 3 | 55 | 422 | |

| BUILDING NOTES | | | |
|----------------|--|--|--|
| | | | |

| BUILDING DIMENSIONS | | | |
|--|--|--|--|
| BAS=[YR=1998] W50 CAN=[YR=1999] N20 W16 S20 E16\$ W16 S26 E42 UOP=[YR=2021] S6 E6 N6 W6\$ E24 N26\$. | | | |

| LAND DESCRIPTION | | | | | | | | | | | | | | TOTAL OB/XF | | | | | | | | | | |
|------------------|----------|-----|----------------------|-----|-----|----------|-------|-------|-------------|-----------|-----|----------|--------|-------------|------------|----------------|------------|-----------------------------|------|---------|------|-----|----|--------|
| L N | USE CODE | CLS | LAND USE DESCRIPTION | CAP | R D | LOC ZONE | FRONT | DEPTH | TOT LND UTS | UNIT TYPE | D T | DPH FACT | % COND | TOT ADJ | UNIT PRICE | ADJ UNIT PRICE | LAND VALUE | OTHER ADJUSTMENTS AND NOTES | YEAR | DENSITY | DECL | FRZ | YR | CONSRV |
| 1 | 000201 | C | MH | 100 | | | 0.00 | 0.00 | 1.00 | AC | | 1.00 | 1.00 | 1.00 | 11,250.00 | 11,250.00 | 11,250 | | | | | | | |