

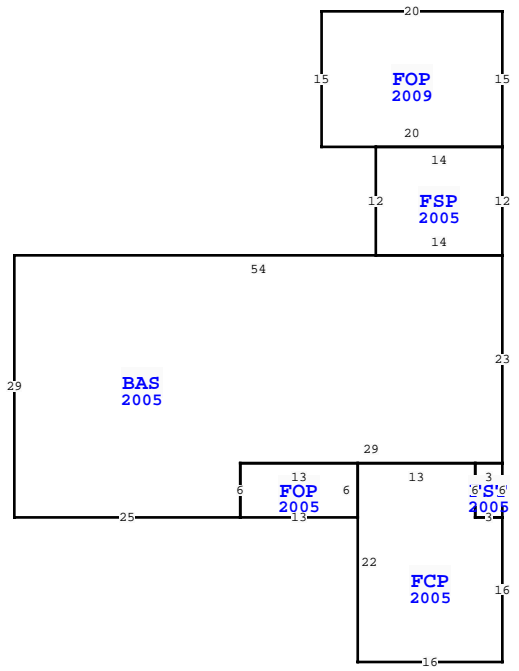

ELEMENT		BUILDING CHARACTERISTICS			
CD	CONSTRUCTION				
02	CONCR SLAB 100				
02	WOOD FRAME 100				
30	VINYL 100				
03	GABLE/HIP 100				
13	GALVALUM 100				
05	DRYWALL 100				
11	CLAY TILE 50				
14	CARPET 50				
04	AIR DUCTED 100				
03	CENTRAL 100				
	3 100				
	2 100				
	0 100				
1.	1. 100				
	0 100				
03	AVERAGE				
0100	SINGLE FAMILY				
5	MKT AREA	02			
63.00	1.00/				
AREA TYPE	TOTAL GROSS AREA	PCT OF BASE	YEAR	TOT ADJ AREA	SUBAREA MARKET VALUE
BAS	1,392	100	2005	1,392	128,503
FCP	334	25	2005	84	7,755
FOP	78	30	2005	23	2,123
FOP	300	30	2009	90	8,308
FSP	168	55	2005	92	8,493
FST	18	55	2005	10	923
TOTALS	2,290			1,691	156,106

MARKET ADJUSTMENTS											
TYPE	MDL	EFF. AREA	TOT ADJ PTS	EFF. BASE RATE	REPL. COST NEW	AYB	EYB	ECON	FNCT	NORM	% COND
0100	01	1,691	118.5000	112.58	190,373	2005	2005	0	0	18.00	82.00
2 SINGLE FAM 100% - 2006 Heated Area: 1392 HX Base Yr 2006											



WAKULLA COUNTY PROPERTY			
VALUATION SUMMARY			PAGE 1 of 2
VALUATION BY		STANDARD	
Tax Group: 3		Tax Dist:	
BUILDING MARKET VALUE		156,106	
TOTAL MARKET OB/XF VALUE		13,678	
TOTAL LAND VALUE - MARKET		37,500	
TOTAL MARKET VALUE		207,284	
SOH/AGL Deduction		60,912	
ASSESSED VALUE		146,372	
TOTAL EXEMPTION VALUE		HX HB 50,000	
BASE TAXABLE VALUE		96,372	
TOTAL JUST VALUE		207,284	
NCON VALUE		0	
INCOME VALUE			
PREVIOUS YEAR MKT VALUE		209,901	
NEW SPOUSE SSN PROVIDED. RMVD H5			
H5 - NEED SPOUSE'S INFO			
WR EXEMPTION REMOVED. THOMAS ROBERTS REMARRIED PER			
JESSICA ROBERTS DC OR 1228 P 30			
PERMIT NUM	DESCRIPTION	AMT	ISSUED
32402	SFD	0	09/20/2004

SALES DATA						
OFF RECORD Number	DATE	TYPE INST	Q / U	V / I	RSN CD	SALE PRICE
1352/0301	3/19/2024	QC	U	I	11	100
GRANTOR: ROBERTS THOMAS MCCOY						
GRANTEE: ROBERTS THOMAS MCCO						
1344/0366	1/19/2024	QC	U	I	11	100
GRANTOR: ROBERTS THOMAS MCCOY						
GRANTEE: ROBERTS THOMAS MCCO						

EXTRA FEATURES																	
L N	OB/XF CODE	DESCRIPTION	BLD	CAP	L	W	UNITS	UT	Adj R	ADJ UNIT PRICE	ORIG COND	YEAR ON	YEAR ACTUAL	Q	% COND	OB/XF MKT VALUE	NOTES
1	0210	CONCRETE D	0	100	12	16	192.00	SF	6.00	6.00	100	2005	2005	3	24	276	
2	0211	CONCRETE W	0	100	32	4	128.00	SF	6.00	6.00	100	1996	1996	3	20	154	
3	0210	CONCRETE D	0	100	22	21	462.00	SF	6.00	6.00	100	1996	1996	3	20	554	
4	0940	OPEN SHED	0	100	22	21	462.00	SF	4.00	4.00	100	1991	1991	3	20	370	
5	0210	CONCRETE D	0	100	22	21	462.00	SF	6.00	6.00	100	1996	1996	3	20	554	
6	0630	METAL UTL	0	100	14	21	294.00	SF	8.00	8.00	100	1991	1991	3	20	470	
7	0950	METAL SHED	0	100	16	21	336.00	SF	8.00	8.00	100	1991	1991	3	20	538	
8	0060	DECK WOOD	0	100	24	10	240.00	SF	5.00	5.00	100	2007	2007	3	40	480	
9	0955	PRIVACY FE	0	100	0	0	48.00	LF	15.00	15.00	100	2007	2007	3	40	288	
10	0620	WOOD UTL B	0	100	14	12	168.00	SF	6.00	6.00	100	1996	1996	3	20	202	

TOTAL OB/XF											
3,886											
BLD DATE	06/27/2019	MMJT	LGL DATE								
XF DATE	06/27/2019	MMJT	LAND DATE	06/27/2019							
INC DATE			AG DATE								

BUILDING NOTES											

BUILDING DIMENSIONS											
FOP=[YR=2009] W20 S15 E20 FSP=[YR=2005] W14 S12 E14											
BAS=[YR=2005] W54 S29 E25 N6 E29 FST=[YR=2005] W3 S6 E3											
FCP=[YR=2005] W3 N6 W13 FOP=[YR=2005] W13 S6 E13 N6 S22 E16											
N16 S N6 S N23 S N12 S N15 S.											

LAND DESCRIPTION																								
L N	USE CODE	CLS	LAND USE DESCRIPTION	CAP	R D	LOC ZONE	FRONT	DEPTH	TOT LND UTS	UNIT TYPE	D T	DPHT FACT	% COND	TOT ADJ	UNIT PRICE	ADJ UNIT PRICE	LAND VALUE	OTHER ADJUSTMENTS AND NOTES	YEAR	DENSITY	DECL	FRZ	YR	CONSRV
1	000100	C	SFR	100			0.00	0.00	5.00	AC		1.00	1.00	1.00	7,500.00	7,500.00	37,500							

