

BAY PARK SUB LOT 20
 OR 52 P 20 OR 85 P 171
 OR 114 P 104 OR 125 P 387

REID WILLIAM H/REID LAJEAN M
 PO BOX 215
 HARTSFIELD, GA 31756

2024

12-6S-02W-098-03906-020

ELEMENT	CD	CONSTRUCTION
Foundation	01	WOOD FRAME 100
Frame	02	WOOD FRAME 100
Exterior Wall	30	VINYL 100
Roof Structur	03	GABLE/HIP 100
Roof Cover	03	COMP SHNGL 100
Interior Wall	05	DRYWALL 100
Interior Floo	08	SHT VINYL 50
Interior Floo	14	CARPET 50
Heating Type	04	AIR DUCTED 100
Air Condition	03	CENTRAL 100
Bedrooms		3 100
Bathrooms		2 100
Stories	1.	1. 100
Class	00	N/A 100
Units		0 100

MARKET ADJUSTMENTS													
TYPE	MDL	EFF. AREA	TOT ADJ PTS	EFF. BASE RATE	REPL. COST NEW	AYB	EYB	ECON	FNCT	NORM	% COND		
0200	02	1,525	96.7500	67.72	103,273	2000	2000	0	0	43.00	57.00		
1 MOBILE HOM 0% - 0 Heated Area: 1344 HX Base Yr													

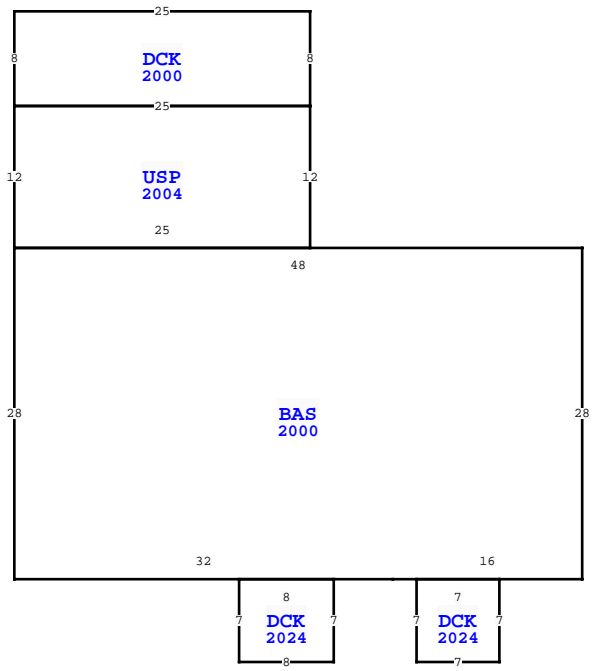

Quality	08	FAIR			
DOR CODE	0200 MOBILE HOME				
MAP NUM	4	MKT AREA 03			
NEIGHBORHOOD/LOC	98.00	1.00/			
AREA TYPE	TOTAL GROSS AREA	PCT OF BASE	YEAR	TOT ADJ AREA	SUBAREA MARKET VALUE
BAS	1,344	100	2000	1,344	51,879
DCK	200	10	2000	20	772
DCK	49	10	2024	5	193
DCK	56	10	2024	6	231
USP	300	50	2004	150	5,790
TOTALS	1,949			1,525	58,866

EXTRA FEATURES																
L N	OB/XF CODE	DESCRIPTION	BLD CAP	L	W	UNITS	UT	Adj R	ADJ UNIT PRICE	ORIG COND	YEAR ON	YEAR ACTUAL	Q	% COND	OB/XF MKT VALUE	NOTES
6	0620	WOOD UTL B	0	0	12	8			6.00	100	1996	1996	3	20	115	
7	0955	PRIVACY FE	0	0	0	0	LF	15.00	15.00	100	2016	2016	3	87	3,706	

TOTALS		1,949				1,525			58,866								
39 WAKULLA CIR, PANACEA										BLD DATE 10/02/2018 MMJT		LGL DATE 10/02/2018 MMJT		AG DATE 10/02/2018 MMJT			

WAKULLA COUNTY PROPERTY			
VALUATION SUMMARY			PAGE 1 of 1
VALUATION BY		STANDARD	
Tax Group: 3		Tax Dist:	
BUILDING MARKET VALUE		58,866	
TOTAL MARKET OB/XF VALUE		3,821	
TOTAL LAND VALUE - MARKET		10,000	
TOTAL MARKET VALUE		72,687	
SOH/AGL Deduction		18,722	
ASSESSED VALUE		53,965	
TOTAL EXEMPTION VALUE		0	
BASE TAXABLE VALUE		53,965	
TOTAL JUST VALUE		72,687	
NCON VALUE		425	
INCOME VALUE			
PREVIOUS YEAR MKT VALUE		61,092	
5 YR CH MM 08/23/2024 UPDATE XFOBS & TRAVS			
MM LEFT DOOR HANGER			
CHG TRAV, DEL SPCD			
5 YR PRCL CK, PU XFOB LN 7, DEL XFOB LN 11			
PERMIT NUM	DESCRIPTION	AMT	ISSUED
2014926	ELEC	0	11/20/2014
026789	DCK	0	07/19/2000
026249	DW/MH	0	02/25/2000

SALES DATA						
OFF RECORD Number	DATE	TYPE INST	Q / U	V / I	RSN CD	SALE PRICE
0972/0323	6/03/2015	WD	U	I	12	19,500
GRANTOR: AMERIS BANK						
GRANTEE: REID WILLIAM H & LA						
0932/0061	12/11/2013	CT	U	I	11	0
GRANTOR: CLERK OF COURT / GRAY						
GRANTEE: AMERIS BANK						

BUILDING NOTES													

BUILDING DIMENSIONS													
BAS=[YR=2000;ORIG=0,0] W48 S28 E32 E16 N28 \$													
USP=[YR=2004;ORIG=-48,0] E25 N12 W25 S12 \$													
DCK=[YR=2000;ORIG=-48,-12] E25 N8 W25 S8 \$													
DCK=[YR=2024;DPR_YEAR=2000;ORIG=-29,28] E8 S7 W8 N7 \$													
DCK=[YR=2024;DPR_YEAR=2016;ORIG=-14,28] E7 S7 W7 N7 \$													

LAND DESCRIPTION														TOTAL OB/XF										
L N	USE CODE	CLS	LAND USE DESCRIPTION	CAP	R D	LOC ZONE	FRONT	DEPTH	TOT LND UTS	UNIT TYPE	D T	DPH FACT	% COND	TOT ADJ	UNIT PRICE	ADJ UNIT PRICE	LAND VALUE	OTHER ADJUSTMENTS AND NOTES	YEAR	DENSITY	DECL	FRZ	YR	CONSRV
1	000201	C	MH	0			75.00	125.00	1.00	LT		1.00	1.00	1.00	10,000.00	10,000.00	10,000							