

BUILDING CHARACTERISTICS		CONSTRUCTION	
ELEMENT	CD		
Foundation	01	WOOD FRAME	100
Frame	02	WOOD FRAME	100
Exterior Wall	30	VINYL	100
Roof Structur	03	GABLE/HIP	100
Roof Cover	03	COMP SHNGL	100
Interior Wall	05	DRYWALL	100
Interior Floo	14	CARPET	60
Interior Floo	08	SHT VINYL	40
Heating Type	04	AIR DUCTED	100
Air Condition	03	CENTRAL	100
Bedrooms		4	100
Bathrooms		2	100
Stories	1.	1.	100
Class	00	N/A	100
Units		0	100
Quality	03	AVERAGE	
DOR CODE	0200	MOBILE HOME	
MAP NUM	5	MKT AREA	10
NEIGHBORHOOD/LOC	000	1.00/	
AREA TYPE	TOTAL GROSS AREA	PCT OF BASE	YEAR
BAS	1,800	100	2013
DCK	16	10	2016
DCK	160	10	2024
UOP	48	25	2016
USP	480	50	2016
TOTALS	2,504		

MARKET ADJUSTMENTS													
TYPE	MDL	EFF. AREA	TOT ADJ PTS	EFF. BASE RATE	REPL. COST NEW	AYB	EYB	ECON	FNCT	NORM	% COND		
1	MOBILE HOM	100%	- 2014		Heated Area: 1800					HX Base Yr	2014		

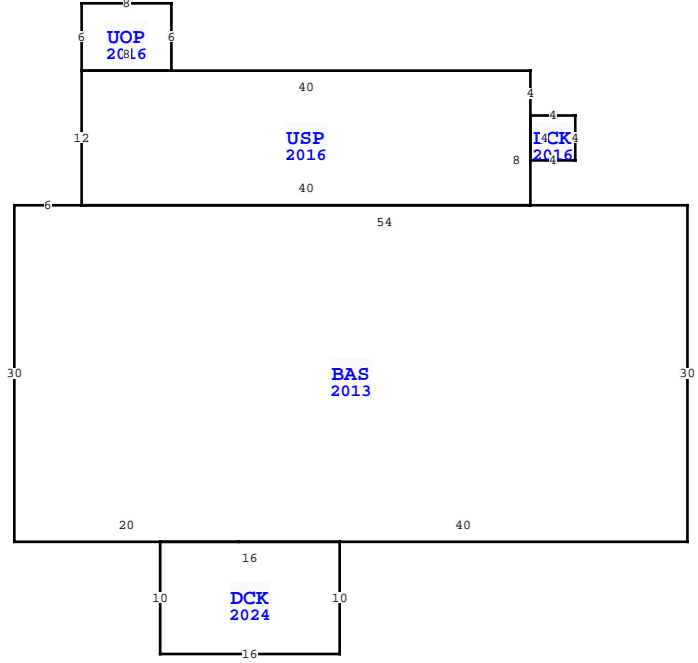

WAKULLA COUNTY PROPERTY			
VALUATION SUMMARY			PAGE 1 of 1
VALUATION BY		STANDARD	
Tax Group: 3	Tax Dist:		
BUILDING MARKET VALUE			131,210
TOTAL MARKET OB/XF VALUE			6,516
TOTAL LAND VALUE - MARKET			13,050
TOTAL MARKET VALUE			150,776
SOH/AGL Deduction			71,144
ASSESSED VALUE			79,632
TOTAL EXEMPTION VALUE	HX HB	50,000	
BASE TAXABLE VALUE			29,632
TOTAL JUST VALUE			150,776
NCON VALUE			3,213
INCOME VALUE			
PREVIOUS YEAR MKT VALUE			97,549
MM 5 YR CK 8/3/23 - CORR QUAL & XFOB DIMENS, PU XF			
CORRECT LAND LINE REMOVE WETLAND			
INCR EYB 2013-2015 PRMT OB22-457			
LN 3, PU XFOB LN 5-6			
PERMIT NUM	DESCRIPTION	AMT	ISSUED
OB22-000457	HVAC-CC	0	08/24/2022
2013213	MECH	0	04/10/2013
2013173	MH SETUP-CO	0	03/25/2013

SALES DATA						
OFF RECORD Number	DATE	TYPE INST	Q U	V I	RSN CD	SALE PRICE
0903/0396	2/25/2013	QC	U	V	11	100
GRANTOR: STOKELEY JEFFERY W &						
GRANTEE: STOKELEY JEFFERY W						
0902/0576	2/25/2013	QC	U	V	11	100
GRANTOR: STOKELEY JEFFERY W &						
GRANTEE: STOKELEY JEFFERY W						

EXTRA FEATURES																	
L N	OB/XF CODE	DESCRIPTION	BLD	CAP	L	W	UNITS	UT	Adj R	ADJ UNIT PRICE	ORIG COND	YEAR ON	YEAR ACTUAL	Q	% COND	OB/XF MKT VALUE	NOTES
1	0130	FIRE PLACE	0	100	0	0	1.00	UT	1,300.00	1,300.00	100	2013	2013	3	80	1,040	
2	0700	PORT BLDG	0	100	20	12	240.00	SF	8.00	8.00	100	2012	2012	3	78	1,498	
3	0055	PORTABLE C	0	100	20	22	440.00	SF	3.00	3.00	100	2000	2000	3	20	264	
5	0700	PORT BLDG	0	100	8	6	48.00	SF	8.00	8.00	100	2000	2000	3	57	219	
6	0213	CONCRETE P	0	100	18	12	216.00	SF	6.00	6.00	100	2000	2000	3	100	1,296	
7	0955	PRIVACY FE	0	100	0	0	34.00	LF	15.00	15.00	100	2024	2020	AV	97	495	
8	0055	PORTABLE C	0	100	40	20	800.00	SF	0.00	0.00	100	2024	2022	AV	97	0	
9	0055	PORTABLE C	0	100	20	20	400.00	SF	0.00	0.00	100	2024	2000	AV	20	0	
10	0213	CONCRETE P	0	100	0	0	284.00	SF	6.00	6.00	100	2024	2018	AV	100	1,704	
12	0055	PORTABLE C	0	100	20	20	400.00	SF	0.00	0.00	100	2024	2022	AV	100	0	

BUILDING NOTES													
BUILDING DIMENSIONS													
BAS=[YR=2013;ORIG=0,0] W54 W6 S30 E20 E40 N30 \$													
USP=[YR=2016;ORIG=-54,0] E40 N8 N4 W40 S12 \$													
UOP=[YR=2016;ORIG=-54,-12] E8 N6 W8 S6 \$													
DCK=[YR=2016;ORIG=-14,-8] S4 E4 N4 W4 \$													
DCK=[YR=2024;ORIG=-47,30] E16 S10 W16 N10 \$													

LAND DESCRIPTION														TOTAL OB/XF										
L N	USE CODE	CLS	LAND USE DESCRIPTION	CAP	R D	LOC ZONE	FRONT	DEPTH	TOT LND UTS	UNIT TYPE	D T	DPH FACT	% COND	TOT ADJ	UNIT PRICE	ADJ UNIT PRICE	LAND VALUE	OTHER ADJUSTMENTS AND NOTES	YEAR	DENSITY	DECL	FRZ	YR	CONSRV
1	000201	C	MH	100			0.00	0.00	1.74	AC		1.00	1.00	1.00	7,500.00	7,500.00	13,050							