

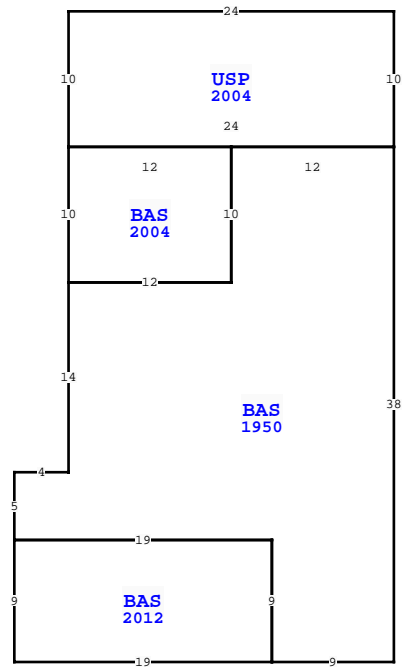

| ELEMENT | | CD | CONSTRUCTION |
|------------------|------------------|---------------|--------------|
| Foundation | 02 | CONCR | SLAB 100 |
| Frame | 03 | MASONRY | 100 |
| Exterior Wall | 15 | CONC BLOCK | 90 |
| Exterior Wall | 04 | SINGLE SID | 10 |
| Roof Structur | 03 | GABLE/HIP | 100 |
| Roof Cover | 13 | GALVALUM | 100 |
| Interior Wall | 01 | MINIMUM | 90 |
| Interior Wall | 05 | DRYWALL | 10 |
| Interior Floo | 10 | LAMINATED | 80 |
| Interior Floo | 11 | CLAY TILE | 20 |
| Heating Type | 02 | CONVECTION | 100 |
| Air Condition | 02 | WINDOW | 100 |
| Bedrooms | | 1 | 100 |
| Bathrooms | | 1.5 | 100 |
| Story Height | | 0 | 100 |
| Stories | 1. | 1. | 100 |
| Units | | 0 | 100 |
| Quality | 02 | BELOW AVERAGE | |
| DOR CODE | 0100 | SINGLE FAMILY | |
| MAP NUM | 5 | MKT AREA | 13 |
| NEIGHBORHOOD/LOC | 000 | 1.00/ | |
| AREA TYPE | TOTAL GROSS AREA | PCT OF BASE | YEAR |
| BAS | 677 | 100 | 1950 |
| BAS | 120 | 100 | 2004 |
| BAS | 171 | 100 | 2012 |
| USP | 240 | 40 | 2004 |
| TOTALS | 1,208 | | |

| MARKET ADJUSTMENTS | | | | | | | | | | | |
|---|-----|-----------|-------------|----------------|----------------|------|------|------|------|-------|--------|
| TYPE | MDL | EFF. AREA | TOT ADJ PTS | EFF. BASE RATE | REPL. COST NEW | AYB | EYB | ECON | FNCT | NORM | % COND |
| 0100 | 01 | 1,064 | 76.3725 | 72.55 | 77,193 | 1950 | 1979 | 0 | 0 | 45.10 | 54.90 |
| 1 SINGLE FAM 100% - 2024 Heated Area: 968 HX Base Yr 2024 | | | | | | | | | | | |



| WAKULLA COUNTY PROPERTY | | | |
|---|-------------------|-----|-------------|
| VALUATION SUMMARY | | | PAGE 1 of 1 |
| VALUATION BY | | | STANDARD |
| Tax Group: 3 | Tax Dist: | | |
| BUILDING MARKET VALUE | | | 42,379 |
| TOTAL MARKET OB/XF VALUE | | | 8,438 |
| TOTAL LAND VALUE - MARKET | | | 30,500 |
| TOTAL MARKET VALUE | | | 81,317 |
| SOH/AGL Deduction | | | 0 |
| ASSESSED VALUE | | | 81,317 |
| TOTAL EXEMPTION VALUE | HX HB | | 50,000 |
| BASE TAXABLE VALUE | | | 31,317 |
| TOTAL JUST VALUE | | | 81,317 |
| NCON VALUE | | | 0 |
| INCOME VALUE | | | |
| PREVIOUS YEAR MKT VALUE | | | 67,010 |
| FOR REROOF | | | |
| MM 5 YR CK CHG RCVR, PU XFOB, EYB 1975-1979 N | | | |
| CONFIRM MAILING ADDRESS | | | |
| 2021 VALUES PORT TO 00063-000 JOHNSON | | | |
| PERMIT NUM | DESCRIPTION | AMT | ISSUED |
| 19000554 | REROOF-CO | 0 | 11/19/2019 |
| 20052028 | RENOVATIONS/CO 7/ | 0 | 07/05/2006 |

| SALES DATA | | | | | | |
|--------------------------------|-----------|-----------|-----|-----|--------|------------|
| OFF RECORD Number | DATE | TYPE INST | Q U | V I | RSN CD | SALE PRICE |
| 1348/0249 | 2/26/2024 | CR | U | I | 11 | 100 |
| GRANTOR: JOHNSON DAVID P & TER | | | | | | |
| GRANTEE: JOHNSON DAVID P & T | | | | | | |
| 1348/0249 | 2/26/2024 | CR | U | I | 11 | 100 |
| GRANTOR: JOHNSON DAVID P | | | | | | |
| GRANTEE: JOHNSON DAVID P & T | | | | | | |

| EXTRA FEATURES | | | | | | | | | | | | | | | | |
|----------------|------------|-------------|---------|-----|----|-------|----|-------|----------------|-----------|---------|-------------|---|--------|-----------------|-------|
| L N | OB/XF CODE | DESCRIPTION | BLD CAP | L | W | UNITS | UT | Adj R | ADJ UNIT PRICE | ORIG COND | YEAR ON | YEAR ACTUAL | Q | % COND | OB/XF MKT VALUE | NOTES |
| 1 | 0350 | BOATDOCK A | 0 | 100 | 18 | 14 | SF | 24.00 | 24.00 | 100 | 1993 | 1993 | 3 | 20 | 1,210 | |
| 2 | 0960 | SCREEN ROO | 0 | 100 | 11 | 11 | SF | 21.00 | 21.00 | 100 | 2003 | 2003 | 3 | 60 | 1,525 | |
| 3 | 0770 | PUMP HOUSE | 0 | 100 | 6 | 4 | SF | 5.00 | 5.00 | 100 | 2009 | 2009 | 3 | 55 | 66 | |
| 4 | 0375 | WOOD WALK | 0 | 100 | 41 | 3 | SF | 15.00 | 15.00 | 100 | 2006 | 2006 | 3 | 27 | 498 | |
| 5 | 0610 | VINYL UTL | 0 | 100 | 8 | 6 | SF | 6.00 | 6.00 | 100 | 2020 | 2020 | 3 | 89 | 256 | |
| 6 | 0950 | METAL SHED | 0 | 100 | 20 | 19 | SF | 8.00 | 8.00 | 100 | 2018 | 2018 | 3 | 80 | 2,432 | |
| 7 | 0955 | PRIVACY FE | 0 | 100 | 0 | 0 | LF | 15.00 | 15.00 | 100 | 2018 | 2018 | 3 | 95 | 2,451 | |
| 8 | 0700 | PORT BLDG | 0 | 100 | 14 | 10 | SF | 0.00 | 0.00 | 100 | 2019 | 2019 | 3 | 92 | 0 | |

| TOTAL OB/XF | | | | | | | | | |
|-------------|------------|------|-----------|-----------------|--|--|--|--|--|
| 8,438 | | | | | | | | | |
| BLD DATE | 08/17/2017 | MMSR | LGL DATE | | | | | | |
| XF DATE | 08/17/2017 | MMSR | LAND DATE | 08/17/2017 MMSR | | | | | |
| INC DATE | | | AG DATE | | | | | | |

| BUILDING NOTES | | | | | | | | | |
|----------------|--|--|--|--|--|--|--|--|--|
| | | | | | | | | | |

| BUILDING DIMENSIONS | | | | | | | | | |
|---|--|--|--|--|--|--|--|--|--|
| USP=[YR=2004] W24 S10 BAS=[YR=2004] S10 E12 N10 W12\$ E24 | | | | | | | | | |
| BAS=[YR=1950] W12 S10 W12 S14 W4 S5 E19 S9 BAS=[YR=2012] N9 | | | | | | | | | |
| W19 S9 E19\$ E9 N38\$ N10\$. | | | | | | | | | |

| LAND DESCRIPTION | | | | | | | | | | | | | | | | | | | | | | | | |
|------------------|----------|-----|----------------------|-----|-----|----------|-------|--------|-------------|-----------|-----|----------|--------|---------|------------|----------------|------------|-----------------------------|------|---------|------|-----|----|--------|
| L N | USE CODE | CLS | LAND USE DESCRIPTION | CAP | R D | LOC ZONE | FRONT | DEPTH | TOT LND UTS | UNIT TYPE | D T | DPH FACT | % COND | TOT ADJ | UNIT PRICE | ADJ UNIT PRICE | LAND VALUE | OTHER ADJUSTMENTS AND NOTES | YEAR | DENSITY | DECL | FRZ | YR | CONSRV |
| 1 | 000132 | C | SFR RIVER | 100 | | | 60.00 | 222.00 | 60.00 | FF | | 1.00 | 1.00 | 1.00 | 500.00 | 500.00 | 30,000 | | | | | | | |
| 2 | 000000 | C | VAC RES | 100 | | | 0.00 | 0.00 | 1.00 | FF | | 1.00 | 1.00 | 1.00 | 500.00 | 500.00 | 500 | | | | | | | |