

ELEMENT		CD	CONSTRUCTION		
Foundation	04	PILE	WOOD	100	
Frame	02	WOOD	FRAME	100	
Exterior Wall	05	HARDIE	BRD	100	
Roof Structur	03	GABLE/HIP		100	
Roof Cover	01	MINIMUM		100	
Interior Wall	05	DRYWALL		100	
Interior Floor	12	HARDWOOD		100	
Heating Type	04	AIR	DUCTED	100	
Air Condition	03	CENTRAL		100	
Bedrooms		1	100		
Bathrooms		1	100		
Story Height		0	100		
Stories	1.	1.	100		
Units		0	100		
Quality	03	AVERAGE			
DOR CODE	0100	SINGLE FAMILY			
MAP NUM	5	MKT AREA	13		
NEIGHBORHOOD/LOC	000	1.00/			
AREA TYPE	TOTAL GROSS AREA	PCT OF BASE	YEAR	TOT ADJ AREA	SUBAREA MARKET VALUE
BAS	811	100	2006	811	85,135
FOP	36	30	2006	11	1,155
FOP	36	30	2006	11	1,155
TOTALS	883			833	87,445

MARKET ADJUSTMENTS													
TYPE	MDL	EFF. AREA	TOT ADJ PTS	EFF. BASE RATE	REPL. COST NEW	AYB	EYB	ECON	FNCT	NORM	% COND		
1	SINGLE FAM	100%	- 1993		Heated Area: 811					HX Base Yr 1993			

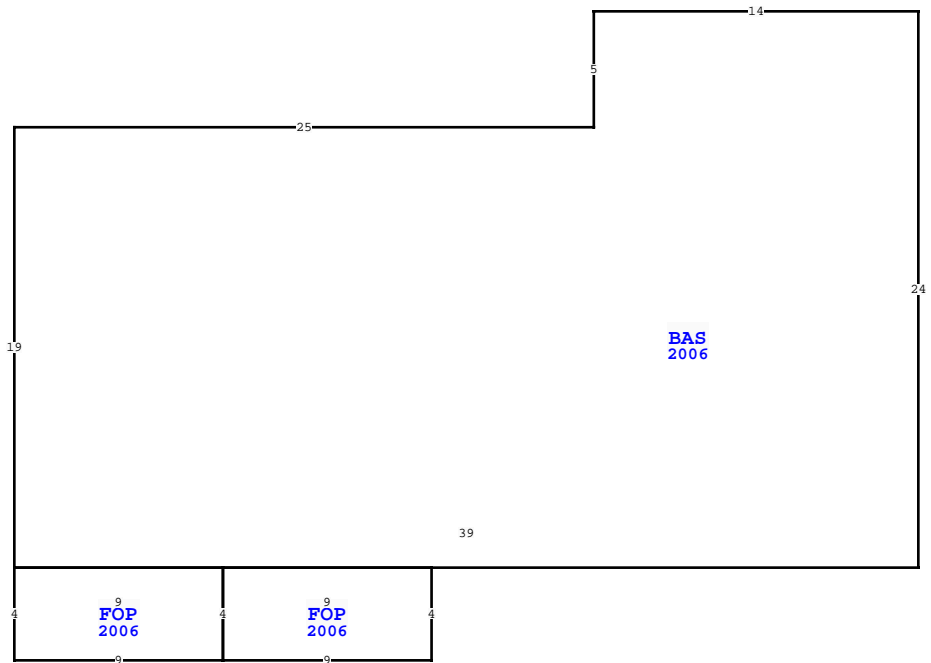

WAKULLA COUNTY PROPERTY				PAGE 1 of 1	3	
VALUATION BY		STANDARD				
Tax Group: 3		Tax Dist:				
BUILDING MARKET VALUE				87,445		
TOTAL MARKET OB/XF VALUE				3,249		
TOTAL LAND VALUE - MARKET				15,000		
TOTAL MARKET VALUE				105,694		
SOH/AGL Deduction				74,034		
ASSESSED VALUE				31,660		
TOTAL EXEMPTION VALUE		HX HB SX		31,660		
BASE TAXABLE VALUE				0		
TOTAL JUST VALUE				105,694		
NCON VALUE				1,156		
INCOME VALUE						
PREVIOUS YEAR MKT VALUE				103,671		
FR 5YR CK 8/17/23; PU NEW TRAV						
INC EYB 2006-2008 HVAC OB22-000609						
UPDATE HX APP YEAR BASED ON HIST INFO						
2019 SX RENEWAL COMPLETE						
PERMIT NUM	DESCRIPTION	AMT	ISSUED			
OB22-000609	HVAC CHANGE OUT-C		09/29/2022			
32251	REPL BRN SFD	0	02/24/2005			
32251	SFD	0	08/16/2004			
287585	RENEWAL	0	03/11/2003			
28755	REMOD	0	03/11/2002			
21409	N/A	0	09/23/1996			
SALES DATA						
OFF RECORD Number	DATE	TYPE INST	Q U	V I	RSN CD	SALE PRICE
0739/0473	12/26/2007	QC	Q	I	01	100
GRANTOR: INGLE ALLISON JOHN &						
GRANTEE: INGLE CHARLES FRANK						
0193/0724	6/01/1992	QC	U	I		100
GRANTOR:						
GRANTEE:						
BUILDING NOTES						
BUILDING DIMENSIONS						
BAS=[YR=2006;ORIG=0,0] W14 S5 W25 S19 E39 N24 \$						
FOP=[YR=2006;ORIG=-30,24] S4 E9 N4 W9 \$						
FOP=[YR=2006;ORIG=-39,24] E9 S4 W9 N4 \$						

EXTRA FEATURES																
L N	OB/XF CODE	DESCRIPTION	BLD CAP	L	W	UNITS	UT	Adj R	ADJ UNIT PRICE	ORIG COND	YEAR ON	YEAR ACTUAL	Q	% COND	OB/XF MKT VALUE	NOTES
1	0130	FIRE PLACE	0	100	0	0		1.00	UT	1,300.00	100	2006	2006	3	66	858
2	0940	OPEN SHED	0	100	13	15		195.00	SF	4.00	100	1998	1998	3	20	156
3	0940	OPEN SHED	0	100	13	10		130.00	SF	4.00	100	1998	1998	3	20	104
4	0620	WOOD UTL B	0	100	12	12		144.00	SF	6.00	100	1982	1982	3	20	173
5	0211	CONCRETE W	0	100	5	4		20.00	SF	6.00	100	2007	2007	3	30	36
6	0375	WOOD WALK	0	100	101	4		404.00	SF	15.00	100	2007	2007	3	30	1,818
7	0940	OPEN SHED	0	100	7	6		42.00	SF	4.00	100	2014	2014	3	62	104
TOTAL OB/XF														3,249		

LAND DESCRIPTION														TOTAL OB/XF										
L N	USE CODE	CLS	LAND USE DESCRIPTION	CAP	R D	LOC ZONE	FRONT	DEPTH	TOT LND UTS	UNIT TYPE	D T	DPH FACT	% COND	TOT ADJ	UNIT PRICE	ADJ UNIT PRICE	LAND VALUE	OTHER ADJUSTMENTS AND NOTES	YEAR	DENSITY	DECL	FRZ	YR	CONSRV
1	000132	C	SFR RIVER	100			80.00	243.00	1.00	LT		1.00	1.00	1.00	15,000.00	15,000.00	15,000							